

INSTALLATION INSTRUCTIONS AND PARTS LIST

FOR MOUNTING 481514 DUALLY BOX EXTENSION SIDE ENTRY STEPS ON: 2015 + CHEVROLET SILVERADO & GMC SIERRA 3500 DUALLY PICKUPS

1. READ INSTRUCTIONS COMPLETELY AND CHECK TO MAKE SURE THAT ALL REQUIRED PARTS (LISTED ON SERVICE PARTS LIST) ARE ON HAND BEFORE STARTING THE INSTALLATION.

ATTACHING THE STEP (PASSENGER SIDE)

2. REMOVE THE FRONT TWO (2) FACTORY BOLTS THAT SECURE THE BOX TO THE FRAME. REMOVE THE M8 BOLT ON THE OUTER EDGE OF THE FRONT BOX STIFFENER, THIS BOLT WILL NOT BE REUSED.
3. ATTACH THE VERTICAL MOUNTING BRACES (ITEM #6, 7), AND TUBULAR STIFFENER BRACE (ITEM #9) TO THE BOX CROSS-MEMBERS AS FOLLOWS:
4. WITH THE VERTICAL BRACES (ITEM #6, 7) IN PLACE, REINSTALL THE TWO (2) FACTORY BOLTS THAT ATTACH THE BOX TO THE FRAME IN THE INNER MOST HOLES OF THE VERTICAL BRACES (ITEM #6, 7) AS SHOWN IN **(FIG. 1)** LEAVE THEM FINGER TIGHT AT THIS TIME.
5. INSTALL THE M8 X 25mm SCREW (ITEM #23), FLAT WASHER (ITEM #17), THRU THE STRAIGHT END OF THE TUBULAR BRACE (ITEM #9) AND THRU THE OUTER MOST HOLE OF THE FRONT VERTICAL BRACE (ITEM #7). AS SHOWN IN **(FIG. 1)**
6. INSTALL THE 3/8-16 X 7.5" J-BOLT (ITEM #15) 3/8" FLAT WASHER (ITEM #25), AND THE 3/8-16 FLANGE NUT (ITEM #16) HOOK THE J-HOOK INTO THE SLOT ON THE SIDE OF THE SECOND BOX BRACE, USING THE OUTER MOST HOLE OF THE REAR VERTICAL BRACE (ITEM #6) AS SHOWN IN **(FIG. 1)** LEAVE LOOSE UNTIL EVERYTHING ELSE IS INSTALLED, THEN ADJUST AND TIGHTEN.
7. INSTALL THE OUTBOARD BRACKETS (ITEM # 11, 13) USING THE 5/16-18 X 1" HEX BOLTS (ITEM #18) FLAT WASHER (ITEM #17) AND 5/16-18 FLANGE NUT (ITEM #19) TO THE VERTICAL BRACES AS SHOWN IN **(FIG.1)** LEAVE FINGER TIGHT AT THIS POINT.
8. ATTACH THE REAR MOUNTING BRACE (ITEM #31) TO THE STEP PLATE USING THE 10-24 X 3/4" SST CARRIAGE BOLTS (ITEM #20), AND THE 10-24 SST FLANGE NUT (ITEM #21), LEAVE THESE FINGER TIGHT AT THIS TIME.
9. INSTALL STEP PLATE ASSEMBLY ON TO OUTBOARD BRACKETS USING THE 10-24 X 3/4" SST CARRIAGE BOLTS (ITEM #20) NEOPRENE WASHERS (ITEM #38) SST FLANGE NUTS (ITEM #21) AS SHOWN IN **(FIG. 1)** LEAVE FINGER TIGHT UNTIL ADJUSTED.
10. ATTACH THE MUD GUARD TRIM (ITEM #32) TO THE MUD GUARD (ITEM #27) AS SHOWN IN **(FIG. 1)**. REMOVE THE (2) FACTORY SCREWS FROM THE FRONT OF THE REAR FENDER OPENING, **(USE A T30 TORX BIT)**. INSTALL THE REAR MUD GUARD TO THE FRONT OF THE REAR FENDER OPENING, REUSING THE (2) FACTORY SCREWS THAT WERE REMOVED. ATTACH THE MUD GUARD TO THE REAR SUPPORT BRACE WITH 10-24 X 3/4" CARRIAGE BOLTS (ITEM #20) AND 10-24 FLANGE NUTS (ITEM #21).
11. ADJUST STEP IN/ OUT, AND UP/DOWN TO MATCH CAB BOARDS, AND TIGHTEN ALL FASTENERS.

NOTE: DRIVERS SIDE IS A MIRROR IMAGE OF PASSENGER SIDE. REPEAT STEPS 2 THRU 12.



1200 E. Birch St.

Brandon, SD 57005

REV A 27JUL15
552596 SHEET 1 OF 3 22SEP14

INSTALLATION INSTRUCTIONS AND PARTS LIST

SERVICE PARTS LIST

ITEM	PART NO.	QTY	DESCRIPTION
1	552590	1	STEP PLATE, LH, – SES, 481514
2	552591	1	STEP PLATE, RH, – SES, 481514
3	104250	1	END CAP-RH FRONT/LH REAR
4	104251	1	END CAP-LH FRONT/RH REAR
5	552469	1	LH SIDE REAR VERTICAL BRACE, 481518
6	552464	1	RH SIDE REAR VERTICAL BRACE, 481518
7	552468	1	RH SIDE FRONT VERTICAL BRACE, 481518
8	552463	1	LH SIDE FRONT VERTICAL BRACE, 481518
9	552099	1	RH SIDE TUBULAR BRACE, 481519
10	552098	1	LH SIDE TUBULAR BRACE, 481519
11	552466	1	RH SIDE FRONT OUTBOARD BRACKET, 481518
12	552471	1	LH SIDE FRONT OUTBOARD BRACKET, 481518
13	552595	1	RH SIDE REAR OUTBOARD BRACKET, 481514
14	552594	1	LH SIDE REAR OUTBOARD BRACKET, 481514
15	109639	2	J-BOLT 3/8-16 X 7.4375, ZP
16	100181	2	NUT-FLANGE, SERRATED, HEX, 3/8-16, ZP
17	100034	22	WASHER-FLAT, 5/16" ZP
18	100647	8	SCREW – CAP, HEX HEAD, 5/16-18 X 1" ZP
19	100178	10	NUT- SERR FLG, HEX, 5/16-18 UNC, STL, ZP
20	104258	18	BOLT-CARRIAGE, SST,#10-24 X 3/4" LG
21	104261	34	NUT - SERR FLANGE, HEX, SST, #10-24
22	105500	2	PAD- MOLDING, STEP PLATE, 5.50 X 20.00" LG
23	102549	2	SCREW – CAP, HEX HEAD, M8-1.25 X 25mm-10.9, ZP
24	104256	1	TRIM-SEAL, EXTRN, 60.50" LG
25	100062	2	WASHER – FLAT, 3/8"
26	109311	1	MUD GUARD-LH, GM, SES, DUALY EXT, 481514
27	109312	1	MUD GUARD-RH, GM, SES, DUALY EXT, 481514
28	104257	4	NUT-HEX, SINGLE SELF THDG, CAP WASHER, 1/4"
29	100025	2	SCREW – CAP, HEX HEAD, 5/16-18 X 1-1/4" ZP
30	107863	12	BOLT-CARRIAGE,SST,#10-24X.50,BZP
31	549412	2	BRACE-SUPPORT, REAR, RH/LH, GM, SES, DUALY
32	544070	2	TRIM-MUD GUARD, 33.00" LG
33	107645	2	CLIP-U, .115- .185, BLK
34	107958	2	SCR-PPH, #8-18 X 1/2, SST
35	104530	16	WSHR-FL, NPRN, .200 SQ. X .468 X .031



(A LUVERNE Company)

1200 E. Birch St.

Brandon, SD 57005

REV A 27JUL115
552596 SHEET 2 OF 3 22SEP14

SERVICE PARTS LIST
MODEL NO. - 481514

**2015 + GM
SILVERADO/SEIRRA
HD 3500 8' DUALLY BOX**

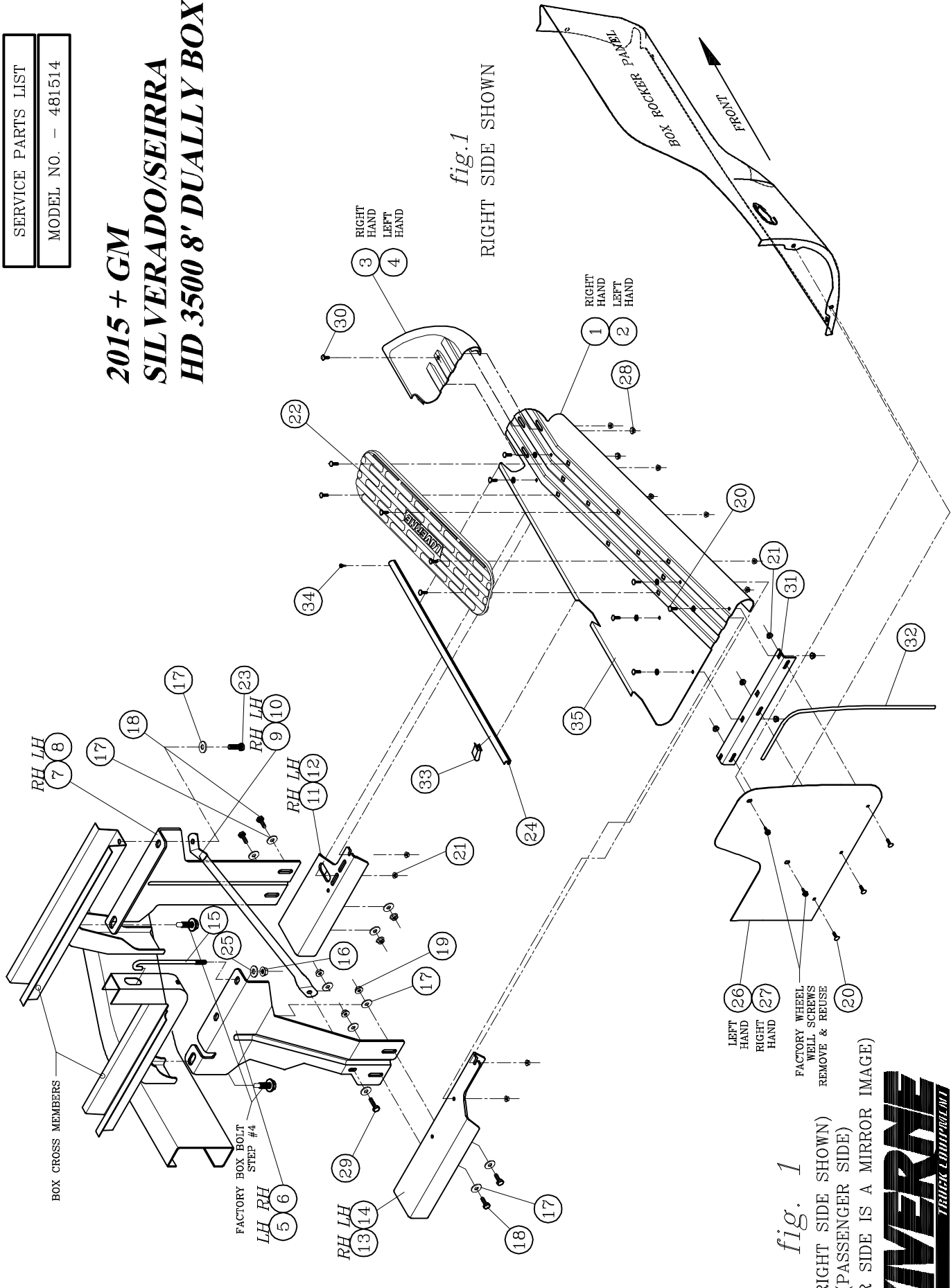

fig.1
RIGHT SIDE SHOWN

fig. 1
(RIGHT SIDE SHOWN)
(PASSENGER SIDE)
(DRIVER SIDE IS A MIRROR IMAGE)



1200 E. Birch St.
A Lovorne Company
Bryn Mawr, PA 19006