

INSTALLATION INSTRUCTIONS AND PARTS LIST

BLACK & STAINLESS STEEL BAJA-STEPS:

430421 2004 AND NEWER FORD F-150 REG. CAB TRUCKS

430422/490422 2004 AND NEWER FORD F-150 SUPER CAB TRUCKS

430923/490923 2009 AND NEWER FORD F-150 SUPER CREW TRUCKS



NO DRILL INSTALLATION

1. READ INSTRUCTIONS COMPLETELY AND CHECK TO MAKE SURE THAT ALL THE REQUIRED PARTS (LISTED ON THE SERVICE PARTS LIST) ARE ON HAND BEFORE STARTING THE INSTALLATION.
2. ASSEMBLE THE BAJA-STEP TUBES AND MOUNTING BRACKETS AS FOLLOWS.
NOTE: THE 1" X 3" SERIAL NUMBER DECAL IS LOCATED ON THE FRONT LEG OF THE LEFT (DRIVERS SIDE) BAJA-STEP ASSEMBLY.
 - 2.1. LAY BAJA-STEP ASSEMBLIES (ITEM #1, & 2) ON FLAT SURFACE, AND ATTACH THE MOUNTING BRACKETS (ITEMS #3) TO EACH BAJA-STEP IN THE LOCATIONS AS SHOWN IN (FIG. 1), USING THE SUPPLIED 3/8-16 X 1 SCREW, 3/8" FLAT WASHER, & 3/8-16 SERRATED FLANGE NUT, (ITEMS #8, 9, & 10). LEAVE THESE FASTENERS FINGER TIGHT AT THIS TIME.
3. EXISTING MOUNTING HOLE PATTERNS ARE LOCATED ON THE INTERIOR WALL OF THE ROCKER PANEL.
 - 3.1. INSERT TWO 5/16-18 MULTI THREAD U-NUTS (ITEMS #6), INTO THE TOP HOLES OF THE FRONT AND REAR PATTERN LOCATIONS, SO THAT THE THREADS ARE TO THE INSIDE OF THE ROCKER PANEL. (THIS IS DONE BY INSERTING THE THREADED HALF OF THE U-NUT THRU THE .75" X 1.50" RECTANGULAR SLOT AND SLIDING THE U-NUT TOWARDS THE ROUND HOLE UNTIL THE U-NUT SEATS IN THE ROUND HOLE).
4. POSITION THE DRIVERS SIDE BAJA-STEP/BRACKET ASSEMBLY UP UNDER THE DRIVERS SIDE ROCKER PANEL SO THE HOLES IN THE MOUNTING BRACKETS LINE UP WITH THE MOUNTING HOLES IN THE PINCH WELD. INSTALL THE 5/16-18 X 1.00" BLACK ZINC BOLTS (ITEMS #11), 5/16 BLACK ZINC WASHER (ITEM #12), 5/16 ZINC FLAT WASHER (ITEM #7) AND THE 5/16-18 SERRATED FLANGE NUTS (ITEM #5). LEAVE FASTENERS FINGER TIGHT AT THIS TIME.
5. ON THE TOP HOLES OF THE BRACKETS, INSTALL THE 5/16-18 X 1.00" HEX HEAD CAP SCREWS (ITEMS #4), AND A 5/16 FLAT WASHER (ITEMS #7), THRU THE MOUNTING BRACKET AND INTO THE U-NUT. (REPEAT STEPS 3 THRU 5 ON PASSENGER SIDE).

NOTE: TORQUE ALL 5/16" FASTENERS TO 11 LB. FT. AND ALL 3/8" FASTENERS TO 33 LB. FT.



1200 E. Birch St.

Brandon, SD 57005

REV B 14AUG13

REV A 23JAN13

552158 SHEET 1 OF 3 20AUG12

SERVICE PARTS LIST

ITEM	PART NO.	QTY	DESCRIPTION
1	552251	1	BAJA-STEP WLDMT, BLK, LH, 430921 REG CAB
2	552252	1	BAJA-STEP WLDMT, BLK, RH, 430921 REG CAB
1	552152	1	BAJA-STEP WLDMT, BLK, LH, 430422 SUPER CAB
2	552153	1	BAJA-STEP WLDMT, BLK, RH, 430422 SUPER CAB
1	552328	1	BAJA-STEP WLDMT, SST, LH, 490422 SUPER CAB
2	552329	1	BAJA-STEP WLDMT, SST, RH, 490422 SUPER CAB
1	552154	1	BAJA-STEP WLDMNT, BLK, LH, 430923 CREW CAB
2	552155	1	BAJA-STEP WLDMNT, BLK, RH, 430923 CREW CAB
1	552330	1	BAJA-STEP WLDMNT, SST, LH, 490923 CREW CAB
2	552331	1	BAJA-STEP WLDMNT, SST, RH, 490923 CREW CAB
3	552151	4	BRACKET MOUNTING, 430422/430923
4	100647	8	SCREW-HEX HD, 5/16-18 X 1.00", ZP
5	102680	8	NUT-SERRATED FLNG, HEX, SST, 5/16-18
6	104264	8	U-NUT, MULTI THREAD, 5/16-18, STL, BLK
7	100034	16	FLAT WASHER, 5/16, ZP
8	106963	8	SCREW-HEX HD, 3/8-16 X 1.00",SST,BZP
9	100062	8	WASHER-FLAT, 3/8, ZP
10	100181	8	FLANGE NUT-HEX, 3/8-16, ZP
11	106997	8	SCR-HHC,5/16-18 X 1.00",SST,BZP
12	106998	8	WSHR-FL,5/16,SST,BZP



(A LIVERNE Company)

1200 E. Birch St.

Brandon, SD 57005

REV B 14AUG13

REV A 23JAN13

552158 SHEET 2 OF 3 20AUG12

SERVICE PARTS LIST

MODEL NO. - 430421/4300422/430923
490422/490923

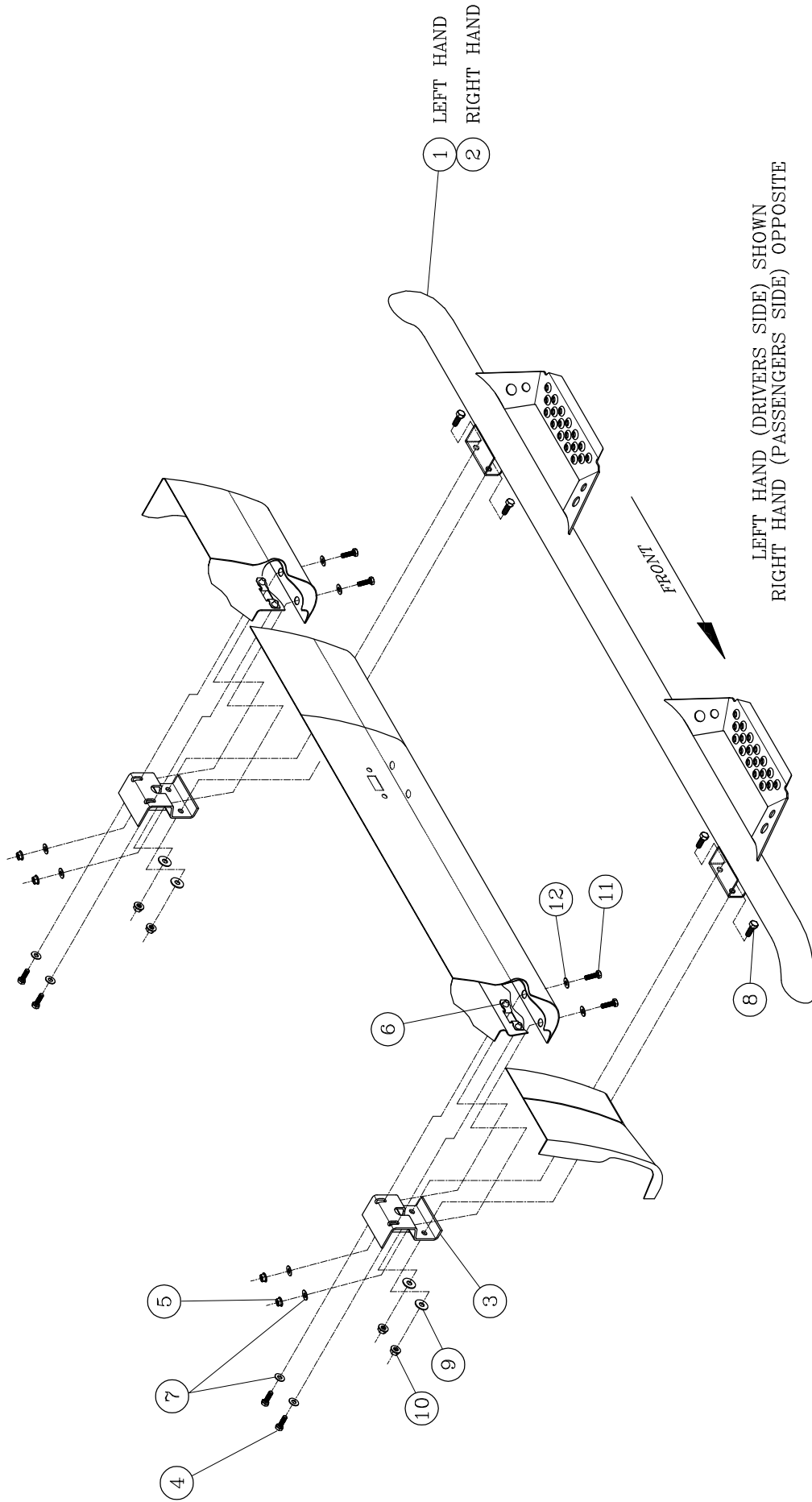

FIG. 1

LOVERNE
TRUCK EQUIPMENT
A LOVERNE COMPANY

1200 E. BIRCH ST. BROADEN, SD 57005

REV B 14AUG13
REV A 23JAN13
552158 SHEET 3 OF 3 20AUG12