

## INSTALLATION INSTRUCTIONS AND PARTS LIST

FOR MOUNTING C8811SST SERIES AND C8812SST SERIES NERF BARS ON:  
1988 AND NEWER CHEVROLET/GMC REGULAR AND EXTENDED CAB PICKUPS  
C88123SST SERIES NERF BARS ON 1996 AND NEWER CHEVROLET/  
GMC EXTENDED CAB PICKUPS WITH SIDE ACCESS PANEL

1. READ THE INSTRUCTIONS COMPLETELY AND CHECK TO MAKE SURE THAT ALL OF THE REQUIRED PARTS ARE ON HAND BEFORE STARTING THE INSTALLATION. THE CARTONS SHOULD CONTAIN:
2. NERF BAR TUBES AND MOUNTING BRACKETS (ITEM #1 & 2) ARE PRE-ASSEMBLED TO MATCH THE VEHICLE BODY MOUNTING LOCATIONS. IF ANY ADDITIONAL ADJUSTMENT SHOULD BE REQUIRED, THIS CAN BE ACCOMPLISHED BY LOOSENING THE PRE-TORQUED 1/2 IN. HEX HEAD BOLT THAT RETAINS THE MOUNTING BRACKET TO THE NERF BAR.
  - 2.1 IF THE PRE-TORQUE ON THE 1/2 IN. BOLT IS BROKEN, THE BOLT MUST BE RE-TORQUED TO 65 LB. FT.
  - 2.2 WHEN MOUNTING C8811T (REGULAR CAB) NERF BARS ON EXTENDED CAB PICKUPS, REMOVE THE 1/2 IN. HEX HEAD BOLT FROM THE LOWER HOLE OF THE REAR MOUNTING BRACKET AND MOVE THE NERF BAR TUBE TO THE UPPER HOLE IN THIS SAME MOUNTING BRACKET. (RE-TORQUE THE BOLT TO 65 LB.FT).
3. REMOVE THE FOUR (4) APPLICABLE BODY MOUNTING BOLTS FROM THE VEHICLE. (THESE ARE M12-1.75 METRIC BOLTS THAT REQUIRE A 15MM WRENCH FOR REMOVAL).
  - 3.1 THESE FOUR (4) BOLTS ARE NOT REUSED IN THIS INSTALLATION.
  - 3.2 THE BODY MOUNTING STEEL WASHER PLATES AND RUBBER CUSHIONS ARE REUSED BETWEEN THE BODY MOUNT AND THE NERF BAR MOUNTING BRACKET.
4. POSITION THE NERF BAR ASSEMBLY UP UNDER THE BODY MOUNTS. INSTALL THE M12-1.75 X 120 MM (APPROX. 4.75" LONG) HEX HEAD BOLT (ITEM #3), 1/2" LOCK WASHER (ITEM #4) AND 1/2" FLAT WASHER (ITEM #5) UP THRU THE HOLE IN THE MOUNTING BRACKET AND THE BODY MOUNTING WASHER PLATE AND CUSHION AS SHOWN. TORQUE THE M12-1.75 X 120 MM HEX BOLT TO 45 LB. FT.



(A LIVERNE Company)

1200 E. Birch St.

Brandon, SD 57005

548478 SHEET 1 MAY97

**SERVICE PARTS LIST**

<b>ITEM</b>	<b>PART NO.</b>	<b>QTY</b>	<b>DESCRIPTION</b>
1	548479	1	NERF BAR/BRKT ASSY- LH,SST,C8811SST
2	548480	1	NERF BAR/BRKT ASSY- RH,SST,C8811SST
1	548502	1	NERF BAR/BRKT ASSY- LH,SST,C8812/123SST
2	548503	1	NERF BAR/BRKT ASSY- RH,SST,C8812SST
1	548502	1	NERF BAR/BRKT ASSY- LH,SST,C8812/123SST
2	548521	1	NERF BAR/BRKT ASSY- RH,SST,(3DR)C88123SST
4	103440	4	BOLT- HEX HEAD CAP,M12-1.75 X 120 MM, ZP
3	100121	4	BOLT- HEX HEAD CAP,M12-1.75 X 120 MM, ZP
5	100118	4	WASHER- FLAT, 1/2 IN., ZP



(A LIVERNE Company)

1200 E. Birch St.

Brandon, SD 57005

548478 SHEET 2 MAY 97

SERVICE PARTS LIST

MODEL NO.	-C8811SST	SER
	-C8811TB	SER
	-C8812SST	SER
	-C8812TB	SER
	-C88123SST	SER
	-C88123TB	SER

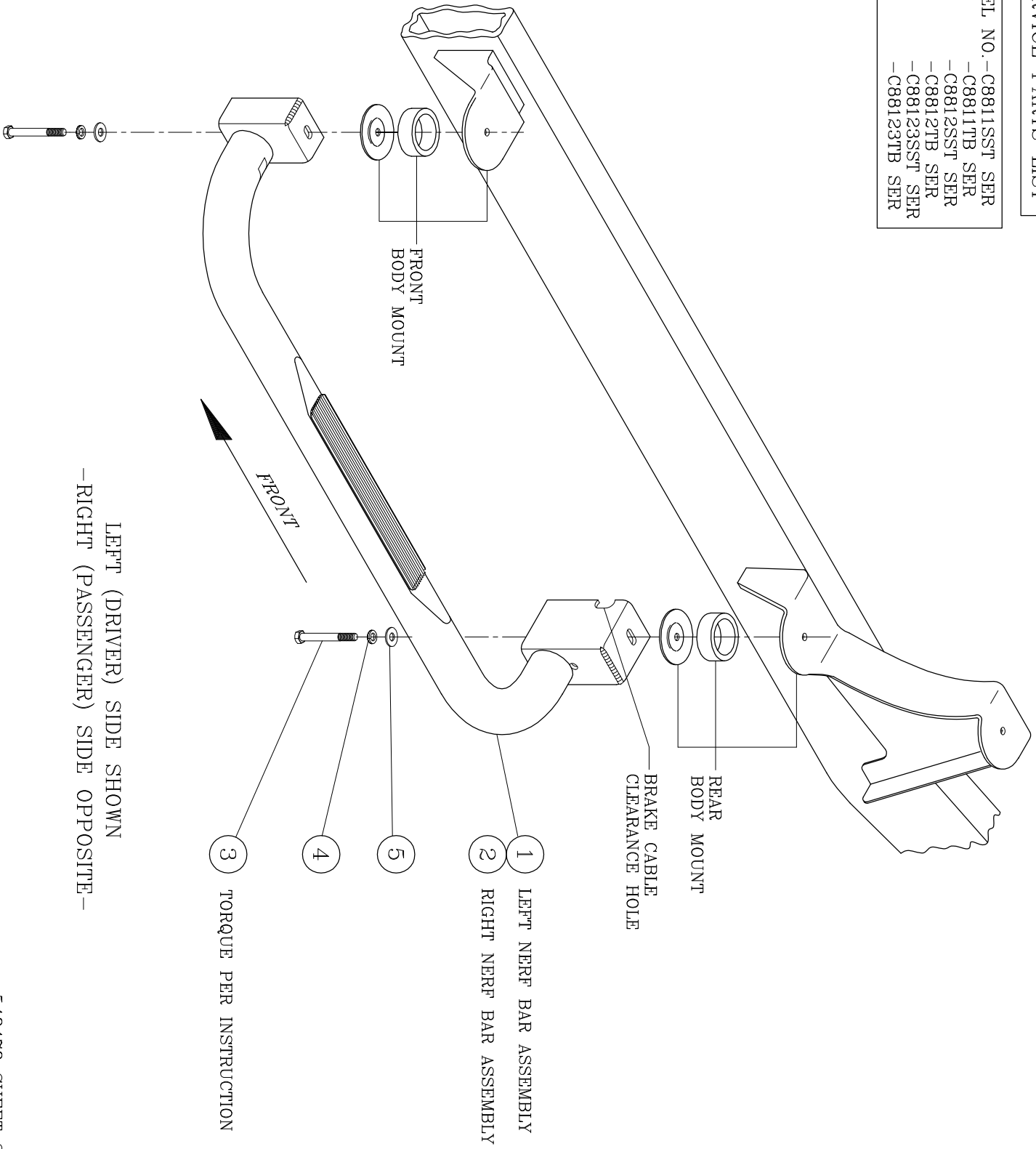

LEFT (DRIVER) SIDE SHOWN  
 -RIGHT (PASSENGER) SIDE OPPOSITE-