

INSTALLATION INSTRUCTIONS AND PARTS LIST

FOR MOUNTING ALL D9431,D9532 AND D98324 SST & TB SERIES NERF BARS ON:
1994 AND NEWER DODGE REGULAR CAB PICKUPS
1995 AND NEWER DODGE EXTENDED CAB PICKUPS
1998 AND NEWER DODGE EXTENDED CAB 4 DOOR PICKUPS

1. READ INSTRUCTIONS COMPLETELY AND CHECK TO MAKE SURE THAT ALL REQUIRED PARTS (LISTED ON SERVICE PARTS LIST) ARE ON HAND BEFORE STARTING THE INSTALLATION.
2. NERF BAR TUBES AND MOUNTING BRACKETS (ITEM #1 & 2) ARE PRE-ASSEMBLED TO MATCH THE VEHICLE BODY MOUNTING LOCATIONS. IF ANY ADDITIONAL ADJUSTMENT SHOULD BE REQUIRED, THIS CAN BE ACCOMPLISHED BY LOOSENING THE PRE-TORQUED 1/2 IN. HEX HEAD BOLT THAT RETAINS THE MOUNTING BRACKET TO THE NERF BAR.
 - 2.1 IF THE PRE-TORQUE ON THE 1/2-13 X 2.00 IN. LONG BOLT IS BROKEN, THE BOLT MUST BE RE-TORQUED TO 65 LB. FT.
3. REMOVE THE FOUR (4) APPLICABLE BODY MOUNTING BOLTS FROM THE VEHICLE.(THESE ARE M12-1.75 METRIC BOLTS THAT REQUIRE A 19 MM WRENCH FOR REMOVAL).
 - 3.1 THESE BOLTS ARE NOT REUSED IN THIS INSTALLATION.
 - 3.2 THE BODY MOUNTING STEEL WASHER PLATE / RUBBER CUSHIONS ARE REUSED BETWEEN THE BODY MOUNT AND THE NERF BAR MOUNTING BRACKET.
4. ASSEMBLE FASTENERS ON THE HANGER TEE BOLTS AS FOLLOWS:
 - 4.1 ON THE FRONT 7.00" LONG HANGER TEE BOLT (ITEM #3).
 - 4.1.1 ASSEMBLE THE FRONT ANGLE CLIP (ITEM #8) AND KEPS NUT (ITEM #10) AS SHOWN. (TEETH OF THE KEPS NUT TOWARDS AND TO WITHIN APPROX. 1.50" OF THE TEE BOLT HEAD).
 - 4.1.2 ASSEMBLE ONE KEPS NUT (ITEM #10) AS SHOWN, WITH THE TEETH TOWARDS THE END OPPOSITE THE TEE BOLT HEAD AND APPROX. 4.00" UP ON THE HANGER TEE BOLT THREADS.
 - 4.2 ON THE REAR 7.50" LONG HANGER TEE BOLT (ITEM #4).
 - 4.2.1 ASSEMBLE THE REAR ANGLE CLIP (ITEM #9) AND KEPS NUT (ITEM #10) AS SHOWN. (TEETH OF THE KEPS NUT TOWARDS AND TO WITHIN APPROX. 1.50" OF THE TEE BOLT HEAD).
 - 4.2.2 ASSEMBLE ONE KEPS NUT (ITEM #10) AS SHOWN, WITH THE TEETH TOWARDS THE END OPPOSITE THE TEE BOLT HEAD AND APPROX. 4.00" UP ON THE HANGER TEE BOLT THREADS.
5. INSTALL THE HEAD OF THE FRONT AND REAR HANGER TEE BOLTS IN THE OBOUNDED HOLES IN THE INCLINED SURFACE OF THE BODY STIFFENERS SO THAT THE HEAD OF THE HANGER TEE BOLT IS ORIENTATED AS SHOWN. NEXT,TIGHTEN THE UPPER KEPS NUTS FINGER TIGHT SO THAT THE ANGLE CLIPS ARE PULLED UP UNDER THE BODY STIFFENERS. (POSITION THE CLIPS AS SHOWN SO THAT THE BOTTOM SURFACE OF THE CLIP IS HORIZONTAL).



(A LUVERNE Company)

1200 E. Birch St.

Brandon, SD 57005

548952 SHEET 1 OF 3 JUN 97

INSTALLATION INSTRUCTIONS AND PARTS LIST

SERVICE PARTS LIST

ITEM	PART NO.	QTY	DESCRIPTION
1	548953	1	NERF BAR/BRKT ASSY- LH,SST,D9431SST
2	548954	1	NERF BAR/BRKT ASSY- RH,SST,D9431SST
1	548104	1	NERF BAR/BRKT ASSY- LH,STL,BLK,D9431TB
2	548105	1	NERF BAR/BRKT ASSY- RH,STL,BLK,D9431TB
1	548978	1	NERF BAR/BRKT ASSY- LH,SST,D9532SST
2	548979	1	NERF BAR/BRKT ASSY- RH,SST,D9532SST
1	548139	1	NERF BAR/BRKT ASSY- LH,STL,BLK,D9532TB
2	548140	1	NERF BAR/BRKT ASSY- RH,STL,BLK,D9532TB
1	549028	1	NERF BAR/BRKT ASSY- LH,SST,D98324SST
2	549029	1	NERF BAR/BRKT ASSY- RH,SST,D98324SST
1	548191	1	NERF BAR/BRKT ASSY- LH,STL,BLK,D98324TB
2	549192	1	NERF BAR/BRKT ASSY- RH,STL,BLK,D98324TB
3	548116	2	BOLT- TEE,WELDMENT,3/8-16 X 7.00 LG
4	548120	2	BOLT- TEE,WELDMENT,3/8-16 X 7.50 LG
5	103440	4	BOLT- HEX HEAD CAP,M12-1.75 X 120 MM
6	100121	4	WASHER- LOCK,1/2 IN.
7	100118	4	WASHER- FLAT,1/2 IN.
8	548118	2	ANGLE CLIP-FRONT
9	548122	2	ANGLE CLIP-REAR
10	103462	12	NUT- KEPS,EXTERNAL TOOTH,3/8-16



(A LIVERNE Company)

1200 E. Birch St.

Brandon, SD 57005

548952 SHEET 2 OF 3 OCT 95

SERVICE PARTS LIST

MODEL NO.	-D9431SST	SER
	-D9431TB	SER
	-D9532SST	SER
	-D9532TB	SER
	-D98324SST	SER
	-D98324TB	SER

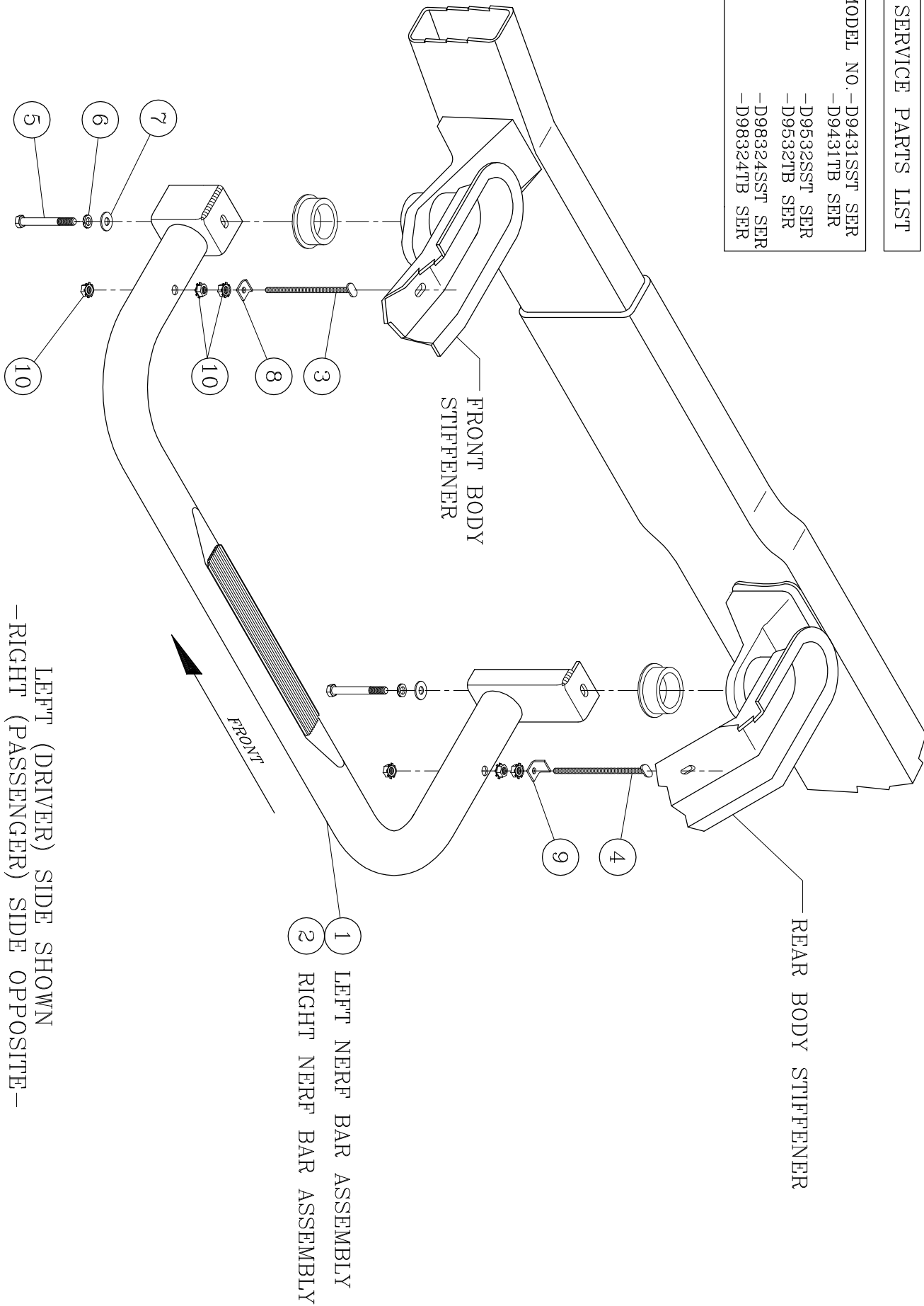

LEFT (DRIVER) SIDE SHOWN
-RIGHT (PASSENGER) SIDE OPPOSITE-