

INSTALLATION INSTRUCTIONS AND PARTS LIST

APPLICATION: MODEL 571300/401300 SES/GRIP ACCESSORY BRACKET ON:
11-16 RAM CREW CAB, CHASSIS CAB DIESEL TRUCKS



1. READ INSTRUCTIONS COMPLETELY AND CHECK TO MAKE SURE THAT ALL REQUIRED PARTS (LISTED ON SERVICE PARTS LIST) ARE ON HAND BEFORE STARTING THE INSTALLATION.
2. **INSTALL THE LH (DRIVER SIDE) CENTER BRACKET AS FOLLOWS.**
3. ON THE VERTICAL WALL OF THE ROCKER PANEL, INSTALL THE T-BOLT WELMENT (ITEM #2) INTO THE LARGE OBOURND HOLE AND FISH THE OTHER END THROUGH THE 1/2" HEXAGON HOLE SHOWN IN FIG. 1. **USE CAUTION NOT TO DROP THE T-BOLT INSIDE OF THE ROCKER PANEL.** ATTACH THE FLAT NYLON WASHER (ITEM #4) TO THE END OF EACH BOLT. (THIS IS A RETAINER.)
4. POSITION THE MOUNTING BRACKET (ITEM #1) SO THAT THE HOLES IN THE BRACKETS LINE UP WITH THE THREADED STUDS ON THE INSIDE WALL OF THE ROCKER PANEL. INSTALL THE 3/8-16 SERRATED FLANGE NUTS (ITEM #3). TIGHTEN BRACKET FASTENERS TO 19 LB FT.

SERVICE PARTS LIST

ITEM	PART NO.	QTY	DESCRIPTION
1	552146	1	BRKT-MTG, GRIP/REGAL 7, RAM DIESEL CHASSIS CAB
1	551656	1	BRKT-MTG, MS/SES, RAM DIESEL CHASSIS CAB
2	550147	1	T-BOLT WELDMENT, ZP
3	100181	2	NUT – HEX FLNG, 3/8-16, ZP
4	108442	2	WASHER – NYL, .360 X 1.5 X .032, BLK



(A LIVERNE Company)

1200 E. Birch St.

Brandon, SD 57005

552842 SHEET 1 OF 2 20NOV15

SERVICE PARTS LIST

MODEL NO. -401300/571300

FIG. 1

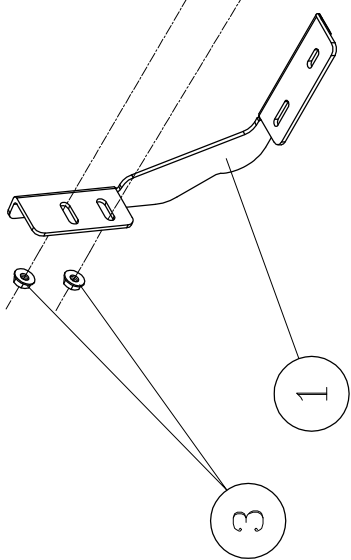

GRIP/REGAL 7 BRACKET
552146

MS/SES BRACKET
551656

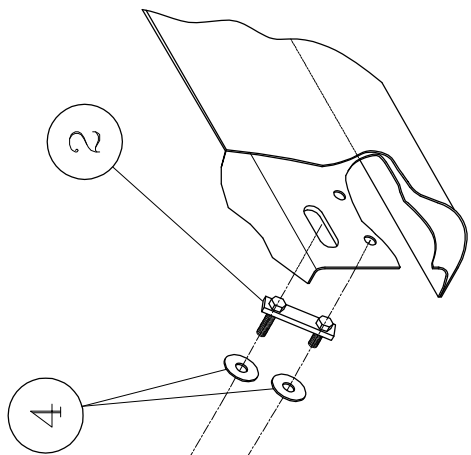

CENTER MOUNTING LOCATION

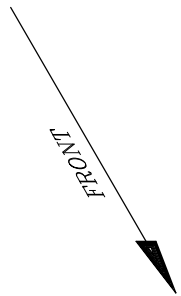
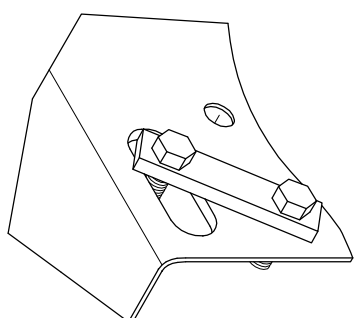

1200 E. Birch St. Brandon, MS 37005