

INSTALLATION INSTRUCTIONS AND PARTS LIST

MODEL 571347 MEGA STEPS

VEHICLE APPLICATION:

2003 AND NEWER 155" WB CHEVROLET EXPRESS AND GMC SAVANA VANS

READ INSTRUCTIONS COMPLETELY AND CHECK TO MAKE SURE THAT ALL REQUIRED PARTS (LISTED ON SERVICE PARTS LIST) ARE ON HAND BEFORE STARTING THE INSTALLATION

1. ON THE RIGHT SIDE OF THE VEHICLE, REMOVE THE FRONT BODY MOUNTING BOLT. THE BOLT, STEEL WASHER AND RUBBER CUSHION WILL BE REUSED.
2. INSTALL THE MULTI-THREAD U-NUT (ITEM #10) ON THE FRONT MOUNTING BRACKET (ITEM #5). **(NOTE: INSTALL IN THE BOTTOM HOLE FOR 2500 & 3500 VANS.)**
3. INSTALL THE FRONT MOUNTING BRACKET (ITEM #5) TO THE FRONT BODY MOUNT WITH THE WASHER AND THE RUBBER CUSHION BETWEEN THE MOUNTING BRACKET AND THE BODY MOUNT. THE STEP END OF THE BRACKET SHOULD BE PERPENDICULAR TO THE OUTSIDE BODY. TIGHTEN THE BOLT TO 65 LB. FT
4. INSTALL A 3/8"-16 SERRATED FLANGE NUT (ITEM #9) ON THE 3/8"-16 X 5" HEX BOLT (ITEM #8) WITH THE FLANGE FACING TOWARD THE END OF THE BOLT AND TURN ON JUST SHORT OF THE HEAD. SCREW THE BOLT INTO THE U-NUT AND WHEN IT COMES THROUGH THE OTHER SIDE START ANOTHER FLANGE NUT FACING THE SAME DIRECTION AS THE FIRST NUT. TURN THE NUT ON UNTIL THERE IS 3/4" PROTRUDING FROM THE FACE OF THE NUT, INSTALL A 3/8" FLAT WASHER (ITEM #11) AND THE .354 X 1.00 X .748 RUBBER WASHER (ITEM #12) ONTO THE END OF THE BOLT. ADJUST THE LOAD REACTION BOLT ASSEMBLY SO THAT THE RUBBER CUSHION IS SNUG AGAINST THE FRAME AND TIGHTEN DOWN THE OUTSIDE FLANGE NUT. **(LOAD REACTION BOLT ASSEMBLY)** AS SHOWN IN *fig. 1*.
5. REMOVE THE SECOND BODY MOUNTING BOLT. THE BOLT, STEEL WASHER AND RUBBER CUSHION WILL BE REUSED.
6. INSTALL THE MULTI-THREAD U-NUT (ITEM #10) ON THE SECOND MOUNTING BRACKET (ITEM #4). INSTALL A 3/8"-16 SERRATED FLANGE NUT (ITEM #9) ON THE 3/8"-16 X 1-3/4" HEX BOLT (ITEM #13) WITH THE FLANGE FACING TOWARD THE END OF THE BOLT AND TURN ON JUST SHORT OF THE HEAD. SCREW THE BOLT INTO THE U-NUT AND WHEN IT COMES THROUGH THE OTHER SIDE INSTALL A .364 X .625 CAP PLUG (ITEM #13) ONTO THE END OF THE BOLT. **(NOTE: INSTALL IN THE BOTTOM HOLE FOR 2500 & 3500 VANS.)**
7. INSTALL THE SECOND MOUNTING BRACKET (ITEM #4) TO THE SECOND BODY MOUNT WITH THE WASHER AND THE RUBBER CUSHION BETWEEN THE MOUNTING BRACKET AND THE BODY MOUNT. THE STEP END OF THE BRACKET SHOULD BE PERPENDICULAR TO THE OUTSIDE BODY. TIGHTEN THE BOLT TO 65 LB. FT.
8. ADJUST THE LOAD REACTION BOLT ASSEMBLY SO THAT THE RUBBER PLUG IS SNUG AGAINST THE FRAME AND TIGHTEN DOWN THE OUTSIDE FLANGE NUT. **(LOAD REACTION BOLT ASSEMBLY)** AS SHOWN IN *fig. 1*.
9. REPEAT STEPS 13 THRU 16 FOR THE THIRD MOUNTING BRACKET (ITEM #6) **EXCEPT, INSTALL THE U-NUT IN THE TOP HOLE OF THE BRACKET FOR THE 2500 & 3500 VANS**



(A LIVERNE Company)

1200 E. Birch St.

Brandon, SD 57005

552543 SHEET 1 OF 3 07JUL14

10. REMOVE THE NUT AND WASHER FROM THE FRONT SPRING SHACKLE BOLT. SAVE THE NUT TO BE REUSED. INSTALL THE BLACK SPACER WASHER (ITEM #15), MOUNTING BRACKET (ITEM #7), 5/8" FLAT WASHER (ITEM #12) AND THE FACTORY NUT ONTO THE SPRING SHACKLE BOLT.
 11. AFTER MOUNTING THE 1st, 2nd AND 3rd BRACKET, MEASURE FROM THE BOTTOM OF THE BODY FLANGE DOWN TO THE BOTTOM OF THE MOUNTING BRACKETS TO MAKE SURE THEY ARE THE SAME, AND WHEN INSTALLING THE 4th BRACKET ADJUST IT TO THIS DIMENSION BEFORE TIGHTENING THE BOLTS. ONCE ADJUSTED TIGHTEN THE NUT TO 65 LB. FT.
 12. FOR THE LEFT SIDE OF THE VEHICLE REPEAT STEPS 1 THRU 8.
- ATTACHING THE BOARDS TO THE MOUNTING BRACKETS**
13. FOR THE 36" MEGA STEP INSTALL TWO (2) SQUARE HEAD SCREWS, 5/16"-18 X 1" (ITEM #16) IN THE FRONT TRACK OF THE STEP PLATE. FOR THE 114" MEGA STEP INSTALL FOUR (4) SQUARE HEAD SCREWS, 5/16"-18 X 1" (ITEM #16) IN THE FRONT TRACK OF THE STEP PLATE.
 14. POSITION THE MEGA STEP ON THE MOUNTING BRACKETS SO THAT THE SQUARE HEAD SCREWS ARE LOCATED IN THE SLOTS OF THE MOUNTING BRACKETS AND THE STEP IS CENTERED, FRONT TO REAR, ON THE VEHICLE. INSTALL 5/16" SERRATED FLANGE NUTS (ITEM #17) ON THE SQUARE HEAD SCREWS. FINGER TIGHTEN ONLY AT THIS TIME.
 15. ALIGN THE STEP PLATE WITH THE BOTTOM OF THE BODY SHEET METAL. THE TOP OF THE STEP SHOULD BE APPROXAMATELY 2-1/2" FROM THE BOTTOM OF THE BODY PANEL.
 16. TIGHTEN THE STEP PLATE BOLTS TO 19 FOOT POUNDS OF TORQUE.

SERVICE PARTS LIST

ITEM	PART NO.	QTY	DESCRIPTION
1	571347-114"	1	MEGA STEP ASSY- 114.00"
2	571347-36"	1	MEGA STEP ASSY- 36"
3	552100	1	MOUNTING BRACKET – LH, FRONT
4	552264	2	MOUNTING BRACKET – RH, CENTER / LH, REAR
5	552101	1	MOUNTING BRACKET – RH, FRONT
6	552263	1	MOUNTING BRACKET – RH, CENTER
7	552107	1	MOUNTING BRACKET – REAR, RH
8	109474	2	SCREW – HHC, 3/8-16 X 5 , FT, ZP
9	100181	7	NUT-SER FLG, 3/8-16, ZP
10	109258	5	U-NUT, MULTI THREAD, 3/8-16 X 1.09
11	106962	2	WASHER-FLAT, 3/8, SST, BZP
12	102592	2	WASHER-RUBBER, .354 X 1.00 X .748
13	107211	3	SCREW – HWHC, 3/8-16 X 1-3/4, BLACK, ZP
14	103325	3	CAP – PLUGS, .364 X .625 VINYL, BLACK
15	100147	1	WASHER – FLAT, 5/8, ZP
16	106880	14	SCREW – SQUARE HEAD, 5/16 – 3/4
17	102680	14	NUT – SER FLG, SST, 5/16-18



(A LUVERNE Company)

1200 E. Birch St.

Brandon, SD 57005

552543 SHEET 2 OF 3 07JUL14

SERVICE PARTS LIST

MODEL NO. - 571347

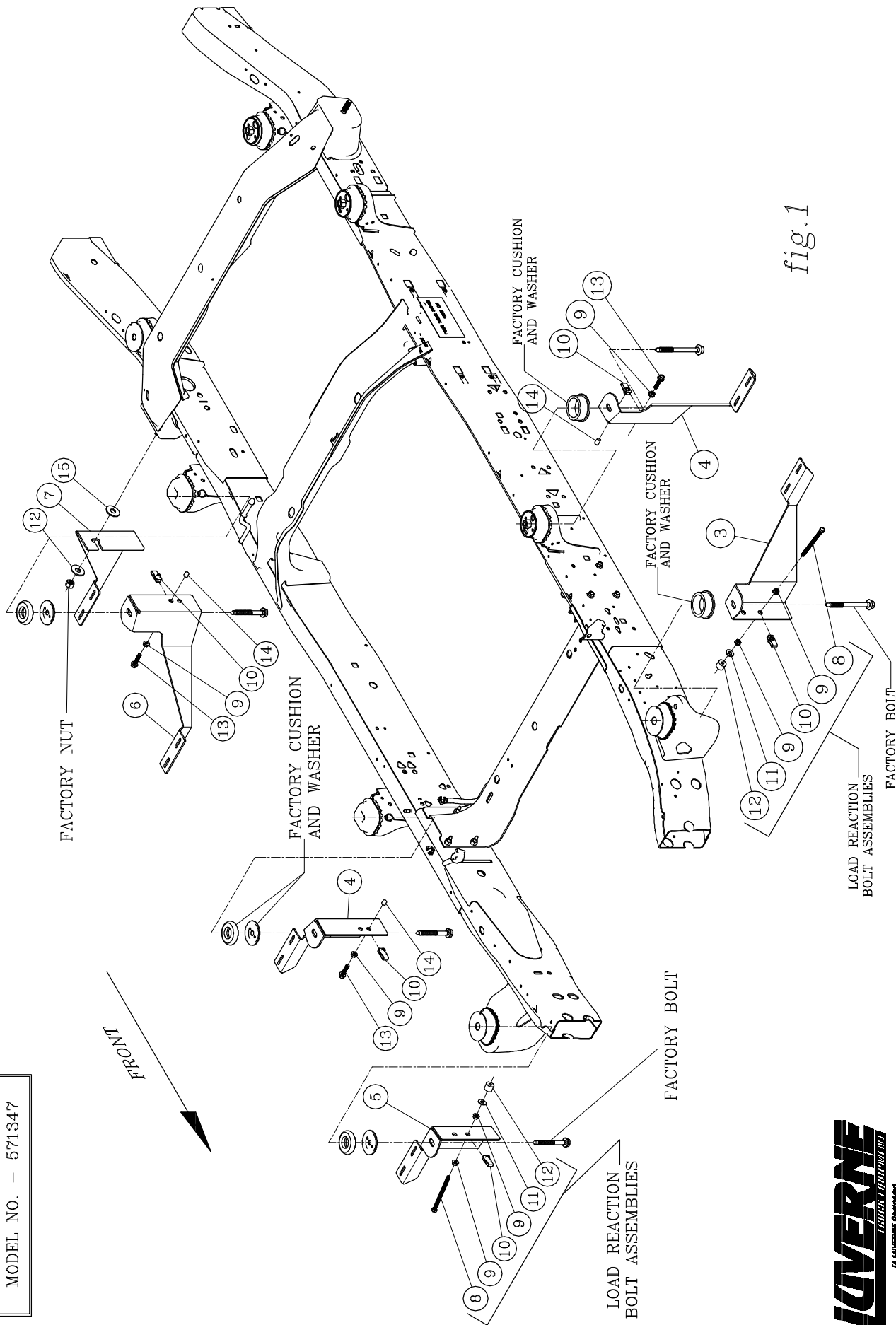

LIVERNE
LIGHT TOWER

(A LIVERNE COMPANY)

1200 E. 10th St. Brandon, SD 57005