

INSTALLATION INSTRUCTIONS AND PARTS LIST

MODEL 583054, 583060, 584054 O-MEGA II 6" OVAL STEPS

1. READ INSTRUCTIONS COMPLETELY AND CHECK TO MAKE SURE THAT ALL REQUIRED PARTS (LISTED ON THE SERVICE PARTS LIST) ARE ON HAND BEFORE STARTING THE INSTALLATION.
2. FOLLOW THE INSTRUCTIONS INCLUDED WITH THE SPECIFIC BRACKET PACKAGE THAT YOU ARE USING, TO MOUNT THE BRACKETS TO YOUR VEHICLE.
3. BEFORE ATTACHING THE O-MEGA STEPS TO THE BRACKETS, PLACE THE STEP PADS (ITEM #2) ON TOP OF THE STEP PLATES. USE THE TABLE ON SHEET #2, AS A GUIDE TO POSITION THE STEP PAD FOR YOUR PARTICULAR VEHICLE. WHEN INSTALLING THE PADS ON THE STEPS, DRILL (5) 1/8" HOLE USING THE STEP PAD AS A GUIDE. ATTACH WITH (5) 8-18X1/2" TEK SCREWS (ITEM #6) PROVIDED. REPEAT FOR ALL STEP PADS.
4. INSTALL THE REQUIRED NUMBER OF SQUARE HEAD BOLTS INTO THE DESIGNATED SLOTS IN THE BOTTOM OF THE STEP PLATES.
5. INSTALL THE END CAPS (ITEM #3) AS SHOWN IN *fig. 1* SNUG UP THE NUTS. BE CAREFUL NOT TO DEFORM THE PLASTIC
6. POSITION THE O-MEGA STEP ON THE MOUNTING BRACKETS SO THAT THE SQUARE HEAD SCREWS (ITEM #4) ARE LOCATED IN THE SLOTS OF THE MOUNTING BRACKETS AND THE STEP IS CENTERED, FRONT TO REAR, ON THE VEHICLE. INSTALL 5/16" SERRATED FLANGE NUTS (ITEM #5) ON THE SQUARE HEAD SCREWS (ITEM #4) AND TIGHTEN TO 19 LB FT.

SERVICE PARTS LIST

ITEM	PART NO.	QTY	DESCRIPTION
1	553069	2	EXTRUSION-AL,51.0,OMEGA STP,SILVER
1	553057	2	EXTRUSION-AL,51.0,OMEGA STP,BLACK
1	553070	2	EXTRUSION-AL,57.0,OMEGA STP,SILVER
2	552970	4	ALUM,STP-PAD,BLK,OMEGA-STEPS
3	107956	4	CAP-END,PLSTC,2.95 X 6.70
4	106880	20	SCREW-SQ HD,5/16-18 X 1,MAGNIGUARD
5	102680	20	NUT-SERR FLG,HX,SST,WX,5/16-18
6	107958	20	SCREW-PPH,TEK,#8-18 X 1/2",SST,BZP



STEP PAD LOCATION GUIDE

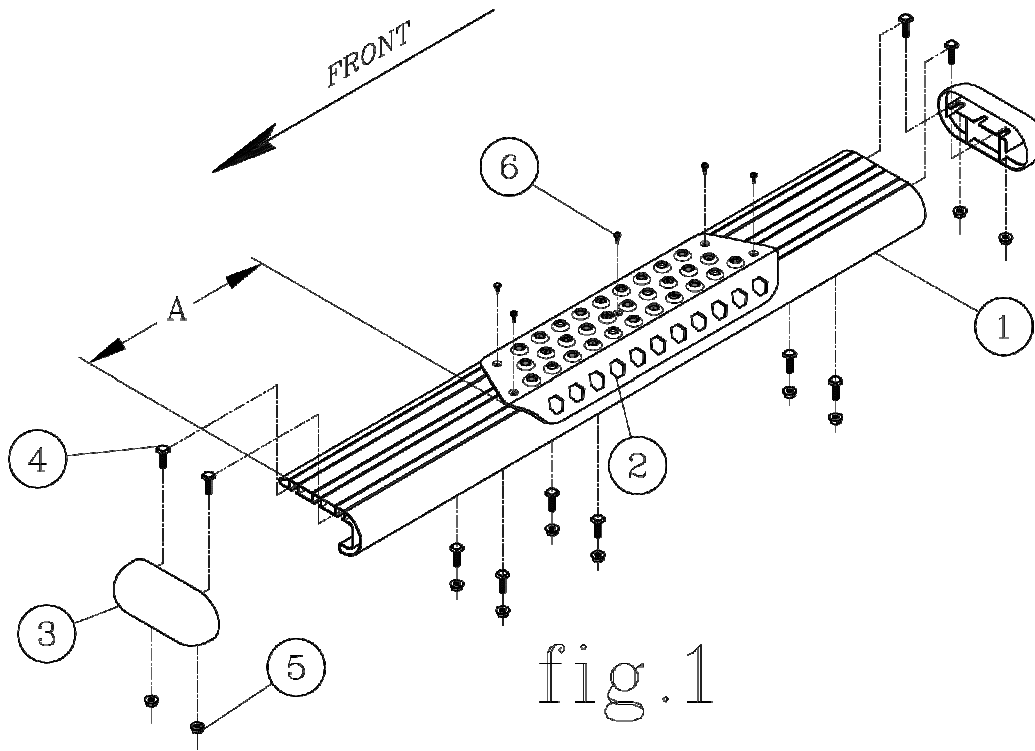

fig.1

VEHICLE MODEL	PAD A	PAD B
SILVERADO/SIERRA REGULAR CAB	14-3/4	N/A
DODGE RAM REGULAR CAB	10-1/2	N/A
FORD F150 REGULAR CAB	18-1/4	N/A
FORD SUPER DUTY REGULAR CAB	6-7/8	N/A
TUNDRA REGULAR CAB	6-1/2	N/A
TOYOTA FJ CRUSIER	6-1/2	N/A
FORD ESCAPE	5-1/2	35-1/2

NOTE: THE ABOVE PAD LOCATIONS ARE ONLY SUGGESTIONS AND MAY BE PLACED AT THE PURCHASERS DISCRETION. (THE 2008-2012 FORD ESCAPE WILL USE 2 PADS PER SIDE ON THE 585060 BOARDS).



INSTALLATION INSTRUCTIONS
08-11 FORD ESCAPE, MEGA AND O-MEGA BRACKETS,
570826

PLEASE READ INSTRUCTIONS BEFORE INSTALLING

1. MOUNT THE REAR BRACKET TO THE BOTTOM OF TRUCKS FRAME BY PLACING THE T-BOLT (ITEM #4) UP AND THROUGH THE BIGGER ROUND HOLE NEXT TO THE MOUNTING HOLES ON THE UNDERSIDE OF FRAME RAIL. **SEE FIG 2.**
2. ONCE THE T-BOLT HAS BEEN INSTALLED PLACE REAR BRACKET (ITEM #3) UP TO THE BOTTOM OF FRAME RAIL SO THAT THE BOLT AND NUT OF THE T-BOLT LINE UP WITH THE HOLE PATTERN ON THE BRACKET PLACE ON FASTENERS (ITEMS # 7,8,9&10). TIGHTEN FASTENERS.
3. REMOVE THE (2) FACTORY BOLTS (THESE WILL BE REUSE) ON THE FRONT OF THE FRAME RAIL. **SEE FIG 1.**
4. PLACE FRONT BRACKET (ITEM #2) UP TO FRAME RAIL LINING UP HOLE PATTERN WITH THE HOLE PATTERN OF THE TRUCK. REPLACE FACTORY BOLTS. TIGHTEN ALL FASTENERS.
5. REMOVE THE PLASTIC SIDE PANEL LOCATED BY THE DOOR SILL OPENING BY REMOVING (2) PLASTIC PUSH PLUGS, LIFT CARPET UP AND PUSH RUBBER BODY PLUG OUT THROUGH BOTTOM OF THE FLOOR PAN.
6. PLACE A WASHER (ITEM #7) AND BOLT (ITEM #9) DOWN THROUGH FLOOR PAN.
7. FROM UNDER THE VEHICLE, PLACE BRACKET (ITEM #15) OVER BOLT AND PLACE ON NUT (ITEM #14).
8. ATTACH THE 2 BRACKETS TOGETHER WITH SCREW, WASHER AND NUT (ITEMS #13, 12, AND 11) AND TIGHTEN.
9. TIGHTEN ALL FASTENERS AND REPLACE CARPET AND PLASTIC COVER.
10. ATTACH THE STEP (ITEM #1) TO THE MOUNTING BRACKETS.
 - a. INSERT (2) 5/16" SQUARE HEAD SCREWS (ITEM #5) IN THE CENTER SLOT ON THE UNDER SIDE OF THE STEP.
 - b. POSITION THE STEP ON THE MOUNTING BRACKETS SO THAT THE SQUARE HEAD SCREWS ARE LOCATED IN THE SLOTS OF THE MOUNTING BRACKETS AND THE STEP IS CENTERED, FRONT TO REAR, ON THE VEHICLE.
 - c. LOCATE THE STEP, IN AND OUT, AS DESIRED, INSTALL 5/16" SERRATED FLANGE NUTS (ITEM #6) ON THE SQUARE HEAD SCREWS AND TIGHTEN TO 19 LB FT.



PARTS LIST

ITEM	PART NO.	QTY	DESCRIPTION
1	575060	2	MEGA STEP BOARD
1	585060	2	O-MEGA STEP,BOARD,SATIN
2	551914	1	BRACKET-MTG,FRONT,LH,570826
3	551916	1	BRACKET-MTG,REAR,LH,570826
2	551915	1	BRACKET-MTG,FRONT,RH,570826
3	551917	1	BRACKET-MTG,REAR,RH,570826
4	551922	2	T-BOLT,WELDMENT,ZP
5	106880	4	SCREW- SQUARE HEAD, 5/16-18 UNC
6	102680	4	NUT- SERRATED FLANGE, HEX, SST, 5/16-18 UNC
7	105909	4	WASHER-FL, 2.00 X .509 X .179,ZP
8	100123	2	NUT-HEX FLG,1/2-13,ZP
9	100069	4	SCR-HEX HD,7/16-14 X 1 ¼,ZP
10	100078	2	WASHER-LOCK,7/16,ZP
11	100181	2	NUT-HEX FLG, 3/8-16, ZP
12	100062	4	WSHR-FL, 3/8, ZP
13	100040	2	SCR-HEX HD, 3/8-16 X 1.00, ZP
14	103737	2	NUT-HEX FLG, 7/16-14, ZP
15	201760	2	BRKT-MTG, URT, 4 X 2, C0300THD



(A LUVERNE Company)

1200 E. Birch St.

Brandon, SD 57005

REV LEVEL A 16JUN11
551920 SHEET 2 OF 3 04NOV10

SERVICE PARTS LIST

MODEL NO. - 570826

LUVERNE LOGO SHOULD BE TOWARD REAR OF VEHICLE

1 RIGHT HAND STEP
LEFT HAND STEP

SQUARE HEAD SCREWS MUST BE INSTALLED IN CENTER AND FRONT SLOTS FROM END OF STEP

REMOVE DOOR SILL SIDE COVER AND LIFT CARPET

REMOVE BODY PLUG

FACTORY BOLTS (REUSED)

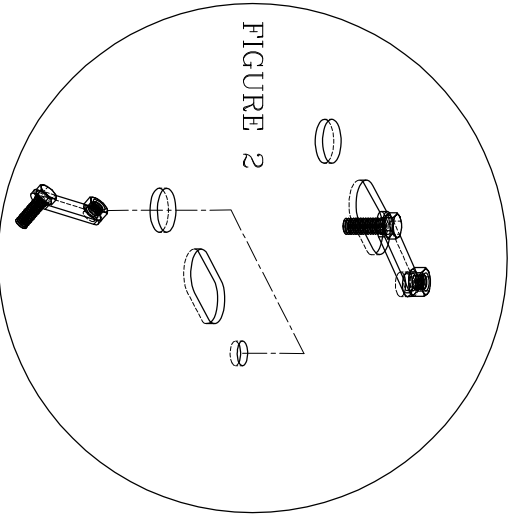
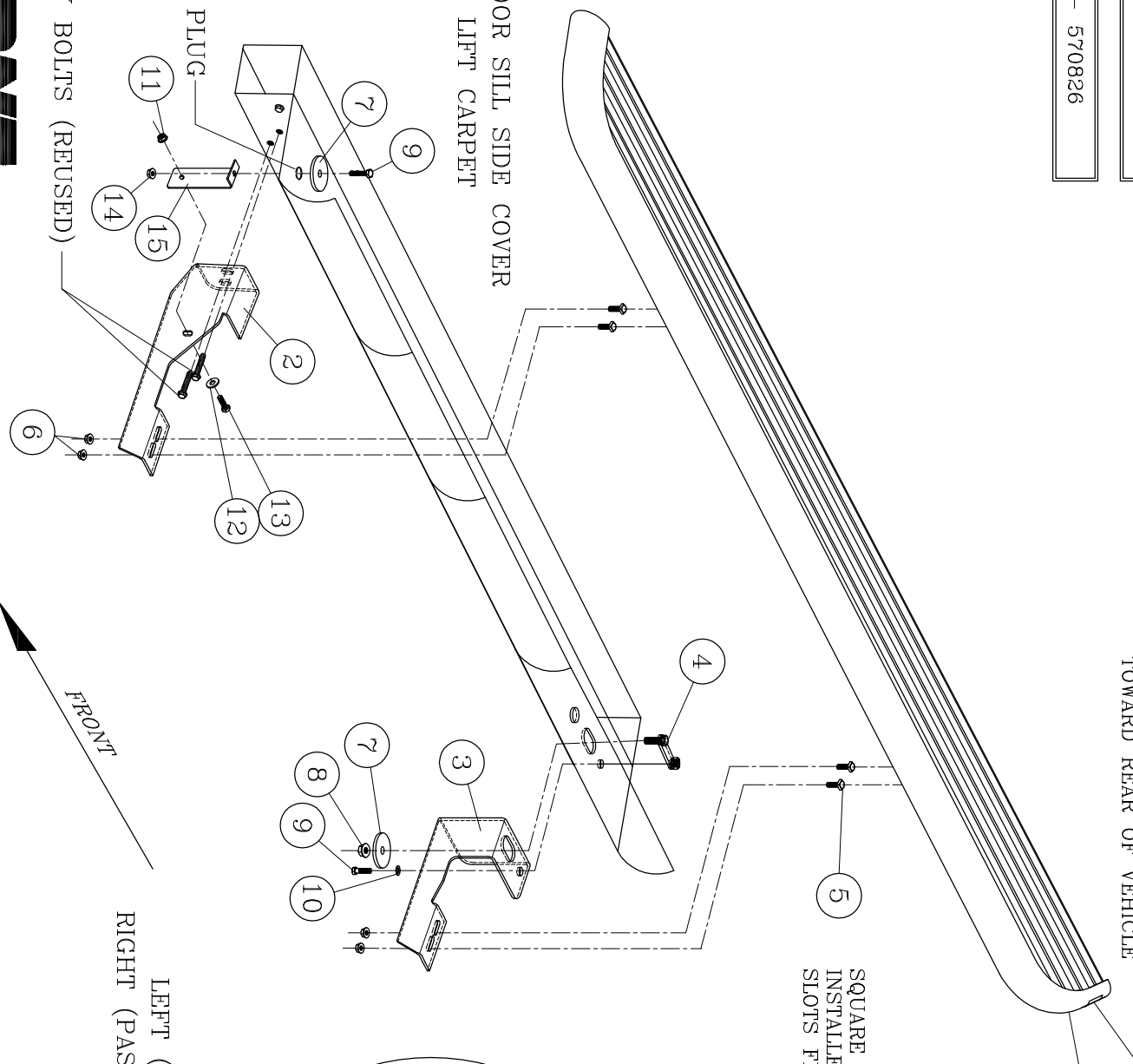

LEFT (DRIVER) SIDE SHOWN
RIGHT (PASSENGER) SIDE OPPOSITE



(A LUVERNE Company)

1200 E. Birch St.
Brandon, SD 57005

REVISION LEVEL A 16JUN11
551920 SHEET 2 OF 2 04NOV10