

INSTALLATION INSTRUCTIONS AND PARTS LIST

MODEL: 583098, 583102, 583108, 583114, 583125, 584098, 584102, 584114, 584125 O-MEGA II 6" OVAL
STEPS
UNIVERSAL APPLICATION

1. READ INSTRUCTIONS COMPLETELY AND CHECK TO MAKE SURE THAT ALL REQUIRED PARTS (LISTED ON THE SERVICE PARTS LIST) ARE ON HAND BEFORE STARTING THE INSTALLATION.
2. FOLLOW THE INSTRUCTIONS INCLUDED WITH THE SPECIFIC BRACKET PACKAGE THAT YOU ARE USING, TO MOUNT THE BRACKETS TO YOUR VEHICLE.
3. BEFORE ATTACHING THE O-MEGA STEPS TO THE BRACKETS, PLACE THE STEP PADS (ITEM #2) ON TOP OF THE STEP PLATES. USE THE TABLE ON SHEET #2, AS A GUIDE TO POSITION THE STEP PAD FOR YOUR PARTICULAR VEHICLE. WHEN INSTALLING THE PADS ON THE STEPS, DRILL (5) 1/8" HOLE USING THE STEP PAD AS A GUIDE. ATTACH WITH (5) 8-18X1/2" TEK SCREWS (ITEM #6) PROVIDED. REPEAT FOR ALL STEP PADS. (NOTE: DUE TO THE SHORTNESS OF SOME BOXES, MOUNT THE BOX STEP PAD FIRST, APPROXIMATELY 1/2" FROM THE END CAP AND THEN MOUNT THE MIDDLE STEP PAD ACCORDINGLY.)
4. INSTALL THE REQUIRED NUMBER OF SQUARE HEAD BOLTS INTO THE DESIGNATED SLOTS IN THE BOTTOM OF THE STEP PLATES.
5. INSTALL THE END CAPS (ITEM #3) AS SHOWN IN *fig. 1*, TIGHTENING THE NUTS TO 5 LB FT.
6. POSITION THE O-MEGA STEP ON THE MOUNTING BRACKETS SO THAT THE SQUARE HEAD SCREWS (ITEM #4) ARE LOCATED IN THE SLOTS OF THE MOUNTING BRACKETS AND THE STEP IS CENTERED, FRONT TO REAR, ON THE VEHICLE. INSTALL 5/16" SERRATED FLANGE NUTS (ITEM #5) ON THE SQUARE HEAD SCREWS (ITEM #4) AND TIGHTEN TO 19 LB FT.

SERVICE PARTS LIST

ITEM	PART NO.	QTY	DESCRIPTION
1	553074	2	EXTRUSION-AL,95.0,OMEGA STP,SILVEER
1	553075	2	EXTRUSION-AL,99.0,OMEGA STP,SILVER
1	553076	2	EXTRUSION-AL,105.0,OMEGA STP,SILVER
1	553077	2	EXTRUSION-AL,111.0,OMEGA STP,SILVER
1	553078	2	EXTRUSION-AL,122.0,OMEGA STP,SILVER
1	553062	2	EXTRUSION-AL,95.0,OMEGA STP,BLACK
1	553063	2	EXTRUSION-AL,99.0,OMEGA STP,BLACK
1	553065	2	EXTRUSION-AL,111.0,OMEGA STP,BLACK
1	553066	2	EXTRUSION-AL,122.0,OMEGA STP,BLACK
2	107957	6	ALUM,STP-PAD,BLK,OMEGA-STEP
3	107956	4	CAP-END,PLSTC,2.95 X 6.70
4	106880	28	SCREW-SQ HD,5/16-18 X 1,MAGNIGUARD
5	102680	28	NUT-SERR FLG,HX,SST,WX,5/16-18
6	107958	30	SCREW-PPH,TEK,#8-18 X 1/2",SST,BZP



STEP PAD LOCATION GUIDE

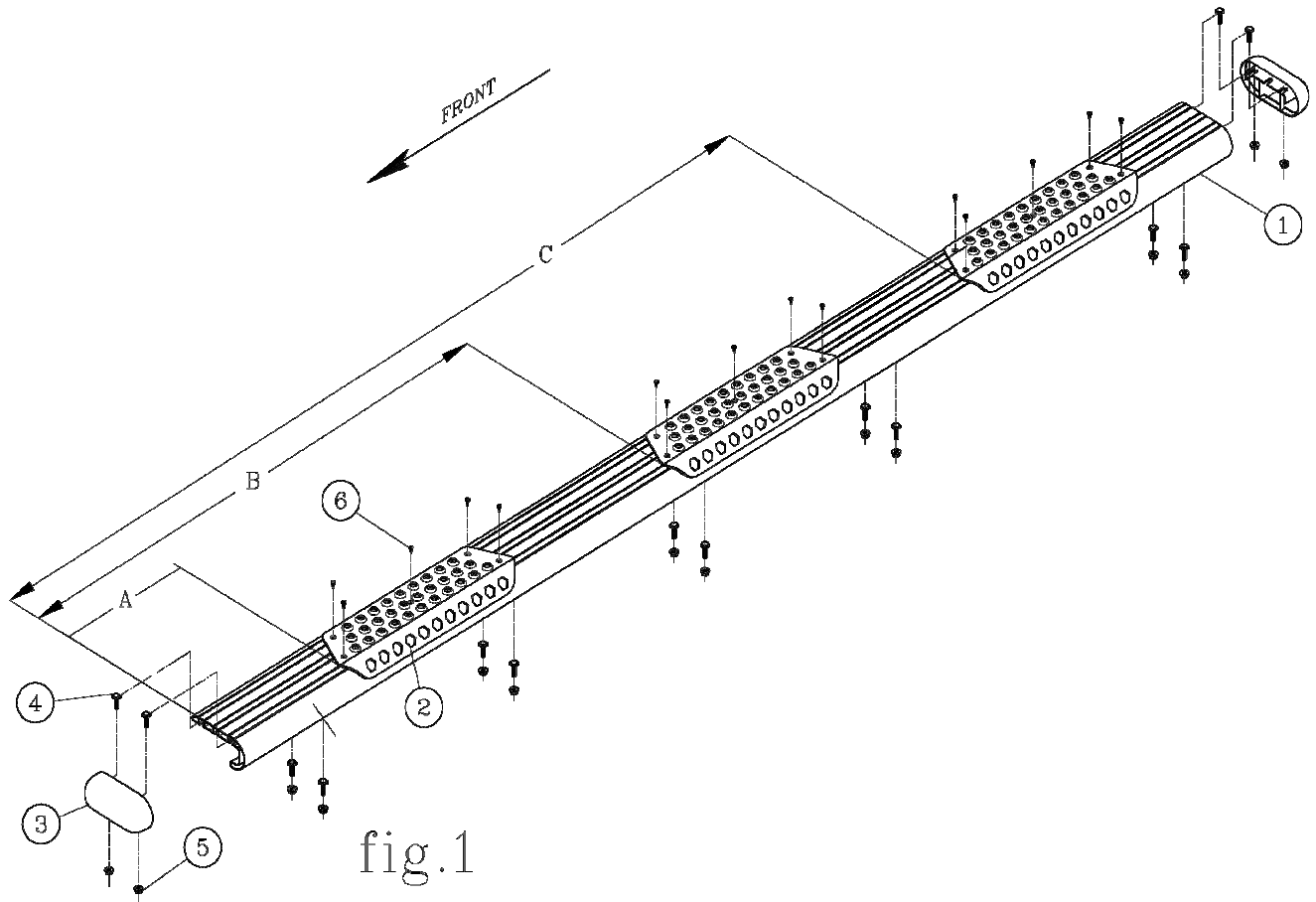

VEHICLE MODEL	PAD A	PAD B
SILVERADO/SIERRA DOUBLE CAB	14-3/4	46-3/4
SILVERADO/SIERRA EXTENDED CAB	14-3/4	41-3/4
SILVERADO/SIERRA CREW CAB	14-3/4	54-1/4
CHEVROLET EXPRESS VAN & GMC SAVANA VAN	7-1/2	N/A
RAM QUAD CAB	10-1/2	46
RAM CREW CAB	10-1/2	48
RAM MEGA CAB	10-1/2	52-1/16
FORD F150 SUPER CAB	18-1/4	46-1/4
FORD F150 SUPER CREW CAB	18-1/4	56-1/2
FORD F150 SUPER CREW CAB	18-1/4	56-1/2
FORD SUPER DUTY SUPER CAB	6-7/8	39-1/16
FORD SUPER DUTY CREW CAB	6-7/8	52-7/8
FORD	7-1/2	N/A

NOTE: THE ABOVE PAD LOCATIONS ARE ONLY SUGGESTIONS AND MAY BE PLACED AT THE PURCHASERS DISCRETION.

INSTALLATION INSTRUCTIONS AND PARTS LIST

APPLICATION:

MODEL 571037 W2W MEGA STEPS:
2010 DODGE RAM 2500, 3500 PICKUPS



1. READ INSTRUCTIONS COMPLETELY AND CHECK TO MAKE SURE THAT ALL REQUIRED PARTS (LISTED ON THE SERVICE PARTS LIST) ARE ON HAND BEFORE STARTING THE INSTALLATION.
2. ATTACH THE MOUNTING BRACKETS TO THE CAB OF THE VEHICLE AS FOLLOWS:
 - 2.1 ON THE VERTICAL WALL OF THE ROCKER PANEL, INSTALL THE T-BOLT WELMENT (ITEM #3) INTO THE LARGE OBOUNDED HOLE AND FISH THE OTHER END THROUGH THE FORWARD 1/2" HEXAGON HOLE **BE CAREFULL NOT TO DROP THE T-BOLT INSIDE OF THE ROCKER PANEL.** ATTACH THE FLAT NYLON WASHER (ITEM #5) TO THE THREADED END OF EACH BOLT. (THIS IS TO BE USED AS A RETAINER.)
 - 2.2 POSITION THE MOUNTING BRACKET (ITEM #2) SO THAT THE HOLES IN THE BRACKET LINE UP WITH THE THREADED STUDS ON THE INSIDE WALL OF THE ROCKER PANEL. INSTALL THE 3/8-16 SERRATED FLANGE NUTS (ITEM #4). TIGHTEN BRACKET FASTENERS TO 19 LB FT.
3. PREPARE THE MEGA STEP PLATE FOR MOUNTING BY INSERTING THREE (4) 5/16" SQUARE HEAD SCREWS (ITEM #6) IN THE CENTER SLOT ON THE UNDER SIDE OF THE STEP.
4. POSITION THE MEGA STEP ON THE MOUNTING BRACKETS SO THAT THE SQUARE HEAD SCREWS ARE LOCATED IN THE SLOTS OF THE MOUNTING BRACKETS AND THE STEP IS CENTERED, FRONT TO REAR, ON THE VEHICLE. INSTALL 5/16" SERRATED FLANGE NUTS (ITEM #7) ON THE SQUARE HEAD SCREWS AND TIGHTEN TO 19 LB FT.
5. ATTACH THE MOUNTING BRACKETS TO THE SHACKLE MOUNT OF THE VEHICLE AS FOLLOWS:
 - 5.1 ATTACH THE UPPER MOUNTING BRACKET (ITEM#9) TO THE TOP OF THE LEAF SPRING SHACKLE MOUNT BY USING THE 1/2" HOLE LOCATED ON THE TOP OF THE SPRING MOUNT. PLACE 1/2" BOLT AND WASHER (ITEMS# 11&12) THROUGH THE BRACKET DOWN THROUGH SPRING MOUNT AND PLACE 1/2" NUT (ITEM# 16) ON BACKSIDE FINGER TIGHT. THE BRACKET WILL SIT AT A 15 DEGREE ANGLE.
 - 5.2 PLACE LOWER BRACKET (ITEM# 8) UP BEHIND THE UPPER BRACKET. SO THAT THE LOWER BRACKET SITS LEVEL TO THE MEGA STEP PLATE. USE THE TOP CENTER HOLE IN UPPER BRACKET AND THE BOTTOM HOLE ON THE BRACKET THAT WILL ALLOW LOWER BRACKET TO SIT LEVEL. INSTALL THE 3/8" BOLT, WASHER AND NUT (ITEMS # 10,15&4) TO AFFIX BRACKETS TOGETHER. TIGHTEN TO 19 LBS FT.
6. ASSEMBLE THE LOAD REACTION STUDS AND HARDWARE (ITEM #13 #14 #15 & #4) AS FOLLOWS.
 - 6.1 ON THE SHORT THREADED END OF THE LOAD REACTION STUD (ITEM #13), INSTALL A 3/8" SERRATED FLANGE NUT (ITEM #4) BACKWARDS TO THE BOTTOM OF THE THREAD. THEN, INSTALL A 3/8" FLAT WASHER (ITEM #15) AND RUBBER "CUSHION" WASHER (ITEM #14) TIGHT UP AGAINST THE SERRATED FLANGE NUT, THE END OF THE STUD MUST BE RECESSED IN THE RUBBER WASHER AT LEAST 3/16".
 - 6.2 ON THE LONG THREADED END OF THE STUD, INSTALL A 3/8" SERRATED FLANGE NUT (ITEM #4) BACKWARDS TO NEAR TO THE BOTTOM OF THE THREADS.

LIVERNE
TRUCK EQUIPMENT

(A LIVERNE Company)

1200 E. Birch St.

Brandon, SD 57005

551813 SHEET 1 21DEC09

INSTALLATION INSTRUCTIONS AND PARTS LIST

APPLICATION:

**MODEL 571037 W2W MEGA STEPS:
2010 DODGE RAM 2500, 3500 PICKUPS**

7. ATTACH THE LOAD REACTION STUD ASSEMBLIES TO THE REAR UPPER STEP MOUNTING BRACKET AS SHOWN.
- 7.1 INSERT THE STUD, FROM WHAT WILL BE THE INBOARD OR FRAME SIDE, THRU THE HOLE IN THE UPPER BRACKET THAT IS OPEN ON THE STEP BRACKET SO THAT THE RUBBER WASHER WILL SEAT FIRM AGAINST THE SIDE WALL OF THE SPRING MOUNT. INSTALL A FLANGE NUT ON THE OUTBOARD END OF THE STUD AS SHOWN
- 7.2 TIGHTEN THE LOAD REACTION STUD ADJUSTING NUTS TO 19 LB FT.

SERVICE PARTS LIST

ITEM	PART NO.	QTY	DESCRIPTION
1	575098	1	MEGA STEP W2W ASSEMBLY -98" REG CAB
1	585098	1	O-MEGA STEP W2W ASSEMBLY-98" REG CAB
1	575102	1	MEGA STEP W2W ASSEMBLY-102" CREW CAB
1	585102	1	O-MEGA STEP W2W ASSEMBLY-102" CREW CAB
1	575114	1	MEGA STEP W2W ASSEMBLY-114" MEGA CAB
1	585114	1	O-MEGA STEP W2W ASSEMBLY 114" MEGA CAB
2	551656	6	MOUNTING BRACKET, BLK, DODGE, MEGA STEP
3	550147	6	T-BOLT WELDMENT, ZP
4	100181	22	NUT-SERRATED FLANGE,HEX,3/8-16,ZP
5	108442	12	WASHER-NYLON,.360 X 1.50 X .032
6	106880	8	SCREW-SQUARE HD,5/16-18UNC X 1.00"
7	102680	16	NUT-SERRATED FLANGE, HEX, SST, 5/16-18 UNC
8	551811	2	MOUNTING BRACKET,LOWER,571037
9	551810	2	MOUNTING BRACKET,UPPER,571037
10	100040	4	SCR-HEX HD,3/8-16 X 1.00,ZP
11	100085	2	SCR-HHC,1/2-13 X 1.00,ZP
12	100118	2	WASHER-FLAT,1/2",ZP
13	104673	2	STUD-DBL END,STL,3/8-16 X 5.00,ZP
14	100085	2	WASHER-RUBBER,.354 X 1.00 X .748
15	100062	6	WASHER-FLAT, 3/8",ZP
16	100123	2	NUT-HEX,SERRATED FLANGE, 1/2-13,ZP



1200 E. Birch St.

Brandon, SD 57005

551813 SHEET 2 21DEC09

SERVICE PARTS LIST

BRACKET NO. - 571037



1200 E. Birch St.

551813 SHEET 3 21DEC09

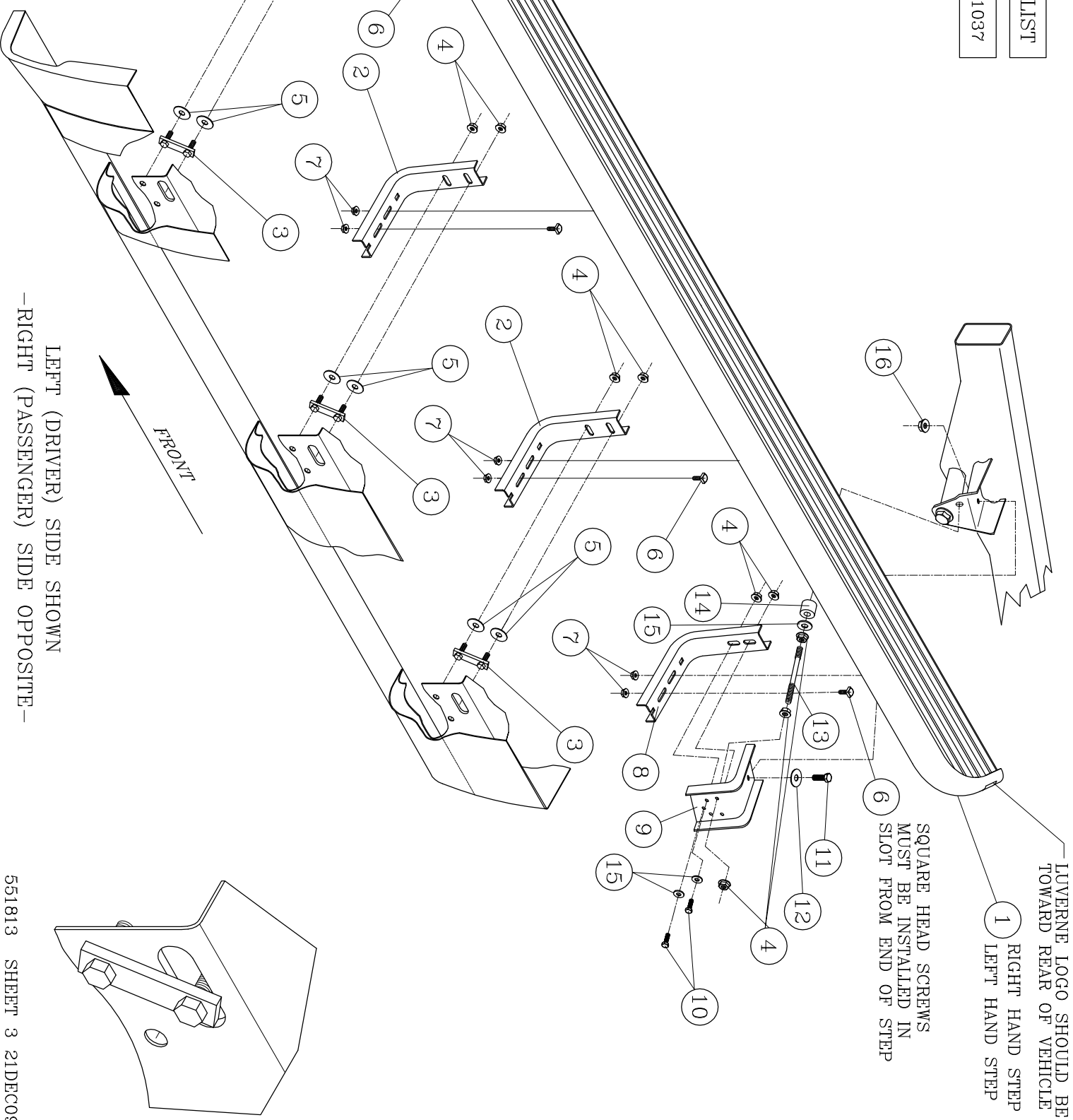

LEFT (DRIVER) SIDE SHOWN
-RIGHT (PASSENGER) SIDE OPPOSITE-

SQUARE HEAD SCREWS
MUST BE INSTALLED IN
SLOT FROM END OF STEP

LUVERNE LOGO SHOULD BE
TOWARD REAR OF VEHICLE
1 RIGHT HAND STEP
LEFT HAND STEP