

INSTALLATION INSTRUCTIONS AND PARTS LIST

MODEL 585054, 585060, 586054 O-MEGA STEPS

1. READ INSTRUCTIONS COMPLETELY AND CHECK TO MAKE SURE THAT ALL REQUIRED PARTS (LISTED ON THE SERVICE PARTS LIST) ARE ON HAND BEFORE STARTING THE INSTALLATION.
2. FOLLOW THE INSTRUCTIONS INCLUDED WITH THE SPECIFIC BRACKET PACKAGE THAT YOU ARE USING, TO MOUNT THE BRACKETS TO YOUR VEHICLE.
3. BEFORE ATTACHING THE O-MEGA STEPS TO THE BRACKETS, MOUNT THE STEP PADS (ITEM #2) TO THE STEP PLATES USING THE 1/2" TEK SCREWS (ITEM #6) PROVIDED. USE THE TABLE ON SHEET #2, AS A GUIDE TO POSITION THE STEP PAD FOR YOUR PARTICULAR VEHICLE. WHEN INSTALLING THE PADS ON THE STEPS, DRILL AND INSTALL THE TWO CENTER SCREWS FIRST. IF INSTALLING THE PADS WHEN THE TEMPERATURE IS AROUND 70° F., MAKE SURE THE SCREWS IN THE END SLOTTED HOLES ARE IN THE MIDDLE OF THE SLOT. WHEN TURNING IN THE SCREWS, TURN THEM IN SNUG THEN BACK OFF A ¼ TURN. PLASTIC WILL EXPAND WHEN IT IS HOT AND CONTRACT WHEN IT GETS COLD AND THE SLOT WILL ALLOW THIS TO HAPPEN WITHOUT RISING UP BETWEEN THE SCREWS.
4. INSTALL THE REQUIRED NUMBER OF SQUARE HEAD BOLTS INTO THE DESIGNATED SLOTS IN THE BOTTOM OF THE STEP PLATES.
5. INSTALL THE END CAPS (ITEM #3) AS SHOWN IN *fig. 1* SNUG UP THE NUTS. BE CAREFUL NOT TO DEFORM THE PLASTIC
6. POSITION THE O-MEGA STEP ON THE MOUNTING BRACKETS SO THAT THE SQUARE HEAD SCREWS (ITEM #4) ARE LOCATED IN THE SLOTS OF THE MOUNTING BRACKETS AND THE STEP IS CENTERED, FRONT TO REAR, ON THE VEHICLE. INSTALL 5/16" SERRATED FLANGE NUTS (ITEM #5) ON THE SQUARE HEAD SCREWS (ITEM #4) AND TIGHTEN TO 19 LB FT.

SERVICE PARTS LIST

| ITEM | PART NO. | QTY | DESCRIPTION |
|------|----------|-----|---------------------------------------|
| 1 | 107959 | 2 | EXTRUSION-AL,51.0,OMEGA STP,585054 |
| 1 | 107960 | 2 | EXTRUSION-AL,57.0,OMEGA STP,585060 |
| 1 | 109985 | 2 | EXTRUSION-AL,51.0,OMEGA STP,586054BLK |
| 2 | 107957 | 4 | PAD-STEP PLATE, 4.50 X 20.00 |
| 3 | 107956 | 4 | CAP-END,PLSTC,2.95 X 6.70 |
| 4 | 106880 | 20 | SCREW-SQ HD,5/16-18 X 1,MAGNIGUARD |
| 5 | 102680 | 20 | NUT-SERR FLG,HX,SST,WX,5/16-18 |
| 6 | 107958 | 24 | SCREW-PPH,TEK,#8-18 X 1/2",SST,BZP |



1200 E. Birch St.

Brandon, SD 57005

REVISED 29JAN16 LVL D
REVISED 14SEP11 LVL C
REVISED 23JUN11 LVL B
REVISED 25APR08 LVL A
551776 SHEET 1 OF 2 09NOV07

STEP PAD LOCATION GUIDE

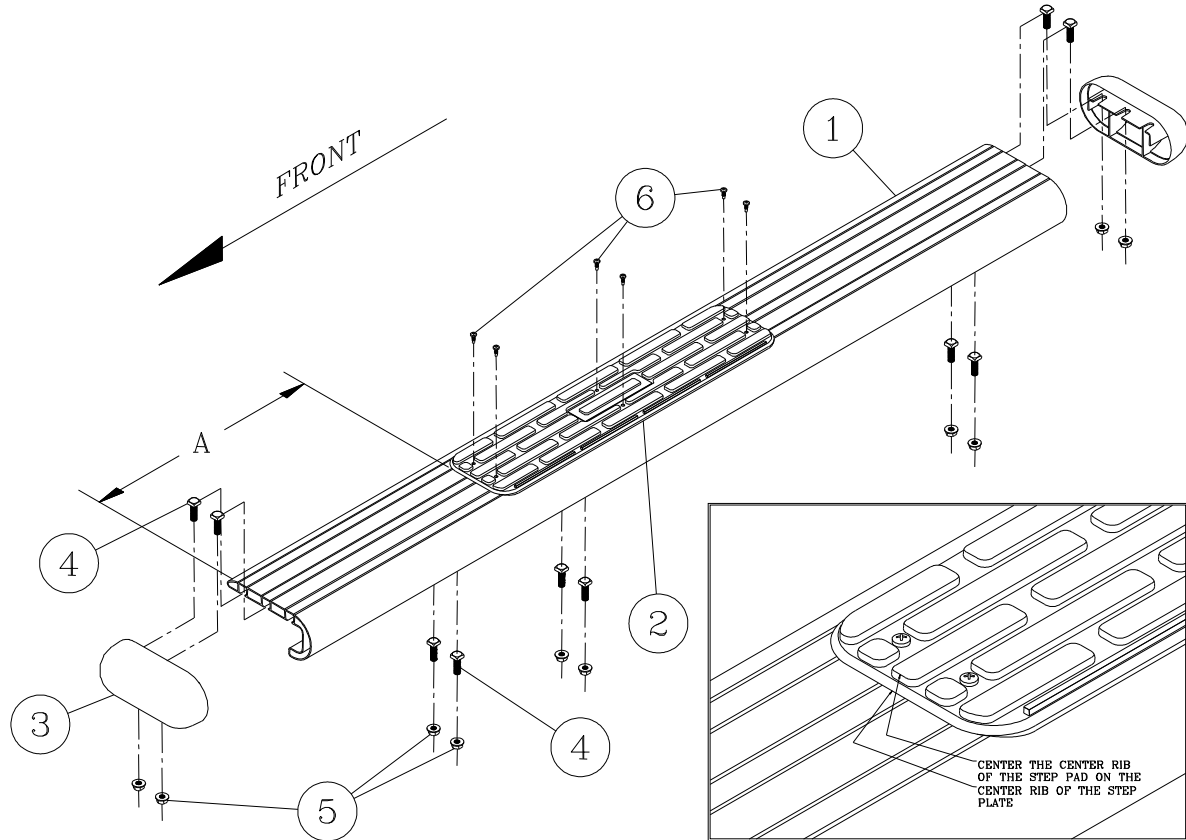

Fig. 1

| VEHICLE MODEL | PAD A | PAD B |
|------------------------------|--------|--------|
| SILVERADO/SIERRA REGULAR CAB | 14-3/4 | N/A |
| DODGE RAM REGULAR CAB | 10-1/2 | N/A |
| FORD F150 REGULAR CAB | 18-1/4 | N/A |
| FORD SUPER DUTY REGULAR CAB | 6-7/8 | N/A |
| TUNDRA REGULAR CAB | 6-1/2 | N/A |
| TOYOTA FJ CRUSIER | 6-1/2 | N/A |
| FORD ESCAPE | 5-1/2 | 35-1/2 |

NOTE: THE ABOVE PAD LOCATIONS ARE ONLY SUGGESTIONS AND MAY BE PLACED AT THE PURCHASERS DISCRETION. (THE 2008-2012 FORD ESCAPE WILL USE 2 PADS PER SIDE ON THE 585060 BOARDS).



1200 E. Birch St.

Brandon, SD 57005

REVISED 29JAN16 LVL D
 REVISED 14SEP11 LVL C
 REVISED 23JUN11 LVL B
 REVISED 25APR08 LVL A
 551776 SHEET 2 OF 2 09NOV07

INSTALLATION INSTRUCTIONS AND PARTS LIST

APPLICATION: MODEL 571441 MEGA STEP BRACKETS ON:

2014+ GM 1500 REGULAR CAB PICKUPS, GAS

2015 GM 2500/3500HD REGULAR CAB PICKUPS, GAS

ROCKER PANEL MOUNT APPLICATION



NO DRILL APPLICATION

1. READ INSTRUCTIONS COMPLETELY AND CHECK TO MAKE SURE THAT ALL REQUIRED PARTS (LISTED ON SERVICE PARTS LIST) ARE ON HAND BEFORE STARTING THE INSTALLATION. THE SIDE ENTRY STEP ASSEMBLIES SHOULD BE MOUNTED TO THE PINCH WELD AND VERTICAL WALL OF THE ROCKER PANEL AS FOLLOWS. **NOTE: DEPENDING ON THE VEHICLE, THE HOLE CONFIGURATION MAY CHANGE. FASTENERS ARE PROVIDED FOR ALL APPLICATIONS.**
2. ON THE LEFT SIDE OF THE VEHICLE REMOVE THE PLASTIC BODY PLUGS THAT ARE LOCATED ON THE VERTICAL WALL OF THE ROCKER PANEL AND INSERT A 5/16"-18 U-NUT (ITEM #7) AS SHOWN. (IF THERE ARE THREADED INSERTS IN THE UPPER LOCATION, USE THE BLACK M8-1.25X30 BOLTS (ITEM #)).
3. POSITION THE MOUNTING BRACKETS (ITEM #3) SO THAT THE HOLES ON THE BRACKET LINE UP WITH THE HOLES ON THE INSIDE WALL OF THE ROCKER PANEL. INSTALL A 5/16"-18 X 1.0" HEX BOLT, AND A 5/16" FLAT WASHER (ITEMS #5, 4) FINGER TIGHT.
4. INSTALL A BLACK M8-1.25 X 30MMHEX BOLT, 5/16" FLAT WASHER, AND THE PINCH WELD SUPPORT (ITEMS #4, 8, 9) THROUGH THE HOLE AND INSTALL A M8-1.25 NUT (ITEM #6) FINGER TIGHT ON THE BACK AS SHOWN.
5. REPEAT STEPS 3 – 4 FOR THE REMAINING BRACKETS.
6. INSTALL THE STEP BOARD AS DESCRIBED BY THE INSTRUCTIONS INCLUDED WITH YOUR STEP BOARDS.
7. PRESS STEP DOWN AND BACK, TIGHTEN THE MOUNTING BOLTS TO 19 LB-FT STARTING WITH THE BOTTOM BOLTS FOLLOWED BY THE TOP BOLTS.
8. REPEAT STEPS 2 – 7 FOR THE RIGHT SIDE OF THE VEHICLE.

SERVICE PARTS LIST

| ITEM | PART NO. | QTY | DESCRIPTION |
|------|----------|-----|--|
| 1 | | 1 | STEP ASSEMBLY, MEGA STEP / O-MEGA STEP |
| 2 | 552628 | 2 | BRKT-MTG, LH, MEGA STEP, 571441 |
| 3 | 552627 | 2 | BRKT-MTG, RH, MEGA STEP, 571441 |
| 4 | 106998 | 8 | 5/16" FLATWASHER, SST, BZP |
| 5 | 100647 | 4 | 5/16"-18 X 1.00" SCR ZP |
| 6 | 105859 | 4 | NUT SERR FLG, M8-1.25, ZP |
| 7 | 105541 | 4 | U-NUT,5/16"-18 |
| 8 | 551666 | 4 | BRKT-MTG,PINCH WELD SUPPORT |
| 9 | 100180 | 4 | M8-1.25 X 30MM, SCR, SST, BZP |



SERVICE PARTS LIST

MODEL NO. -571441

GM REGULAR CAB

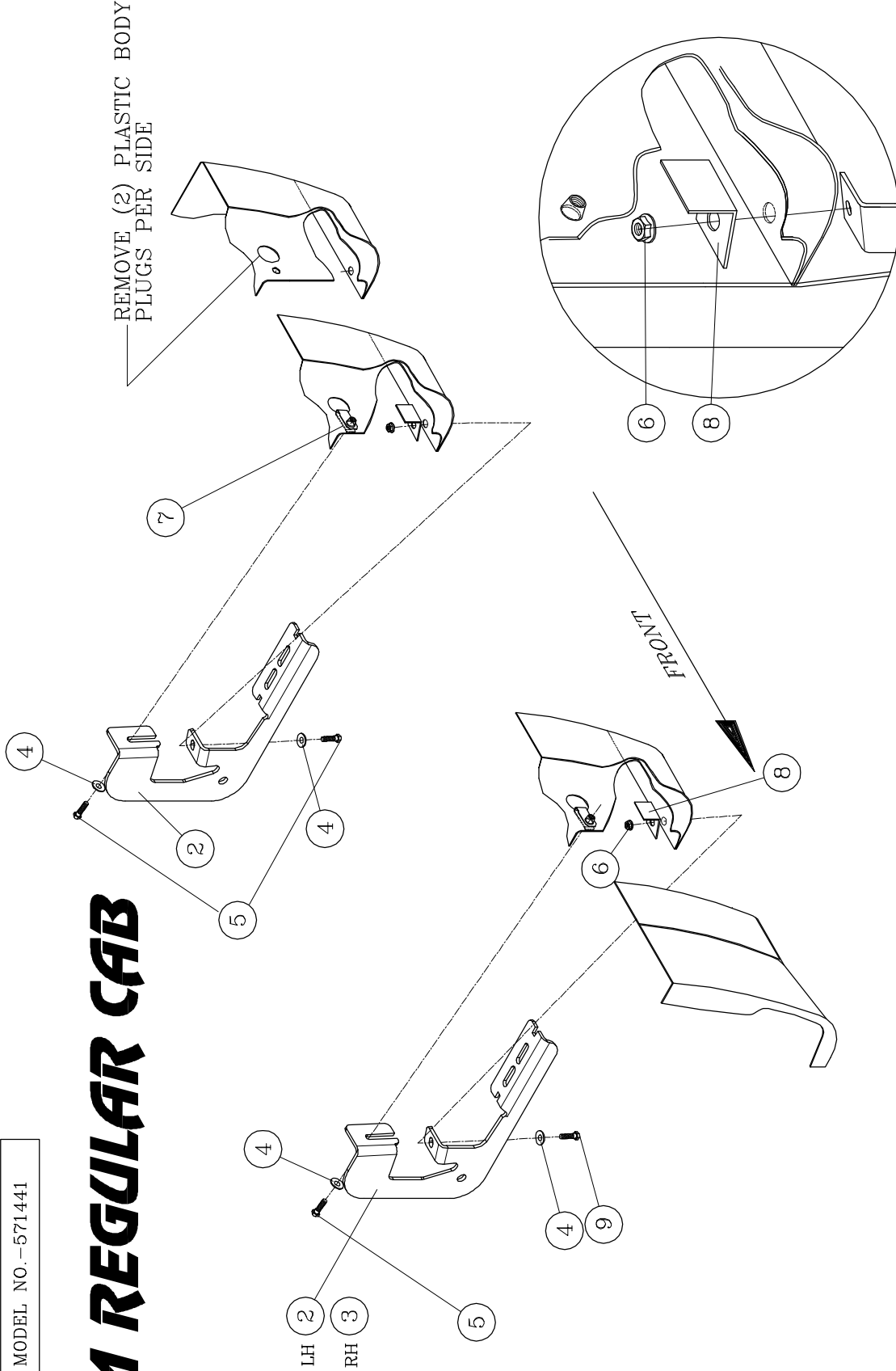

PINCH WELD SUPPORT ASSEMBLY



1280 E. Birch St. Spindler, SB 57606

LEFT (DRIVER) SIDE SHOWN
- RIGHT (PASSENGER) SIDE OPPOSITE -