

MBRP

MBRP Muffler Installation Instructions

229T610

'12-'16

Pro Cross / Pro Climb 1100 Turbo / 9000 Series

Note: Local regulations may limit or prohibit modification to your snowmobile's emissions system and/or the sound levels that it generates. It is your responsibility to be aware of restrictions that may apply to your intended use of this product.

1. Remove the O₂ sensor from the existing exhaust pipe.
2. Remove the bolts attaching the muffler to the turbo downpipe. (Set these bolts safely aside so they can be reused).
3. Remove the stock muffler from the belly pan. Be careful not to damage the gasket at the muffler inlet.
4. Remove the rubber bushings from the stock muffler and transfer these onto the MBRP muffler.
5. Install the MBRP muffler in the same location as the original equipment. Reuse the stock gasket between the turbo downpipe and the muffler inlet. If the gasket has been damaged, contact your local dealer for a replacement. Reuse the stock hardware to secure the muffler to the turbo downpipe.
6. Install the stock O₂ sensor into the provided bung on the MBRP muffler.

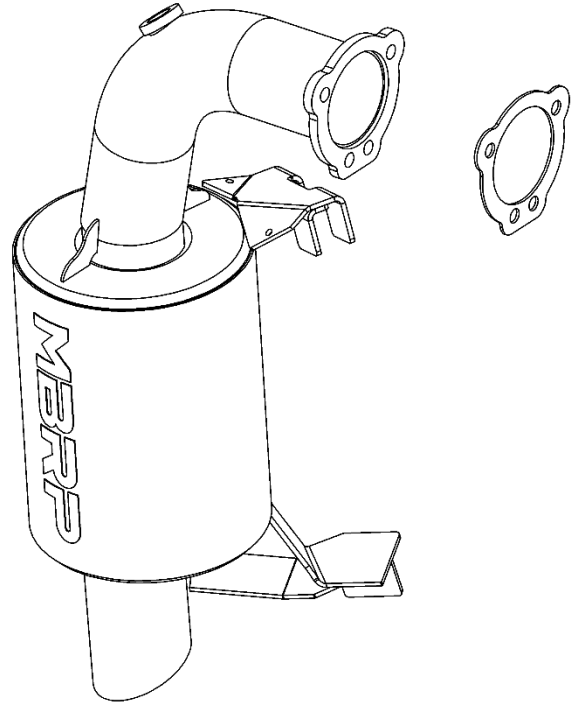

NOTE: To avoid exhaust leaks use a high heat silicone to seal all connections between the expansion chambers and the muffler. Monitor the exhaust for leaks during the first 200 miles after your installation and re-apply silicone where necessary. We suggest having your local snowmobile mechanic or performance shop install this product.

CAUTION: **DO NOT** touch the muffler while the snowmobile is running or shortly after it has run, as it may result in personal injury.

MBRP Ltd. warranty applies for a two (2) year period from the date of purchase to defects in product material and workmanship and is to the original purchaser on record and for the original vehicle for which it was designed and installed. This warranty is limited, at MBRP Ltd.'s sole determination, to the repair or replacement of defective product only and does not include the cost of removal or re-installation, damage by accident, abuse, misuse or misapplication or any consequential damages however they may arise. Determination of warranty coverage shall be at the discretion of an authorized MBRP Ltd. quality engineer.