

S4202

2014-2019 FORD FIESTA ST 1.6L
ECOBOOST - CAT BACK 3"
DUAL OUTLET

MBRP

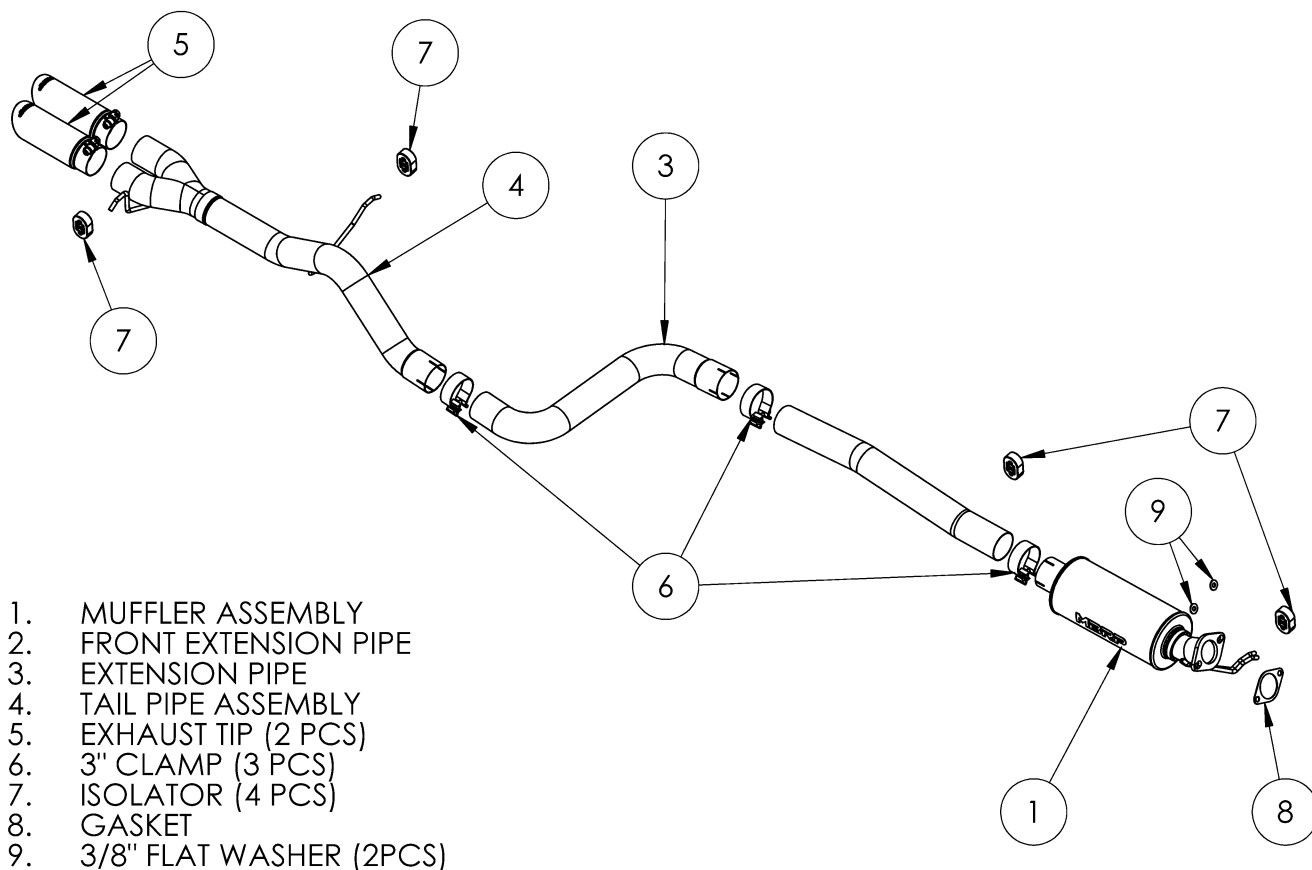

Refer to this LOT NUMBER when contacting customer service: _____

PLEASE READ BEFORE STARTING INSTALLATION

While MBRP has made every effort to ensure that all components of this system are of superior quality and properly packaged, it is the installer's responsibility to ensure the following before removal of the factory exhaust:

- that ALL components shown above are present.
- that ALL mating components fit together.
- that there are no damaged components.
- that the system you have purchased is appropriate for your vehicle year, model and configuration.
- that the system will not interfere with any modifications previously installed or planned.
- that you have read and understand these instructions.

If you have any questions or are uncertain about any aspect of the installation of this system to your vehicle please contact your dealer before commencing installation.



Figure 1



Figure 2



Figure 3



Figure 4



Figure 5

Removal of Stock System:

1. Apply a penetrating lubricant liberally to all exhaust fasteners, hangers and rubber isolators.
2. Unhook the rear rubber isolators and allow exhaust to hang down.
Refer to Figure 1.
3. Remove the small cross member.
Refer to Figure 2.
4. Carefully cut the factory exhaust in front of the rear suspension.
Refer to Figure 3.
5. Remove the factory muffler assembly from the vehicle.
6. Remove the two nuts from the factory front resonator assembly.
7. Remove the last hangers from the factory isolators and remove the exhaust from the vehicle.
8. Remove all four factory rubber isolators.

Installation of MBRP Performance Exhaust:

1. Re-install the small cross member.
2. Install the front **Rubber Isolator** onto the vehicle.
3. Insert the **Muffler Assembly** hanger into the **Rubber Isolator**. Centre the **Gasket** between the down pipe flange and **Muffler Assembly** flange. Place the **3/8" Flat Washers** over the down pipe studs and install the two factory nuts. Ensure the two flanges remain centered in relation to each other.
Refer to Figure 4.
4. Place one **3" Clamp** over the **Muffler Assembly** outlet and insert the **Front Extension Pipe** into the **Muffler Assembly** outlet. Install the second **Rubber Isolator** and place one **3" Clamp** over the **Front Extension Pipe**.
Refer to Figure 5.



Figure 6

5. Insert the **Extension Pipe** into the **Front Extension Pipe**. Place one **3" Clamp** over the **Extension Pipe**. Refer to **Figure 6**.



Figure 7

6. Install the remaining two **Rubber Isolators** onto the **Tail Pipe Assembly**. Refer to **Figure 7**.



Figure 8

7. It may be necessary to slightly relocate the factory tie down hook on the rear swing axle. This is easily done with a pry bar placed between the hook and the trailing arm. Refer to **Figure 8**.



Figure 9

8. Install the **Tail Pipe Assembly** into the **Extension pipe** and install the **Rubber Isolators** onto the vehicle mounting points. Refer to **Figure 9**.

MBRP



Figure 10

9. Install the **Exhaust Tips** onto the **Tail Pipe Assembly**. Ensure that the **Tail Pipe Assembly** is level and the **Exhaust Tips** are centred in the fascia opening.

Refer to Figure 10.

7. Carefully align all parts of the system to achieve the best possible fit with the **Tips** centered in the fascia. Take time now and check alignment each time you tighten a joint.

8. Carefully align the system and tips. Align the edge of each band clamp with the edge of the joint it is connecting. Tighten all hardware and clamps, starting at the front and working rearward to secure the system. Check along the full length of the exhaust system to ensure there is adequate clearance for fuel lines, vent lines, brake lines, frame, bodywork, suspension and any wiring, etc. If there is any interference detected, relocate or adjust to provide adequate clearance. Ensure all clamp connections are secure and components are unable to rotate or slide. Band clamps (excluding tip hardware) require approximately **45 lb-ft (60 N-m)** of torque. Verify clearances, system security and band clamp torque after 30-60 miles (50-100 km) of driving.



Congratulations! You are ready to begin experiencing the improved power, sound and driving experience of your **MBRP** performance exhaust system. We know you will enjoy your purchase.