

# S4203

2016-2018 FORD FOCUS RS  
3" CAT-BACK DUAL

**MBRP** INC.  
PERFORMANCE EXHAUST

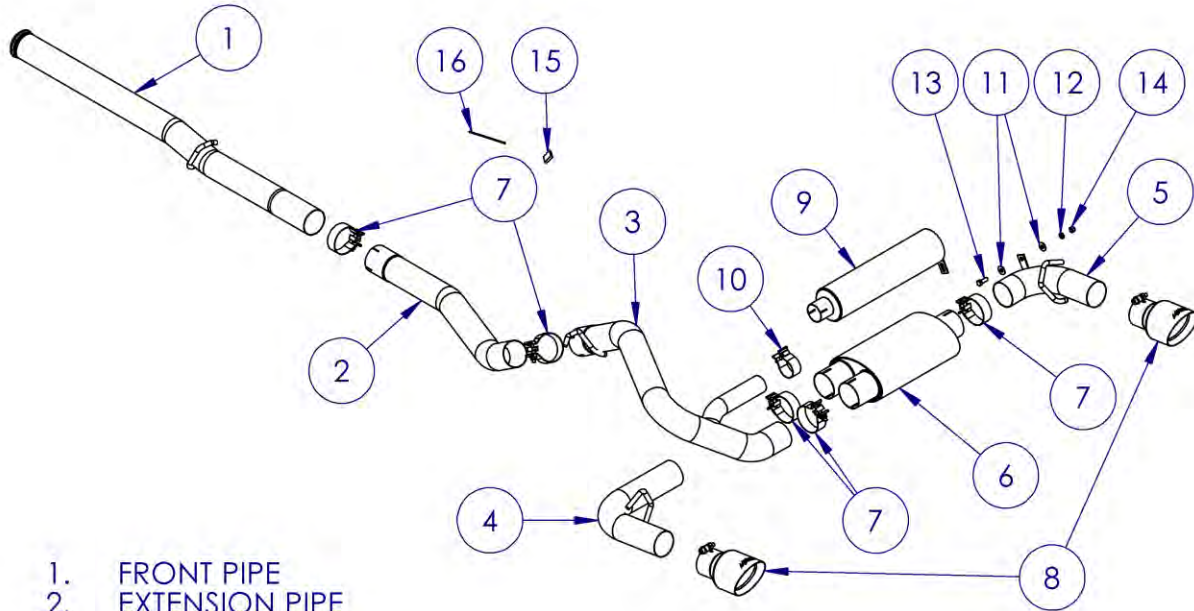

1. FRONT PIPE
2. EXTENSION PIPE
3. OVER-AXLE PIPE
4. DRIVER-SIDE TAIL PIPE
5. PASSENGER-SIDE TAIL PIPE
6. MUFFLER
7. 3" BAND CLAMP (5 PCS - BLACK SYSTEMS USE 2 PLAIN, 3 BLACK)
8. TIP (2 PCS)
9. RESONATOR
10. 2" BAND CLAMP
11. FLAT WASHER (2 PCS)
12. LOCK WASHER
13. BOLT
14. NUT
15. ELECTRONIC VALVE SIMULATOR
16. CABLE TIE

## PLEASE READ BEFORE STARTING INSTALLATION

While MBRP Inc. has made every effort to ensure that all components of this system are of superior quality and properly packaged, it is the installer's responsibility to ensure the following before removal of the factory exhaust:

- that ALL components shown above are present.
- that ALL mating components fit together.
- that there are no damaged components.
- that the system you have purchased is appropriate for your vehicle year, model and configuration.
- that the system will not interfere with any modifications previously installed or planned.
- that you have read and understand these instructions.

If you have any questions or are uncertain about any aspect of the installation of this system to your vehicle please contact your dealer before commencing installation.

**Removal of Stock System:**



**Figure 1**



**Figure 2**



**Figure 3**



**Figure 4**



**Figure 5**

1. Apply a penetrating lubricant liberally to all exhaust fasteners, hangers and rubber isolators.

2. Disconnect the wiring from the electronic exhaust valve.  
**Refer to Figure 1.**

3. Carefully cut the factory exhaust in front of the rear suspension.  
**Refer to Figure 2.**

4. Remove the rubber insulator in front of the rear suspension from the exhaust, the two rear insulators from the vehicle, and remove the muffler assembly.

5. Loosen the factory V-band clamp on the front pipe completely.  
**Refer to Figure 3.**

6. Remove the front pipe from the factory isolator and from the V-band flange.

**Installation of MBRP Inc. Performance Exhaust:**

**NOTE: Do not fully tighten any clamps until the entire system is properly aligned.**

1. Feed the **Over-Axle Pipe** up over the rear CV axle from the rear, and place a **3" Band Clamp** on the forward facing end.  
**Refer to Figure 4.**

2. Insert the **Front Pipe** into the **Extension Pipe**. Place a **3" Band Clamp** over the **Extension Pipe**. Install the **Front pipe** and **Extension Pipe** as a unit into the **Over-Axle Pipe** and then into the factory front V-band clamp.

3. Install the **Front Pipe** and **Over-Axle Pipe** hangers into the factory rubber isolators.

4. Using a **3" Band Clamp**, install the Muffler onto the **Over-Axle Pipe**.  
**Refer to Figure 5.**



**Figure 6**

5. Install the factory rubber isolators onto the **Tail Pipes** before installing them on the vehicle.

**Refer to Figure 6.**



**Figure 7**

6. Using a **3" Band Clamp** install the **Driver-Side Tail Pipe** into the **Muffler** and attach the factory rubber isolator onto the factory mount. **Refer to Figure 7.**



**Figure 8**

7. Using a **3" Band Clamp** install the **Passenger-Side Tail Pipe** into the **Muffler** and attach the factory rubber isolator onto the factory mount. **Refer to Figure 8.**



**Figure 9**

8. Align the **Tail Pipes** with the **Muffler** and the openings in the rear fascia. The **Tail Pipes** and **Muffler** should point upwards towards the rear of the vehicle at approximately 9 degrees.

**Refer to Figure 9.**



**Figure 10**

9. Install the **Exhaust Tips** onto the **Tail Pipes**. Ensure that the **Exhaust Tips** are centered in the fascia openings. Adjust the extension of the **Exhaust Tips** to your liking.

**Refer to Figure 10.**



**Figure 11**

10. Using the **2" Band Clamp** and included **Hardware** attach the **Resonator** to the **Over-Axle Pipe** and the bracket on the **Passenger-Side Tail Pipe**.

**Refer to Figure 11.**

11. Align the exhaust as required. Pay particular attention to the area around the rear drive shaft hanger bearing and the factory front flex pipe hangers. Starting at the front of the exhaust, tighten all hardware, clamps, and connections. Ensure each joint is secure.

**Refer to Figures 12 and 13.**

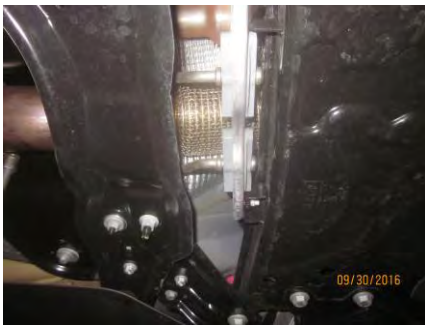

**Figure 12**

12. Check along the entire length of the exhaust system to ensure that there is adequate clearance between the exhaust system and heat shields, cross members, driveline, and body panels. Adjust the system if required.

13. Connect the **Electronic Valve Simulator** to the factory wiring and secure to the vehicle body using the **Cable Tie**.

**Refer to Figure 14.**



**Figure 13**



**Figure 14**



**Congratulations!** You are ready to begin experiencing the improved power, sound and driving experience of your **MBRP Inc.** performance exhaust system. We know you will enjoy your purchase.