

# S4711

2022-2024 KIA FORTE GT SEDAN,  
1.6L TURBO, AXLE-BACK, 2.5" DUAL SPLIT  
REAR, TOURING PROFILE, QUAD TIPS

# MBRP®

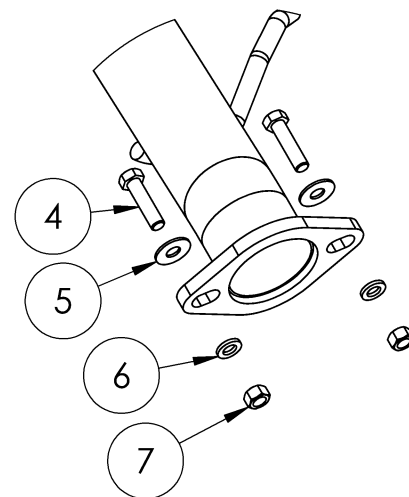
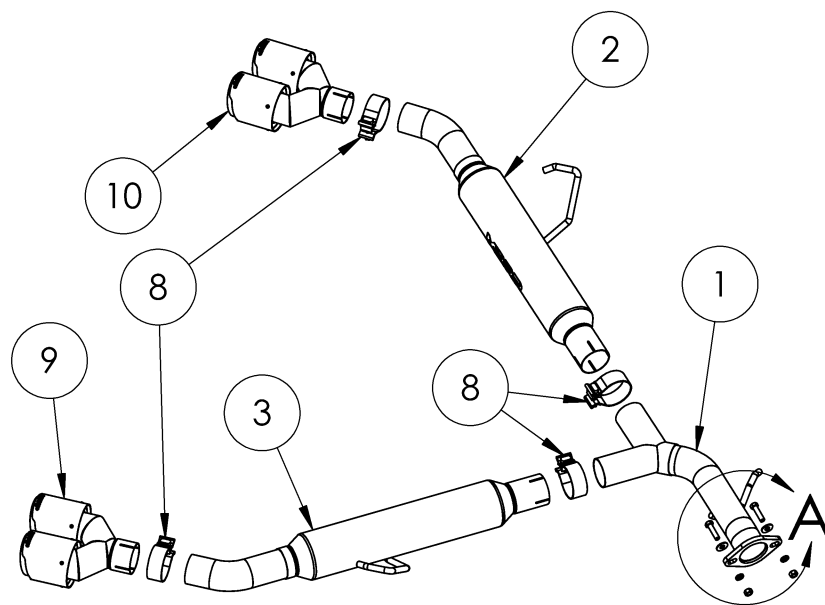

DETAIL A

ITEM	DESCRIPTION	QTY
1	Y-PIPE	1
2	DRIVER-SIDE TAIL PIPE	1
3	PASSENGER-SIDE TAIL PIPE	1
4	3/8" X 1.5" HEX BOLT	2
5	3/8" FLAT WASHER	2
6	3/8" LOCK WASHER	2
7	3/8" HEX NUT	2
8	2.5" CLAMP	4
9	PASSENGER-SIDE TIP	1
10	DRIVER-SIDE TIP	1

Refer to this LOT NUMBER when contacting customer service: \_\_\_\_\_

## PLEASE READ BEFORE STARTING INSTALLATION

While MBRP has made every effort to ensure that all components of this system are of superior quality and properly packaged, it is the installer's responsibility to ensure the following before removal of the factory exhaust:

- that ALL components shown above are present.
- that ALL mating components fit together.
- that there are no damaged components.
- that the system you have purchased is appropriate for your vehicle year, model and configuration.
- that the system will not interfere with any modifications previously installed or planned.
- that you have read and understand these instructions.

If you have any questions or are uncertain about any aspect of the installation of this system to your vehicle please contact your dealer before commencing installation.

# MBRP

## Removal of Stock System

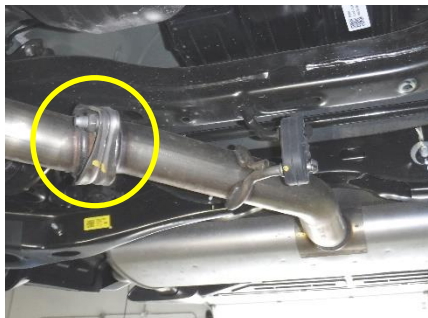

**Figure 1**

1. Apply penetrating lubricant liberally to all exhaust fasteners, hangers, and rubber insulators.

2. Remove the muffler nuts at the rear flange connection and save the nuts for the installation.

**Refer to Figure 1.**

3. With the rear of the exhaust system supported, remove the factory insulators from the vehicle. Retain the insulators for the installation.

4. Remove the muffler assembly from the vehicle. Carefully remove the factory gasket from the muffler flange to be used for the installation.

## Installation of **MBRP** Performance Exhaust



**Figure 2**

1. Using the factory gasket and **3/8" Hardware**, loosely attach the **Y-Pipe** onto the factory flange connection. Align the flanges to center the pipe connection and gasket.

**Refer to Figure 2 and Page 1.**

2. Reinstall the factory insulator onto the **Y-Pipe** and vehicle.

**Refer to Figure 2.**



**Figure 3**

3. Using a **2.5" Clamp**, loosely install the **Passenger-Side Tail Pipe** onto the **Y-Pipe**. Reinstall the factory rubber insulator.

**Refer to Figure 3.**

4. Using a **2.5" Clamp**, loosely install the **Driver-Side Tail Pipe** onto the **Y-Pipe**. Reinstall the factory rubber insulator.

**Refer to Figure 4.**



**Figure 4**

# MBRP



**Figure 5**

**5.** Using **2.5" Clamps**, install the **Tips** and adjust to your liking. Refer to **Figures 5 and 6**.

**6.** The **Tips** will be angled up approximately 5 degrees and outwards about 2 degrees.

Refer to **Figures 7 and 8**.

**7.** Carefully align the system, centering the **Tips** with the factory fascia openings. Align the edge of each band clamp with the edge of the joint it is connecting. Tighten all hardware and clamps, starting at the front and working rearward to secure the system. Check along the full length of the exhaust system to ensure there is adequate clearance for fuel lines, vent lines, brake lines, frame, bodywork, suspension and any wiring, etc. If there is any interference detected, relocate or adjust to provide adequate clearance. Ensure all clamp connections are secure and components are unable to rotate or slide. Band clamps require approximately 45 lb-ft (60 N-m) of torque. Verify clearances, system security and band clamp torque after 30-60 miles (50-100 km) of driving.



**Figure 6**



**Figure 7**



**Figure 8**



**Congratulations!** You are ready to begin experiencing the improved power, sound and driving experience of your **MBRP** Performance Exhaust. We know you will enjoy your purchase!