

S6059

2020-UP CHEVY/GMC
2500/3500 EC/CC, 6.6L DURAMAX,
FILTER BACK, 4.0" SINGLE SIDE,
SINGLE TIP

MBRP®

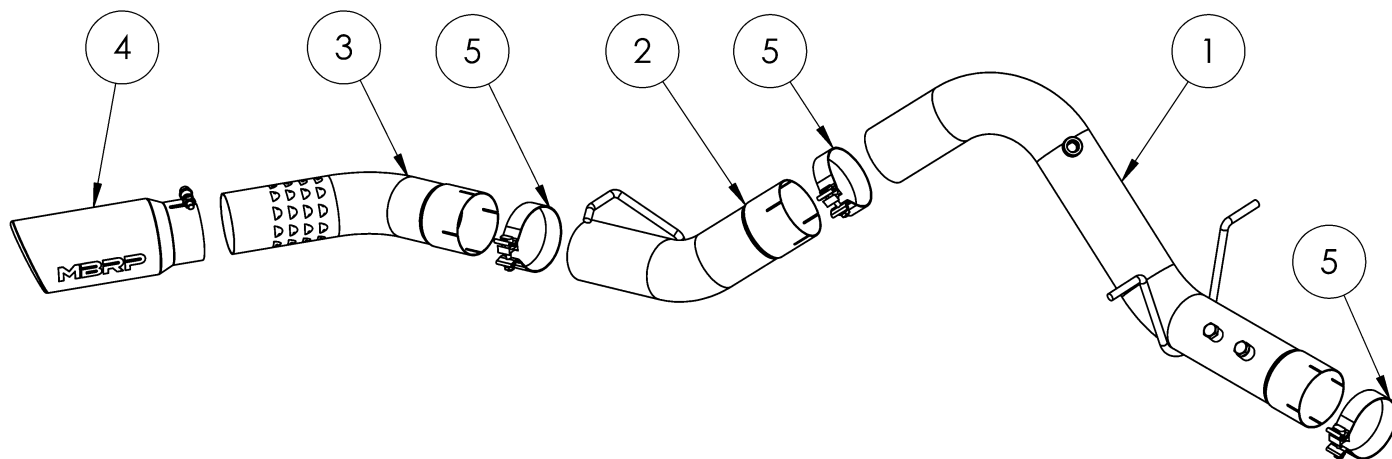

ITEM	DESCRIPTION	QTY.
1	OVER-AXLE PIPE	1
2	PIPE ASSEMBLY	1
3	TAIL PIPE	1
4	EXHAUST TIP	1
5	4" BAND CLAMP	3

PLEASE READ BEFORE STARTING INSTALLATION

While MBRP has made every effort to ensure that all components of this system are of superior quality and properly packaged, it is the installer's responsibility to ensure the following before removal of the factory exhaust:

- that ALL components shown above are present.
- that ALL mating components fit together.
- that there are no damaged components.
- that the system you have purchased is appropriate for your vehicle year, model and configuration.
- that the system will not interfere with any modifications previously installed or planned.
- that you have read and understand these instructions.

If you have any questions or are uncertain about any aspect of the installation of this system to your vehicle please contact your dealer before commencing installation.

MBRP

Removal of Stock System

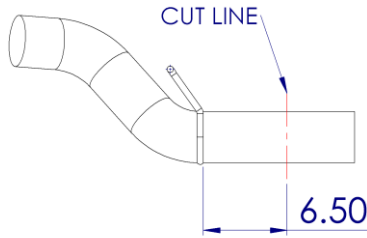

Figure 1



Figure 2



Figure 3

1. Apply a penetrating lubricant liberally to all hangers and rubber insulators.
2. Mark a cut line 6.5" forward of the OEM hanger.
Refer to Figure 1.
3. Disconnect and remove any sensors located in the section of the factory exhaust being removed. Retain these sensors as they will be reused.
4. To verify the cut line, line up the supplied **Over-Axle Pipe** before making the final cut. Cut the factory pipe at the cut line.
5. Unhook the three factory rubber insulators from the exhaust and remove the factory pipe.

Installation of MBRP Performance Exhaust

1. Place a **4" Band Clamp** over the factory extension pipe and install the **Over-Axle Pipe** over the factory extension pipe.
Refer to Figure 2.
2. Install the **Over-Axle Pipe** hangers into the factory rubber insulators.
3. Place a **4" Band Clamp** on the inlet of the **Pipe Assembly** and install it onto the **Over-Axle Pipe**.
4. Install **Pipe Assembly** hanger into factory rubber insulator.
Refer to Figure 3.
5. Place a **4" Band Clamp** on the inlet of the **Tail Pipe** and install it onto the **Pipe Assembly**.
6. Install the **Exhaust Tip** and adjust to your liking.
7. Once everything is aligned, completely tighten all clamps.
8. Reinstall any sensors previously removed. Short box trucks will require the plugs to be removed from the bungs in the **Over-Axle Pipe** for installation of the OEM sensors.
9. Check along the full length of the exhaust system to ensure there is adequate clearance for fuel lines, vent lines, brake lines, frame, bodywork, suspension and any wiring, etc. If there is any interference detected, relocate or adjust to provide adequate clearance. Ensure all clamp connections are secure and components are unable to rotate or slide. Band clamps require approximately 45 lb-ft (60 N-m) of torque. Verify clearances, system security and band clamp torque after 30-60 miles (50-100 km) of driving.

Congratulations! You are ready to begin experiencing the improved power, sound and driving experience of your

MBRP performance exhaust system. We know you will enjoy your purchase.