

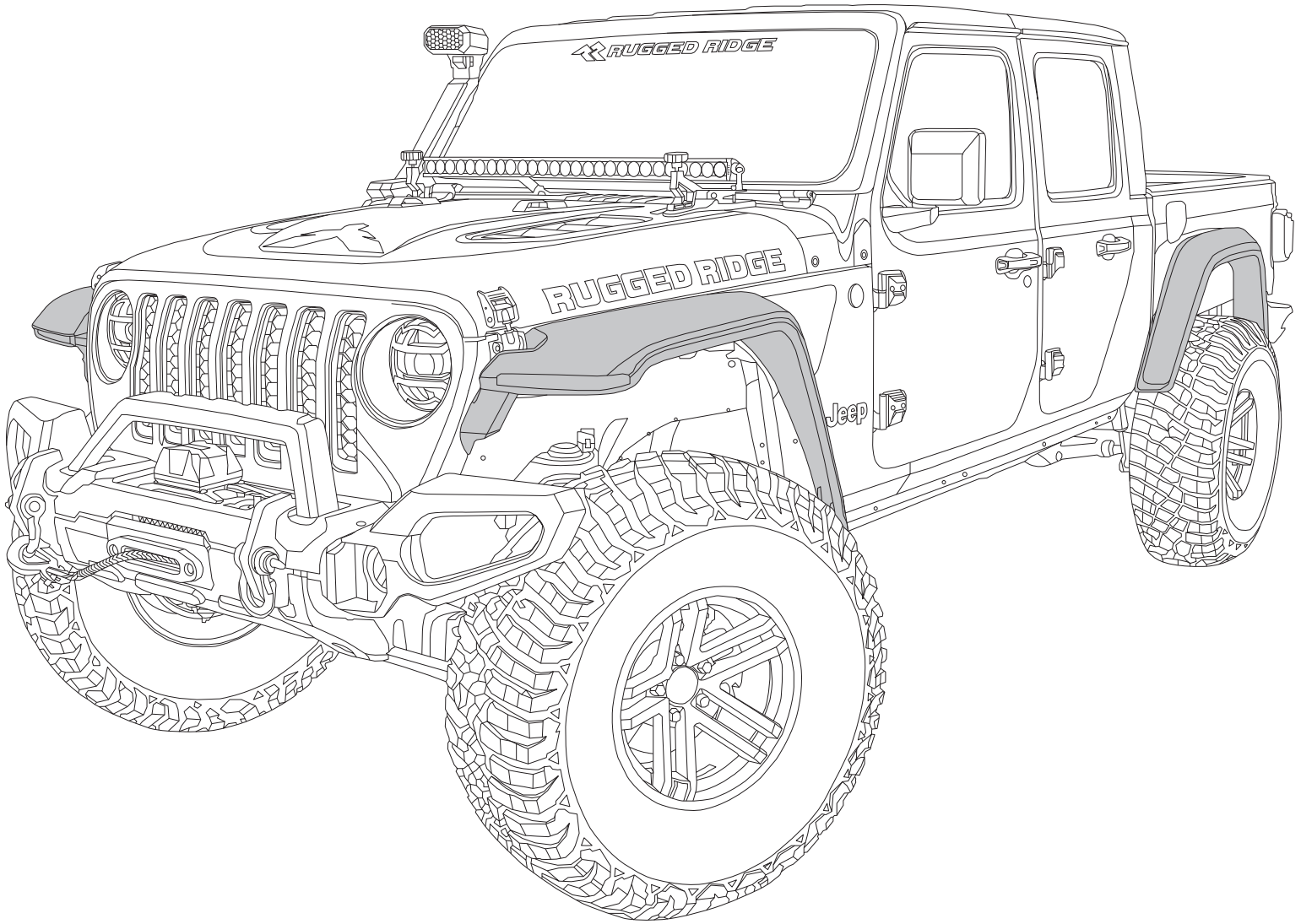

460 HORIZON DR. | SUWANEE, GA 30024 | PHONE: 770-614-6101 | FAX: 770-614-6069 | www.omix-ada.com

Part #11640.52

Max Terrain Flares, JT Patent Pending



OMIX-ADA® TECHNICAL SUPPORT

PHONE: M-F 8am - 5pm EST 1-800-449-6649 | TICKET: www.omixsupport.com

FOR WARRANTY INFORMATION VISIT: www.Omix-Ada.com



460 HORIZON DR. | SUWANEE, GA 30024 | PHONE: 770-614-6101 | FAX: 770-614-6069 | www.omix-ada.com

Max Terrain Flares, JT Patent Pending

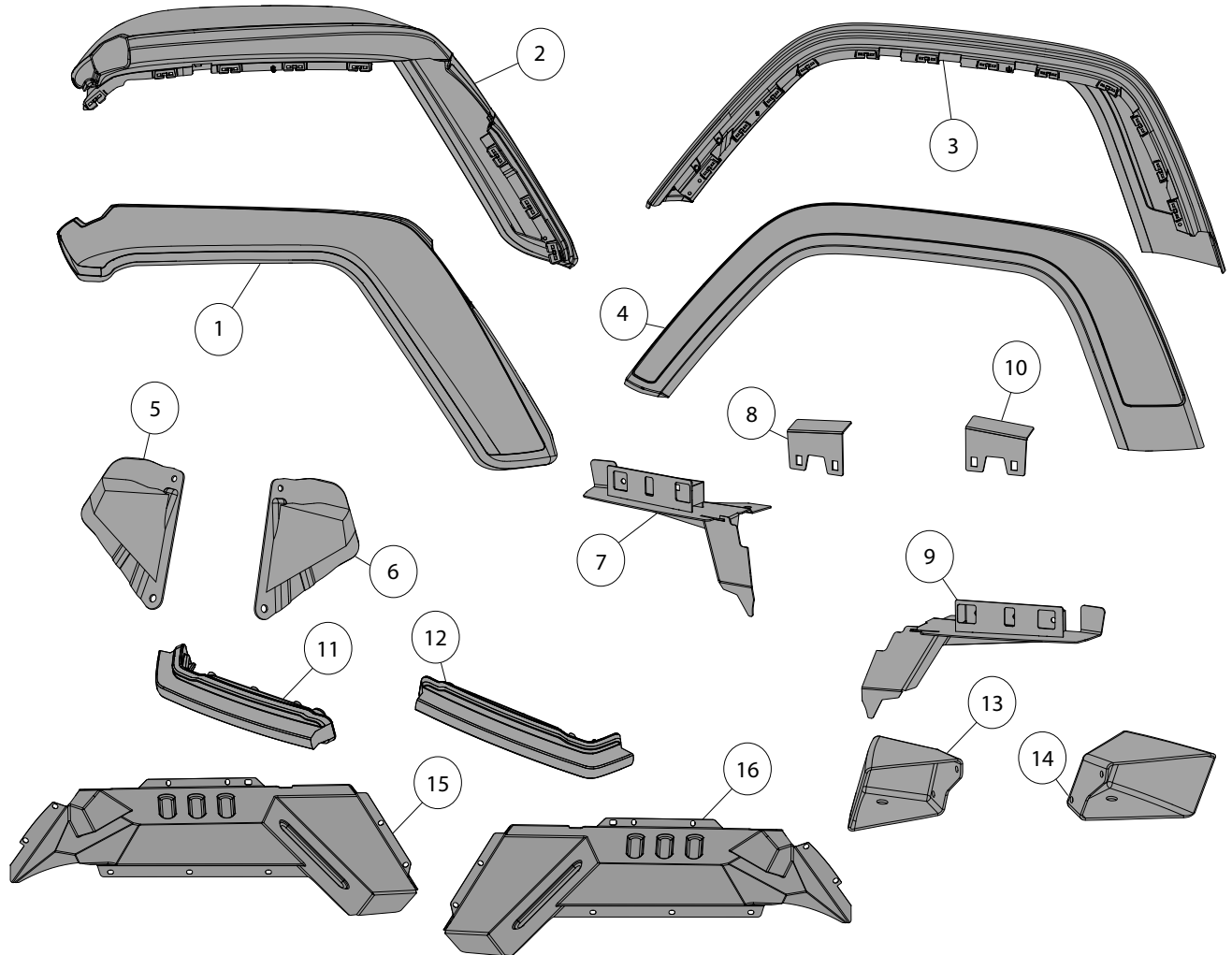

Components

1. Front Flare, LH	(1)	9. Light Bracket, LH	(1)
2. Front Flare, RH	(1)	10. Support Bracket, LH	(1)
3. Rear Flare, LH	(1)	11. Daytime Running Light, RH	(1)
4. Rear Flare, RH	(1)	12. Daytime Running Light, LH	(1)
5. Front Lower Stanchion, RH	(1)	13. Rear Stanchion, RH	(1)
6. Front Lower Stanchion, LH	(1)	14. Rear Stanchion, LH	(1)
7. Light Bracket, RH	(1)	15. Rear Liner, LH	(1)
8. Support Bracket, RH	(1)	16. Rear Liner, RH	(1)

OMIX-ADA® TECHNICAL SUPPORT

PHONE: M-F 8am - 5pm EST 1-800-449-6649 | TICKET: www.omixsupport.com

FOR WARRANTY INFORMATION VISIT: www.Omix-Ada.com



460 HORIZON DR. | SUWANEE, GA 30024 | PHONE: 770-614-6101 | FAX: 770-614-6069 | www.omix-ada.com

Max Terrain Flares, JT Patent Pending

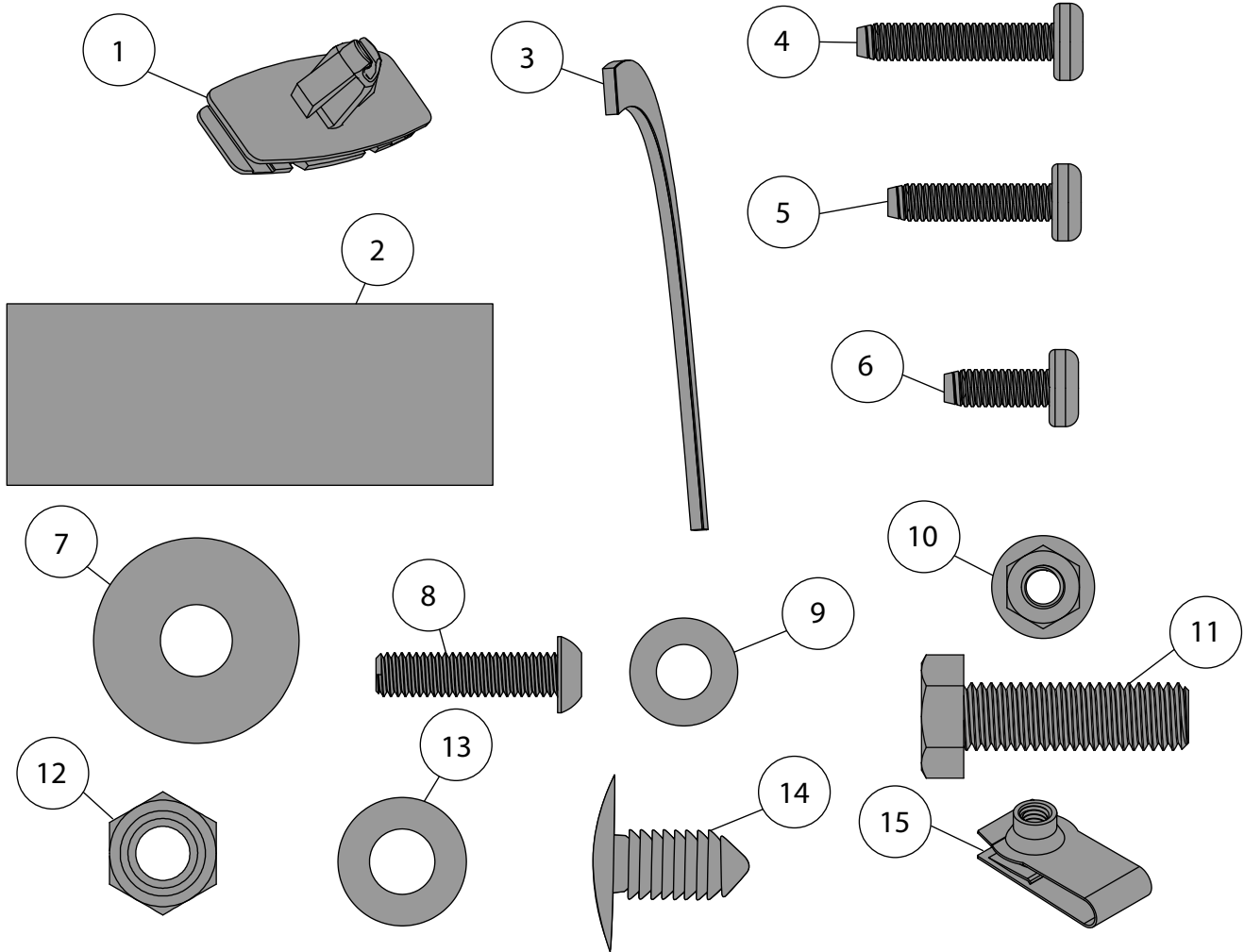

Hardware

1. Flare Clips	(28)	9. M6 Washer	(20)
2. Double Sided Tape	(6)	10. M6 Flange Nut	(8)
3. Trim Foam	(4)	11. M8 Bolt	(4)
4. Long M6 Thread Forming Screw	(2)	12. M8 Nut	(8)
5. Medium M6 Thread Forming Screw	(2)	13. M8 Washer	(6)
6. Short M6 Thread Forming Screw	(2)	14. 10mm Shield Retainer	(6)
7. M8 Oversized Washer	(2)	15. M6 U-nut	(12)
8. M6 Button Head Bolt	(20)		

OMIX-ADA® TECHNICAL SUPPORT

PHONE: M-F 8am - 5pm EST 1-800-449-6649 | TICKET: www.omixsupport.com

FOR WARRANTY INFORMATION VISIT: www.Omix-Ada.com



460 HORIZON DR. | SUWANEE, GA 30024 | PHONE: 770-614-6101 | FAX: 770-614-6069 | www.omix-ada.com

Max Terrain Flares, JT Patent Pending

1. Disconnect primary and secondary batteries by removing wire leads from grounding post on fender and negative battery terminal.

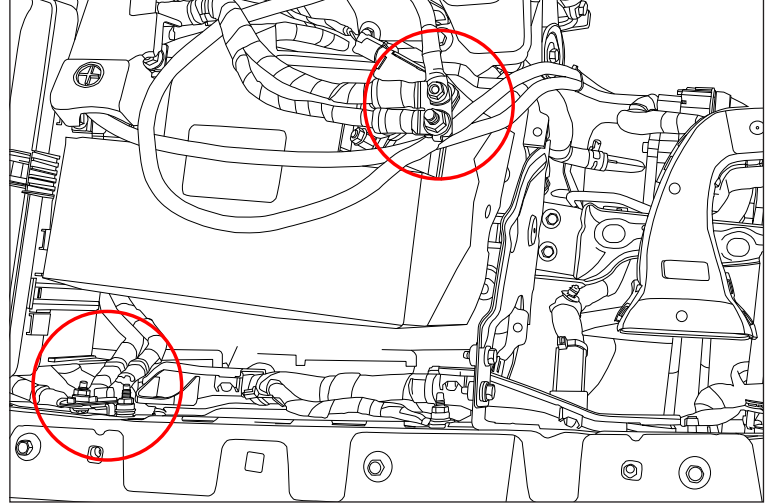

2. Remove front and rear factory fender flares, flare supports, and wheel liner. Disconnect OE daytime running light (DRL) from wire harness. Retain all hardware.

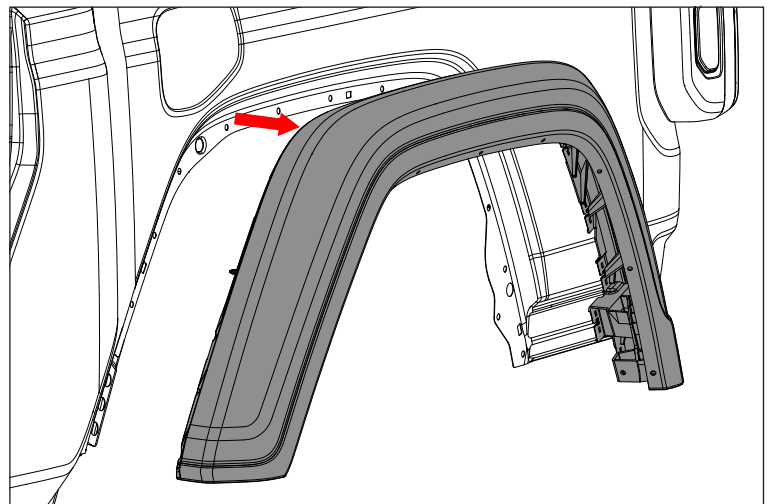
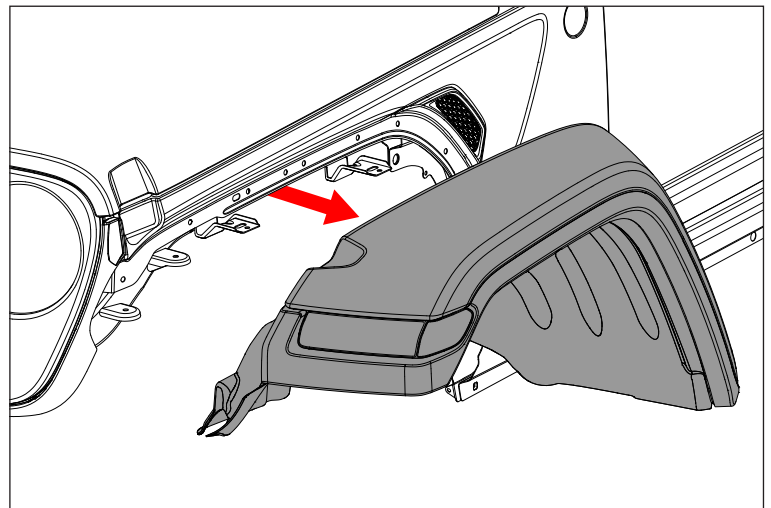



460 HORIZON DR. | SUWANEE, GA 30024 | PHONE: 770-614-6101 | FAX: 770-614-6069 | www.omix-ada.com

Max Terrain Flares, JT Patent Pending

3. Using a clip removal tool, flat head screwdriver, or pry tool, remove any plastic clips still on fender. Thoroughly clean exposed fenders.

NOTICE Skip to Step 7 if not reusing OE wheel liners.

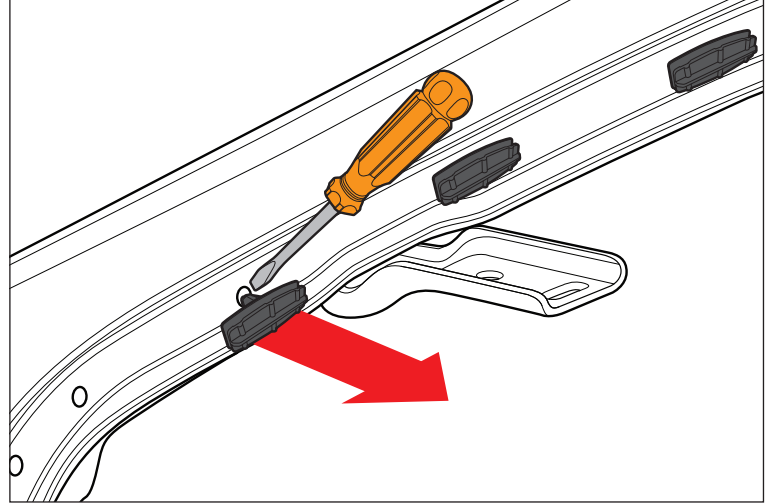

4. Using punch or drill with 5/16" bit, drill through plastic rivets along edge of flare and OE wheel liner.

NOTICE Do this for only the front flares.

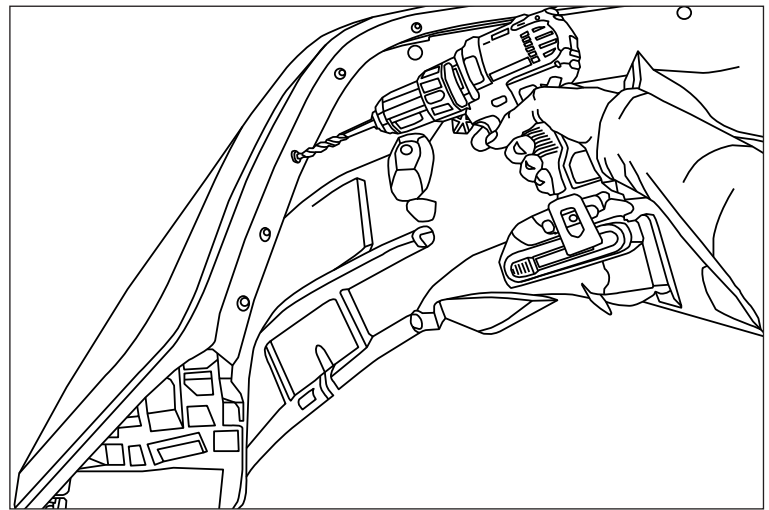

5. Position OE front wheel liner on vehicle. Using Jeep body as a guide, mark portion of front wheel liner protruding from vehicle body. Using a dremel, or other suitable cutting device, trim the OE front wheel liner along marked lines.

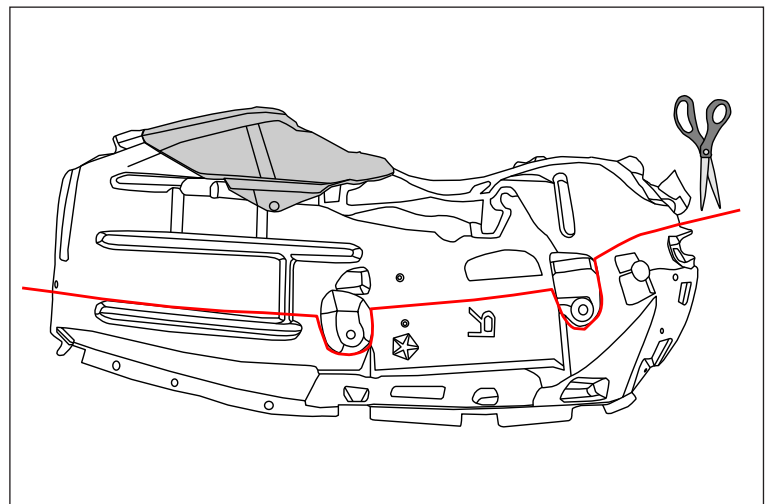



460 HORIZON DR. | SUWANEE, GA 30024 | PHONE: 770-614-6101 | FAX: 770-614-6069 | www.omix-ada.com

Max Terrain Flares, JT Patent Pending

6. Reusing OE push rivets and hardware, reattach OE front wheel liners.

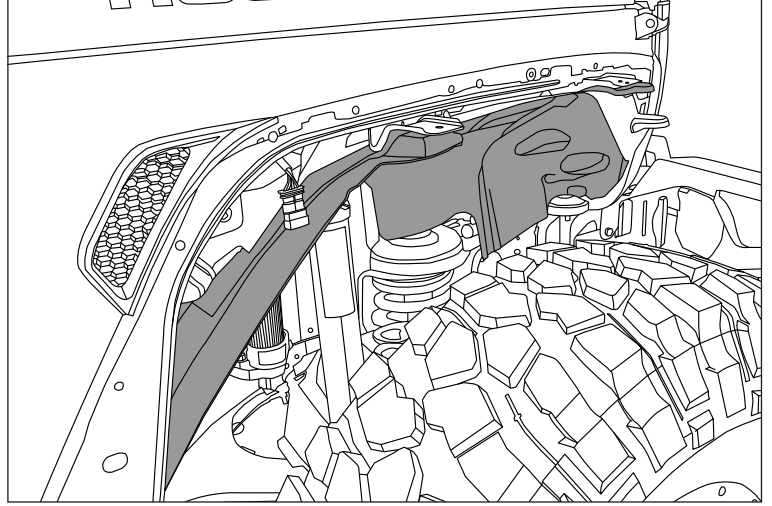

7. Apply adhesive promoter to the inside edge of Front Flare, approximately 1/4" from the edge.

8. Starting at one end, attach Trim Foam 1/4" from the top surface of flare.

NOTICE The Trim Foam will help protect the painted fender once the flares are installed.

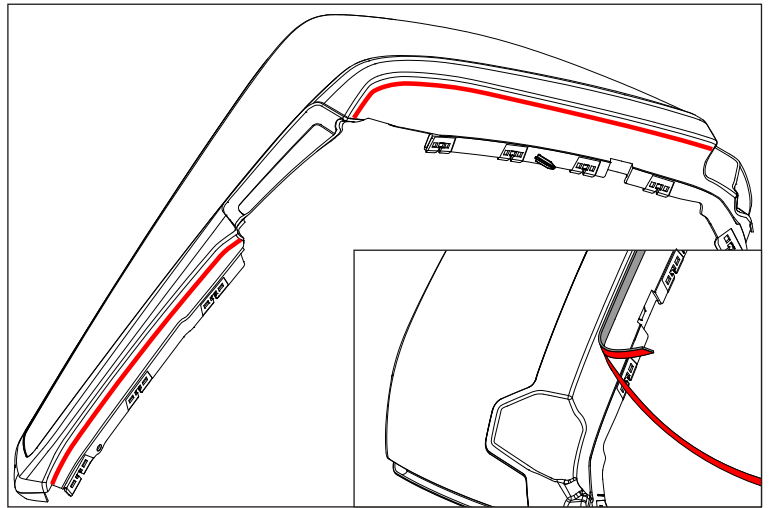

9. Attach U-nuts to the outer six holes on the rear liners.

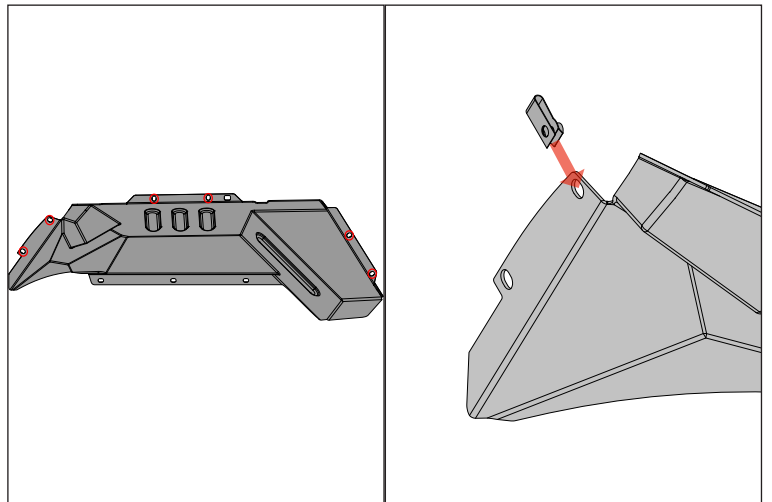



460 HORIZON DR. | SUWANEE, GA 30024 | PHONE: 770-614-6101 | FAX: 770-614-6069 | www.omix-ada.com

Max Terrain Flares, JT Patent Pending

10. Position rear wheel liner on vehicle. Using supplied 10mm shield retainer, affix to vehicle along the back of the wheel well.

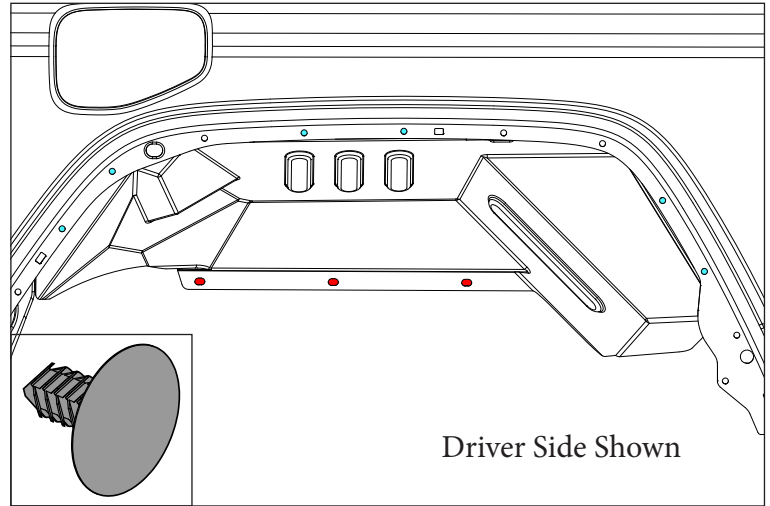

11. Apply adhesive promoter to the inside edge of Rear Flare, approximately 1/4" from the edge. Starting at one end, attach Trim Foam 1/4" from the top surface of flare.

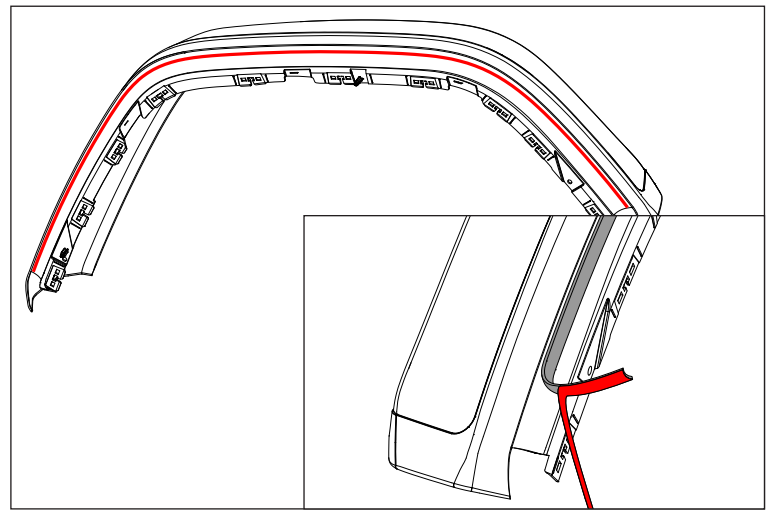

12. Attach flare clips to front flare.

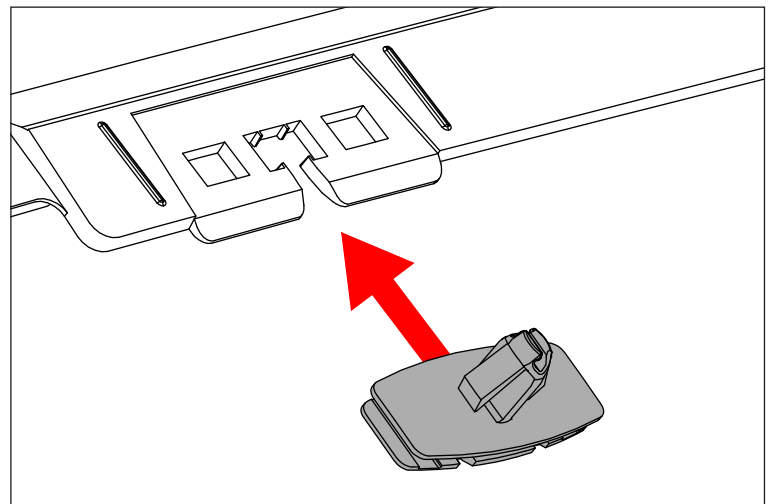



460 HORIZON DR. | SUWANEE, GA 30024 | PHONE: 770-614-6101 | FAX: 770-614-6069 | www.omix-ada.com

Max Terrain Flares, JT Patent Pending

13. Affix Front Flares to vehicle using flare clips.

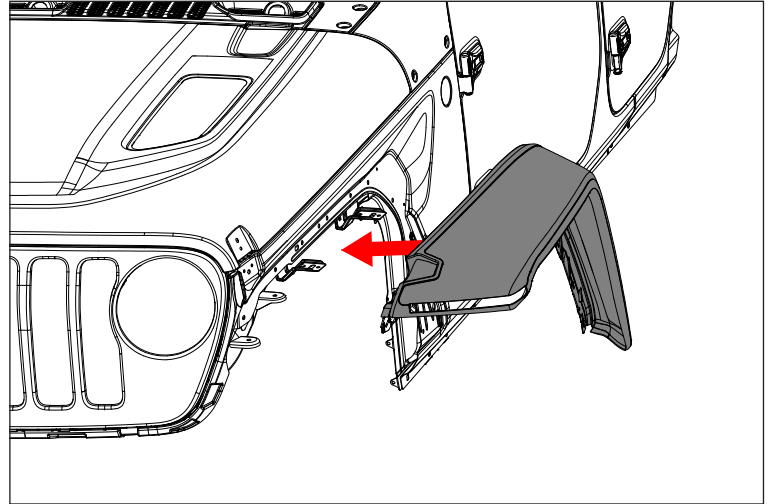

14. Apply adhesive promoter to the top of Lower Stanchion. Then attach Double Sided Tape.

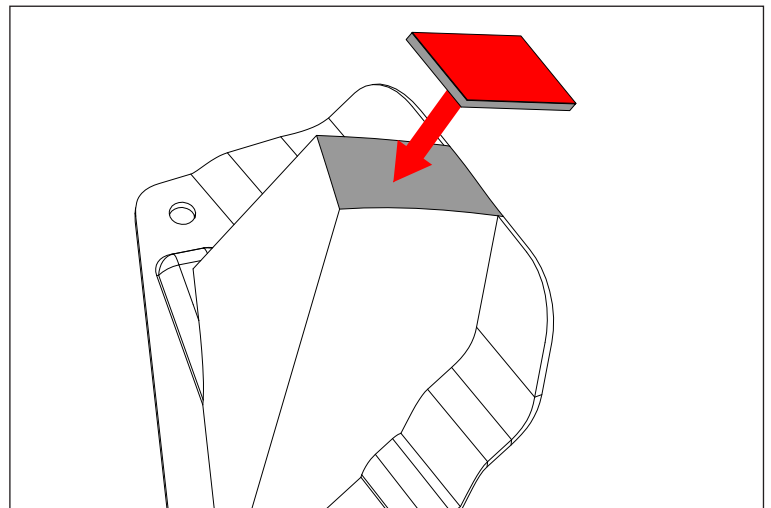

15. Using supplied M6 Flange Nut, M6 Bolt, M6 Washer, and M8 Oversized Washer, loosely attach front lower stanchion to vehicle's front fender.

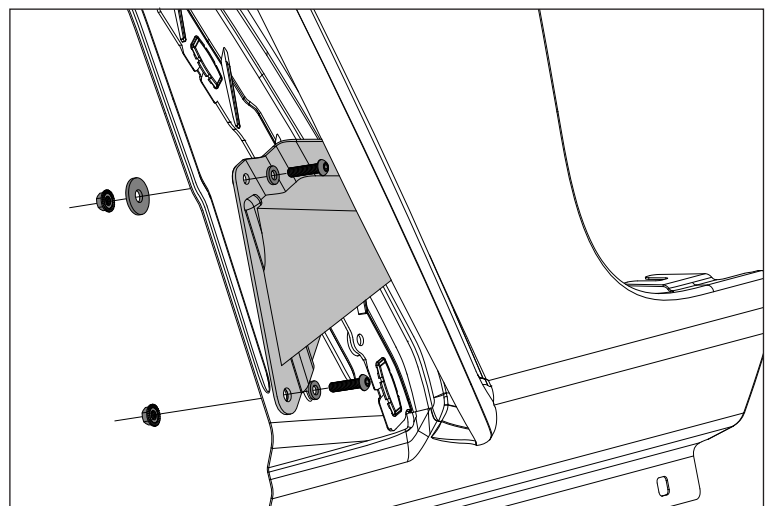



460 HORIZON DR. | SUWANEE, GA 30024 | PHONE: 770-614-6101 | FAX: 770-614-6069 | www.omix-ada.com

Max Terrain Flares, JT Patent Pending

16. Gently pull front flare away, and remove backing from double sided tape. Press front flare and lower stanchion together.

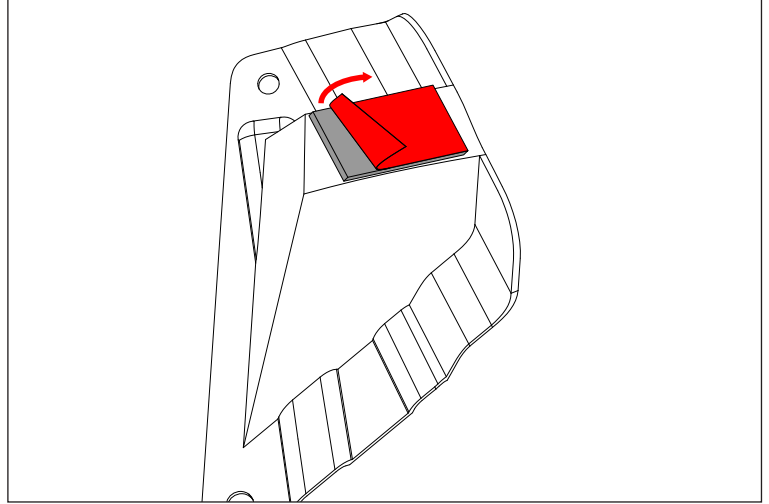

17. Attach Daytime Running Light to light bracket using supplied Thread Forming Screws.

NOTICE Three different size screws are used. Longest to shortest starting toward the center of vehicle.

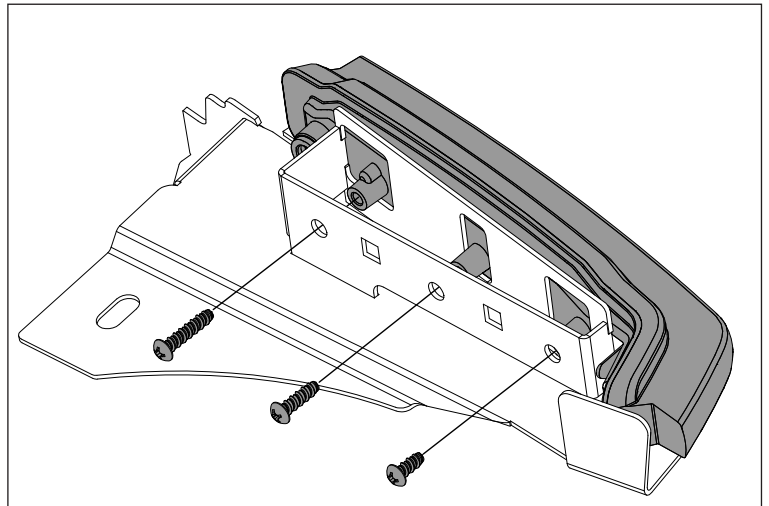

18. Connect light to OE wire harness. Using supplied M8 hardware, attach Light Bracket to vehicle. Position Daytime Running Light to align with opening in flare.

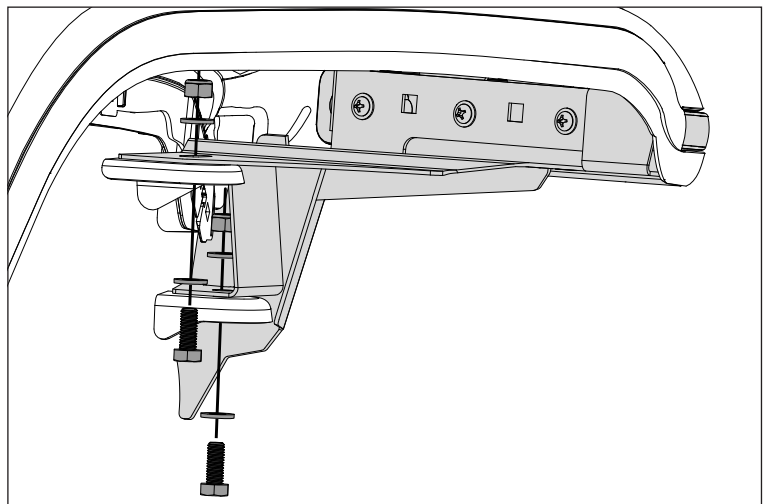



460 HORIZON DR. | SUWANEE, GA 30024 | PHONE: 770-614-6101 | FAX: 770-614-6069 | www.omix-ada.com

Max Terrain Flares, JT Patent Pending

19. Apply adhesive promoter to support bracket. Attach double sided tape. Using supplied M8 Nut and M8 Washer, loosely attach support bracket to Light Bracket.

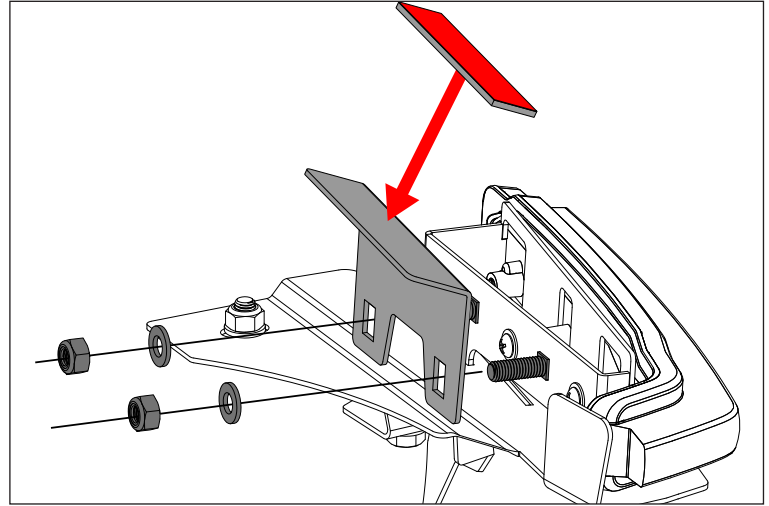

20. Position support bracket under flare and mark location. Add adhesive promoter to marked area.

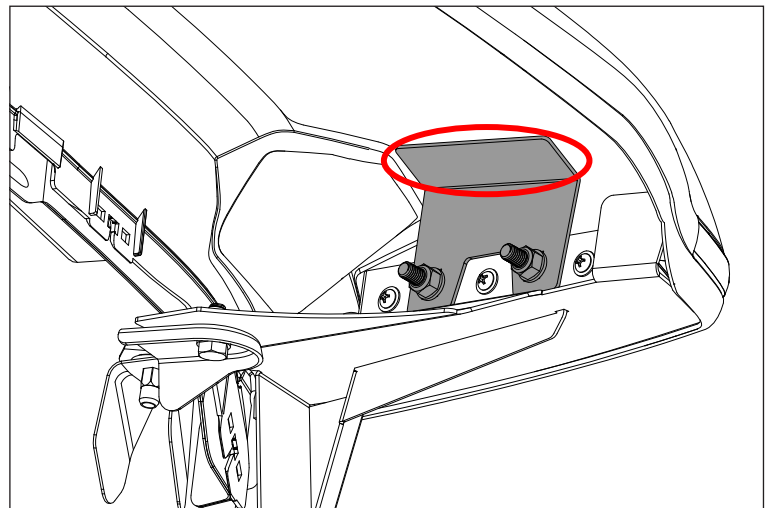

21. Peel backing from double sided tape.

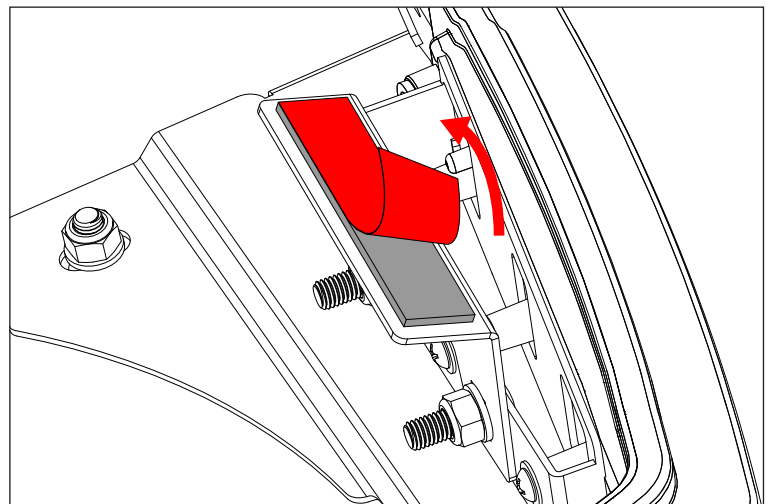



460 HORIZON DR. | SUWANEE, GA 30024 | PHONE: 770-614-6101 | FAX: 770-614-6069 | www.omix-ada.com

Max Terrain Flares, JT Patent Pending

22. Press support bracket against flare.

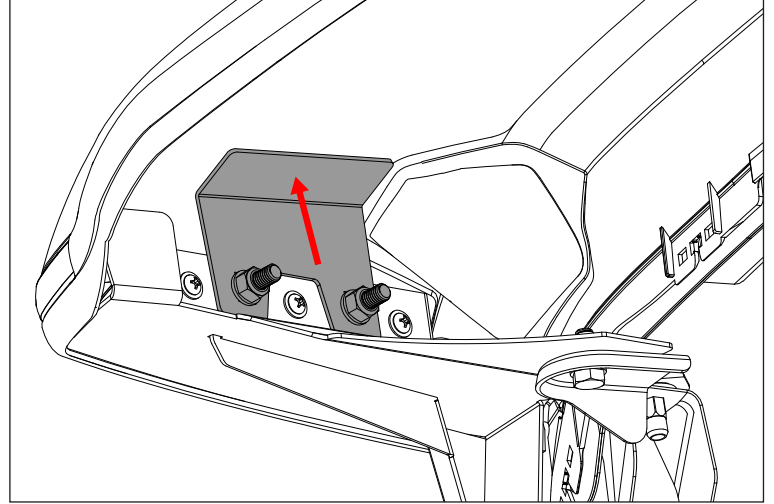

23. Attach rear flare stanchion using supplied M6 bolt, washer, and nut to vehicle.

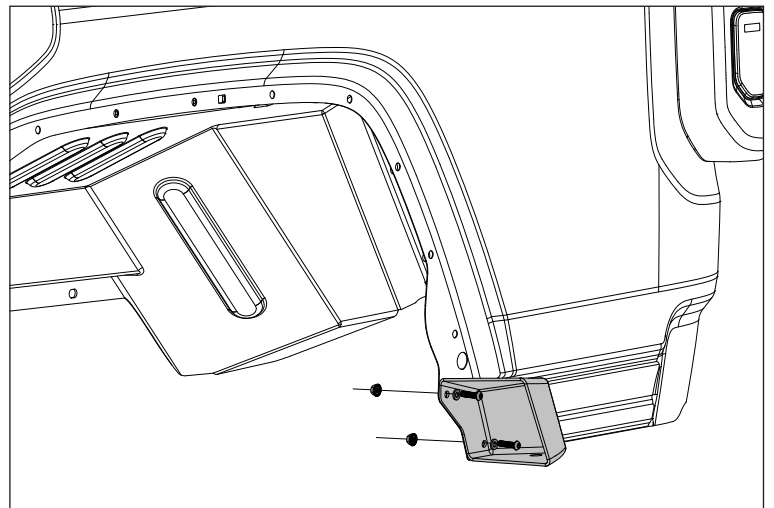

24. Apply adhesive promoter to the side of rear stanchion. Then attach double sided tape.

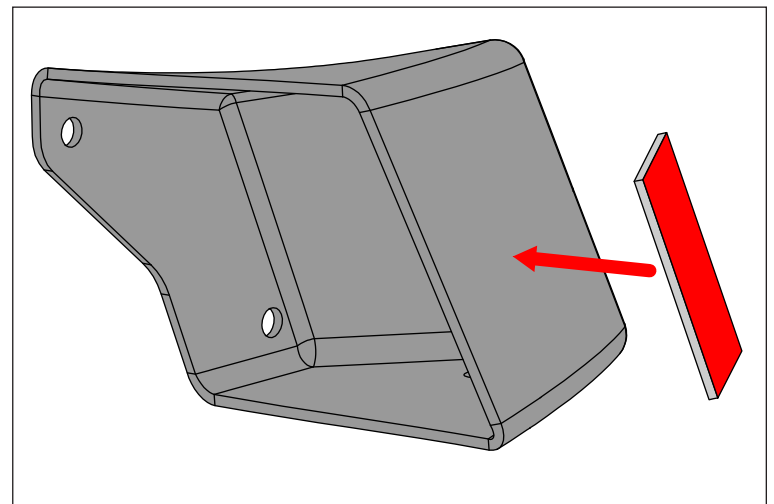



460 HORIZON DR. | SUWANEE, GA 30024 | PHONE: 770-614-6101 | FAX: 770-614-6069 | www.omix-ada.com

Max Terrain Flares, JT Patent Pending

24. Attach flare clips to the shown locations on the rear flare.

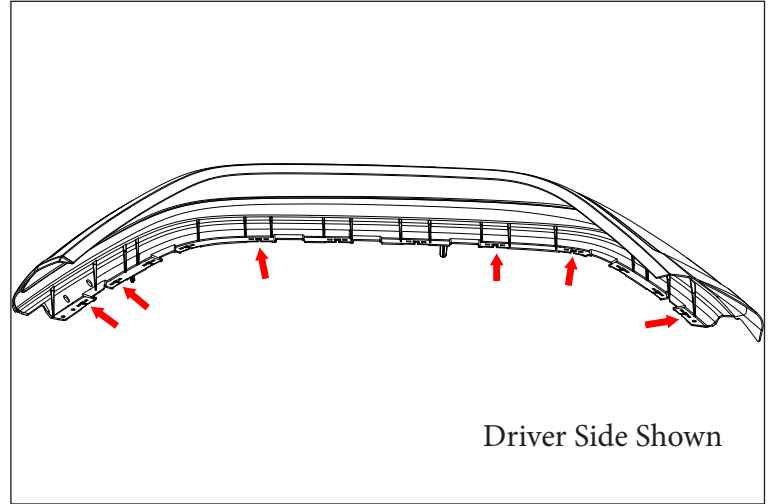

25. Affix rear flares to the vehicle using flare clips.

26. Using supplier M6 bolt and washer, affix rear liner and flares to vehicle.

27. Gently pull rear flare away, and remove backing from double sided tape on rear stanchion. Press rear flare and rear stanchion together.

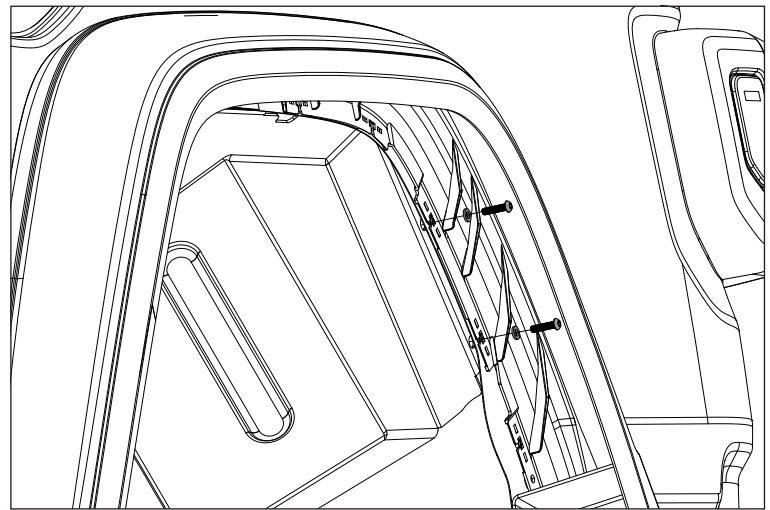

28. Tighten hardware. Reconnect primary and secondary Battery.

NOTICE Hyper flash or a DRL error may show on the dash after starting the vehicle. The vehicle's computer system should cycle any errors after a day or two of normal driving.