

## Windbreaker, 4 Door

1. **SOFT TOP VEHICLE:** Refer to owner's manual for instructions on lowering factory top. Once open, unscrew shoulder bolts fastening top to sport bar and remove soft top.

**HARD TOP VEHICLE:** Refer to owner's manual for instruction on removing factory hard top.

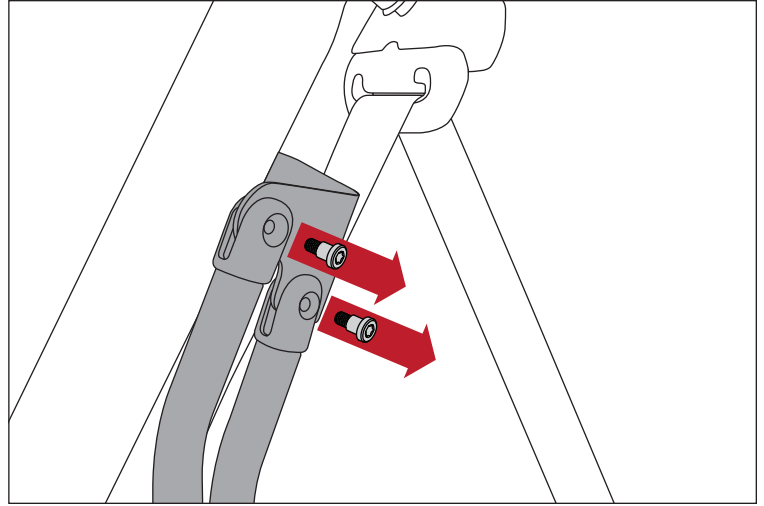

2. Orient windbreaker with window on top and vinyl side facing rear of vehicle. Start with top straps and thread end of each strap around sport bar and through each buckle as shown. Loosely tighten each strap to hold windbreaker in place.

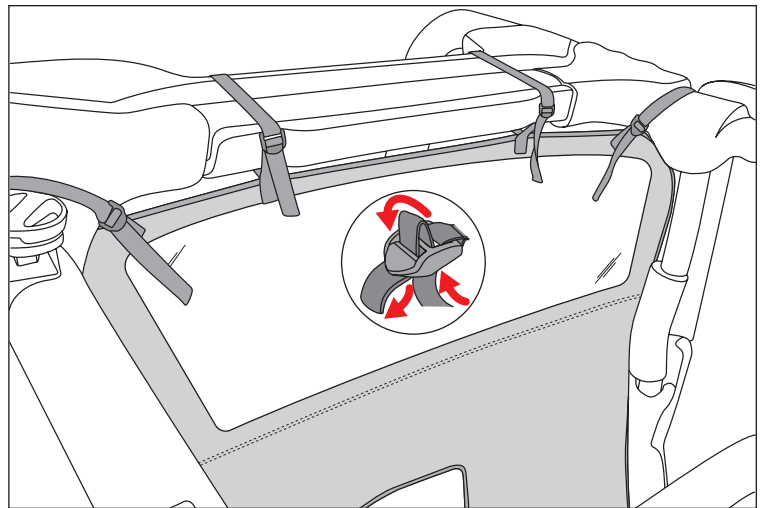

3. Secure windbreaker to seat brackets. Pull down gently on the gabric and thread straps through back of seat brackets. Buckle straps and tighten all straps.

### NOTICE

If installing with optional tonneau cover extension proceed to Step 4. Otherwise, installation is complete

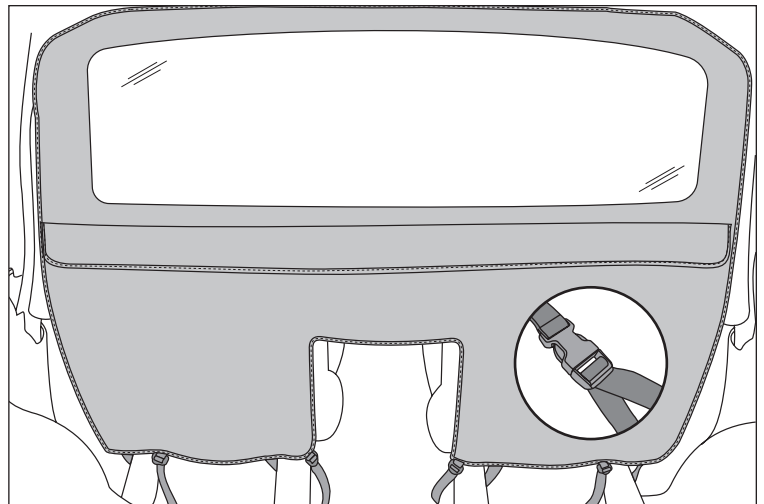

## Windbreaker, 4 Door

4. Zip windbreaker to tonneau cover extension using zipper under flap of windbreaker.

