



OMIX-ADA, Inc.

460 HORIZON DR. SUITE 400 | SUWANEE, GA 30024 | PHONE: 770-614-6101 | FAX: 770-614-6069 | info@omix-ada.com

Rocker Guard, Body Armor; JLU

Rugged Ridge only approves installing the Rocker Guard, Body Armor according to these written instructions with the hardware provided. **WARNING:** Failure to install according to these instructions will invalidate the warranty. This includes, but is not limited to using alternative installation methods, hardware, or materials. **DO NOT USE: Loctite, SuperGlue, or similar products on the hardware or the Rocker Guard, Body Armor.**

Fit: Verify the fit of the Rocker Guard, Body Armor to vehicle. (Some filing, sanding, or cutting may be necessary to ensure proper fit).

Painting: (Optional) if paint is desired it must be done prior to installing the Rocker Guard, Body Armor on the vehicle. Clean outer surface with a good grade degreaser. **DO NOT USE LACQUER THINNER OR ENAMEL REDUCER AS A DEGREASER.** Wipe outer surface thoroughly with a tack rag prior to paint. Application of plastic adhesion promoter for TPO plastic as per your paint system manufacturer's recommendations is required. Paint the Rocker Guard, Body Armor using a high quality enamel, or polyurethane automotive paint.

Exhaust System: Modifications may be necessary to maintain a minimum 4" clearance between armor and exhaust pipes. (Exhaust gases should not vent directly onto the Rocker Guard, Body Armor)

Metal Protection: All exposed fasteners and bare metal should be treated with rust resistant paint BEFORE installing the Rocker Guard, Body Armor.

Decals: The Rocker Guard, Body Armor may interfere with existing decals on vehicle. If you wish, remove decals prior to installation of the Rocker Guard, Body Armor.

Components



1. Alcohol Prep Pad.....(4)

OMIX-ADA® TECHNICAL SUPPORT

PHONE: M-F 8am - 5pm EST 1-800-449-6649 | EMAIL: techsupport@omix-ada.com

FOR WARRANTY INFORMATION VISIT: www.Omix-Ada.com



OMIX-ADA, Inc.



460 HORIZON DR. SUITE 400 | SUWANEE, GA 30024 | PHONE: 770-614-6101 | FAX: 770-614-6069 | info@omix-ada.com

Rocker Guard, Body Armor; JLU

1. Front Side Panel Installation Procedure (Driver's Side)

Peel back 2" of tape liner from each flange. Using a marker, number the tape tabs as shown:

1: Tape tab removed in step 4.

NOTE: Pull back 4" of tape liner at this location.

2: Tape tab removed in step 5.

3: Tape tab removed in step 6.

4: Tape tab removed in step 7.

NOTE: This tab must hang down as shown.

5: Tape tab removed in step 8.

6: Tape tab removed in step 9.

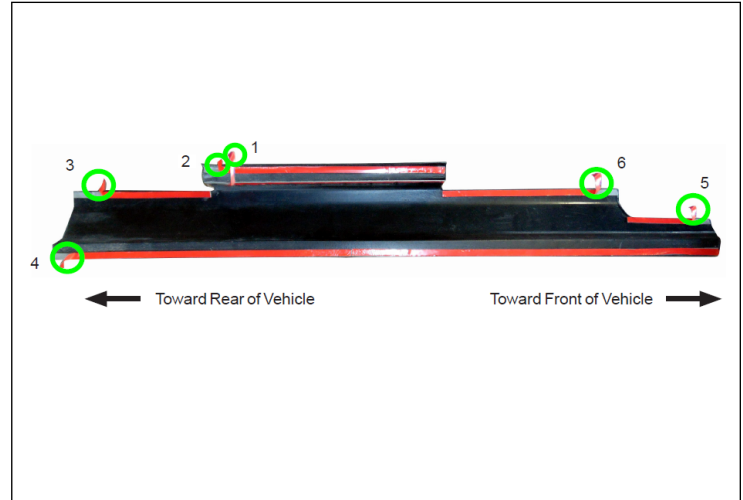

2. Open vehicle door. Clean all dirt and debris from vehicle then use supplied alcohol wipe where part will be.

NOTE: Temperature should be at least 60°F for proper tape adhesion.



3. Place part on vehicle, making sure to line up edges of part with edges of vehicle. Ensure that all tape tabs are accessible. Firmly press on exposed areas of tape to tack Trail Armor in place.

NOTE: Refer to step 1 for placement of certain tabs.





OMIX-ADA, Inc.

460 HORIZON DR. SUITE 400 | SUWANEE, GA 30024 | PHONE: 770-614-6101 | FAX: 770-614-6069 | info@omix-ada.com

Rocker Guard, Body Armor; JLU

4. Pull tape liner tab 1.



5. Pull tape liner tab 2.

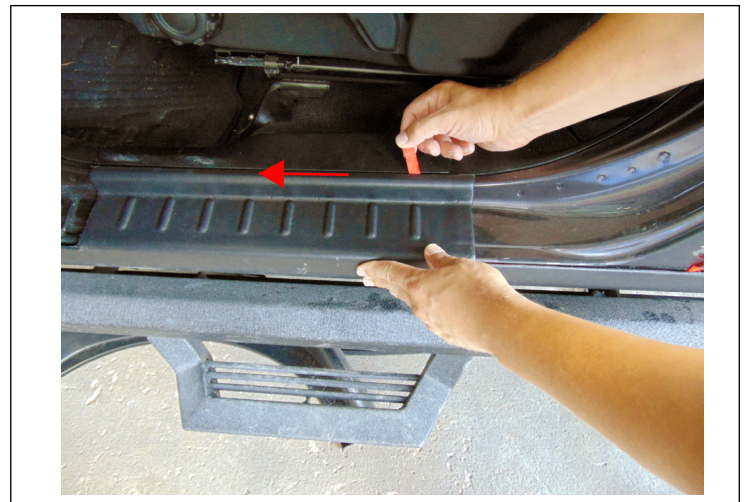

6. Pull tape liner tab 3.





OMIX-ADA, Inc.



460 HORIZON DR. SUITE 400 | SUWANEE, GA 30024 | PHONE: 770-614-6101 | FAX: 770-614-6069 | info@omix-ada.com

Rocker Guard, Body Armor; JLU

7. Pull tape liner tab 4.

NOTE: Refer to step 1 for additional tape tab identification.

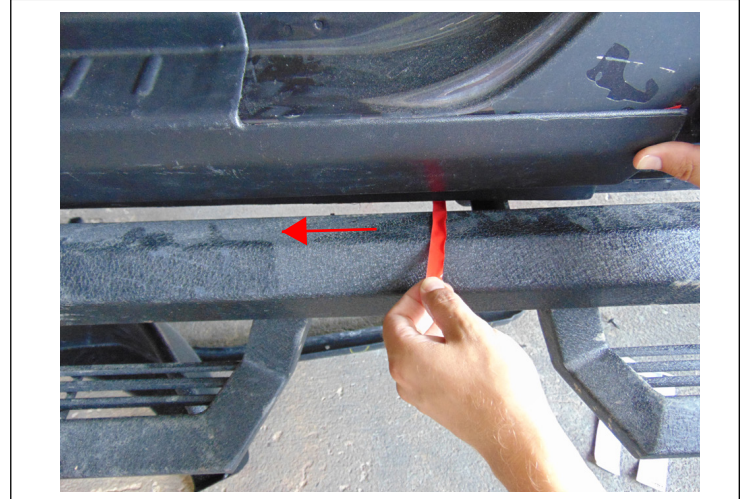

8. Pull tape liner tab 5.



9. Pull tape liner tab 6.





OMIX-ADA, Inc.



460 HORIZON DR. SUITE 400 | SUWANEE, GA 30024 | PHONE: 770-614-6101 | FAX: 770-614-6069 | info@omix-ada.com

Rocker Guard, Body Armor; JLU

10. Once all tape liners are peeled, press down on entire length of part applying strong force to taped areas.

NOTE: The tape reaches maximum adhesive bond after 24 hours of contact. Do not wash vehicle for 24 hours.



11. Rear Side Panel Installation Procedure (Driver's Side)

Peel back 2" of tape liner from each flange. Using a marker, number the tape tabs as shown:

1: Tape tab 1-4 as shown.

2: Tape tab 5.

NOTE: Pull back 4" of tape liner at this location.

NOTE: This tab must hang down as shown for removal.

3: Tape tab 6.

NOTE: This tab must hang down as shown for removal from tape.

4: Tape tab 7.

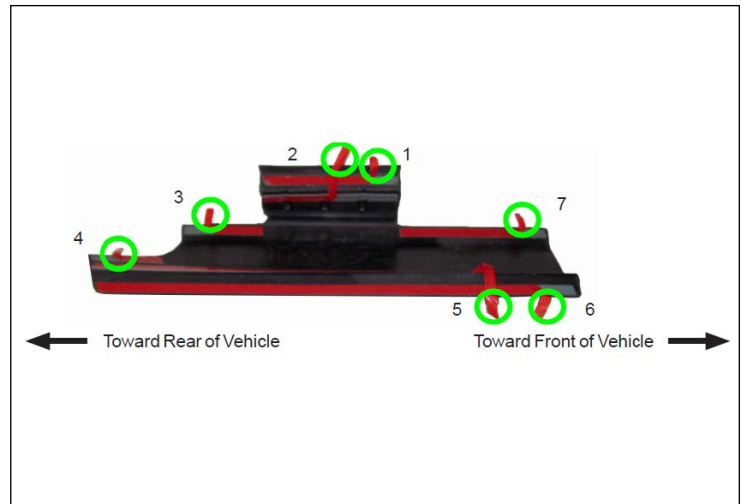

12. The Rear Side Panel installs with the same preparation methods as the front.

Repeat steps 1-12 for passenger side of truck.

