

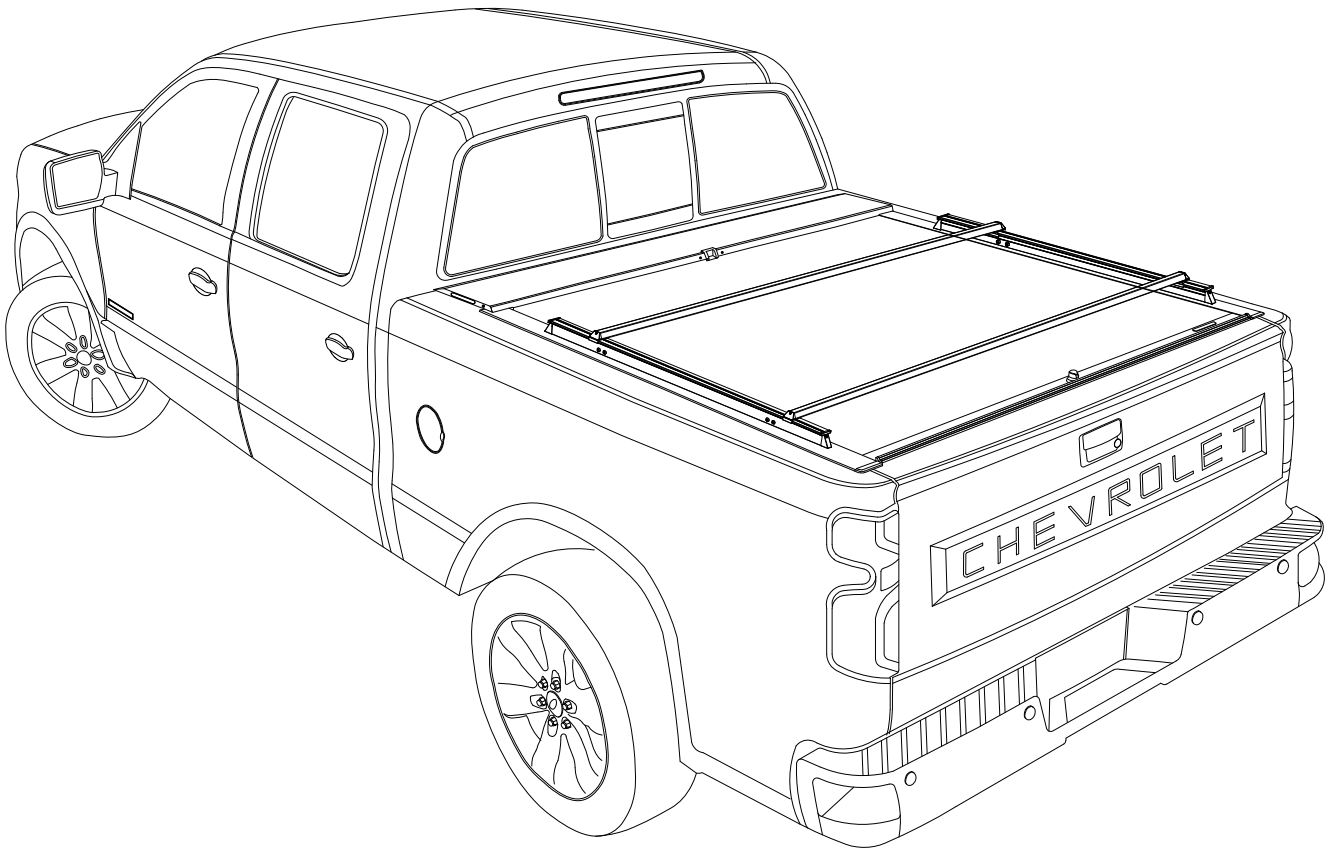

QwikRak Installation Guide

2019 Chevrolet Silverado / GM Sierra with Multi-Pro Step Option



Product Code
QR223-QR224

Item	Part Name	Qty.	Item	Part Name	Qty.	Item	Part Name	Qty.
A	QwikRak Track	2	F	1/4" Lock Washer	2	K	Cargo Nut	2
B	Cross Bar	2	G	1/4" Flat Washer	2	L	1/4" Allen Wrench	1
C	5/16" x 1" Socket Cap Screw	6	H	5/16" x 3/4" Socket Cap Screw	4	M	3/16" Allen Wrench	1
D	5/16" Lock Washer	6	I	5/16" Nylon Lock Nut	4	N	Track Clamp Bracket	1
E	1/4"-28 Socket Cap Screw	2	J	#10-24 X 3/8" Screw	2			

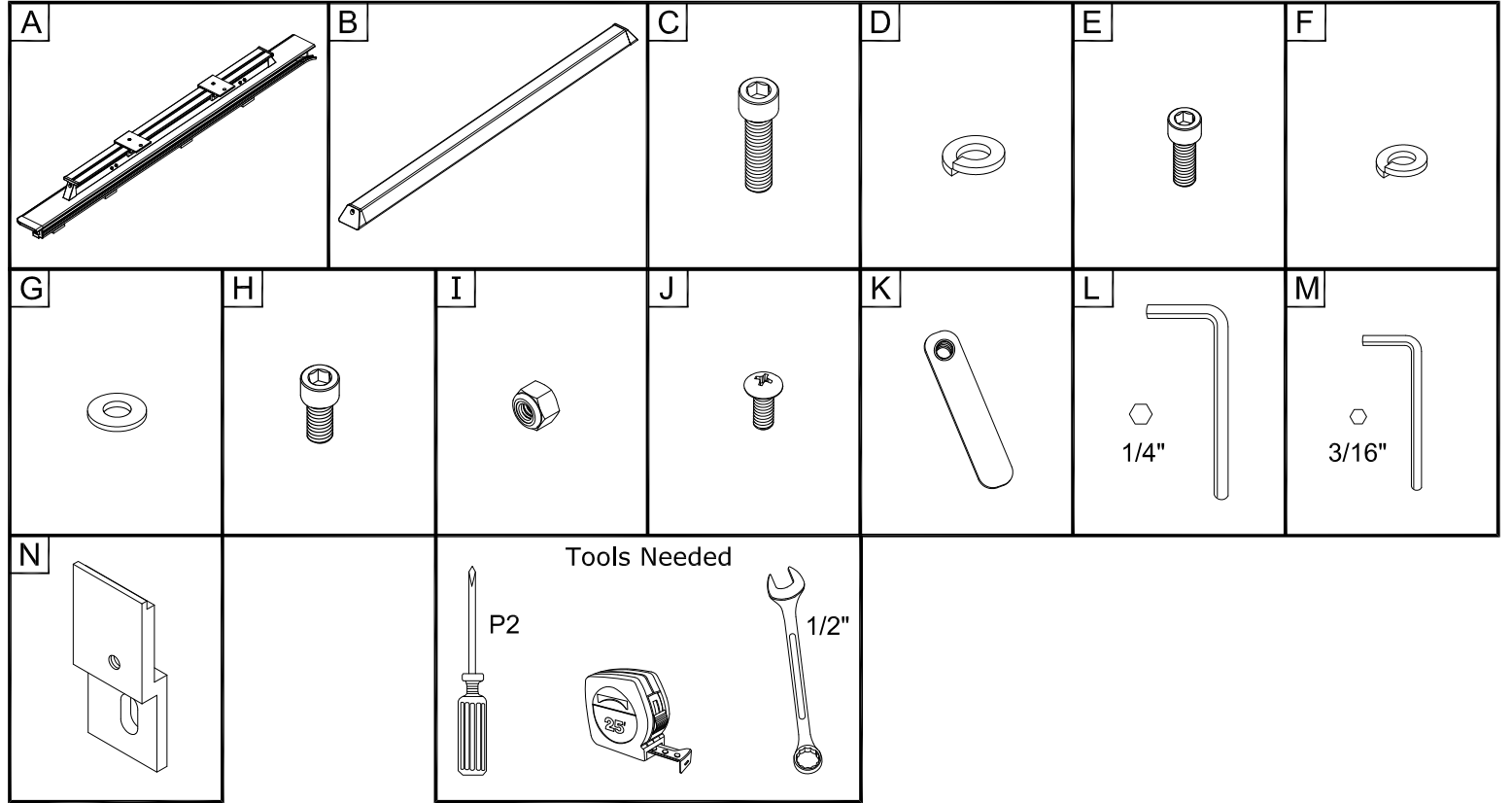

1 LHS = RHS

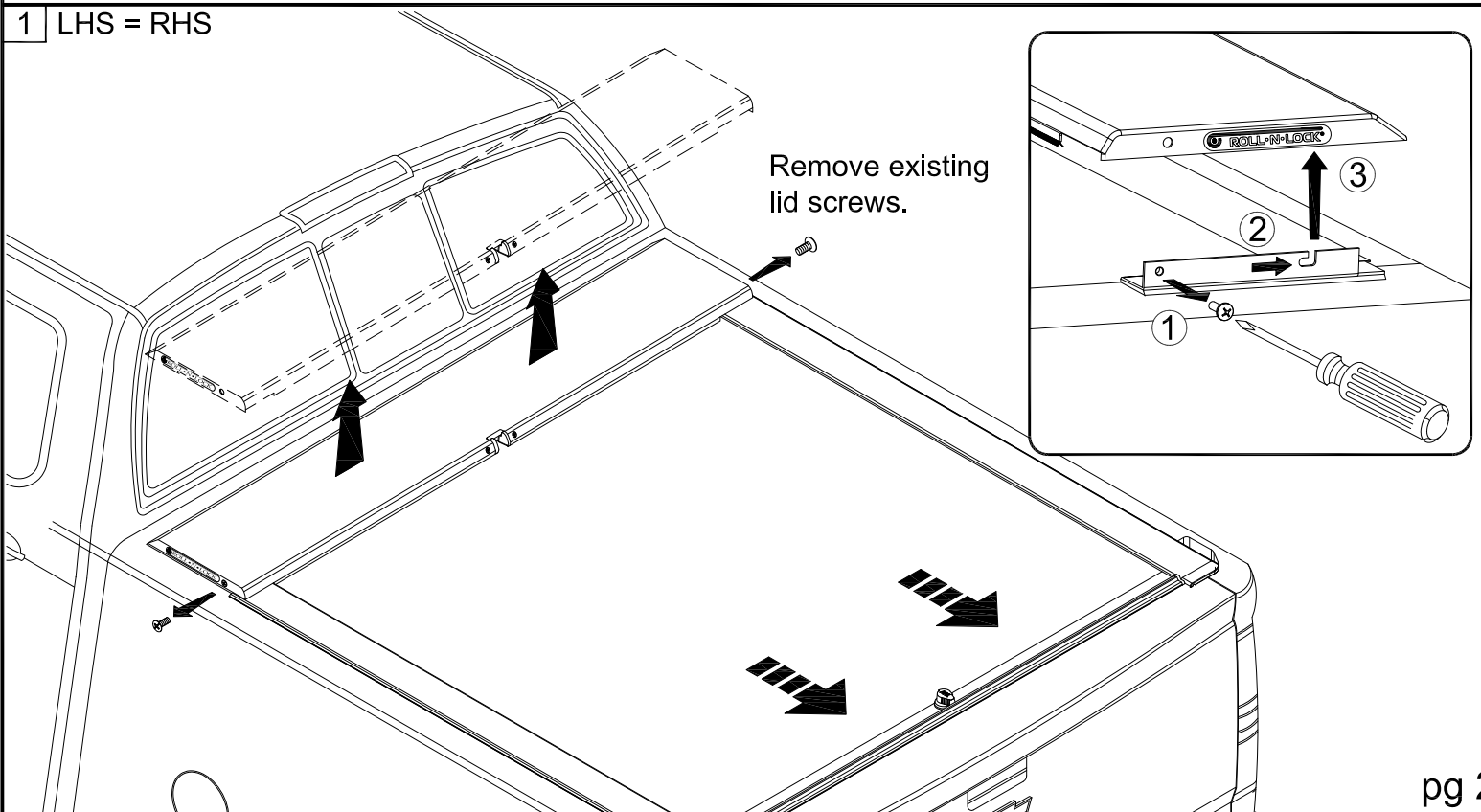

IF TRUCK IS **NOT** EQUIPPED
WITH THE MULTI-PRO STEP
PROCEED WITH PAGES 2-11.

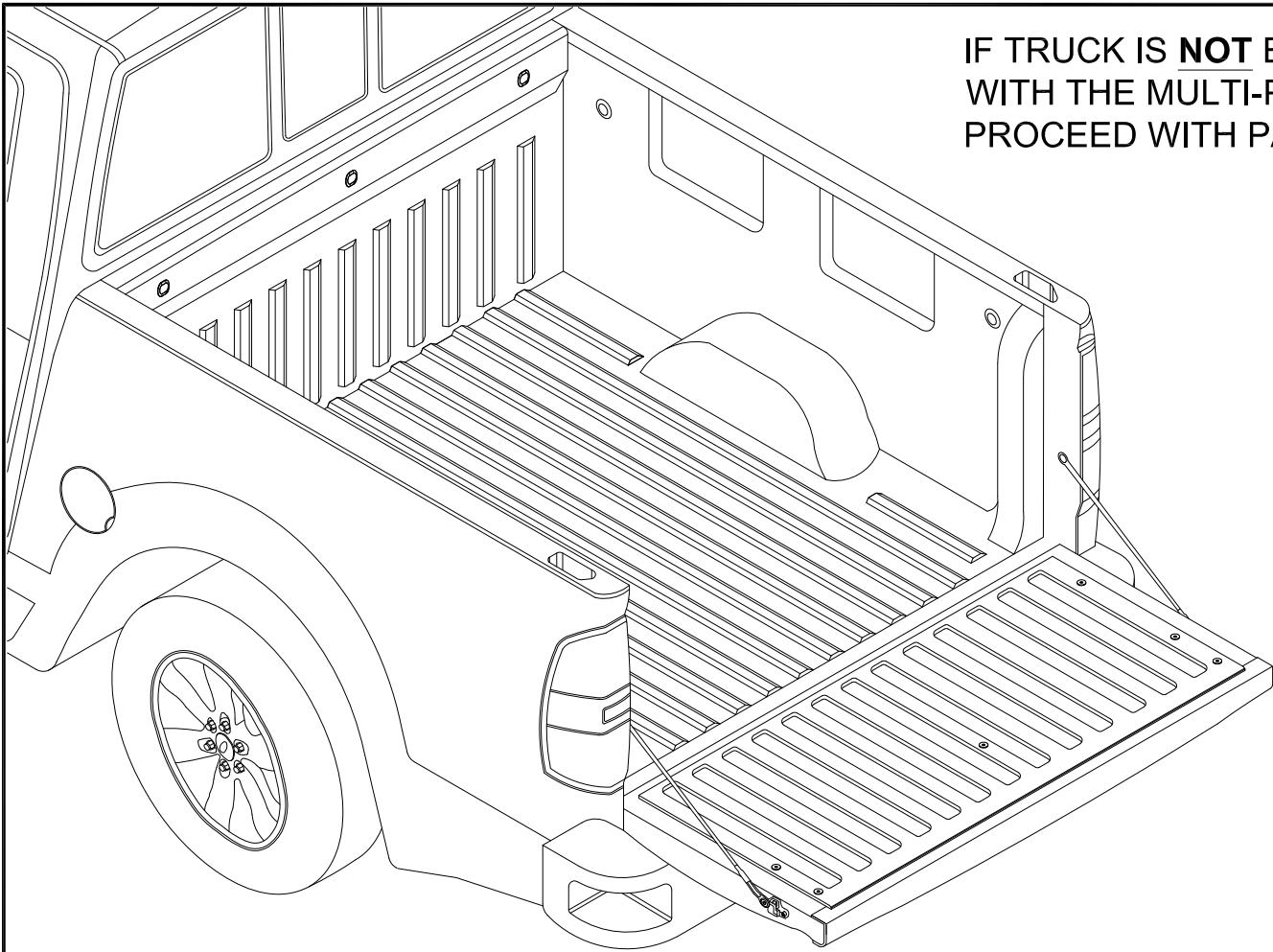

IF TRUCK IS EQUIPPED WITH
THE MULTI-PRO STEP
PROCEED WITH PAGES 12-22.

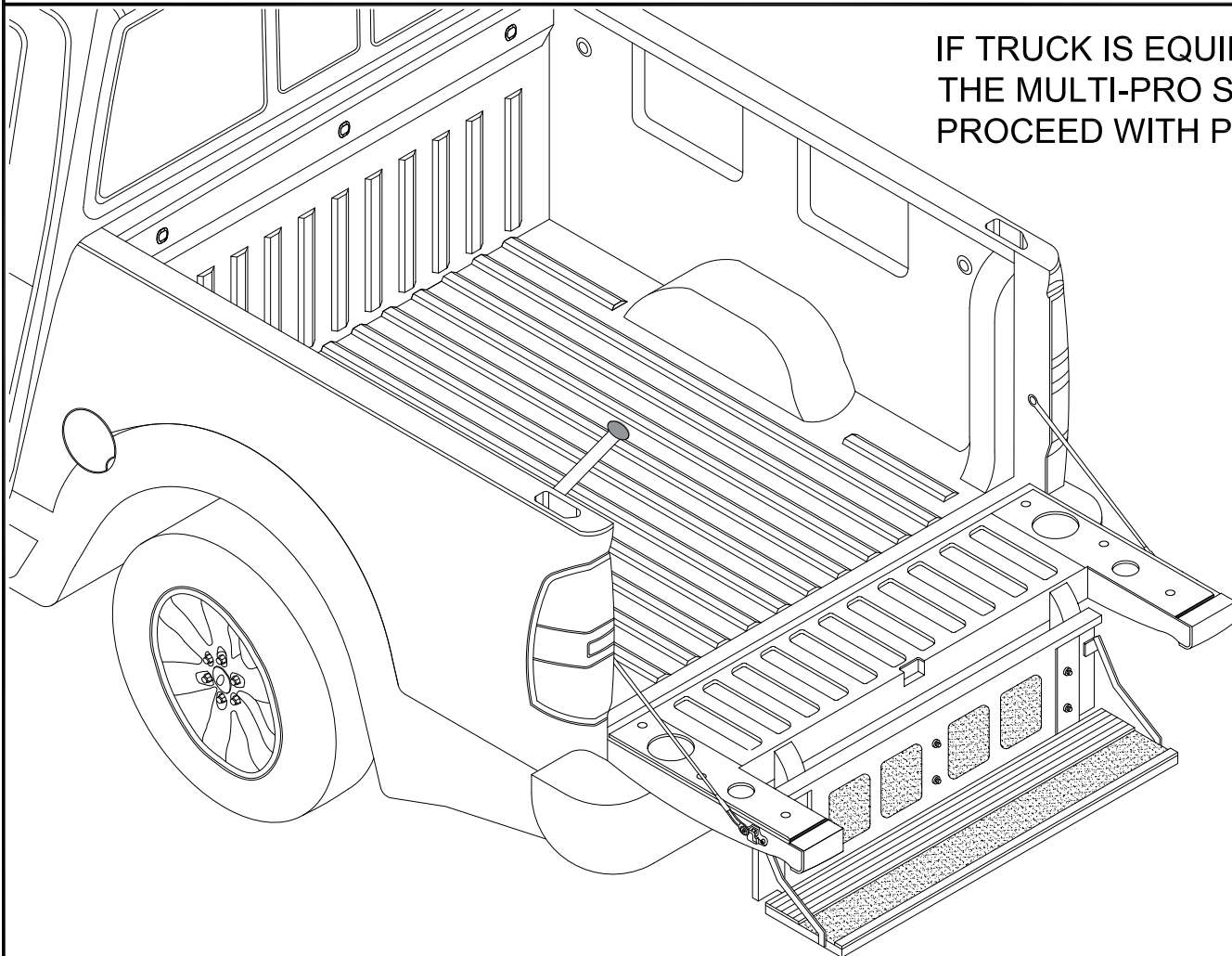

2 LHS = RHS

Place a buffer between the housing and cover to prevent the cover from rolling back.

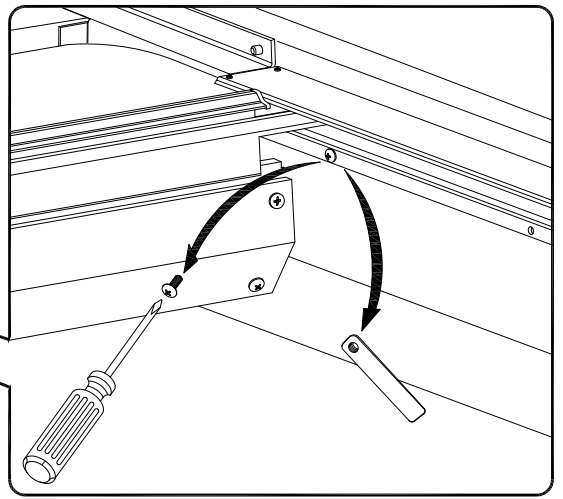

3 LHS = RHS

Remove existing clamps.

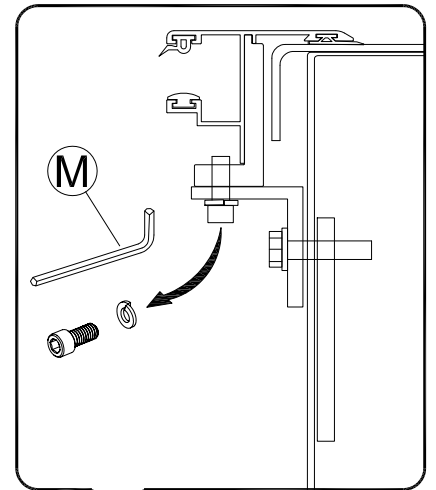
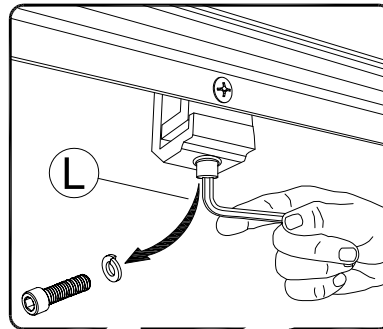

4 LHS = RHS

Remove existing tracks.

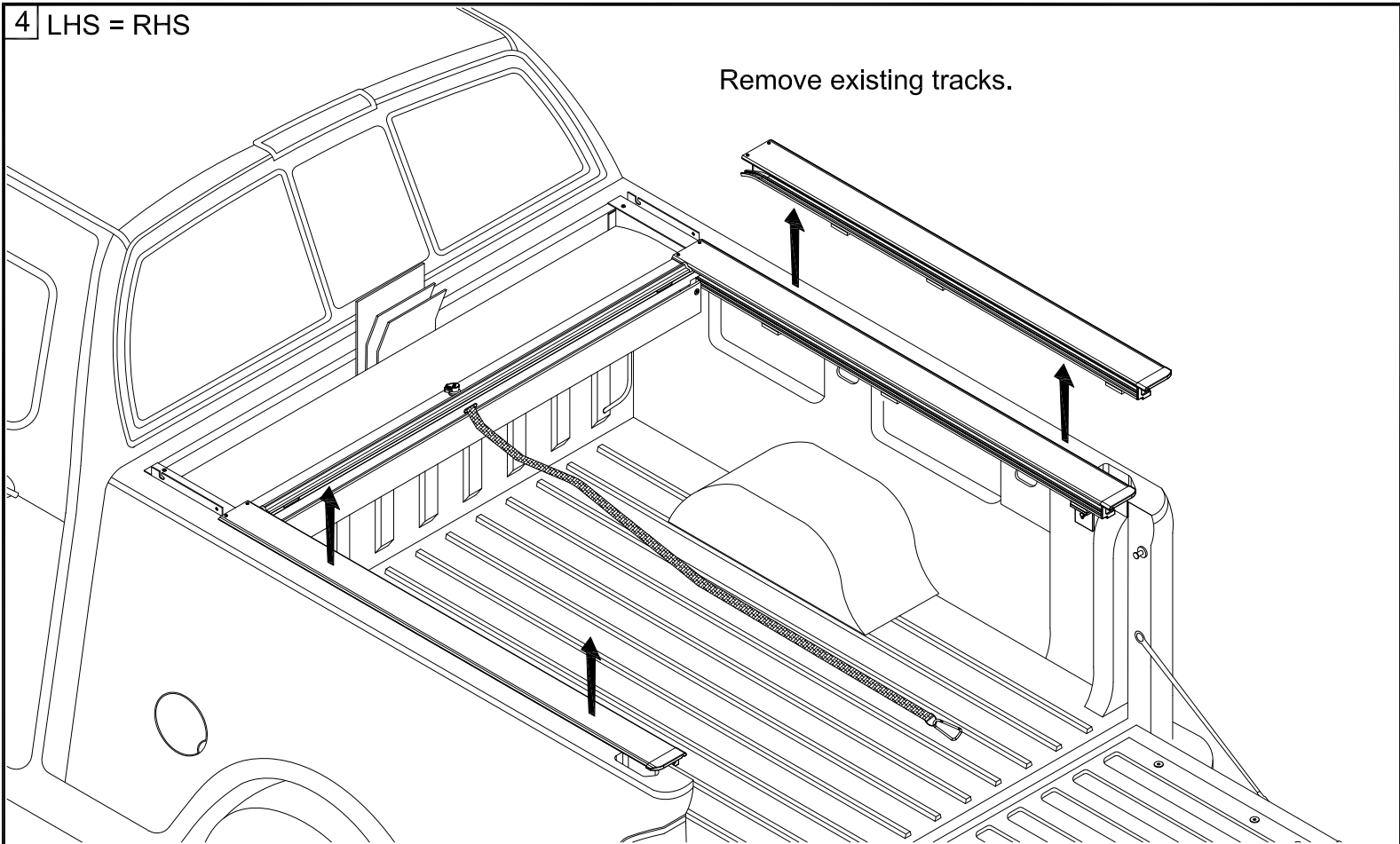

5 LHS = RHS

Replace with Qwikrak tracks.

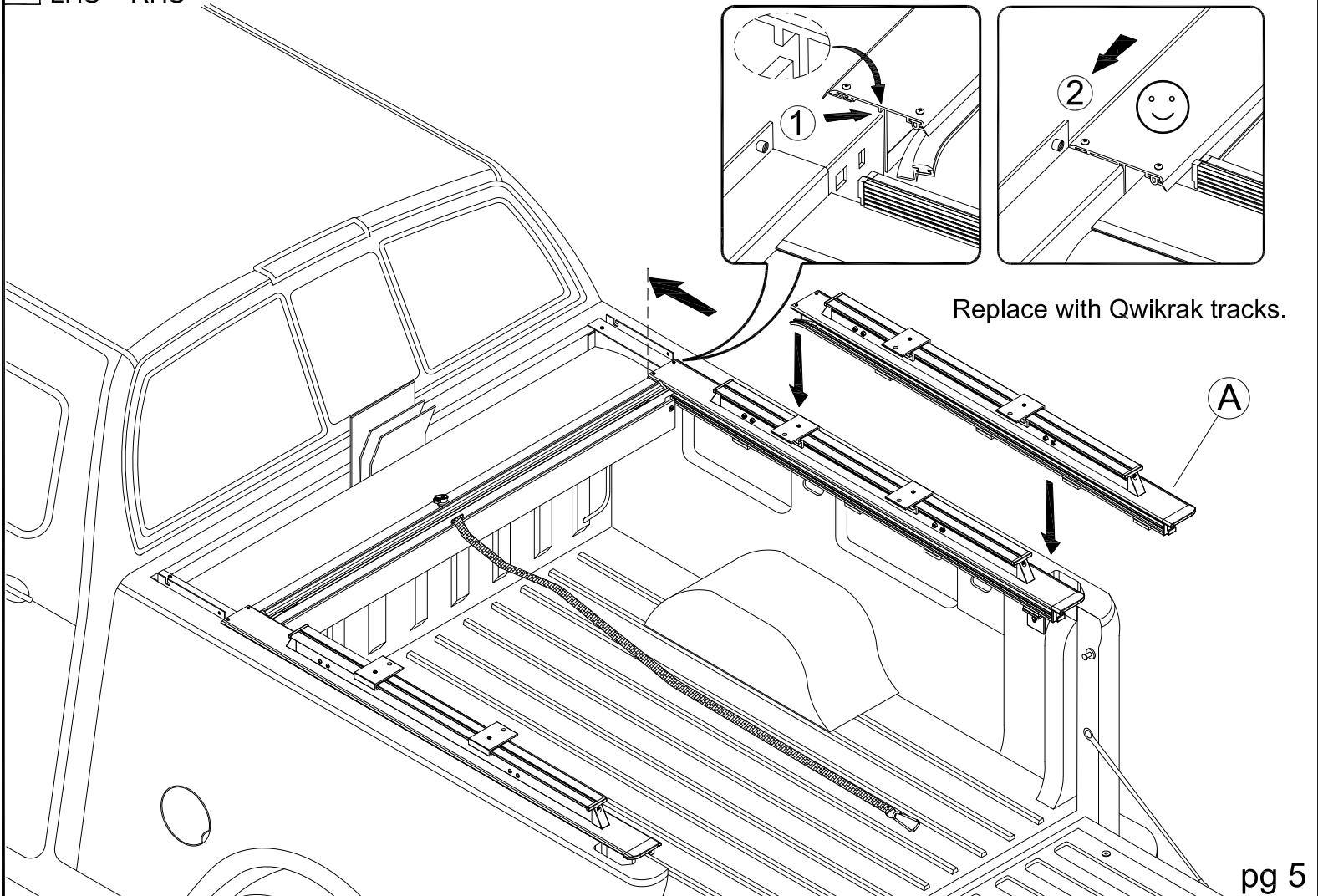

6 LHS=RHS

Use new hardware.
Use existing clamps.

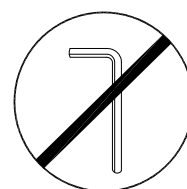
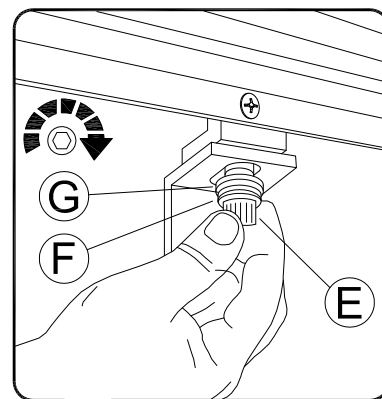
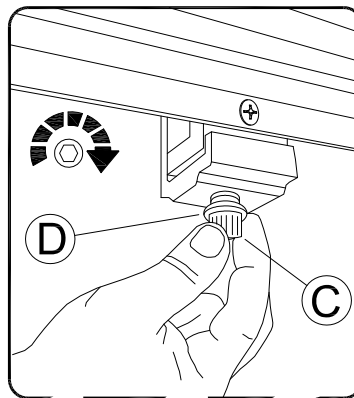

7 LHS = RHS

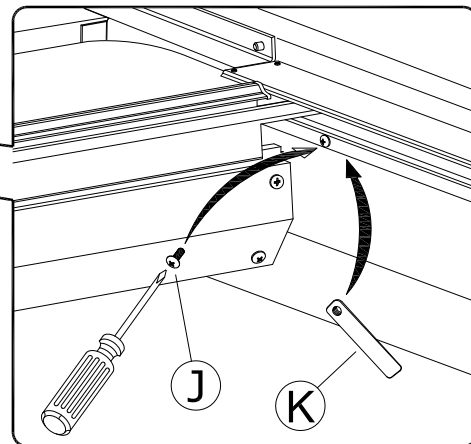

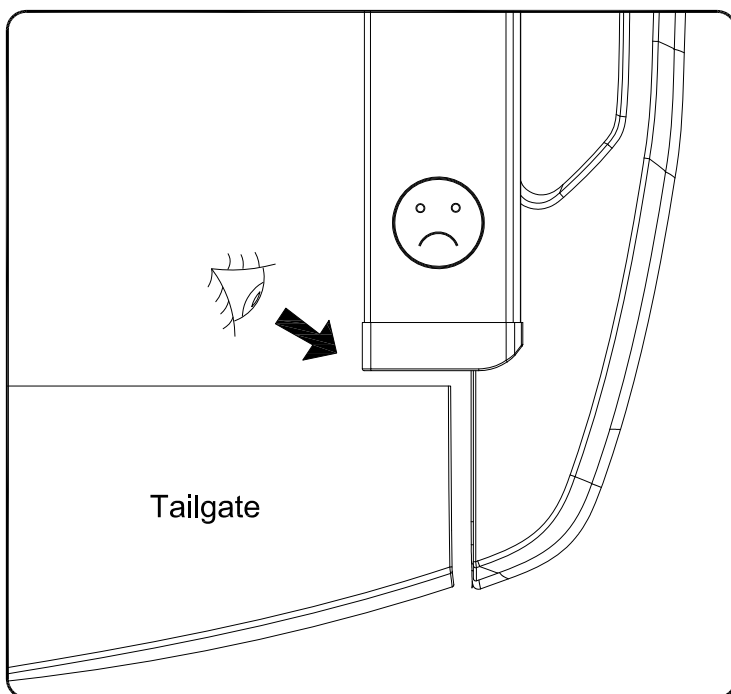
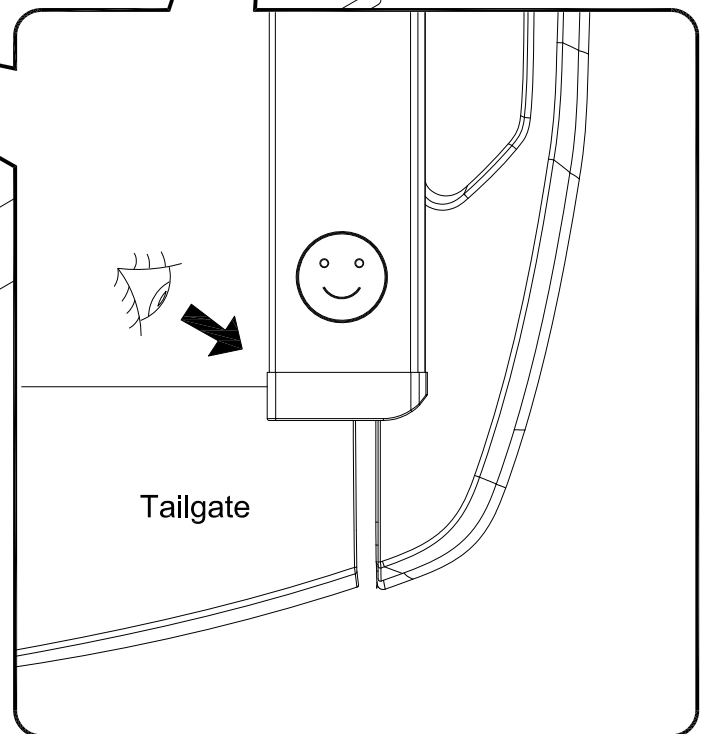
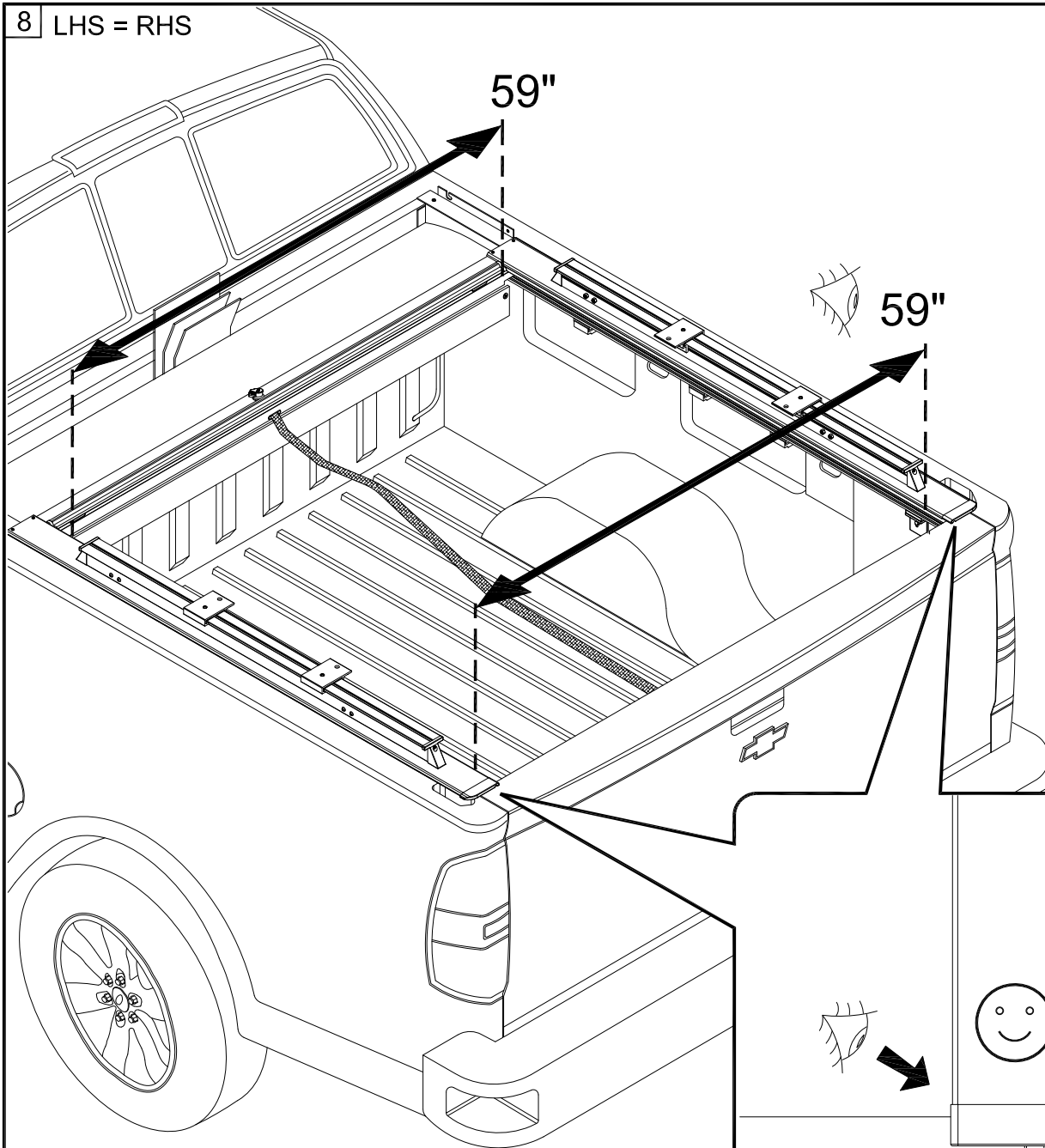

9 LHS = RHS

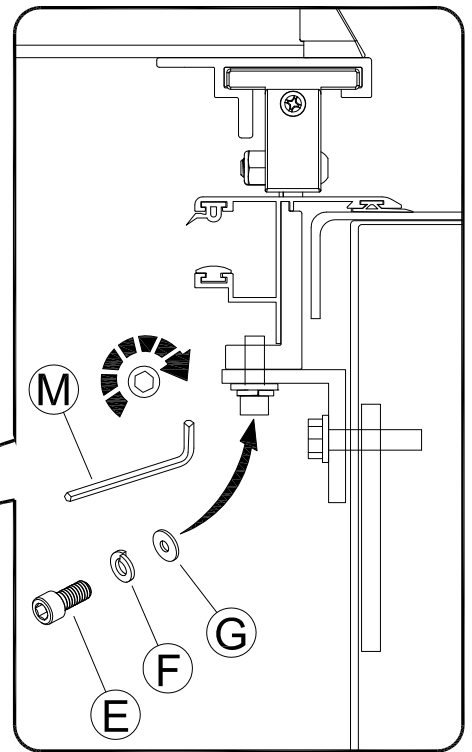
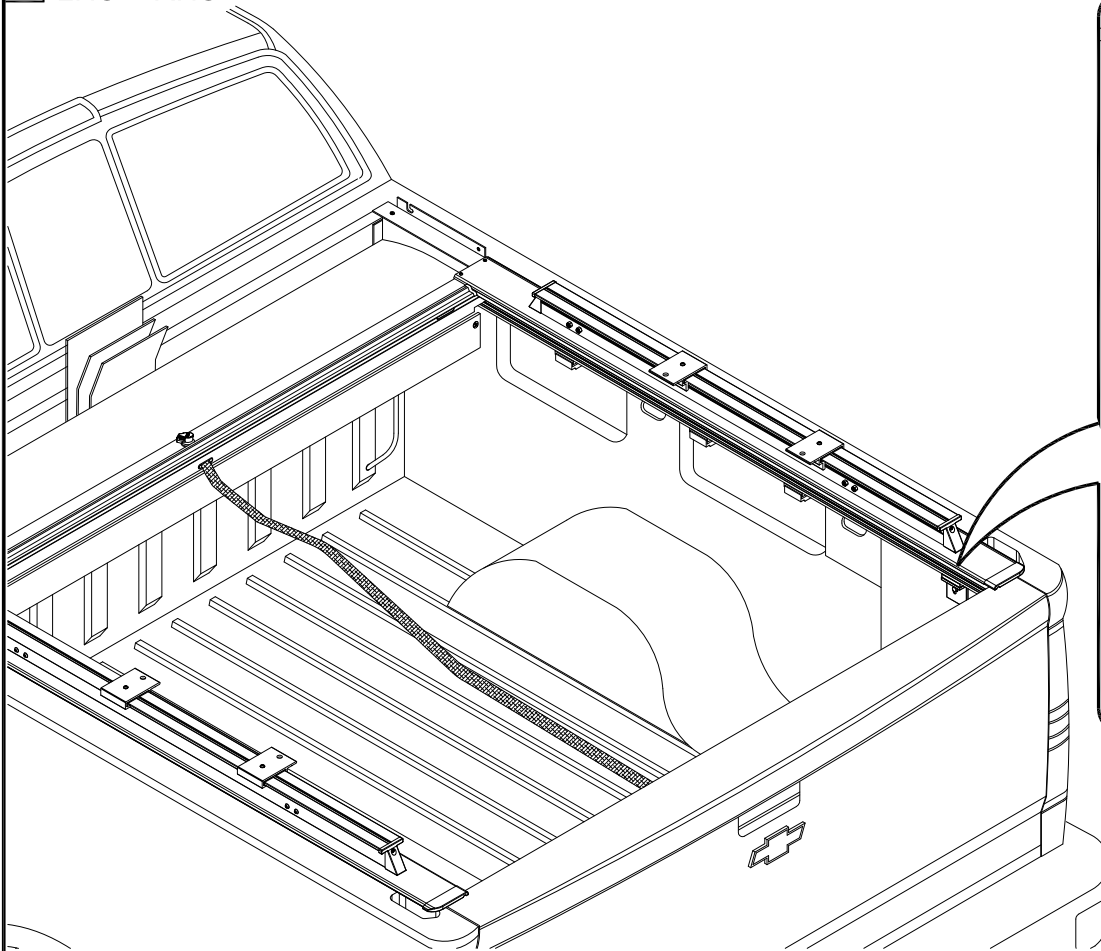

10 LHS = RHS

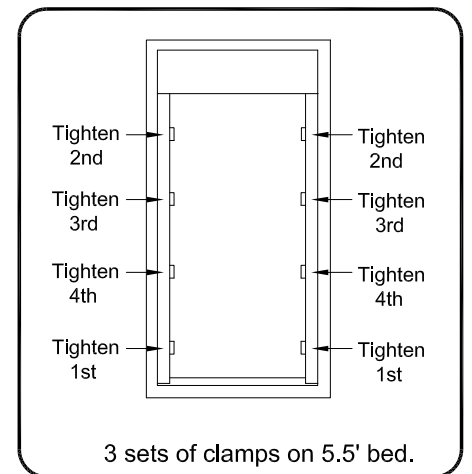
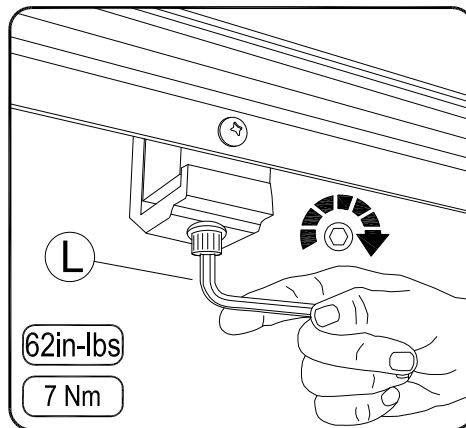
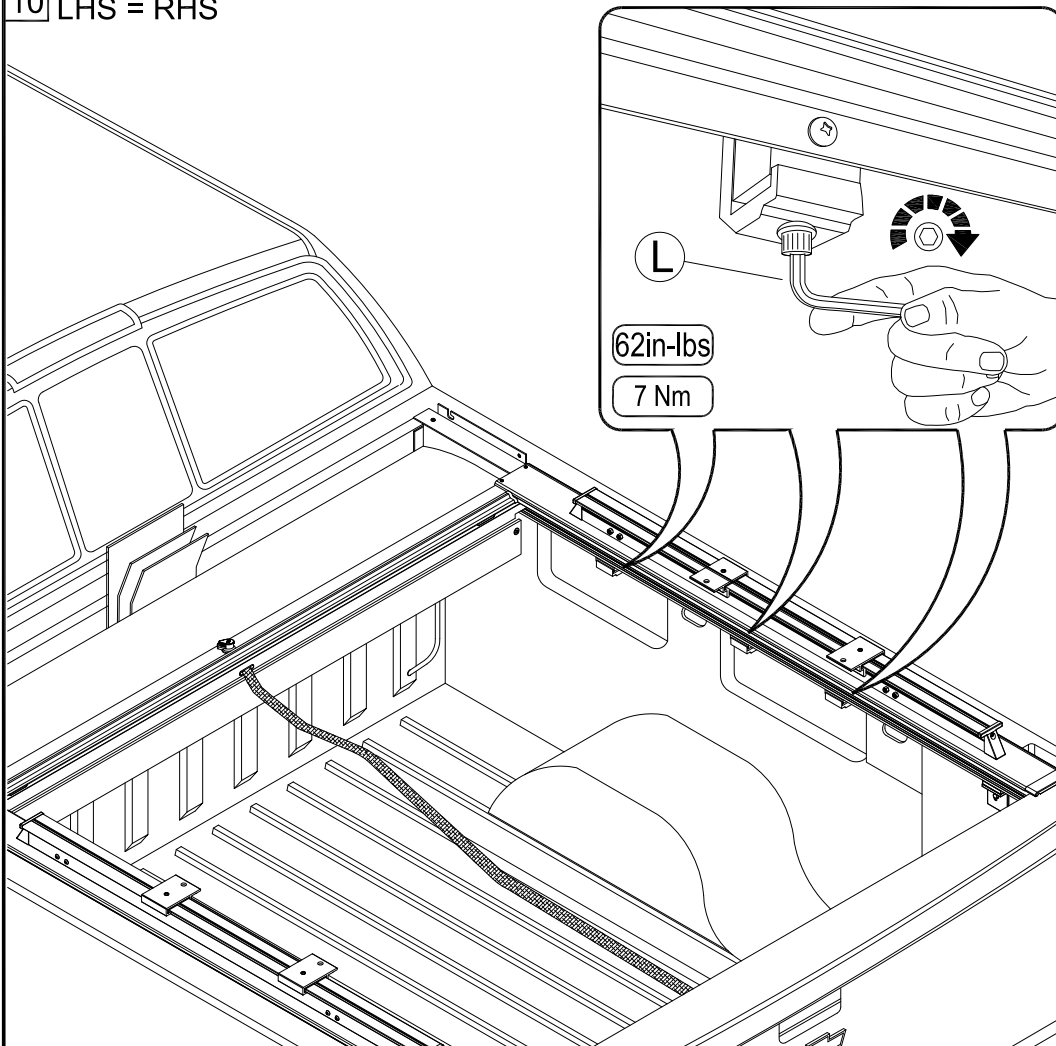

11

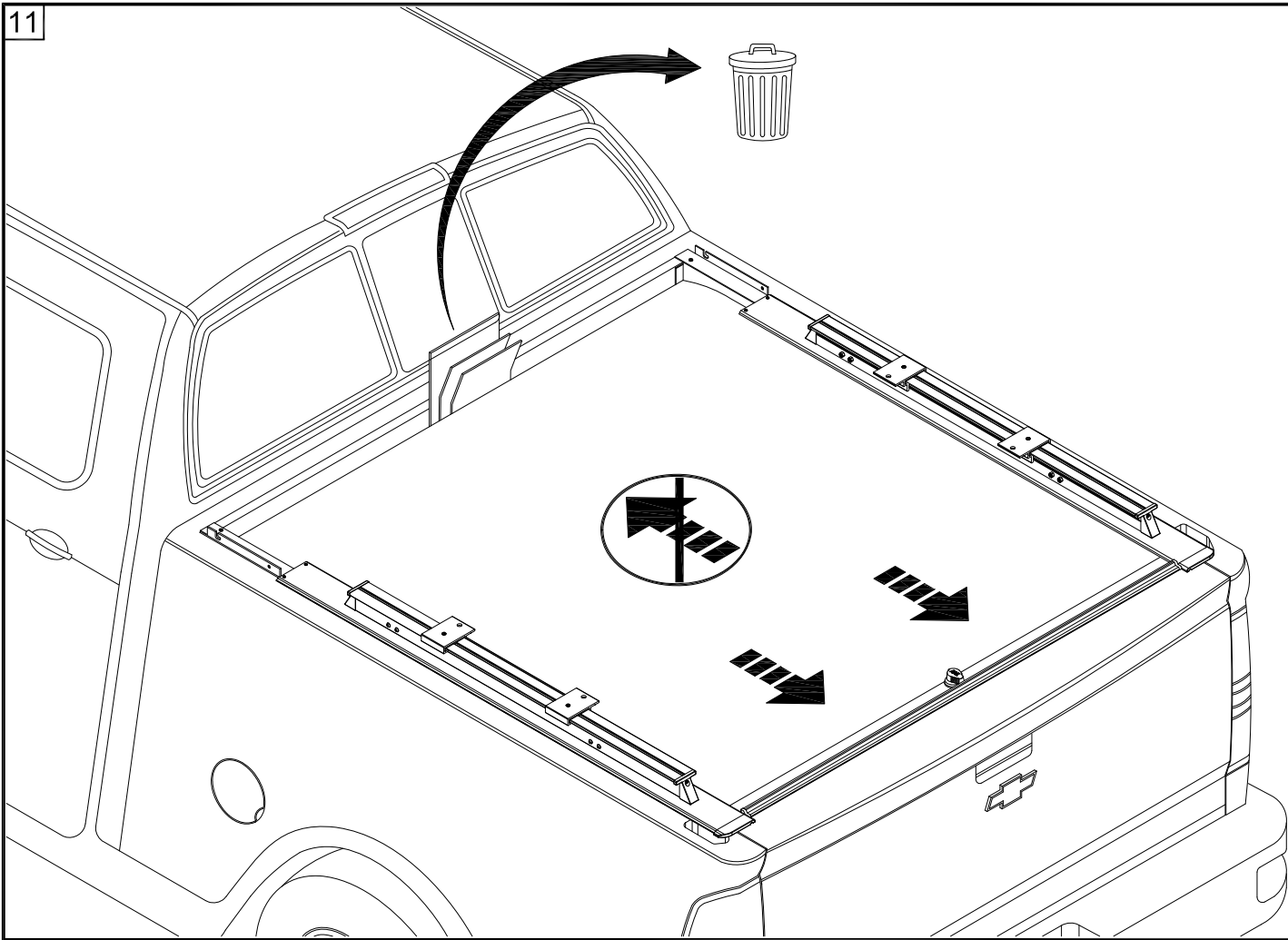

12 LHS = RHS

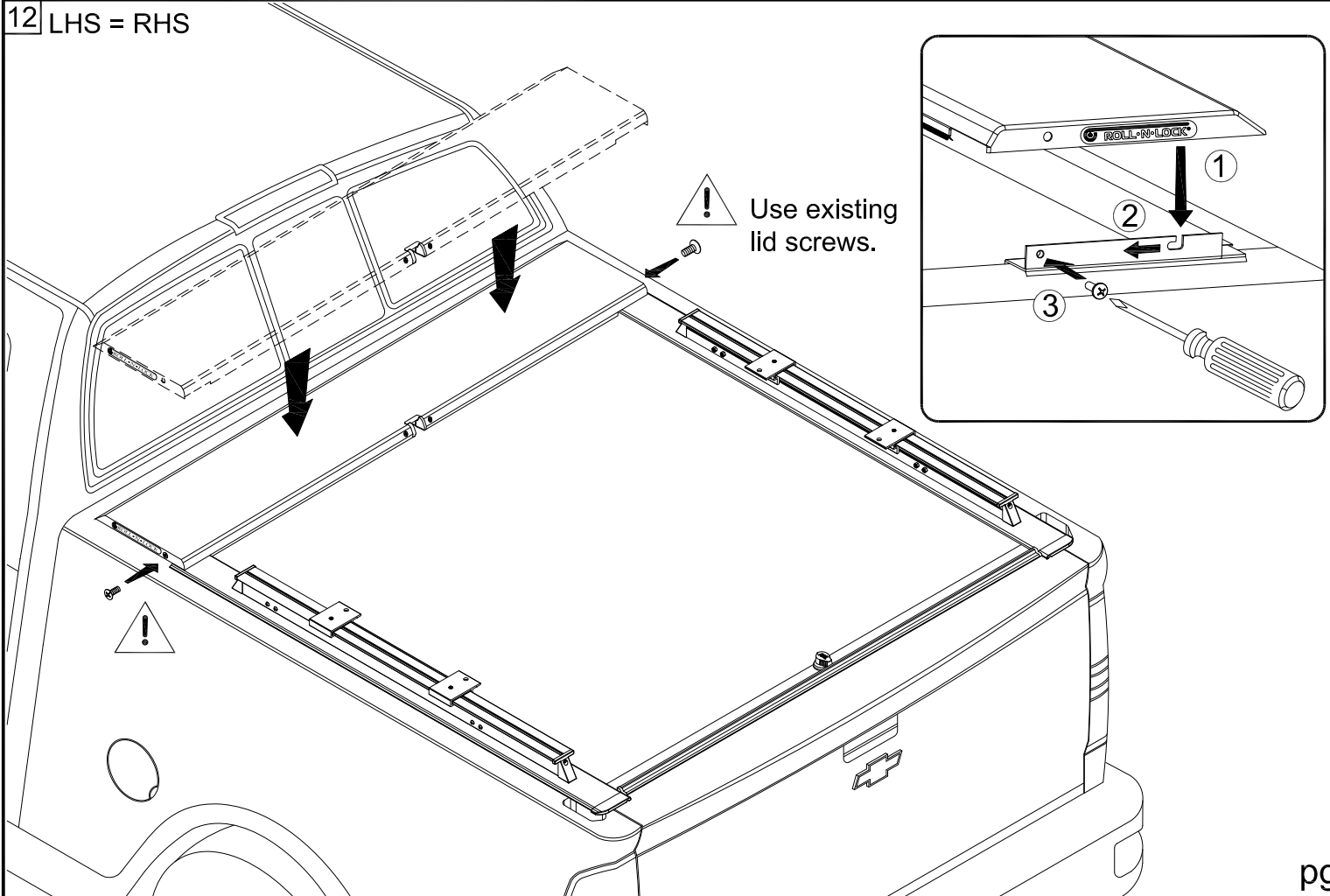

13

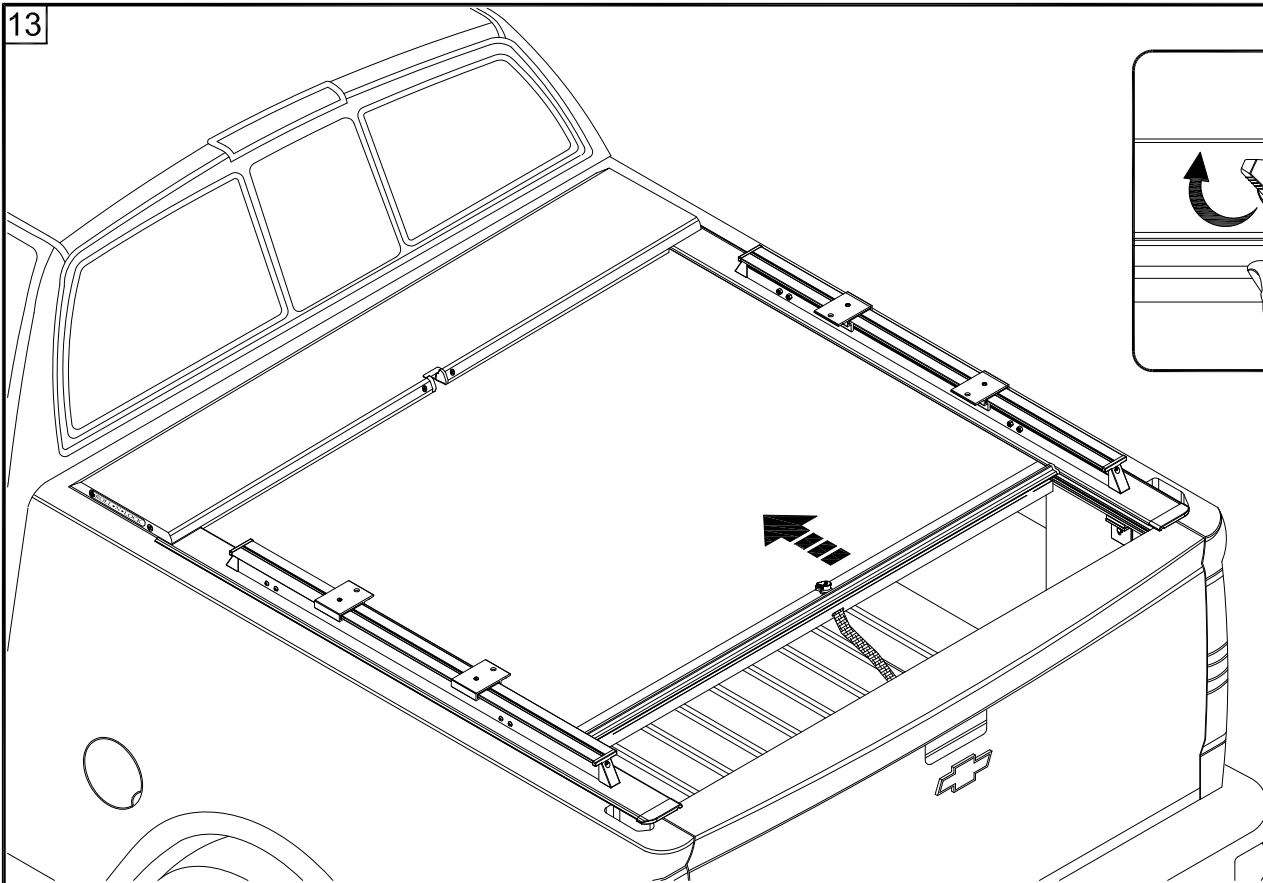

14 LHS = RHS

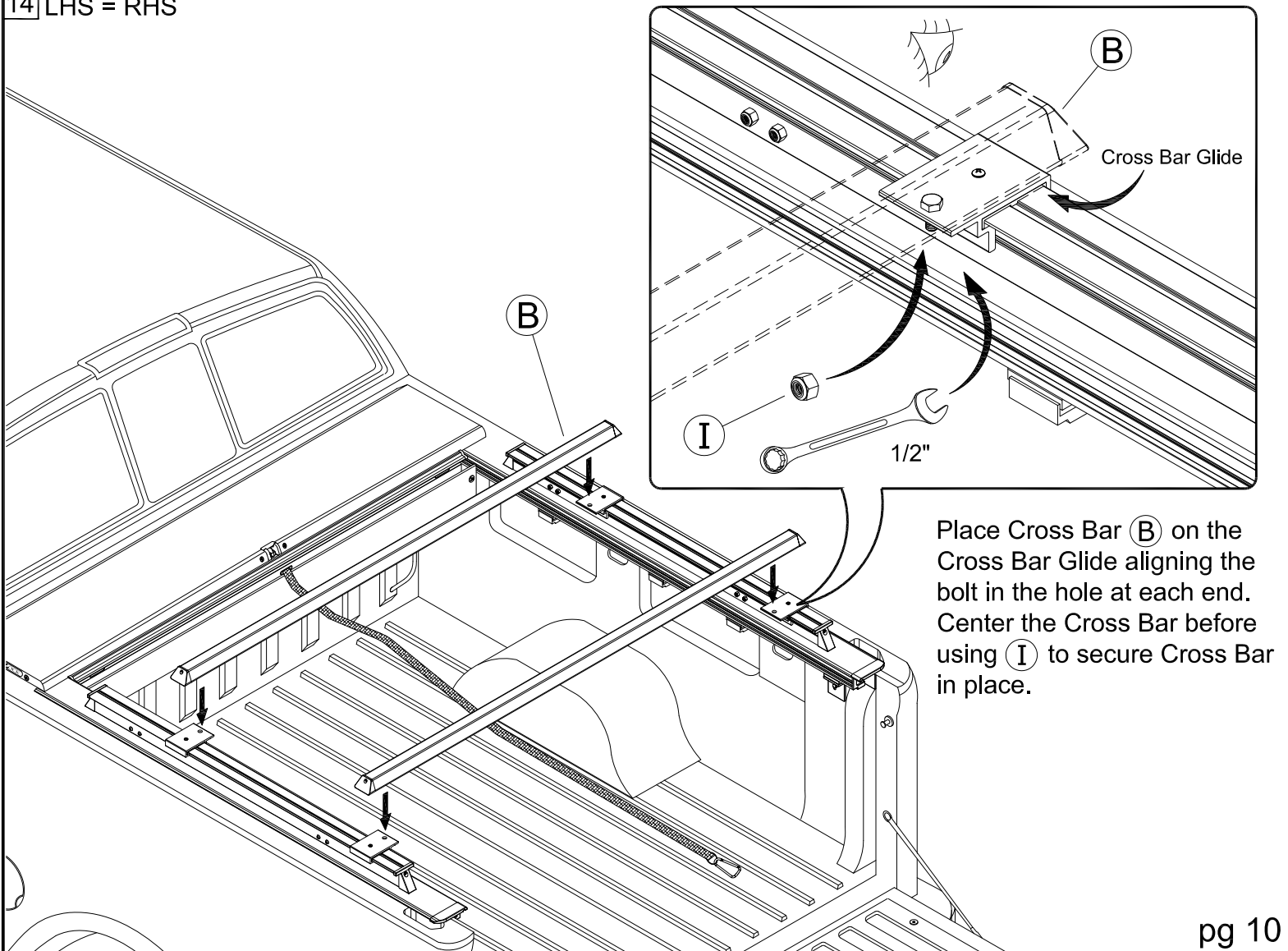

Once a desired location for the Cross Bar has been determined use (H) to thread through the hole in the Cross Bar Glide. Use supplied (L) to secure Cross Bars in place.

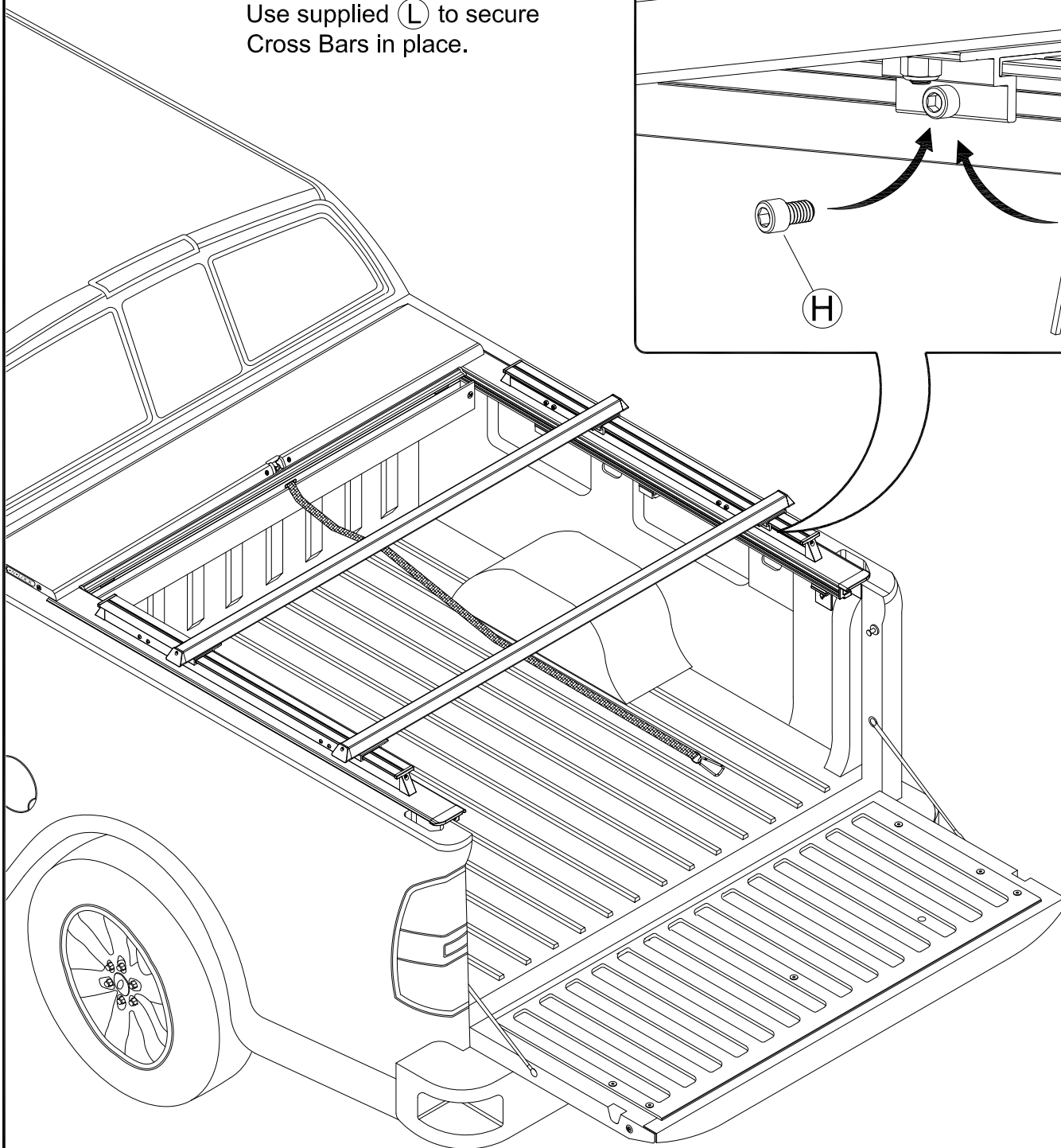

IF TRUCK IS EQUIPPED WITH THE MULTI-PRO STEP
PROCEED WITH PAGES 12-22.

1 LHS = RHS

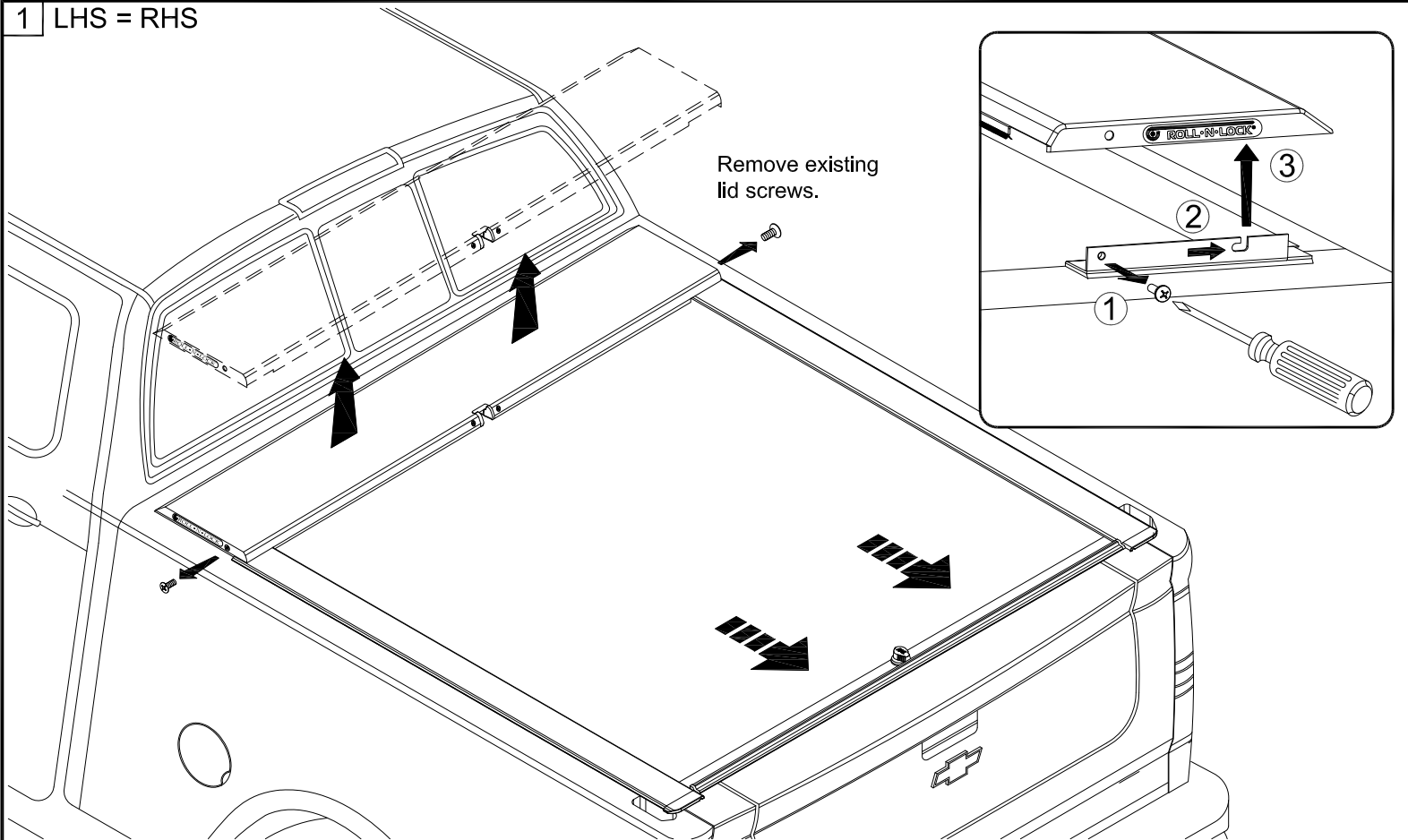

2 LHS = RHS

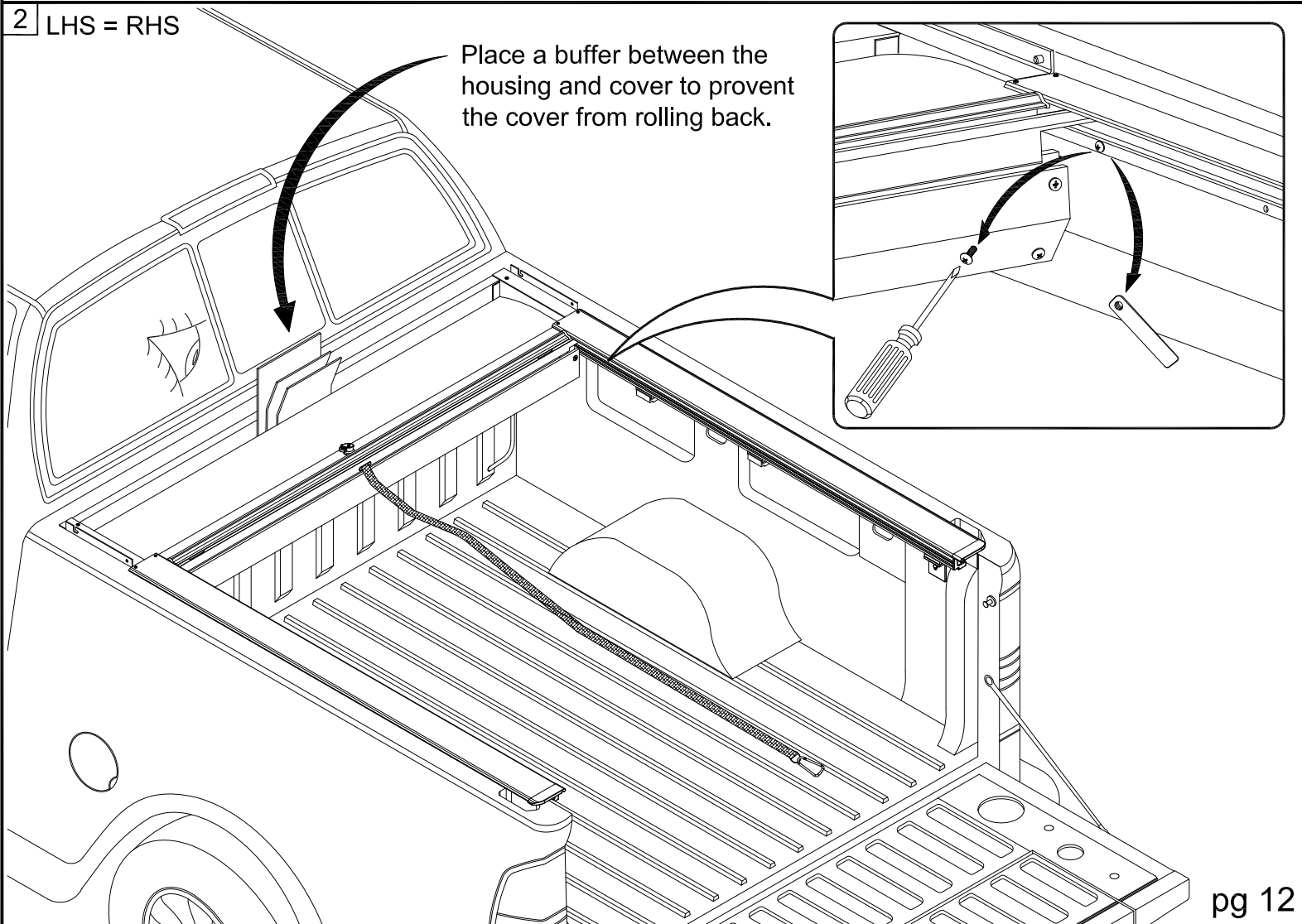

3 LHS = RHS

Remove existing clamps.

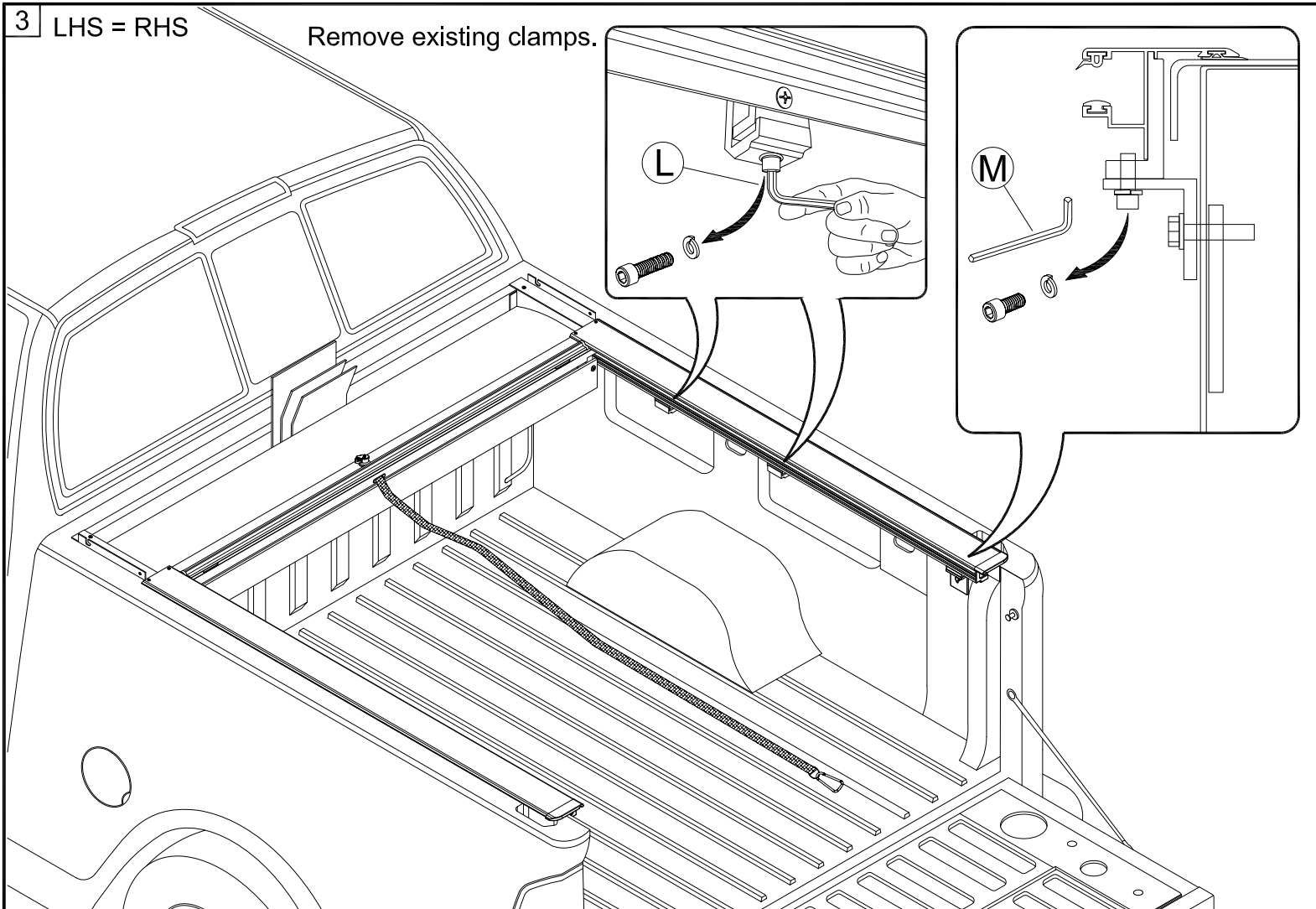

4 LHS = RHS

Remove existing tracks.

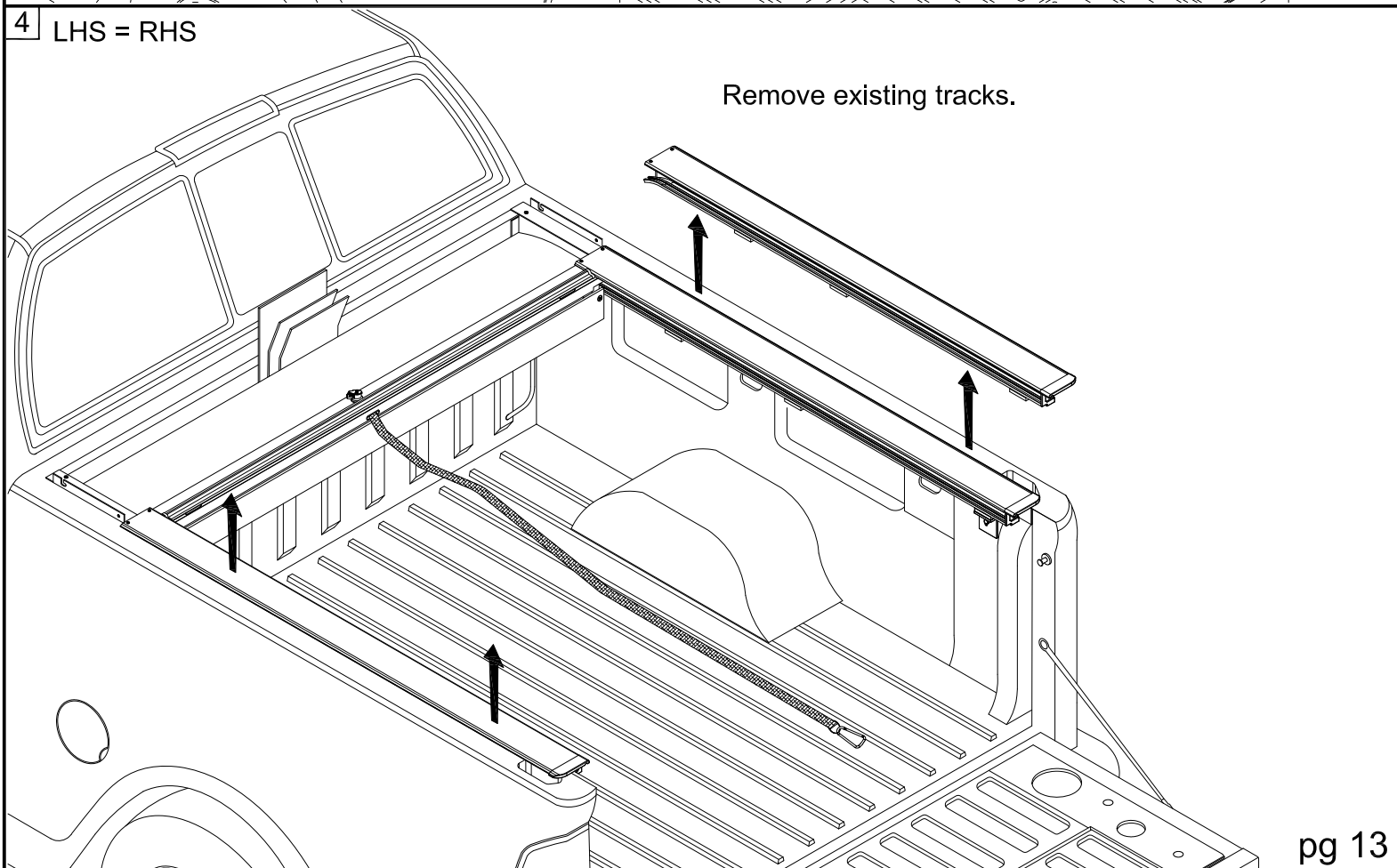

5

DRIVER SIDE TRACK ONLY.

- ① Remove screw and lock washer, set aside.

- ② Remove break away, file tabs.

Discard Track Clamp.

Clamp keyed into track.

- ④ Use the same screw and lock washer that was removed, loosely attach bracket to track.

- ③ Attach Track Clamp Bracket at slotted hole in track.

6

LHS

Remove flange nut from the top of the step handle bracket.

7 LHS=RHS

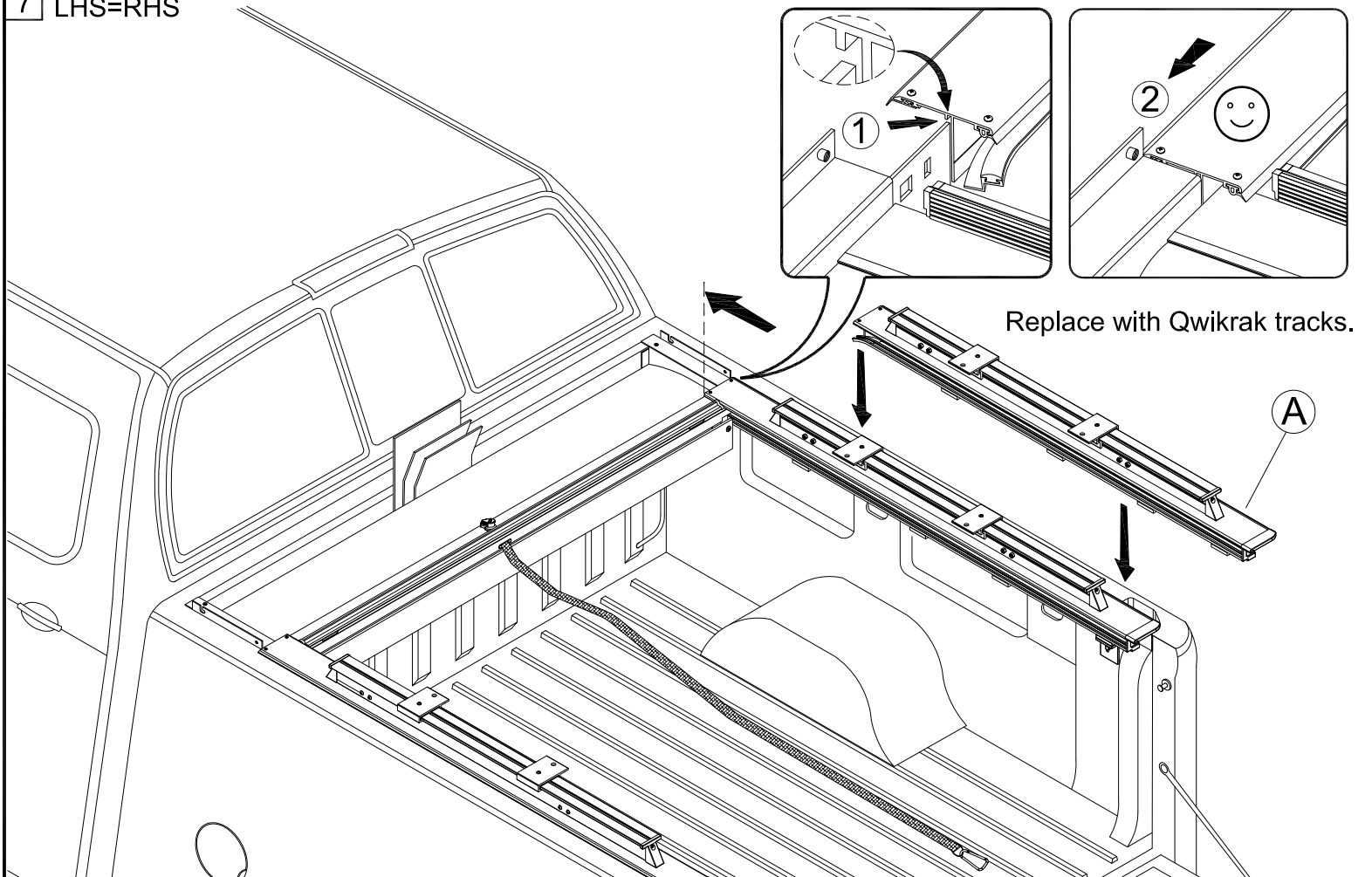

8 LHS

1

Key slot on track clamp bracket over screw on Multi-Pro Step handle bracket, replace with flange nut loosely.

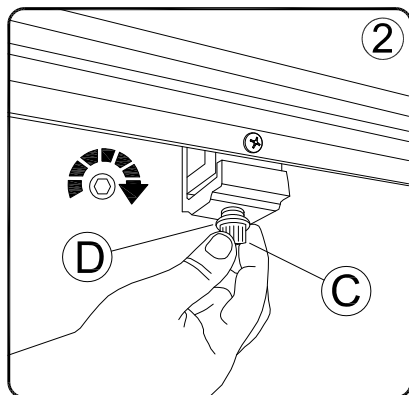

Use new hardware.
Use existing clamps.

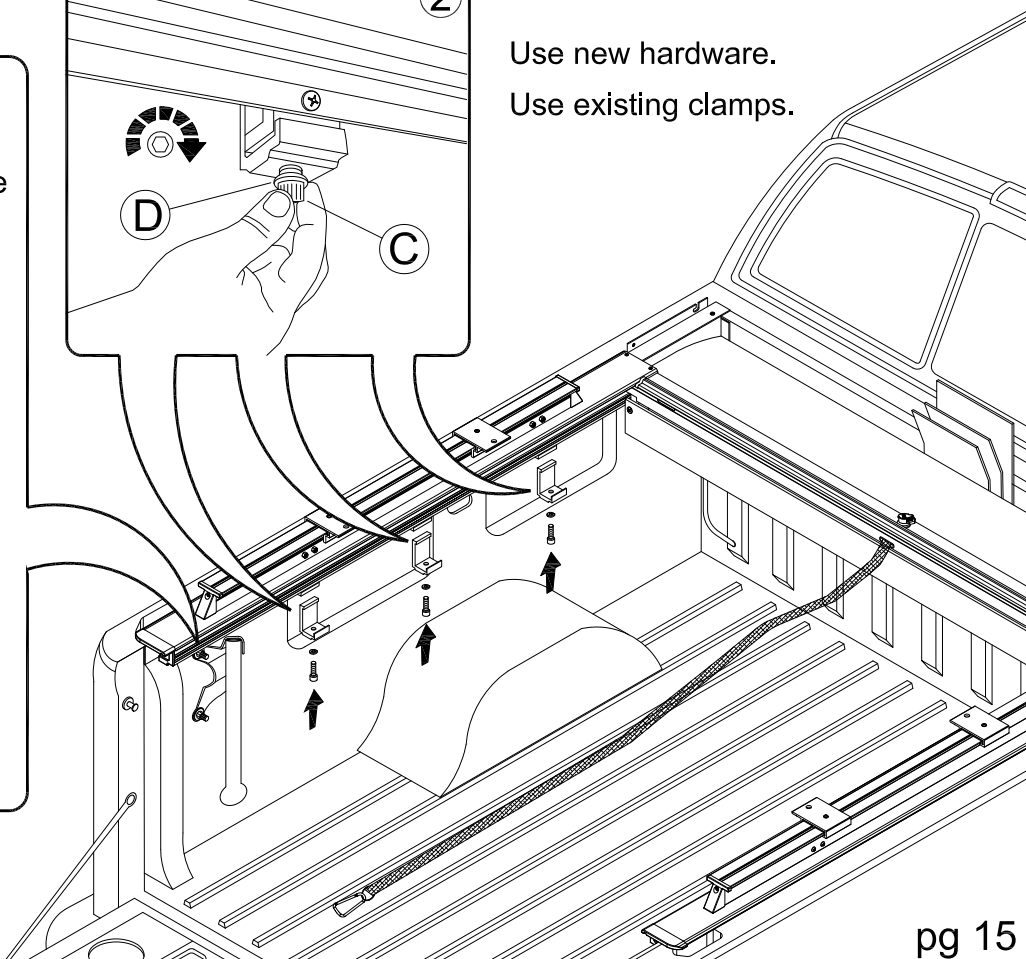
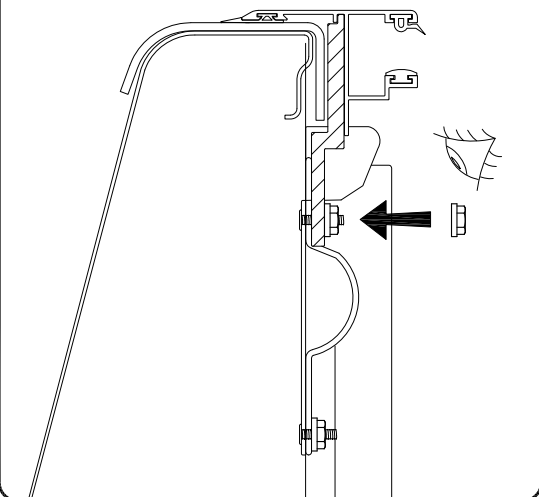

9 LHS = RHS

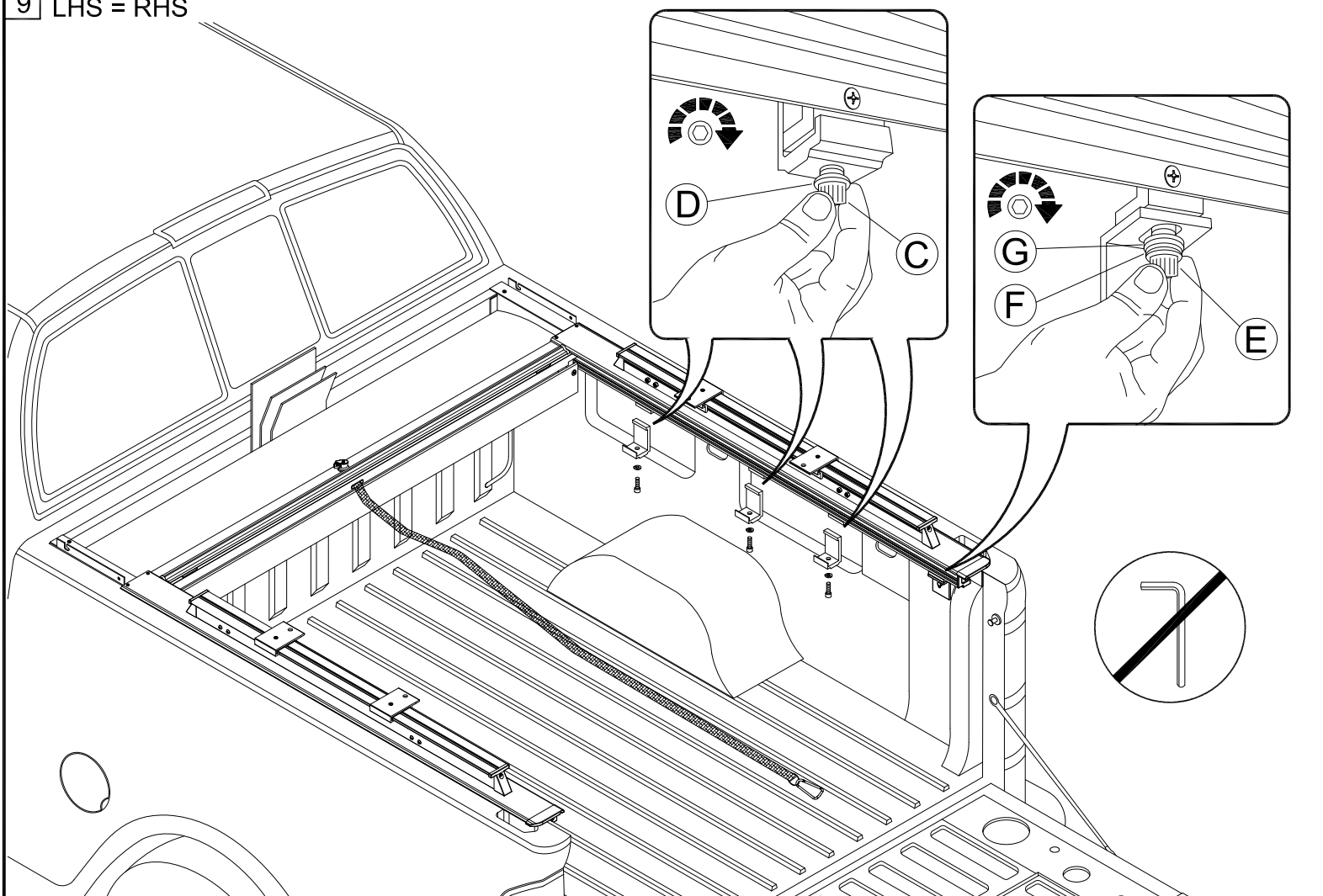

10 LHS = RHS

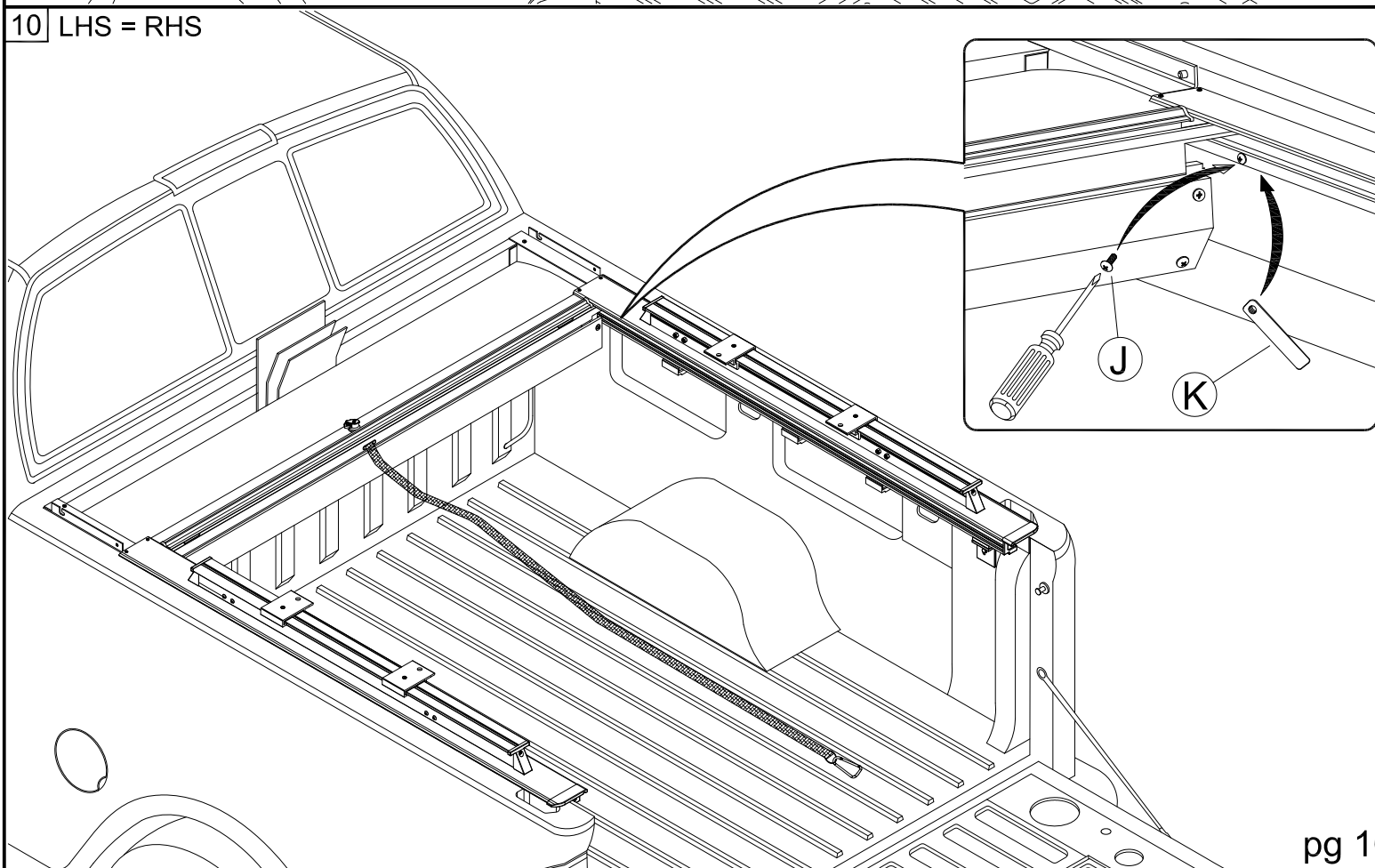

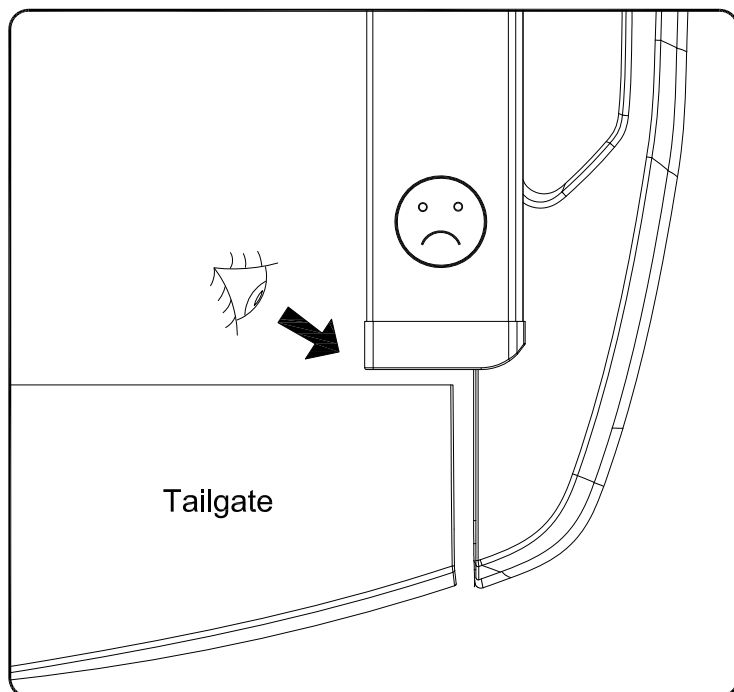
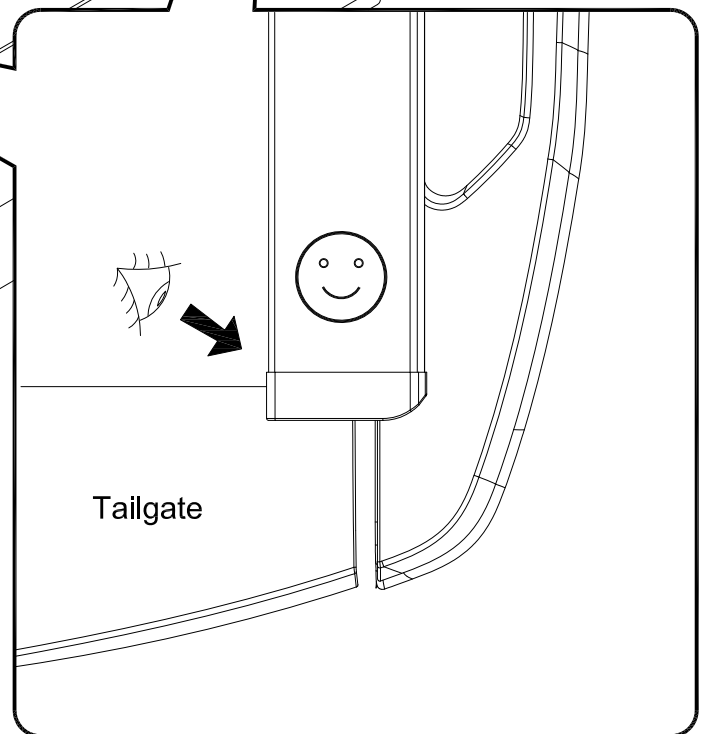
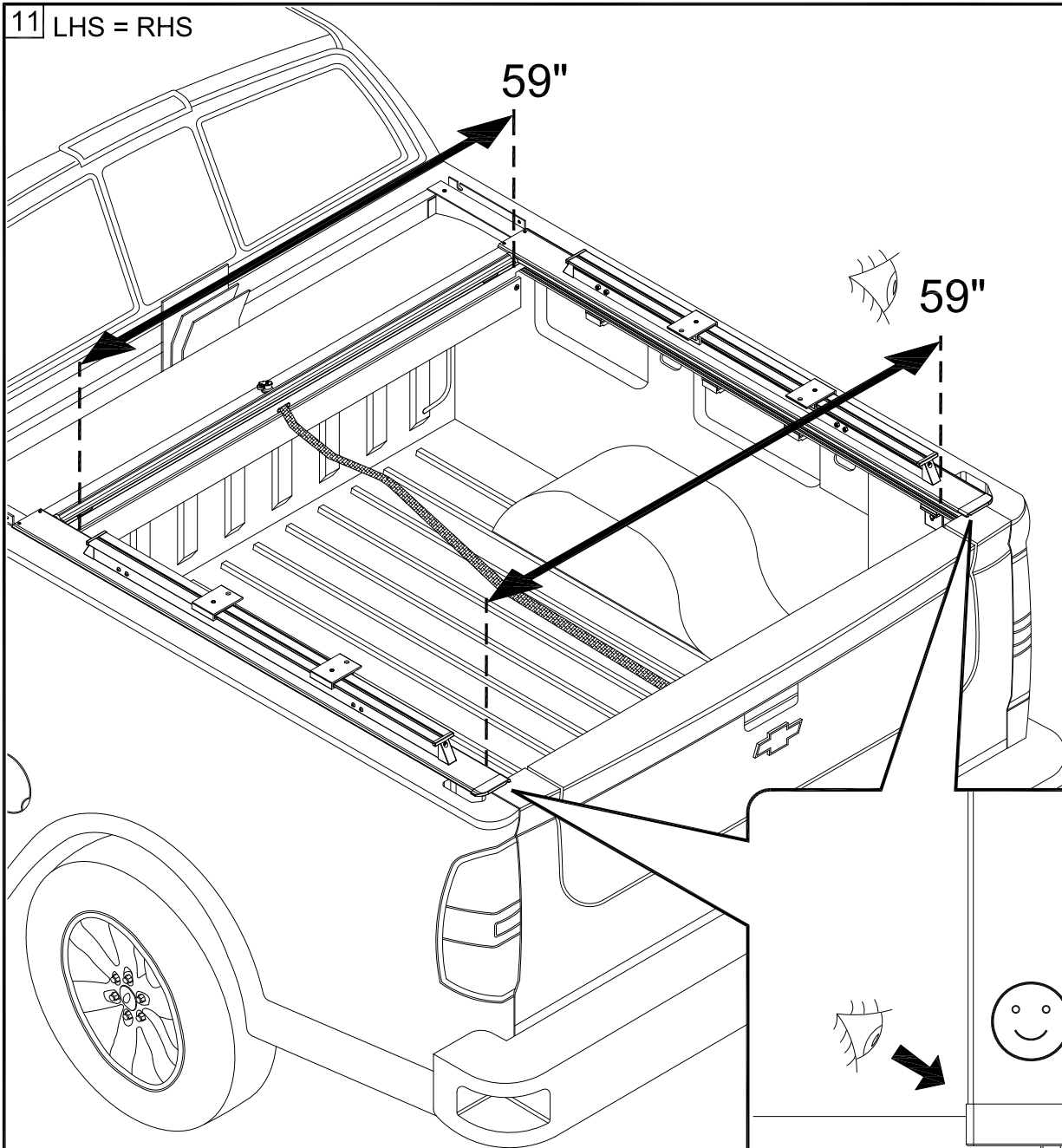

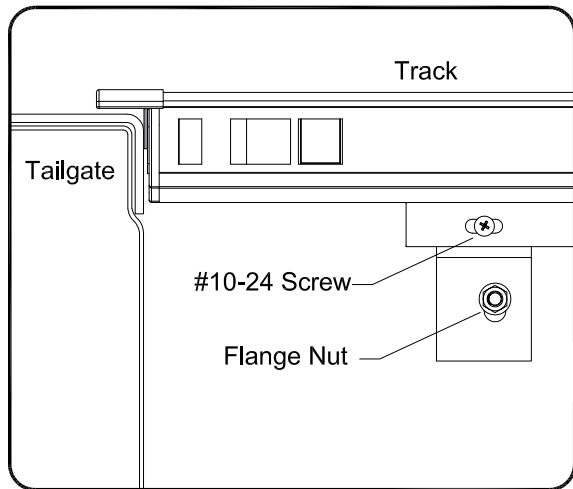

Once track is back against tailgate tighten #10-24 screw. Adjust track to correct height and tighten flange nut.

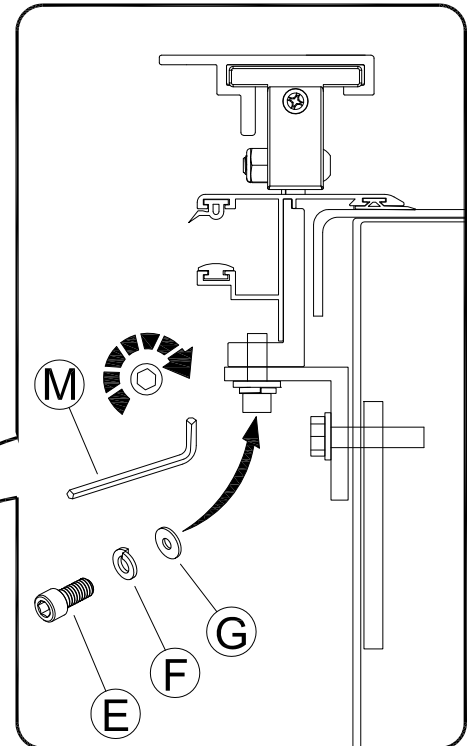
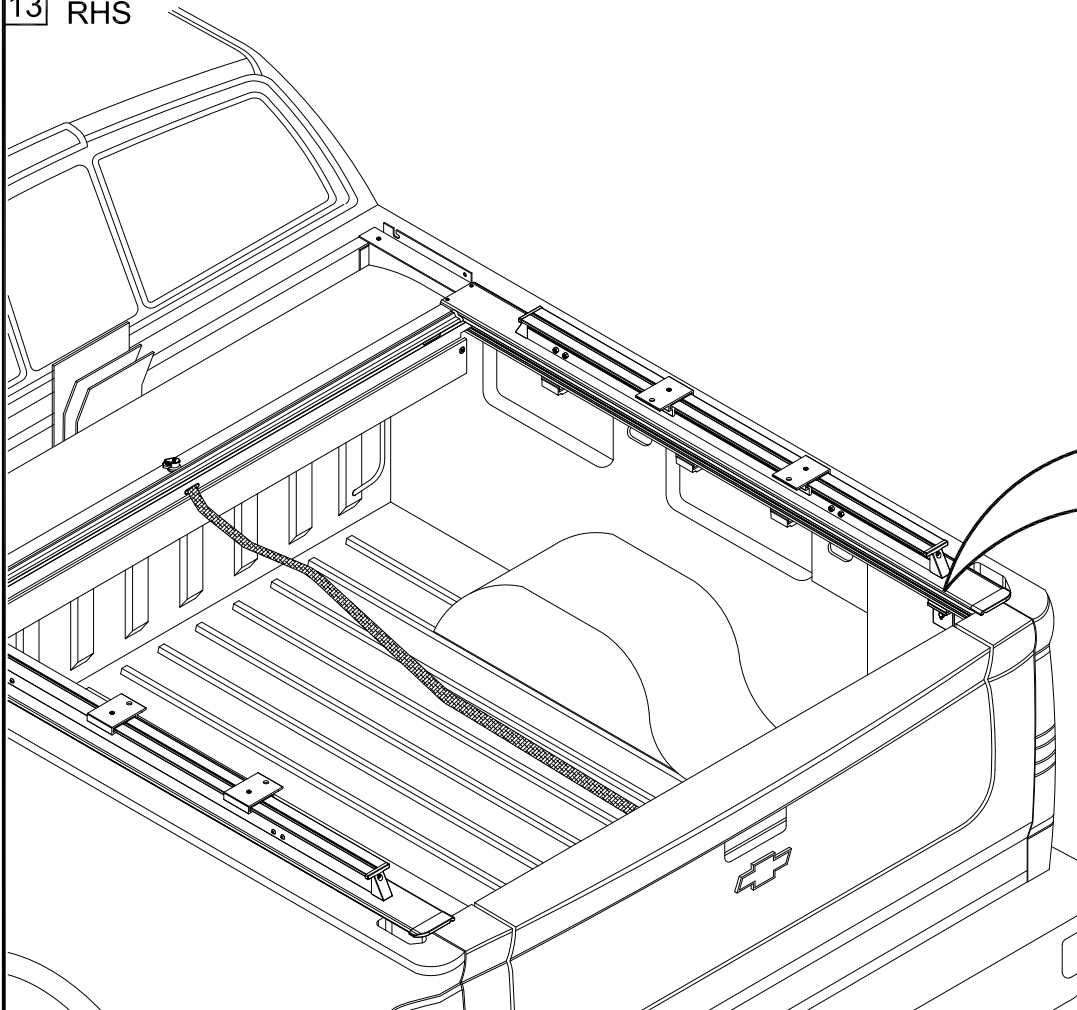
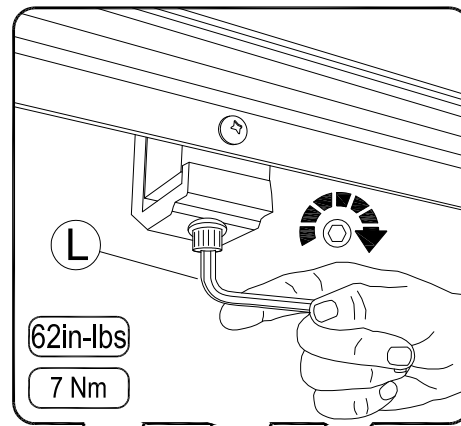

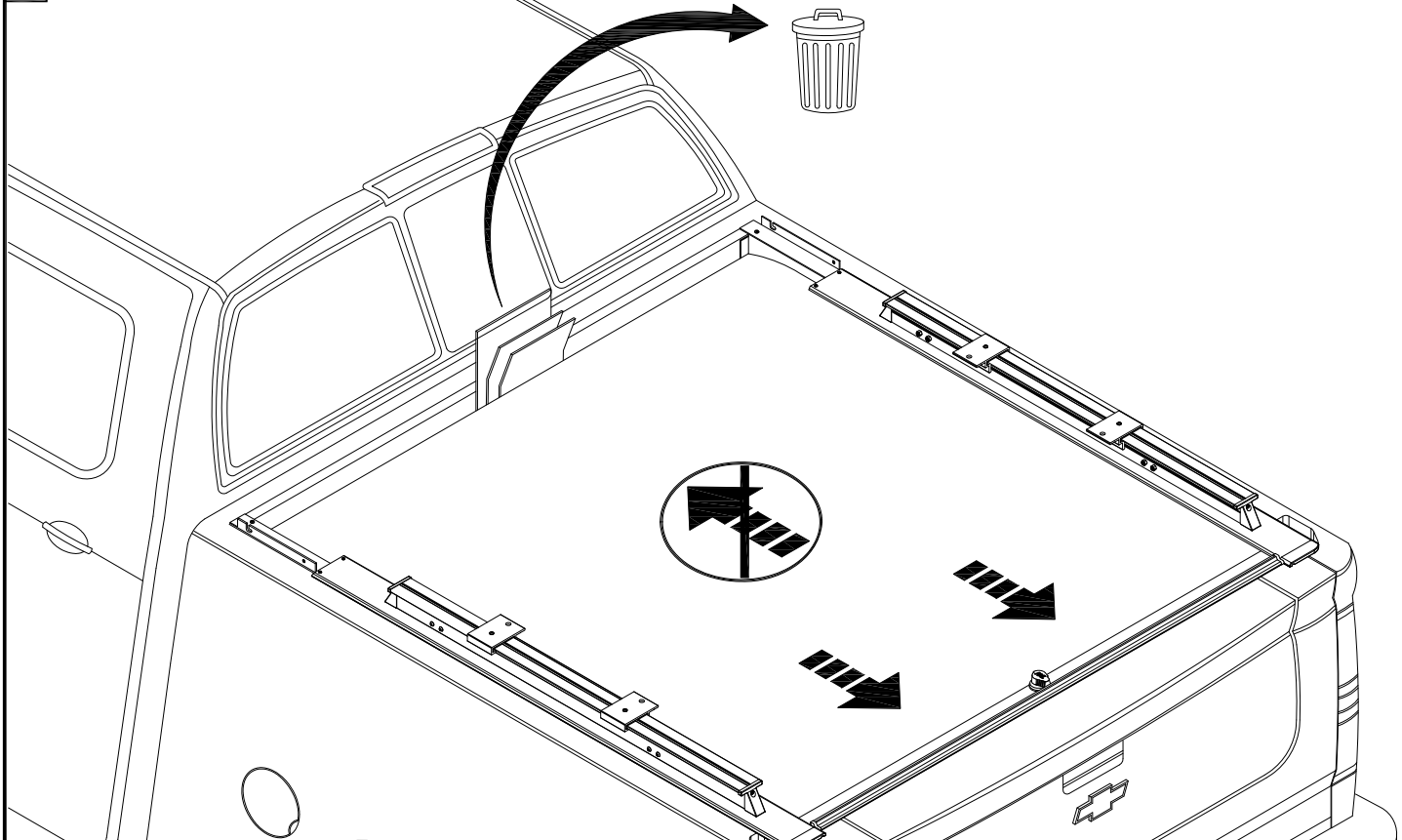
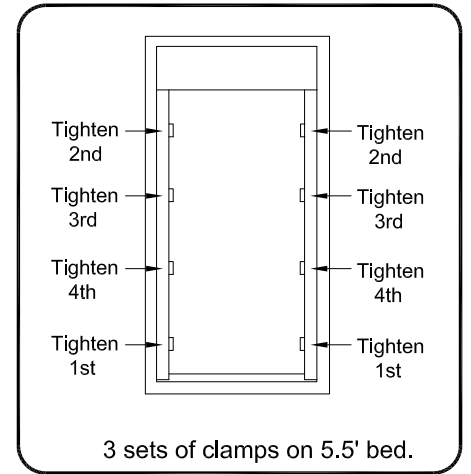
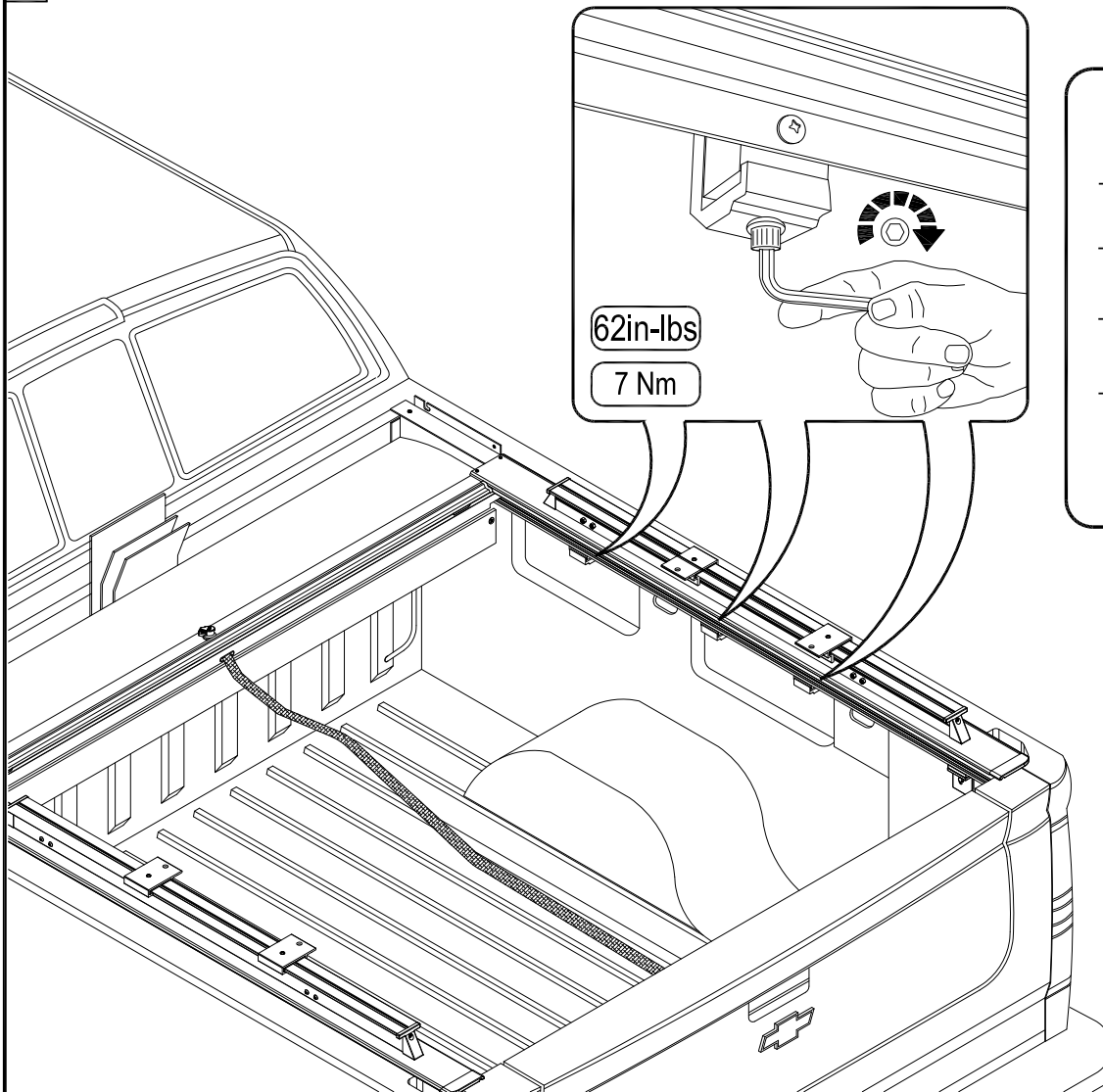

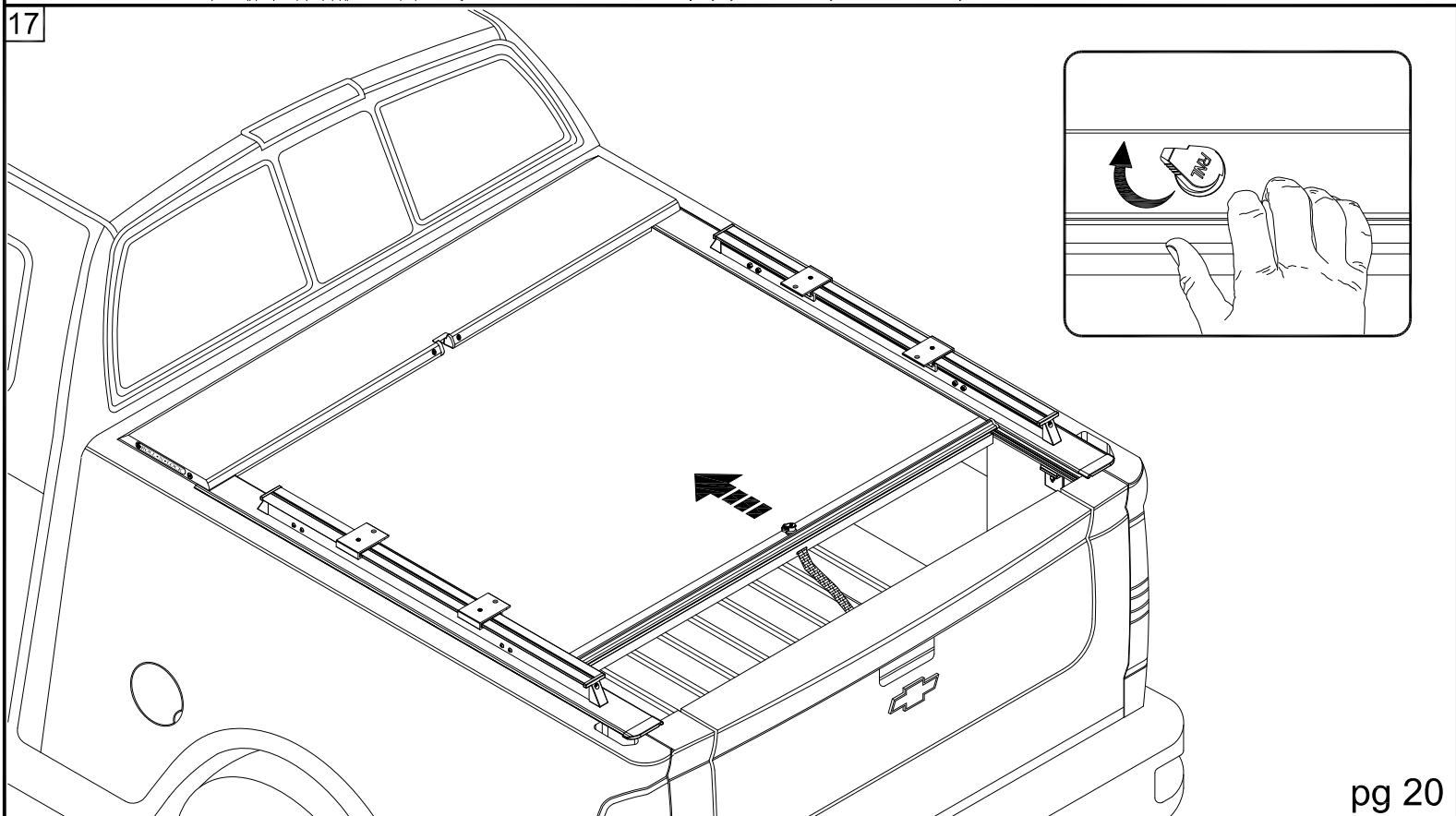
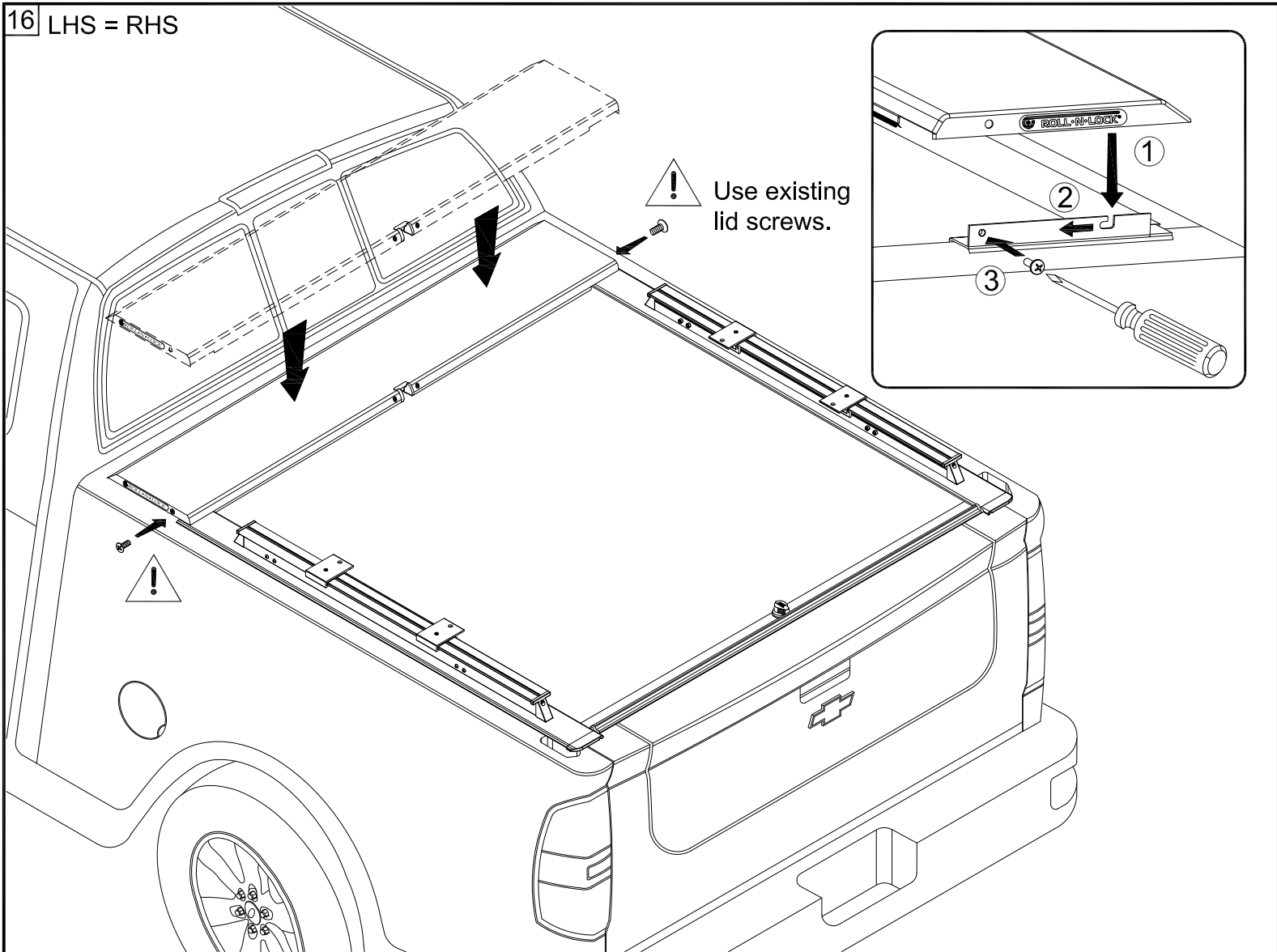

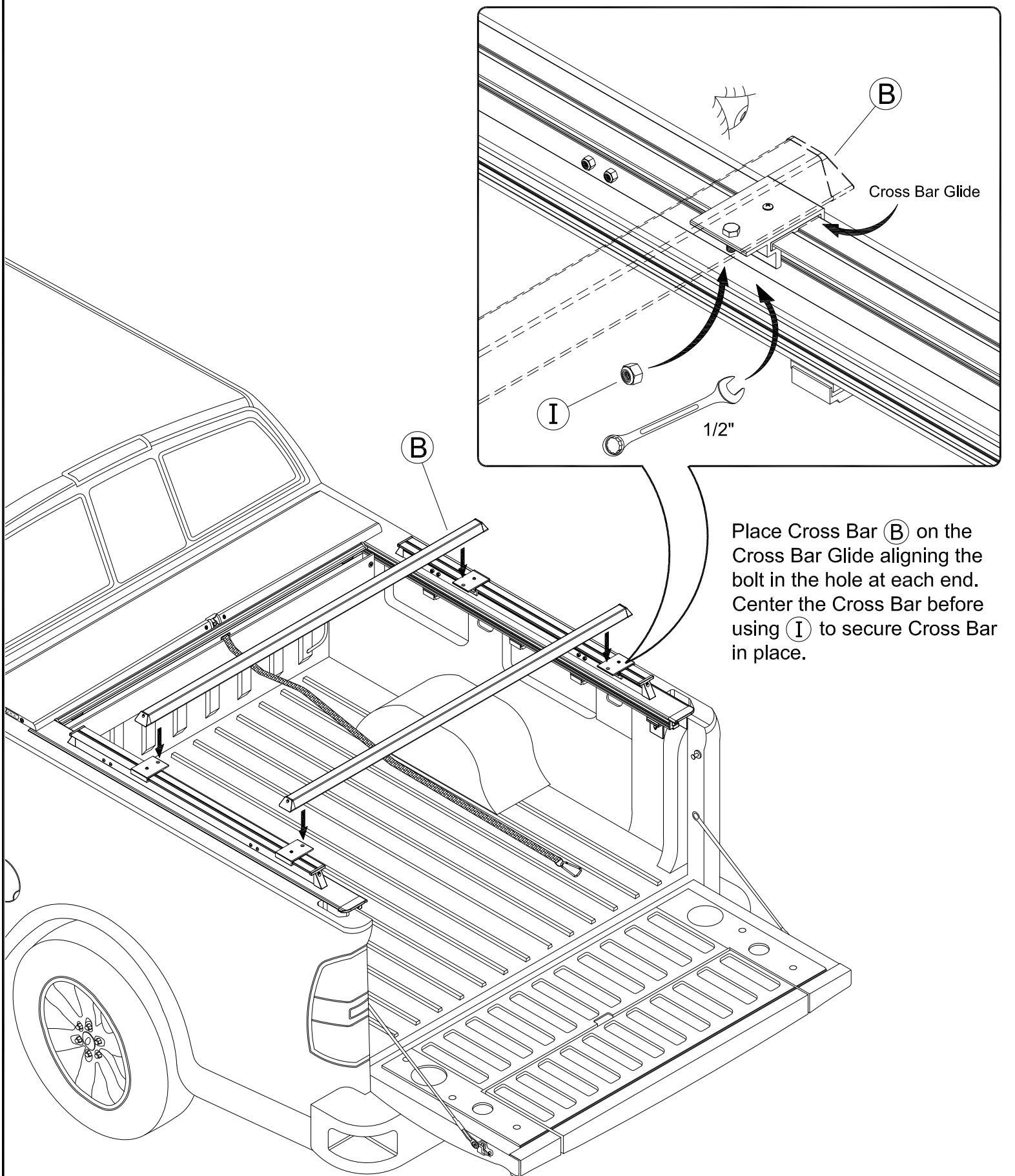

Place Cross Bar (B) on the Cross Bar Glide aligning the bolt in the hole at each end. Center the Cross Bar before using (I) to secure Cross Bar in place.

Once a desired location for the Cross Bar has been determined use (H) to thread through the hole in the Cross Bar Glide. Use supplied (L) to secure Cross Bars in place.

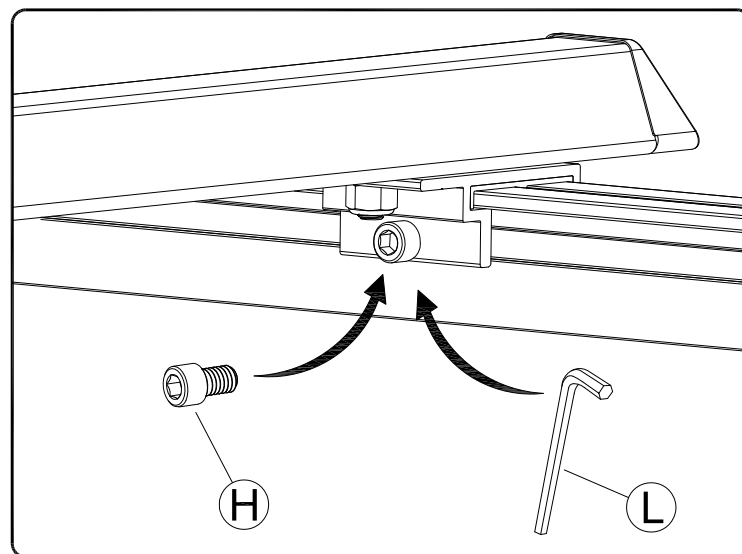

Any questions please call Customer Service at 800-952-7655
or e-mail customerservice@rollnlock.com