

## Polaris 2015-22 Ranger 500/570 20" Under Bed Light Kit

Thank you for choosing Rough Country for all your vehicle needs.

Please read instructions before beginning installation. Check the kit hardware against the kit contents shown below. Be sure you have all needed parts and know where they go.

If question exist, please call us @1-800-222-7023. We will be happy to answer any questions concerning this product.

Check all fasteners for proper torque. Check to ensure for adequate clearance between all components.

Periodically check all hardware for tightness.

### KIT CONTENTS:

20" Single Row LED Light Kit x1  
Mounting Brackets x2

### TOOLS NEEDED:

13mm Socket

### HARDWARE INCLUDED:

5/16-18 x 1 Self Tap Bolts x4



### Torque Specs:

Size	Grade 5	Grade 8	Size	Class 8.8	Class 10.9
5/16"	15 ft/lbs	20ft/lbs	6MM	5ft/lbs	9ft/lbs
3/8"	30 ft/lbs	35ft/lbs	8MM	18ft/lbs	23ft/lbs
7/16"	45 ft/lbs	60ft/lbs	10MM	32ft/lbs	45ft/lbs
1/2"	65 ft/lbs	90ft/lbs	12MM	55ft/lbs	75ft/lbs
9/16"	95 ft/lbs	130ft/lbs	14MM	85ft/lbs	120ft/lbs
5/8"	135ft/lbs	175ft/lbs	16MM	130ft/lbs	165ft/lbs
3/4"	185ft/lbs	280ft/lbs	18MM	170ft/lbs	240ft/lbs



## INSTALLATION INSTRUCTIONS

1. Locate the dimples in the bed frame on each side of the UTV. **See Photo 1.**
2. Clean and prep the mounting surface of the bed frame. **See Photo 2.**

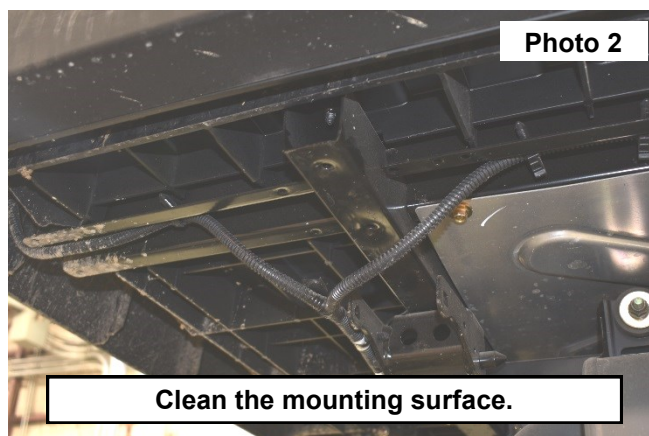
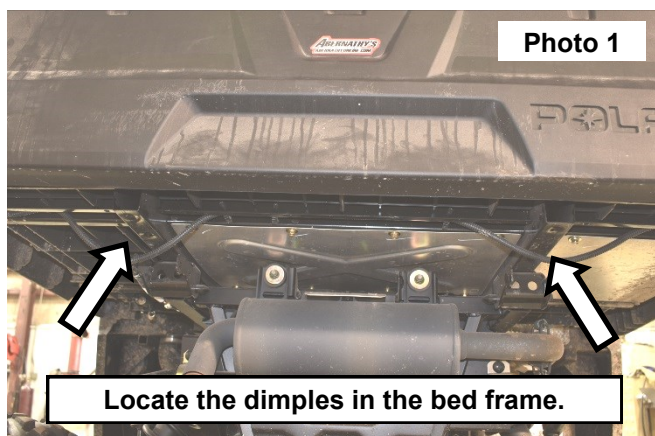

3. Driver side shown, install the bracket with the mounting tab to the inside of the UTV. Secure using (2) of the supplied 5/16-18 self tapping bolts. **See Photo 3.**
4. Tighten the brackets to the bed frame using a 13mm socket. **See Photo 4.**

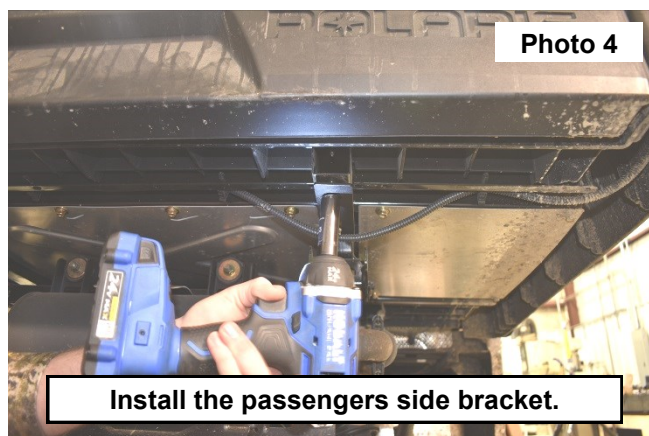
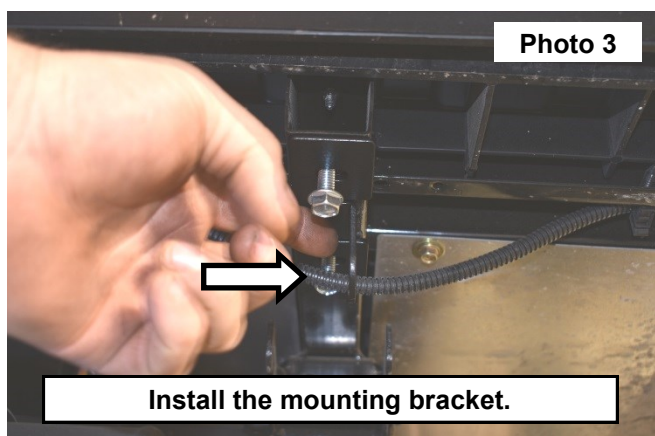

5. Install the passengers side bracket with the mounting tab to the inside of the UTV. Secure using (2) of the supplied 5/16-18 self tapping bolts. Tighten using a 13mm socket. **See Photo 5.**
6. Connect the wiring harness to the UTV using the corresponding instruction sheet supplied in the light bar kit.
7. **NOTE: Brackets can be adjusted using the slots in the brackets to fit the width of the light.** Install the light bar in-between the mounting brackets using the supplied hardware in the light bar kit.
8. Connect the light bar to the wiring harness. Then adjust the light to the desired angle and tighten using the supplied allen wrench. **See Photo 6.**

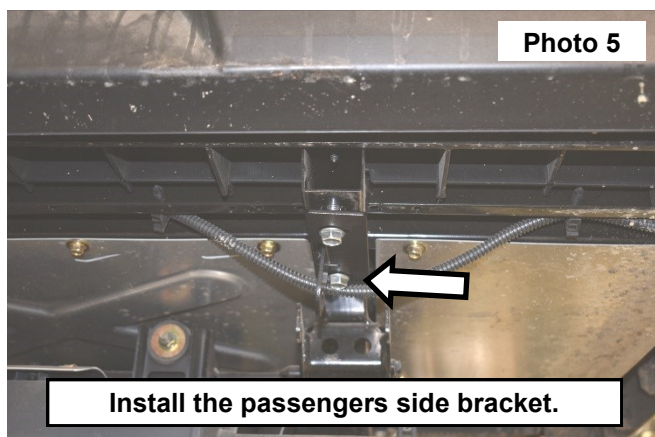

By purchasing any item sold by Rough Country, LLC, the buyer expressly warrants that he/she is in compliance with all applicable, State, and Local laws and regulations regarding the purchase, ownership, and use of the item. It shall be the buyers responsibility to comply with all Federal, State and Local laws governing the sales of any items listed, illustrated or sold. The buyer expressly agrees to indemnify and hold harmless Rough Country, LLC for all claims resulting directly or indirectly from the purchase, ownership, or use of the items.

