

SumoSprings Rear

Mercedes Sprinter 2500 (2013-present)

Part #SSR-326-47-1
Installation Instructions

Passenger side (Driver's similar)

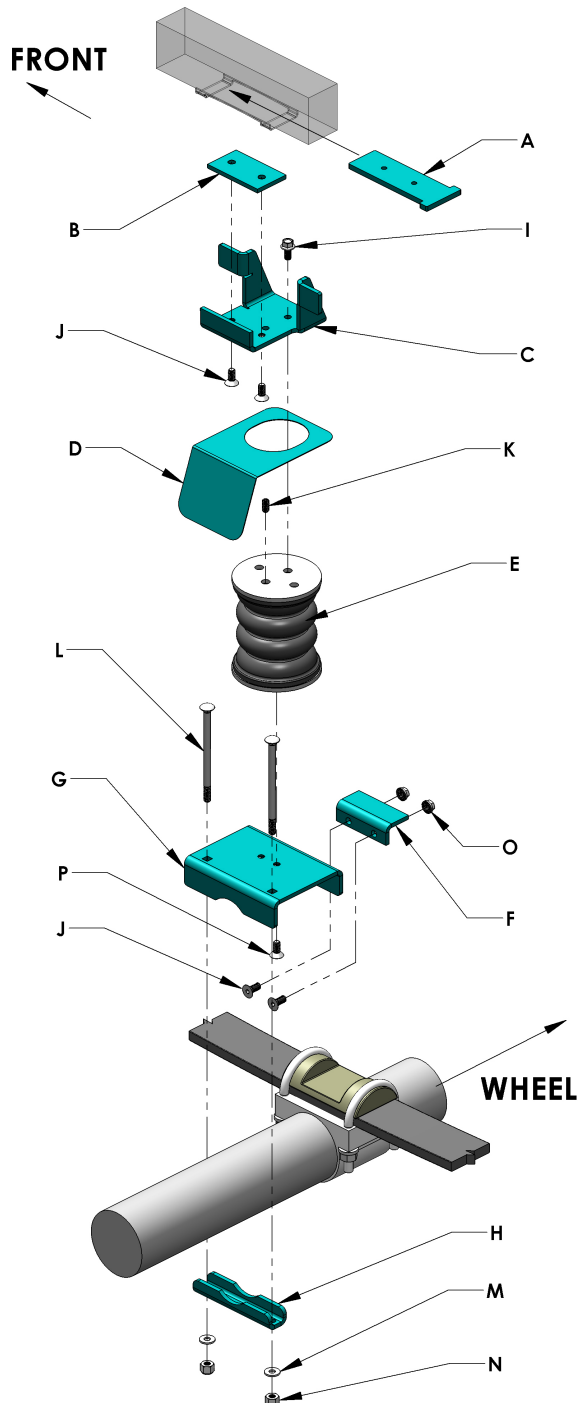

Tool List

Floor Jack	1
Jack stands	2
Wheel blocks	4
9/16" wrench	2
9/16 socket wrench	1
7/32 Allen key	1

Parts List

Item	Part #	Description	Quant.
A	512075	Upper T- bracket	2
B	512076	Upper spacer bracket	2
C	512077	Upper frame bracket RHS (shown at left in assembly passenger side)	1
	512088	Upper frame bracket LHS (Driver's side)	1
D	512078	Heat shield – PS only	1
E	521400	Sumospring 5060-47	2
F	512080	Lower axle bracket angle	2
G	512079	Lower axle bracket	2
H	512081	Lower axle clamp	2
I	512207	3/8-16 x 3/4" serrated flange bolt	2
J	512245	3/4-16 x 7/8" FHCS	10
K	512263	3/8 x 1/4" set screws	2
L	512210	3/8-16 x 6" carriage bolts	4
M	512227	3/8 USS flat washer	4
N	512234	3/8-16 top-lock nut	4
O	512209	3/8-16 serrated flange nuts	4
P	512239	Loc-tite	1

20180426

Installation Instructions

- 1) Park vehicle on level hard surface. Place wheel blocks in front and behind the front wheels to prevent rolling. Observe all safety precautions and wear safety glasses.
- 2) Raise the rear of the vehicle allowing the axle to hang free and rest the frame on the safety jack stands rated for the vehicle. Removal of the rear wheels is optional.
- 3) Starting on the driver's side. Remove the factory jounce bumpers from the underside of the frame and set aside. These would be removed by pulling sideways firmly and rotating them out of the holders.
- 4) Remove the upper bracket assembly parts A (part #512075), B (part #512076) and C(part #512077) from the box. Slide the upper T-bracket (item A) into the bump-stop holder bracket underside the frame from the rear. Attach the upper frame bracket and upper spacer (part B) to the upper T-bracket using two 3/8-16 x 7/8" flat head cap-screws (part J) and secure tightly. Ensure you orientate the upper frame bracket with the two vertical flanges outside the frame toward the wheel.
- 5) Remove the lower bracket assembly parts F, G and H from the box. Assemble the lower axle bracket (part G) and lower axle bracket angle (part F) using two 3/8-16 x 7/8" flat head cap-screws (part J) and 3/8-16 serrated flange nuts (part O). Then attach the assembly to the underside of the Sumospring using a 3/8-16 x 5/8" flat head cap-screw. Ensure you engage the rear hole of the two options in the lower axle bracket (part G) and secure tightly ensuring that the top holes of the Sumospring are aligned as indicated in the assembly diagram above. (Please note that on the passenger's side you will engage the front hole of the two options in the lower axle bracket (part G)).
- 6) Place the assembly on the driver's side axle housing with the lower axle bracket angle (part F) sitting between the factory u-bolts and up against the factory spring-pack. In instances where the exhaust pipe runs in close proximity to the Sumospring then insert the heat shield. Secure the top of the Sumospring to the upper frame bracket using a 7/8-16 x 3/4" serrated flange bolts (part I) and a 3/8-16 x 3/4" set screw (part K) as a locating and anti rotation pin.
- 7) Attach the lower bracket assembly to the axle using the lower axle clamp (part H) and two 3/8-16 x 6" carriage bolts (part L) and 3/8-16 top-lock nuts (part N) and 3/8 USS washers (part M).
- 8) Repeat steps three through seven on the passenger's side of the vehicle. Please note that on the passenger's side it is important to secure the bottom of the Sumospring to the lower axle bracket (Item G) in the front bolt hole position as described in point 5 above. (see assembly diagram above)
- 9) If rear wheels were removed you can now reinstall the rear wheels.
- 10) Jack up vehicle, remove safety jack stands and carefully lower the vehicle to the hard surface.
- 11) Remove wheel blocks from the front wheels.
- 12) Fill out warranty card and send to SuperSprings. The warranty card is an attached document.

Important Notice.

- 1) For easy installation please read instructions completely first and have all necessary tools available.
- 2) We recommend that this installation be done by a professional or persons with sound mechanical knowledge.
- 3) SumoSprings are designed to work with the original factory springs only. If they have been replaced with aftermarket springs then please consult with Supersprings International at 866-898-0720.
- 4) These instructions are meant as a guide for the installation of SumoSprings. SuperSprings International assumes no liability for the actual installation process. Installers should apply common automotive safety practices when raising, lowering and working on vehicles.
- 5) SumoSprings are designed to enhance the vehicles load carrying performance and road handling however it does not authorize or recommend loading beyond the manufacturer's GVWR specifications.
For technical support contact SuperSprings International at 866-898-0720.

To prevent damage to the vehicle and to ensure safety, do not exceed the maximum load recommended by the vehicles manufacturer (GVWR).

SumoSprings **Rear**

Suspension Enhancement
Dodge/Mercedes/Freightliner Sprinter 2500 [2003 - present]
SumoSprings Part# SSR-326-47-1



Installation



Driver's Side



Passenger's Side

Refer to SumoSprings application guide for part selection www.supersprings.com [Tech line #866-898-0720]
SumoSprings enhance load carrying capability, handling & towing. Never exceed vehicle manufacturer's GVWR rating.