

SumoSprings Rear

Mercedes Sprinter 3500 (2013-Present)

Part #SSR-336-47-1 | SSR-336-54-1 | SSR-336-60-1

Excludes Sprinter with 2" block lift between axle & underside of springpack & axle spacer under bump-stop

Passenger's side (Driver's side similar)

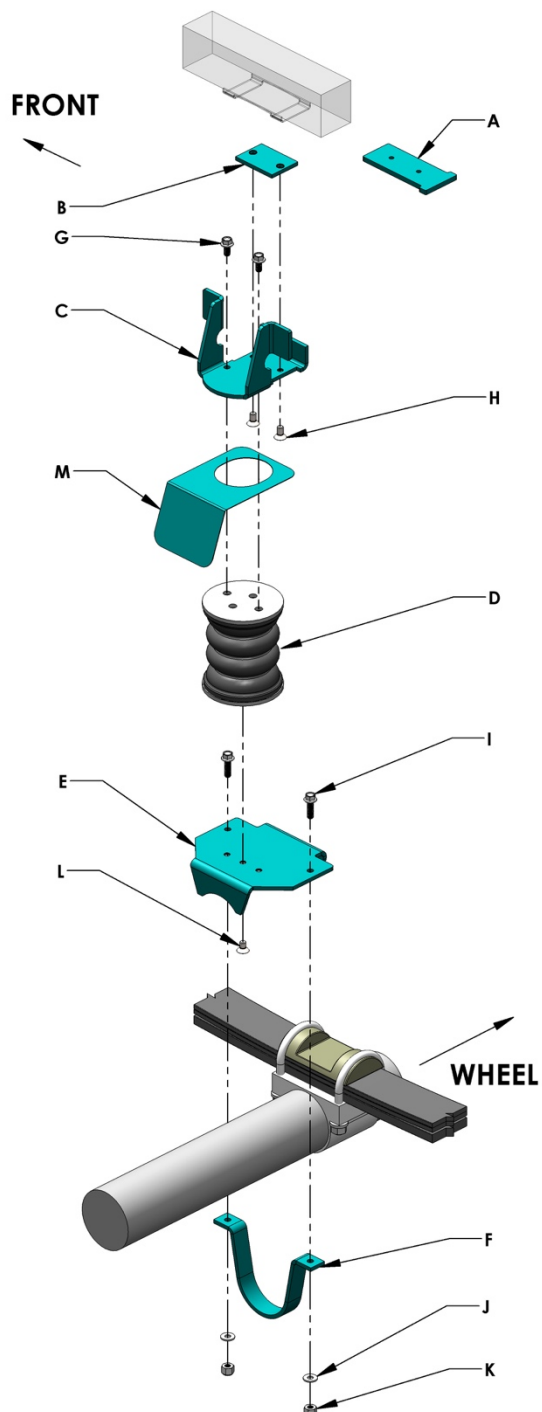

Tool List

Floor Jack	1
Jack stands	2
Wheel blocks	4
9/16" wrench	2
9/16 socket wrench	1
7/32 Allen key	1

Parts List

Item	Part #	Description	Quant.
A	512082	Upper T- bracket	2
B	512083	Upper spacer bracket	2
C	512084	Upper frame bracket RHS	2
D	521400	Sumospring 5060-47	2
	521405	Sumospring 5060-54	
	521406	Sumospring 5060-60	
E	512085	Lower bracket RHS (shown at left in the assembly)	1
	512086	Lower bracket LHS	1
F	512087	Axle strap	2
G	512207	3/8-16 x 3/4" serrated flange bolt	4
H	512245	3/4-16 x 7/8" FHCS	4
I	512223	3/8-16 x 1.25" hex bolt	4
J	512227	3/8 USS flat washer	4
K	512234	3/8-16 top-lock nut	4
L	512245	3/8-16 x 7/8" FHCS	2
M	512078	Heat Shield – passenger's side only	1

Installation Instructions

- 1) Park vehicle on level hard surface. Place wheel blocks in front and behind the front wheels to prevent rolling. Observe all safety precautions and wear safety glasses.
- 2) Raise the rear of the vehicle allowing the axle to hang free and rest the frame on the safety jack stands rated for the vehicle. Removal of the rear wheels is optional.
- 3) Starting on the driver's side. Remove the factory jounce bumpers from the underside of the frame and set aside. These would be removed by pulling sideways firmly and rotating them out of the holders.
- 4) Remove the upper bracket assembly items A (part #512082), B (part #512083) and C (part #512084) from the box. Slide the upper T-bracket (Item A #512082) into the bump-stop holder bracket underside the frame from the rear. Attach the upper frame bracket (Item C #512084) and upper spacer (Item B #512083) to the upper T-bracket using two 3/8-16 x 7/8" flat head cap-screws (Item H) and secure tightly. Ensure you orientate the upper frame bracket with the two vertical flanges inside the frame away from the wheel.
- 5) Remove the lower bracket assembly parts E (Part #512086) and F (Part #512087) from the box (Please note that the Lower Bracket LHS (Part E #512086) is slightly shorter along the axle than the RHS (Part E #512085). Then attach the Lower Bracket LHS (Part #512086) to the underside of the Sumospring using a 3/8-16 x 7/8" flat head cap-screw (Item H). Ensure you engage the vertically appropriate hole of the three options in the lower bracket LHS (part E) and secure tightly ensuring that the top holes of the Sumospring are aligned as indicated in the assembly diagram above.
- 6) Place the assembly on the driver's side axle housing with the lower bracket outboard cut-out located between the factory u-bolts and against the factory spring-pack. Please note that the Lower Bracket (Part E) is a snug fit between factory spring-pack and shock mount bracket on top of the axle. In instances where the exhaust pipe runs in close proximity to the Sumospring (passenger's side) then insert the heat shield. Secure the top of the Sumospring to the upper frame bracket using two 7/8-16 x 3/4" serrated flange bolts (Item G).
- 7) Attach the lower bracket assembly to the axle using the axle strap (Item F) and two 3/8-16 x 1.25" hex bolts (Item I), two 3/8-16 lock-nuts (Item K) and two 3/8 USS washers (Item J).
- 8) Repeat steps three through seven on the passenger's side of the vehicle.
- 9) If rear wheels were removed you can now reinstall the rear wheels.
- 10) Jack up vehicle, remove safety jack stands and carefully lower the vehicle to the hard surface.
- 11) Remove wheel blocks from the front wheels.
- 12) Fill out warranty card and send to SuperSprings. The warranty card is an attached document.

Important Notice.

- 1) For easy installation please read instructions completely first and have all necessary tools available.
- 2) We recommend that this installation be done by a professional or persons with sound mechanical knowledge.
- 3) SumoSprings are designed to work with the original factory springs only. If they have been replaced with aftermarket springs then please consult with Supersprings International at 866-898-0720.
- 4) These instructions are meant as a guide for the installation of SumoSprings. SuperSprings International assumes no liability for the actual installation process. Installers should apply common automotive safety practices when raising, lowering and working on vehicles.
- 5) SumoSprings are designed to enhance the vehicles load carrying performance and road handling however it does not authorize or recommend loading beyond the manufacturer's GVWR specifications.
- 6) For technical support contact SuperSprings International at 866-898-0720.

To prevent damage to the vehicle and to ensure safety, do not exceed the maximum load recommended by the vehicles manufacturer (GVWR).

SumoSprings **Rear**

Suspension Enhancement

Dodge Sprinter 3500 [2007~present]

(excludes Sprinters with 2" block lift between axle and bumpstop)

SumoSprings Part# SSR-336-47-1 ~ SSR-336-54-1



SSR-336-47-1



SSR-336-54-1 Installation

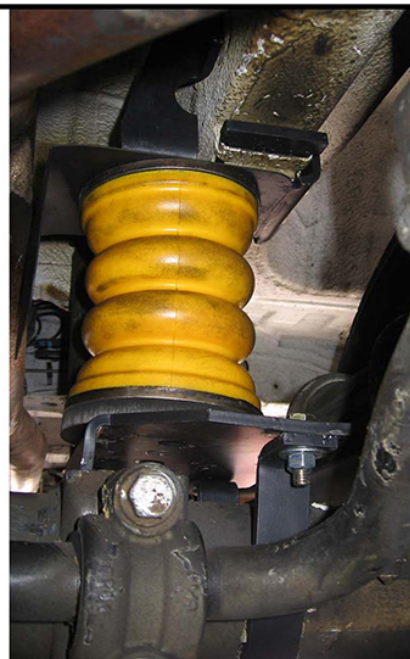

Passenger's side unloaded



Passenger's side loaded

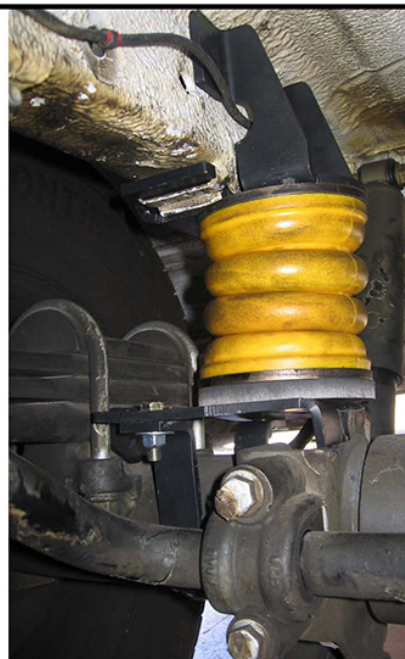

Driver's side unloaded

Refer to SumoSprings application guide for part selection www.supersprings.com [Tech line #866-898-0720]
SumoSprings enhance load carrying capability, handling & towing. Never exceed vehicle manufacturer's GVWR rating.