

EVO3 RUNNING BOARD
07-15 1500-2500-3500 SILVERADO/SIERRA EXTRA/DOUBLE CAB
INCLUDES DIESEL W/DEF

PARTS LIST:

Qty	Description	Qty	Description
1	Driver/left EVO3 Running Board Assembly	11	8-1.25mm x 25mm Hex Bolts
1	Passenger/right EVO3 Running Board Assembly	1	8mm x 28mm x 3mm Large Flat Washer
1	Passenger Front Upper Bracket	12	8mm x 24mm x 2mm STD Flat Washers
11	8-1.25mm Clip-On Nuts	12	8mm Lock Washers
1	8-1.25mm x 40mm Hex Bolt	1	8-1.25mm Nylon Lock Nut

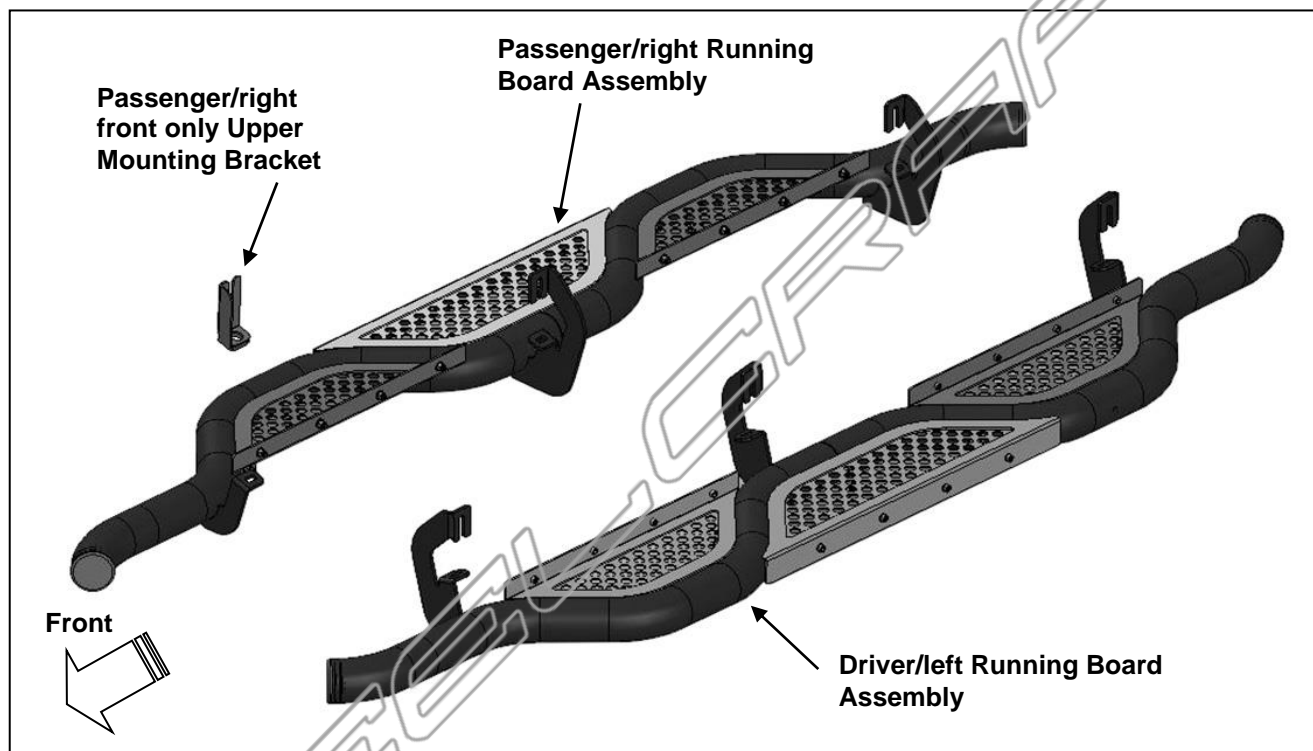

PROCEDURE:

REMOVE CONTENTS FROM BOX. VERIFY ALL PARTS ARE PRESENT. READ INSTRUCTIONS CAREFULLY BEFORE STARTING INSTALLATION. ASSISTANCE IS RECOMMENDED. ON MODELS WITH DEF TANK, SELECT A FLAT, LEVEL AREA FOR INSTALLATION.

1. Start the installation under the passenger side of the vehicle. Locate the 4 tabs along the bottom edge of the body, (pinch weld). Mounting Brackets will bolt to the 1st, 2nd and 4th mounting tabs only, (Figure 1). Directly above each tab is a top mounting location on the side of the body panel. If necessary, hold the Running Board up in place to determine the mounting holes to use along the body.
2. Determine the correct procedure for your model year and each Bracket location.

Bottom mounting location on the edge of the pinch weld.

Flat tab on pinch weld with factory installed weld nut:

Thread hex bolt into weld nut from the backside-down to clear paint from threads, (Figure 2).

Flat tab on pinch weld with hole:

Select (1) 8mm Clip Nut. Slide the Clip Nut over the tab with the nut facing up behind the tab, (Figures 3—5). Line up threaded nut with hole in tab. Repeat for each mounting location.

Top mounting location on the side of the body panel.

Models with factory installed threaded insert in body panel:

Thread 8mm Hex Bolt into threaded insert to clear paint as required, (Figures 2 & 3).

**EVO3 RUNNING BOARD
07-15 1500-2500-3500 SILVERADO/SIERRA EXTRA/DOUBLE CAB
INCLUDES DIESEL W/DEF**

Large and small hole in side of body panel:

Remove the rubber plug from the larger hole, **(Figure 4)**. Select (1) 8mm Clip Nut. Slide the Clip Nut into the larger hole. Line up the threaded nut with the smaller hole, **(Figure 5)**.

3. Next, determine if the vehicle is equipped with a plastic diesel exhaust fluid (DEF) tank, **(Figures 6 & 7)**. Note that the DEF tank is only installed on the passenger side of the vehicle.

Models without DEF tank, skip ahead to Step 4.

Models with DEF tank: The tank sits close to the side of the body. With specialized tools, the passenger front upper Bracket can be installed but room is limited. It may be easier to drop the tank down to access the inner side of the body panel for the upper bracket installation. Tank will not need to be removed, only dropped down for access to mounting location. **IMPORTANT:** If tank is full, it will be very heavy and assistance is highly recommended to avoid injury or damage to the vehicle or the tank. It is recommended that installation is performed when the DEF tank is low on fluid and on level surface before dropping the tank.

- a. On models with plastic lower tray under the tank, remove the (3) hex bolts attaching the tray to the frame, **(Figure 6)**, and remove the tray.
 - b. Release the tank filler hose. Release the plug for the sending unit on the top of the tank.
 - c. Support the tank with a floor jack. Place a smooth flat surface, (wooden block for example), between the floor jack and the tank to avoid damaging the plastic tank. **IMPORTANT:** Do not push up on the tank; only support the weight of the tank with the jack.
 - d. Remove the (2) bolts securing the tank straps to the vehicle, **(Figure 7)**. Tilt the straps to release from the brackets. Slowly lower the tank until the top of the tank is almost visible. Use blocks or stands to support the tank while installing the front Upper Bracket.
 - e. Proceed to **Step 4**.
4. Locate the first tab on the edge of the pinch weld. Select the passenger front Upper Bracket, **(Figure 8)**. Repeat the appropriate **Step 2** to attach the Bracket to the side of the body panel with (1) 8mm Hex Bolt, (1) 8mm Lock Washer and (1) 8mm STD Flat Washer, **(Figures 9, 11 & 12)**. Pull the Bracket down tight against the pinch weld and tab. On models with a nut welded onto the tab, **(Figures 2 & 9)**, slide the Bracket over the nut. Tighten the upper Hex Bolt to 18-20ft-lbs. Reinstall the DEF tank and cover, if equipped, as described in **Step 3**.
 5. Hold the passenger side Running Board up to the side of the vehicle over the (3) mounting locations. Attach the Running Board to the center and rear locations first with (4) 8mm Hex Bolts, (4) 8mm Lock Washers and (4) 8mm STD Flat Washers, **(Figure 10)**. Do not tighten hardware at this time.
 6. Move to the front mounting location with the Front Upper Bracket, **(Step 6)**. Insert (1) 8mm x 40mm Hex Bolt with (1) 8mm STD Flat Washer up and through the bracket on the Running Board, the mounting tab and the Upper Bracket. Slide a (1) 8mm Large Flat Washer and (1) 8mm Nylon Lock Nut over the Hex Bolt, **(Figures 11 & 12)**. Do not tighten hardware at this time.
 7. Level and adjust the Running Board and tighten all hardware. Torque 8mm fasteners to 18-20ft-lbs.
 8. Repeat **Steps 1, 2 & 5** to install the driver/left Running Board. **NOTE:** The driver side Running Board does not require the separate front bracket. Repeat **Step 5** to attach the front, center and rear Brackets to the vehicle with (6) 8mm Hex Bolts, (6) 8mm Lock Washers and (6) 8mm STD Flat Washers. Do not tighten hardware at this time.
 9. Level and adjust the driver side Running Board and tighten all hardware. Torque 8mm fasteners to 18-20ft-lbs.
 10. Do periodic inspections to the installation to make sure that all hardware is secure and tight.

To protect your investment, wax this product after installing. Regular waxing is recommended to add a protective layer over the finish. Do not use any type of polish or wax that may contain abrasives that could damage the finish.

Mild soap may be used to clean the EVO3 Running Board.

Passenger/left Side Installation Pictured

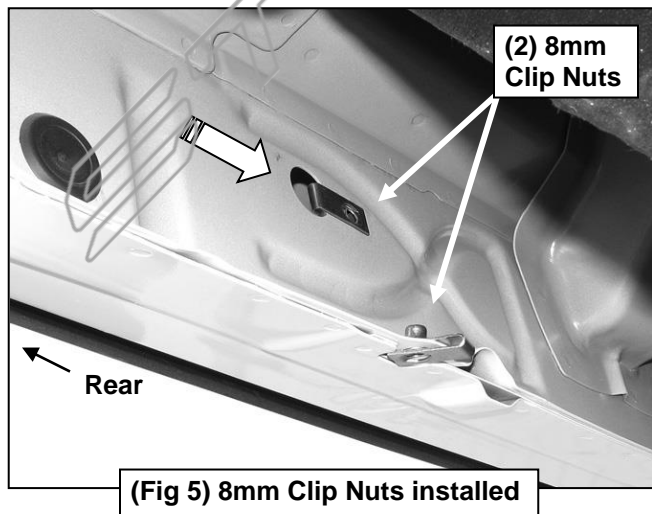
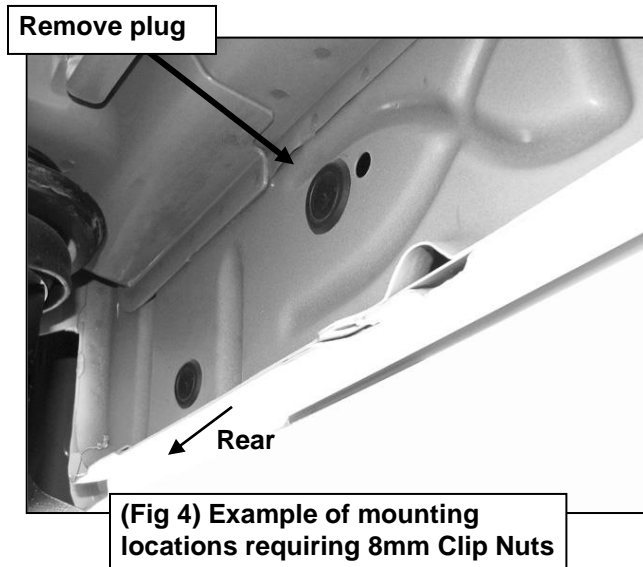
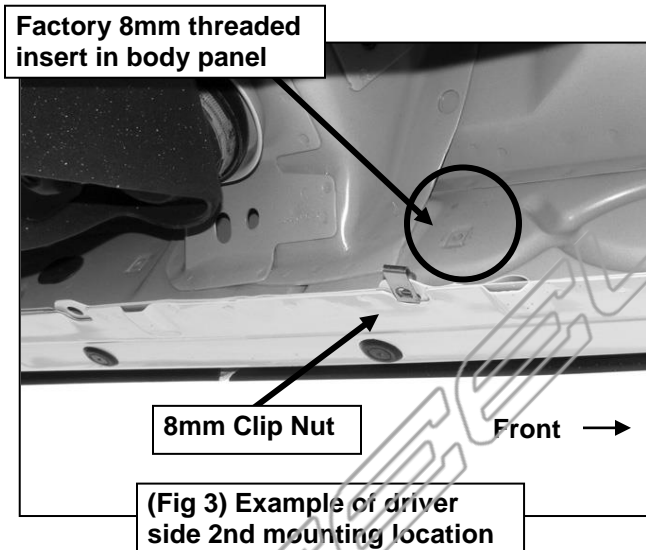
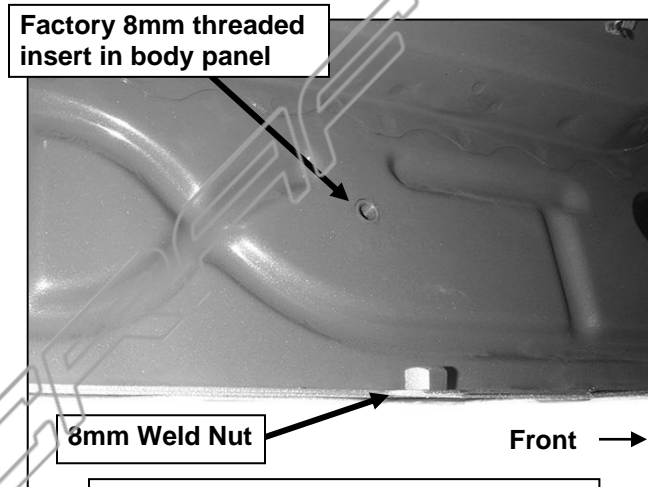
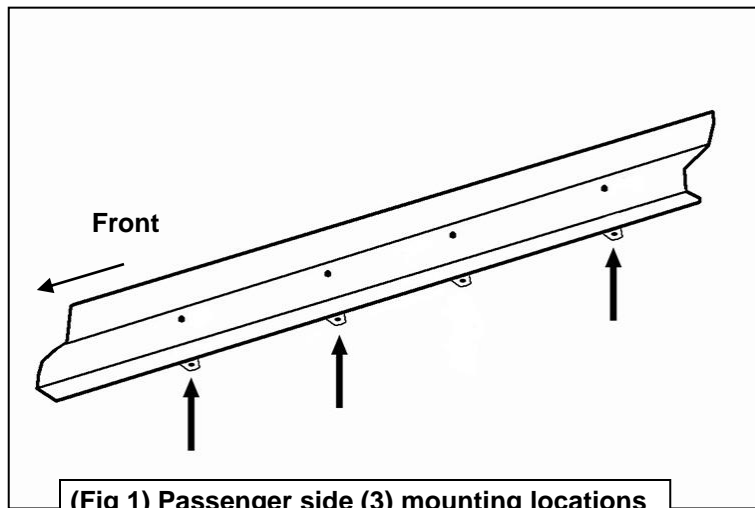

Passenger/left Side Installation Pictured

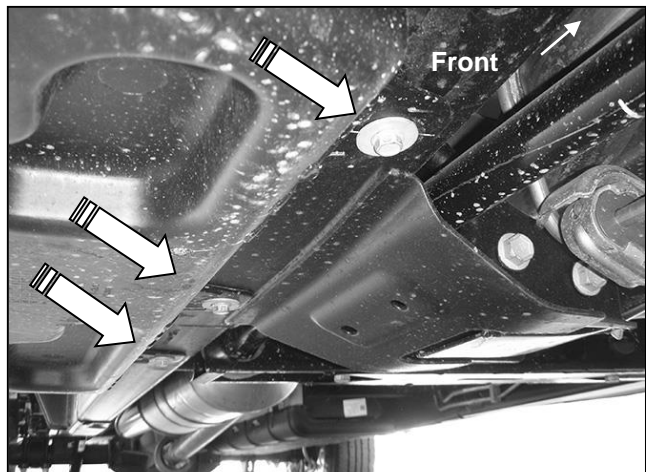

(Fig 6) Passenger side front pictured with DEF tank cover. Remove (3) hex bolts to remove cover

Remove (2) factory bolts to remove tank straps

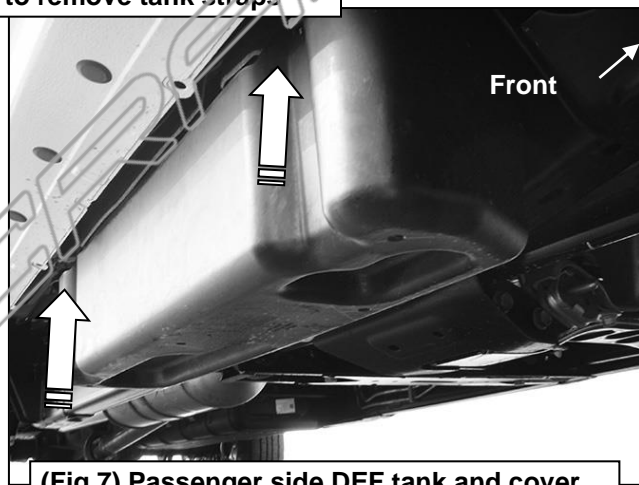

(Fig 7) Passenger side DEF tank and cover

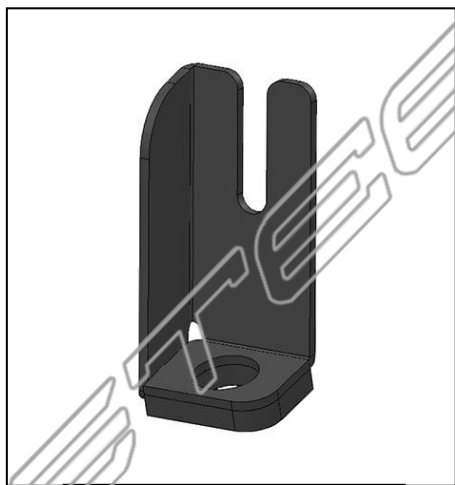

(Fig 8) Passenger/right front upper Bracket

8mm x 25mm Hex Bolt
8mm Lock Washer
8mm Flat Washer

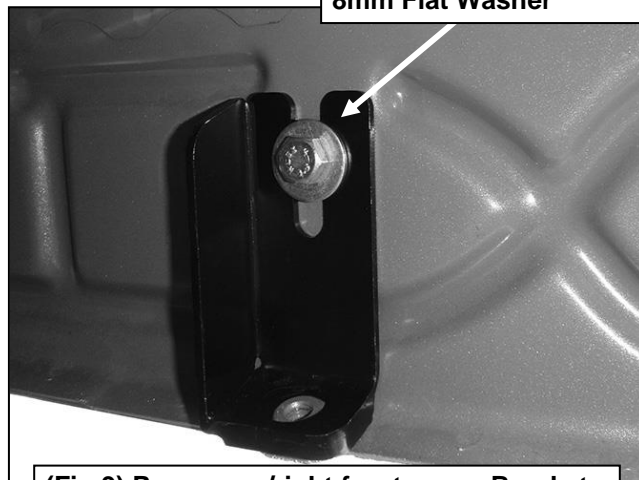

(Fig 9) Passenger/right front upper Bracket

Passenger/right Side Installation Pictured

