



# INSTALLATION INSTRUCTION ATV WINCH MOUNT

Mount Kit: PN 35274

Application: YAMAHA BIG BEAR 4x4, 2x4,

Your safety, and the safety of others, is very important. To help you make informed decisions about safety, we have provided installation and operating instructions and other information on labels and in this guide. This information alerts you to potential hazards that could hurt you or others. It is not possible to warn you about all potential hazards associated with this product, you must use your own good judgment.

**CARELESS INSTALLATION AND OPERATION CAN RESULT IN SERIOUS INJURY OR EQUIPMENT DAMAGE. READ AND UNDERSTAND ALL SAFETY PRECAUTIONS AND OPERATING INSTRUCTIONS BEFORE INSTALLING AND OPERATING THIS PRODUCT.**

This guide identifies potential hazards and has important safety messages that help you and others avoid personal injury or death.

**WARNING** and **CAUTION** are signal words that identify the level of hazard. These signal words mean:

**WARNING** signals a hazard that could cause serious injury or death, if you do not follow recommendations.

**CAUTION** signals a hazard that may cause minor to moderate injury, if you do not follow recommendations.

This guide uses **NOTICE** to call attention to important mechanical information, and **Note**: to emphasize general information worthy of special attention.

## WARNING

**SEVERE INJURY OR DEATH MAY RESULT IF YOU IGNORE ANY OF THE FOLLOWING.**

- **Read the Winch Operator’s Manual, ATV Operator’s Manual, and all warning labels before operating the winch and ATV.**
- **Stay clear of moving parts and cable. Keep others away when operating the winch.**
- **Inspect the winch mechanism, fasteners, and cable, before operating. Replace all worn or damaged parts before operating.**
- **Make sure the winch is deactivated when leaving the ATV unattended.**

## PARTS LIST:

<u>PART NO.</u>	<u>QUANTITY</u>	<u>DESCRIPTION</u>
22514	2	3/8-16 x 2 hex head cap screw
1828	2	3/8-16 hex nut
1829	2	3/8 lock washer
3870	2	5/16-18 x 3/4 hex head cap screw
2079	2	5/16-18 hex nut
1402	4	5/16 lock washer
22508	2	8mm x 1.25 x 25mm flange bolt
29269	2	u-clamp
32650	1	Rear strap
29202	1	Mounting plate

## INSTRUCTIONS:

1. Remove the two cap screws holding the bottom tubes of the bumper to the frame.
2. Attach the long rear strap (no. 1) as pictured. Using the two 8mm hex head cap screws and lock washers supplied with the kit.
3. Place the mounting plate (no. 2) on top of the rear strap and attach with the two 5/16-18 x 3/4 hex head cap screws, hex nuts and lock washers. Tighten cap screws finger tight at this time.
4. Slip the two u-clamps (no. 3) into position. These u-clamps fit around the frame and under the mounting plate as shown. Attach to the mounting plate using the 3/8-16 x 2 cap screws hex nuts and lock nuts. Tighten cap screws finger tight at this time.
5. Place winch into position on top of the mounting plate. Motor of winch will be on the right side of the ATV with the drum rotation label on the winch facing forward. Fasten winch to mounting plate using 4 5/16-18 cap screws supplied with the winch. Note: There is a chrome combination mounting plate and fairlead supplied with the winch, this is not used in this application. The casted black hawse fairlead is used, remove this from the chrome fairlead plate and retain the hardware used for attachment.
6. Attach the cast fairlead (no. 4) to the two front tabs of the mounting plate. Using the two 7/16-14 x 1 socket head cap screws and lock nuts.
7. Refer to winch manual for electrical connection instructions.

**TIGHTEN ALL FASTENERS SECURELY AT THIS TIME.**

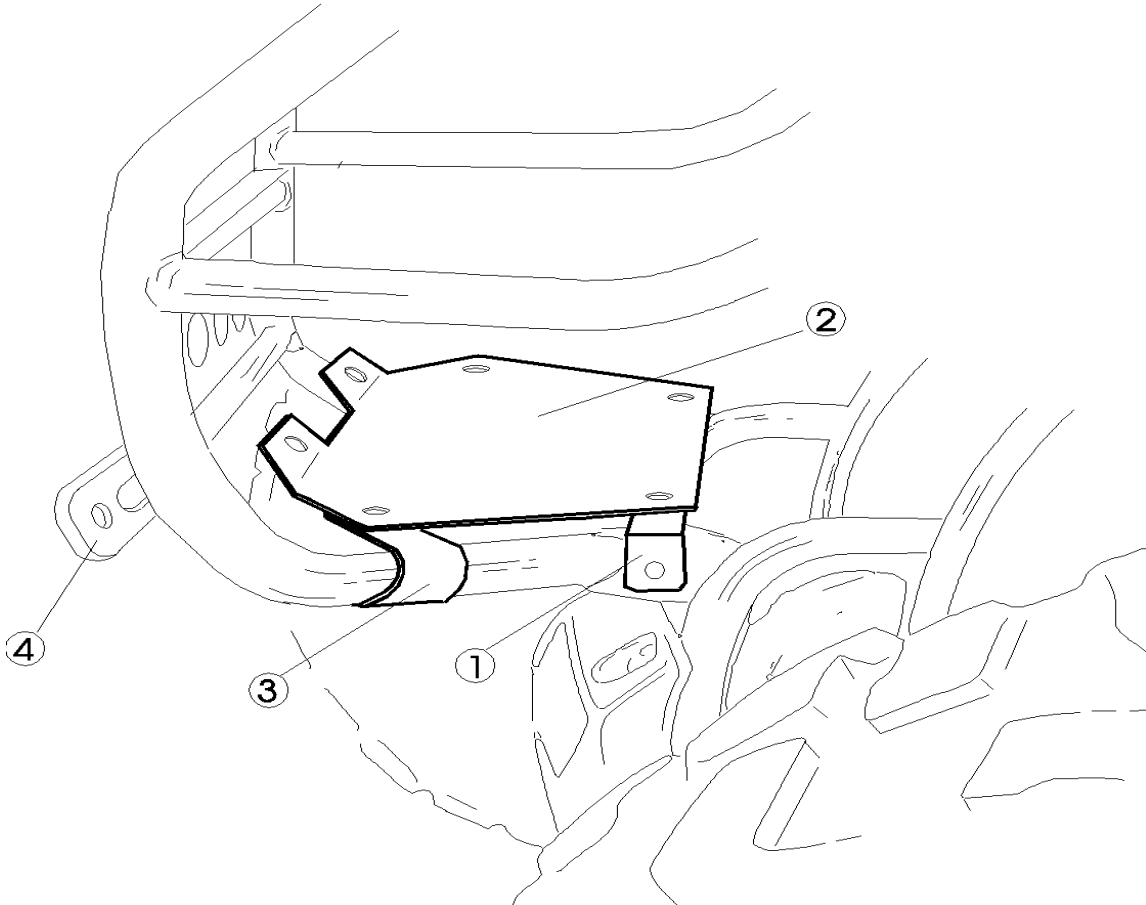

**SWITCH INSTALLATION**