



INSTALLATION INSTRUCTIONS

ATV Electric Actuator Wire Rope Service Kit

Part Number: 68135

Application: WARN's line of Electric Actuators

I. Tools Required

- Allen Wrench: 3/16"
- Nut Driver: 5/16"

II. Parts List

Part #	Qty	Description
67648	1	Cable with Ball End
67626	1	Cable Thimble
64219	2	Cable Clamp

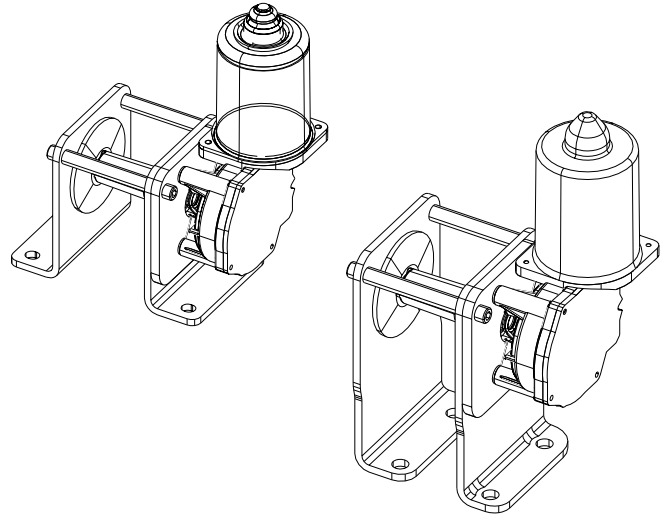

III. Installation

1. Place the actuator on its side with the motor side down. Remove the two socket head bolts shown in figure 1.

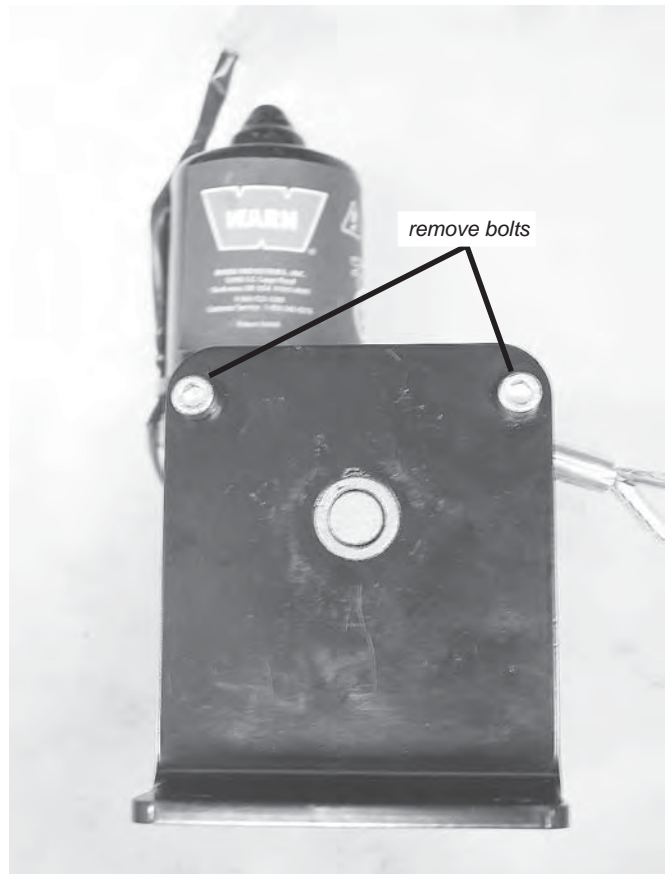

Figure 1 Remove Socket Head Bolts

- 2 Pull the the drum off the assembly and remove the wire rope shown in figure 2

NOTE: *If the old wire rope is not broken, then it must be cut in order to be removed from the drum.*

- 3 Slide the new wire rope through the drum and reassemble the electric actuator using the socket head bolts removed in step 1.
- 4 Slide the end of the wire rope through both cable clamps, form a loop, and slide the end back through both cable clamps again. The free end of the cable should be resting on the u-bolt side of the cable clamps.
- 5 Place a thimble inside the formed loop and pull out the cable slack until the cable is tight around the thimble and next to a clamp.
- 6 Tighten both cable clamps completely. Alternate tightening each nut until they no longer can be tightened. Check to make sure the clamps are tight prior to each use of the plow.

⚠ WARNING

Failure to perform regular inspections on the cable clamps prior to use may result in the plow dropping suddenly, causing loss of control on the vehicle and/or impact of a stationary object which can lead to operator injury or death.

Assembly is now complete. Test actuator prior to use.

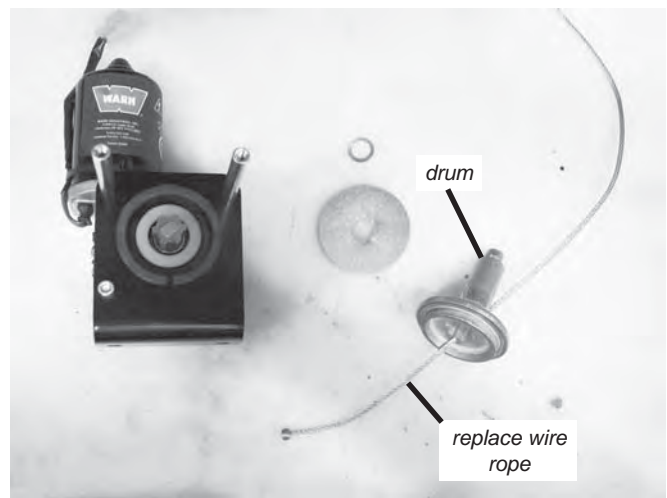

Figure 2 Replace Wire Rope in Drum

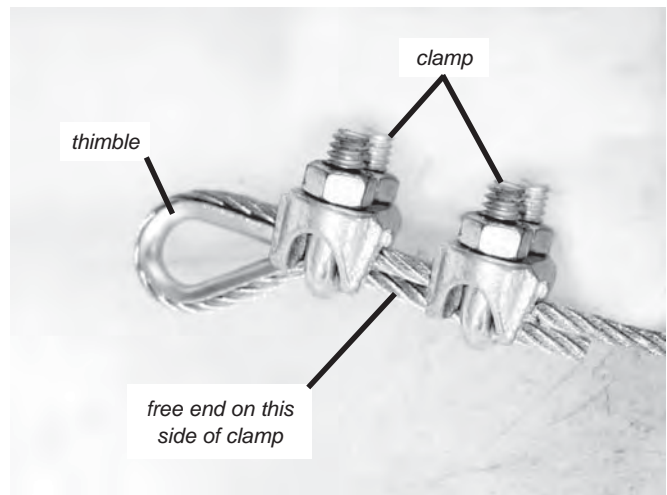

Figure 3 Attach Cable Clamps