



INSTALLATION INSTRUCTIONS

BUMPER KIT

Part Number: 71175
Application: 2005 - 2007 Honda Rubicon and
Foreman 500

Your safety, and the safety of others, is very important. To help you make informed decisions about safety, we have provided installation and operating instructions and other information on labels and in this guide. This information alerts you to potential hazards that could hurt you or others. It is not possible to warn you about all potential hazards associated with this product, you must use your own good judgment.

CARELESS INSTALLATION AND OPERATION CAN RESULT IN SERIOUS INJURY OR EQUIPMENT DAMAGE. READ AND UNDERSTAND ALL SAFETY PRECAUTIONS AND OPERATING INSTRUCTIONS BEFORE INSTALLING AND OPERATING THIS PRODUCT.

This guide identifies potential hazards and has important safety messages that help you and others avoid personal injury or death. **WARNING** and **CAUTION** are signal words that identify the level of hazard. These signal words mean:

▲WARNING signals a hazard that *could* cause serious injury or death, if you do not follow recommendations. **▲CAUTION** signals a hazard that *may* cause minor to moderate injury, if you do not follow recommendations.

This guide uses **NOTICE** to call attention to important mechanical information, and **Note**: to emphasize general information worthy of special attention.

▲ WARNING

INJURY HAZARD

Failure to observe these instructions could lead to severe injury or death.

- Always** use extreme caution when cutting and trimming during fitting.
- Always** remove jewelry and wear eye protection.
- Always** use appropriate and adequate care in lifting components into place.
- Always** insure components will remain secure during installation and operation.
- Always** tighten all nuts and bolts securely, per the installation and operation.
- Always** perform regular inspections and maintenance on the bumper and related hardware.
- Never** operate this **WARN** product with damaged or missing parts.

NOTES

This bumper includes mounting holes for WARN trail lights, which are sold separately.

I. TABLE OF CONTENTS

Parts List	page 2
Tools Required	page 2
Torque Specifications	page 2
Installation	page 3-4
Maintenance/Care	page 5

II. PARTS LIST

<u>Reference</u>	<u>Qty</u>	<u>Description</u>
(# 1)	8	Flat Washer
(# 2)	4	M8-1.25 x 25 mm Flanged Bolt
(# 3)	1	Bumper

III. TOOLS REQUIRED

- Ratchet or wrenches
- 12mm Socket or wrench
- 10mm Socket or wrench

IV. TORQUE SPECIFICATIONS

M8 17 lb. ft. (12.5 N-m)

V. INSTALLATION

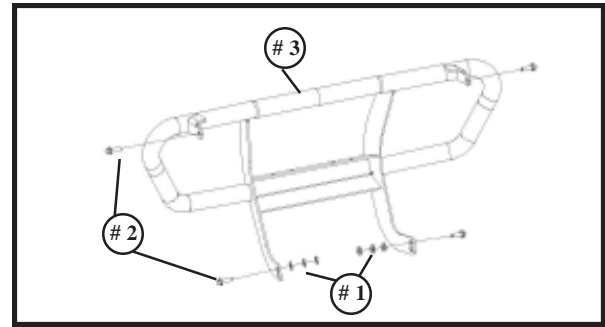

Figure 1

1. Remove the two front rack bolts and the two front plastic bolts, using the 12mm socket or wrench. These bolts will not be used for the bumper installation.

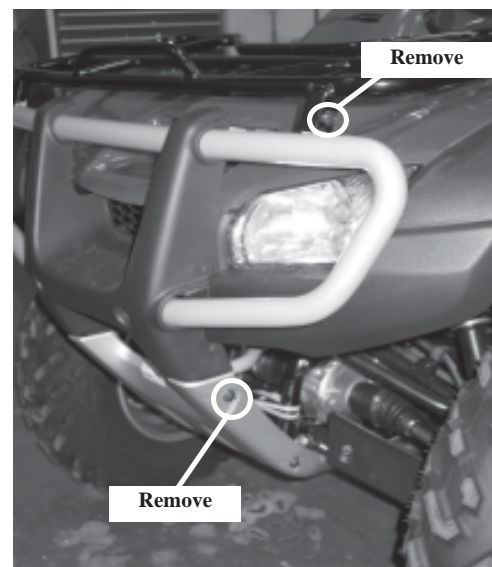

Figure 2

2. Move the bumper into place on the front of the vehicle.



Figure 3

INSTALLATION CONT.

3. Place one bolt (Ref. #2) per side, through the lower bumper slots. Put three washers (Ref. #1) on each side, between the bumper and the plastic. Loosely fasten the two bolts.

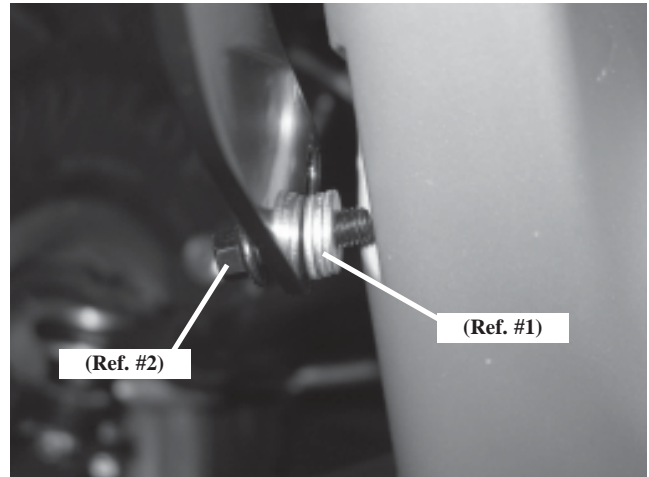

Figure 4

4. Align the tabs at the top of the bumper with the rack mounts. If there is a gap between the rack mount and bumper tab, then place a washer between the mount and the tab. Fasten the bumper with the remaining two flange bolts.

Tighten all four bolts (Ref. #2) to the recommended torque of 17lb. ft. (12.5 N-m).

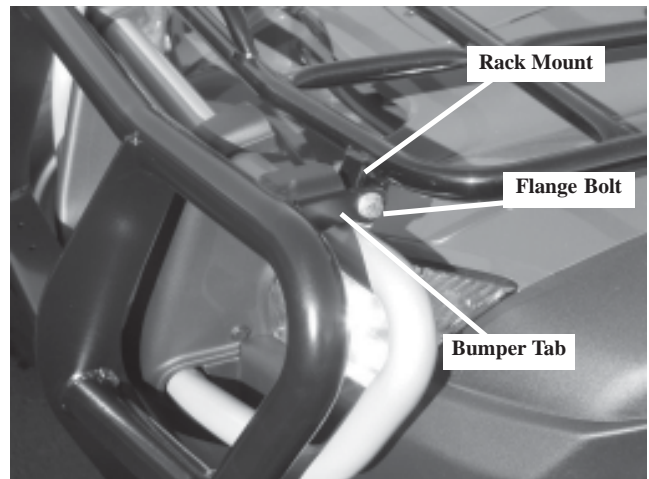

Figure 5

5. Installation is now complete.

PROCEED TO SECTION TITLED “MAINTENANCE/CARE”.



Figure 6

VI. MAINTENANCE/CARE

1. Inspect all parts on the bumper and related hardware prior to each use. Replace all hardware that appears rusted or deformed.

WARNING

FAILURE TO SECURELY TIGHTEN ALL BOLTS ON THE BUMPER CAN RESULT IN PRODUCT FAILURE WHICH MAY RESULT IN VEHICLE DAMAGE AND OPERATOR INJURY OR DEATH. DOUBLE CHECK THAT ALL BOLTS ARE SECURELY TIGHTENED PRIOR TO USE.

