



INSTALLATION INSTRUCTIONS UNIVERSAL HANDLE BAR LIGHT BRACKET KIT

Part Number: 83972

Application: All ATV's*

* Does not include Can Am & Kawasaki vehicles

Your safety, and the safety of others, is very important. To help you make informed decisions about safety, we have provided installation and operating instructions and other information on labels and in this guide. This information alerts you to potential hazards that could hurt you or others. It is not possible to warn you about all potential hazards associated with this product, you must use your own good judgment.

CARELESS INSTALLATION AND OPERATION CAN RESULT IN SERIOUS INJURY OR EQUIPMENT DAMAGE. READ AND UNDERSTAND ALL SAFETY PRECAUTIONS AND OPERATING INSTRUCTIONS BEFORE INSTALLING AND OPERATING THIS PRODUCT.

This guide identifies potential hazards and has important safety messages that help you and others avoid personal injury or death. **WARNING** and **CAUTION** are signal words that identify the level of hazard. These signal words mean:

WARNING signals a hazard that *could* cause serious injury or death, if you do not follow recommendations. **CAUTION** signals a hazard that *may* cause minor to moderate injury, if you do not follow recommendations.

This guide uses **NOTICE** to call attention to important mechanical information, and **Note**: to emphasize general information worthy of special attention.

WARNING

INJURY HAZARD

Failure to observe these instructions could lead to severe injury or death.

- Always** use extreme caution when cutting and trimming during fitting.
- Always** remove jewelry and wear eye protection.
- Always** use appropriate and adequate care in lifting components into place.
- Always** insure components will remain secure during installation and operation.
- Always** tighten all nuts and bolts securely, per the installation and operation.
- Always** perform regular inspections and maintenance on the bumper and related hardware.
- Never** operate this **WARN** product with damaged or missing parts.

I. TABLE OF CONTENTS

Parts List	page 2
Tools Required	page 2
Installation	page 3-4
Maintenance/Care	page 5

I. PARTS LIST

<u>ID</u>	<u>P/N</u>	<u>QTY</u>	<u>DESCRIPTION</u>
A1	83625	2	
A2	83627	1	
A3	83973	1	
B1	84882	2	
B2	29799	2	

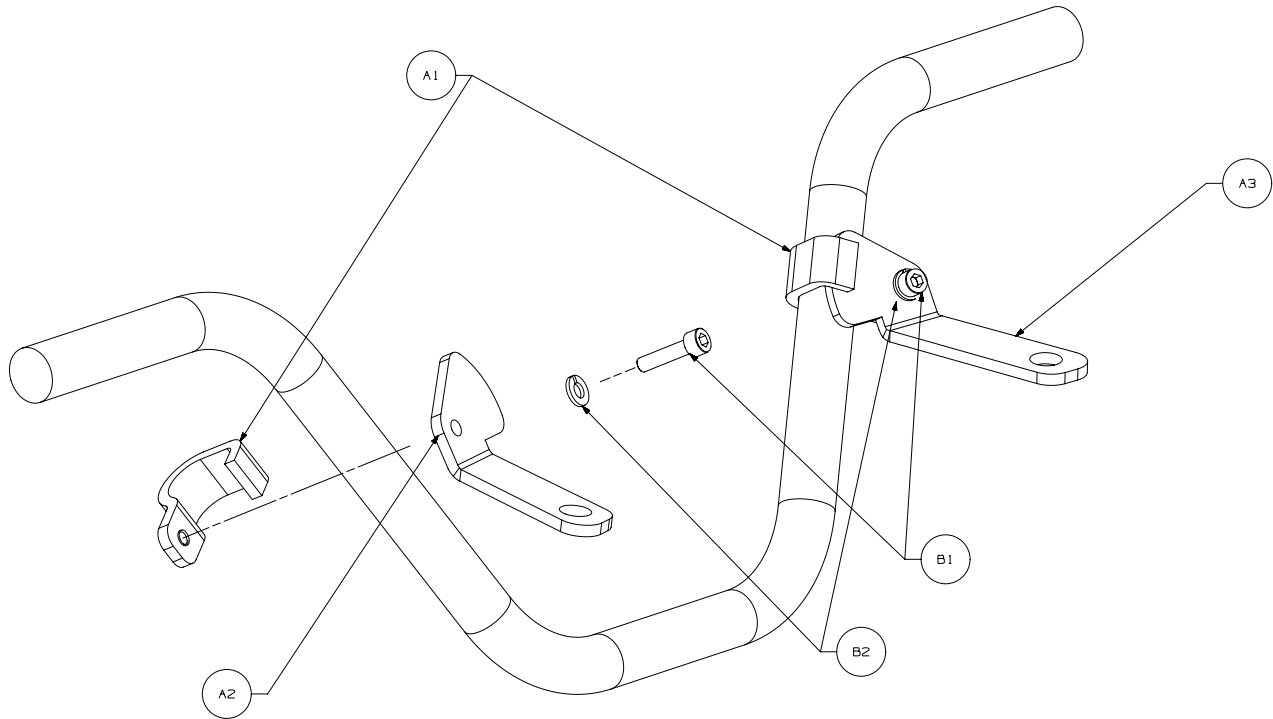

II. TOOLS REQUIRED

- 5mm Allen Wrench
- 17mm and 19mm Open End Wrench

III. INSTALLATION

1. Place handle bar clamp with radius face to the rear of Handle bar. The threaded end should be pointing away from vehicle. Shown in figure 1.



Figure 1

2. Place left or right hand bracket (A2 and A3) under the hooked edge of the clamp in figure 1. Make sure that the holes are lined up for the next step. Shown in figure 2.



Figure 2

3. Place the socket head screw and a lock washer through the hole in the bracket. Thread the screw into the bracket positioned behind, but do not tighten yet. Shown in Figure 3.



Figure 3

INSTALLATION CONT.

4. Once you have both light brackets assemblies installed, you can now position them for height, from side to side. At this time you will want to also rotate the brackets that the light attaches to clockwise or counter clockwise so the bracket are level. Also simultaneously rotating the whole assembly around the handle bar for optimal positioning. Tighten the screws at this time to lock into position. See figure 4.

⚠ WARNING

Do not over tighten clamps as they will distort and fail to clamp correctly. Tighten only enough to keep clamps from rotating in both directions. If light moves during riding tighten clamps a little more.



Figure 4

5. Install light as shown in Figure 5, also note that the bracket tips forward. This is o.k. as it varies from vehicle to vehicle. The light hinge point will compensate for that. Do not tighten yet. See figure 5.



Figure 5

6. Figure 6 shows the complete installation of the lights and brackets. You may now aim your lights and tighten the nuts on the lights. If you have not wired your vehicle you are now ready.



Figure 6

**PROCEED TO SECTION TITLED
“MAINTENANCE/CARE”.**

IV. MAINTENANCE/CARE

1. Inspect all parts on the light bracket and related hardware prior to each use. Replace all hardware that appears rusted or deformed.

WARNING

FAILURE TO SECURELY TIGHTEN ALL SCREWS ON THE LIGHT BRACKET CAN RESULT IN PRODUCT FAILURE WHICH MAY RESULT IN VEHICLE DAMAGE AND OPERATOR INJURY. DOUBLE CHECK THAT ALL SCREWS ARE SECURELY TIGHTENED PRIOR TO USE.