



SIGNATURE OF QUALITY

AUTOMOTIVE PRODUCTS, INC.

# INSTALLATION INSTRUCTIONS

HDX RUNNING BOARDS  
APPLICATION: CHEVY/GMC VAN 1996-15 EXPRESS/SAVANA  
PART # 57-53743

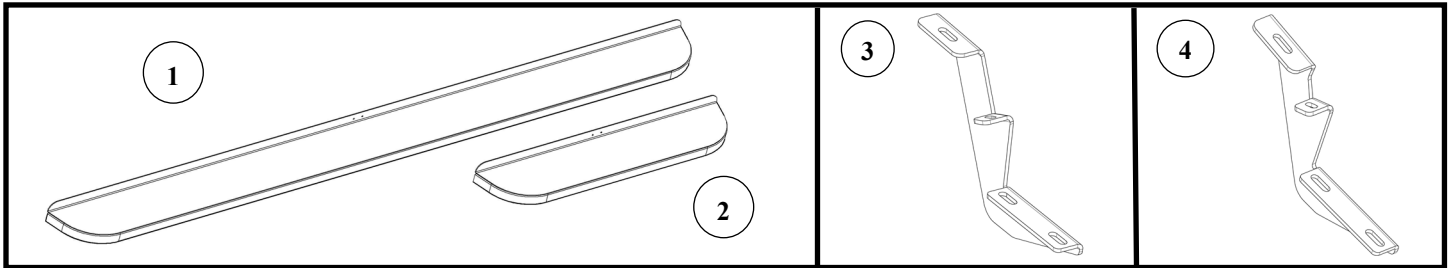

ITEM	QUANTITY	DESCRIPTION	TOOLS NEEDED
1	1	RUNNING BOARD PASSENGER	13MM SOCKET
2	1	RUNNING BOARD DRIVER	13MM WRENCH
3	4	FRONT BRACKET	4MM ALLEN WRENCH
4	2	REAR BRACKET	10MM SOCKET
5	18	M8 HEX HEAD BOLT	10MM WRENCH
6	18	M8 24MM FLAT WASHER	RATCHET
7	18	M8 LOCK WASHER	TORQUE WRENCH
8	18	M8 U-NUT	TRANSFER PUNCH
9	6	M6 HEX NUT	1/4-3/4 STEP DRILL BIT
10	6	M6 BUTTOM-HEAD SCREW	7/16" DRILL BIT
11	6	M6 LOCK WASHER	5/16" DRILL BIT
12	12	M6 FLAT WASHER	CENTER DRILL BIT

**ANTI-SEIZE LUBRICANT MUST BE USED ON ALL STAINLESS STEEL FASTENERS TO PREVENT THREAD DAMAGE AND GALLING .**

- Remove contents from box, verify if all parts listed are present and free from damage. Carefully read and understand all instructions before attempting installation.
- Identify passenger (Item 1) and driver (Item 2) side running boards and install M8 u-nut clips (Item 8) to the underside of the boards. **Figure 1.**
- Starting at the passenger side. Center the running board between front and rear fender.
- Locate on the running board the 2nd bracket location from the front.
- Place a front bracket (Item 3) in the rocker panel as shows in **figure 4**. Use a center punch mark the locations where holes are going to be drilled. (Be sure the bracket sits in a flat area at the inner-rocker panel).
- At the inner-rocker panel. Make another center mark at 3/4" from the first center mark were the bracket rear flange will sit. (be sure to mark it in a flat area) **Figures 5 and 6.**
- Using the center drill bit to start. Drill holes in the first two marks from step 5. Drill at the outer-rocker panel 5/16" hole and 7/16" at the inner-rocker panel. **Figures 5 and 6.**
- Using a step drill bit, drill a 3/4" hole at the 2nd mark in the inner-rocker panel.  
**Pay special attention to the holes drilling locations. Figures 5 and 6. Follow instructions carefully. Not doing it may cause problems for proper installation. Use some paint primer at the drilling holes to avoid rust in the future.**
- Slip a (1x) U-nut clip (Item 8) through the 3/4" hole and position the extruded threaded hole of the u-clip at the 7/16" hole. Figure 6.
- Figures 7 & 8.** Install one front bracket (Item 3) using (1x) M8 hex head bolts (item 5), (1x) M8 lock washers (item 7), (1x) M8 flat washers (item 6), (1x) M6 button-head screw (Item 10), (1x) M6 hex nut (Item 9), (2x)M6 flat washers (Item 12), and (1x) M6 lock washer (Item 11) *Do not fully tighten at this time.*



Westin Automotive Products, Inc.  
320 Covina Blvd  
San Dimas, Ca. 91773

Thank You for choosing Westin products  
For Additional installation assistance please call  
Customer service (800) 793-7846  
www.westinautomotive.com

11. Place the running board at the bracket, using two M8 hex head bolts (*item 5*) to align the running board **Figure 2**, and use a jack stand for the rear end to place the running board in position for installation.
12. Install (1x) front bracket (Item 3) and (2x) rear brackets (Item 4) on the running board using on each bracket (1x) M8 hex head bolts (*item 5*), (1x) M8 lock washers (*item 7*), (1x) M8 flat washers (*item 6*) **Figure 2**. *Do not fully tighten at this time.*
13. Repeat step 5 for each bracket. Remove the running board and repeat steps 6 to 9.
14. Repeat step 11 to align running board and install each bracket using step 10. *Do not fully tighten at this time.*
15. Get the remaining 2 front brackets. Repeat steps 3-14 for the Driver side.
16. Align and adjust running boards as needed then fully tighten all hardware at this time. Torque M8 fasteners to 18 ft. lbs. and M6 to 8 ft. lbs.

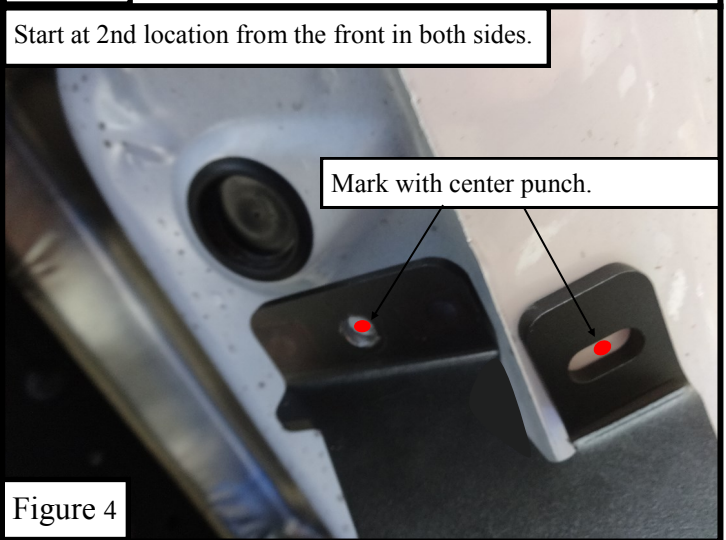
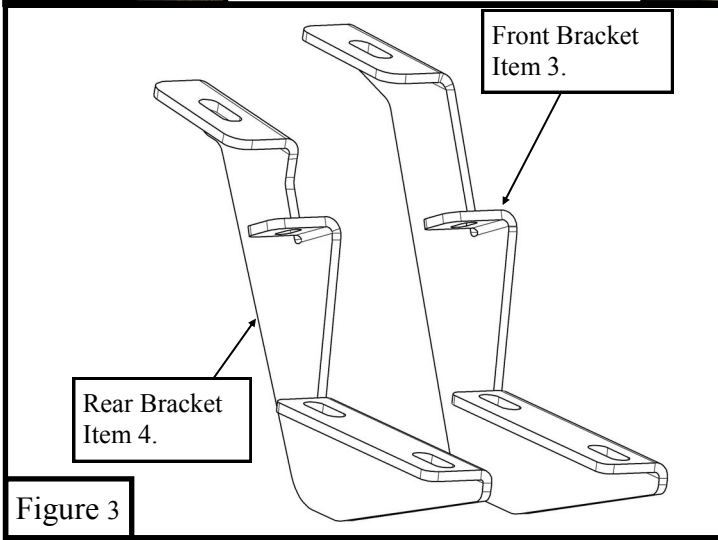
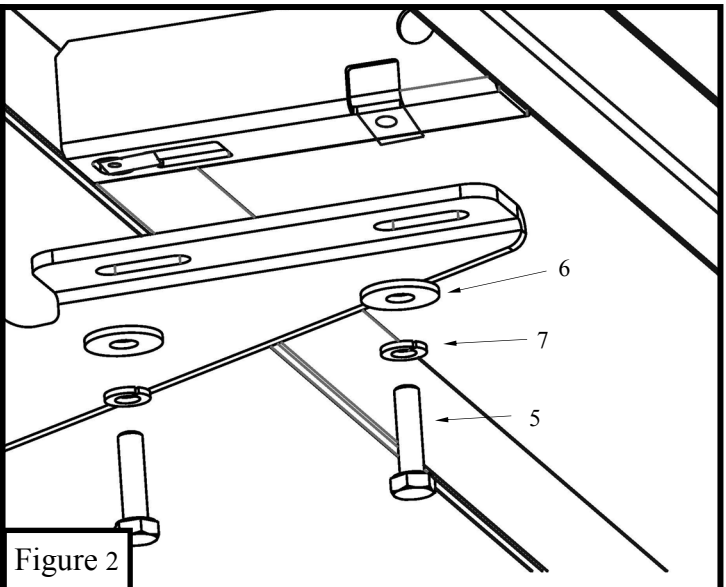
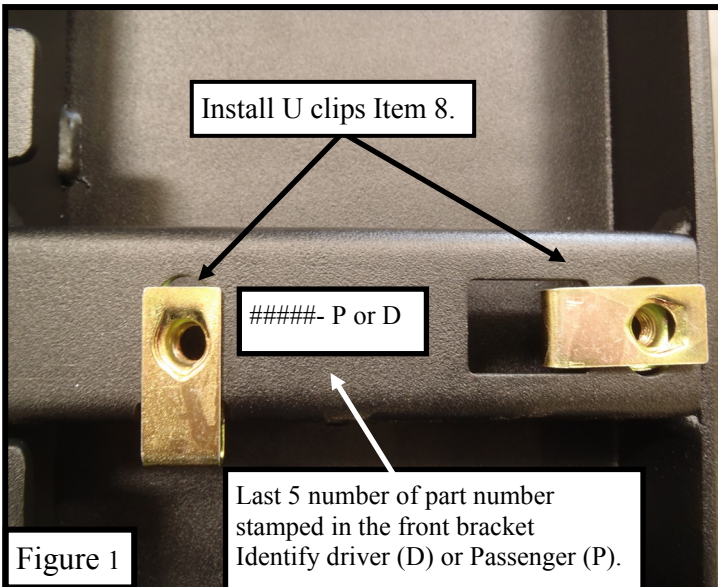

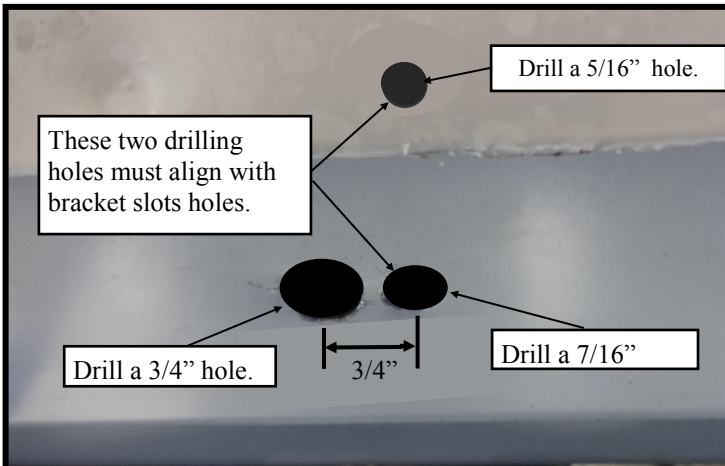

Figure 5

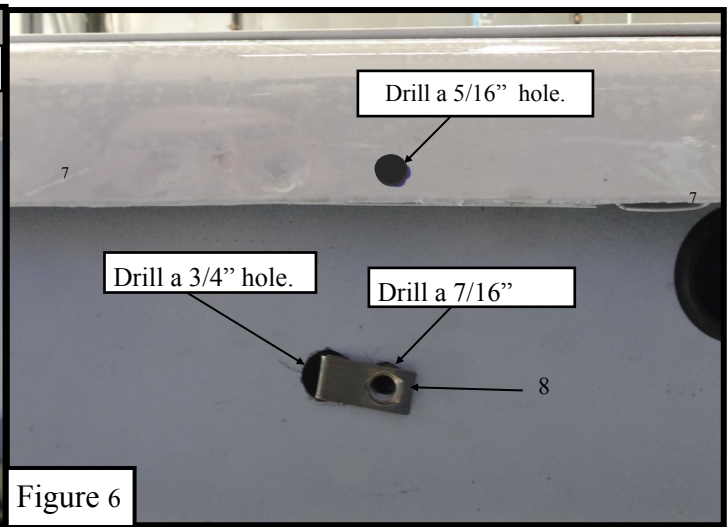

Figure 6



Figure 7

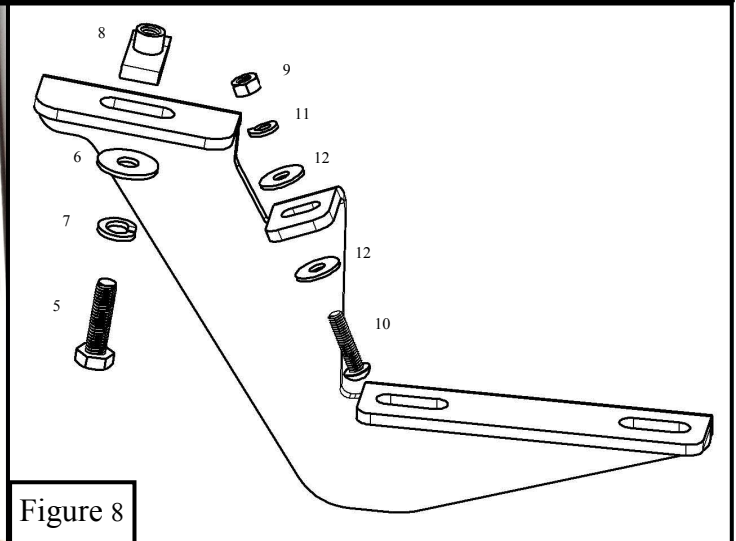

Figure 8

Installation complete

