



AUTOMOTIVE PRODUCTS,

## INSTALLATION INSTRUCTIONS

### OFF-ROAD LIGHT BAR

#### APPLICATION:

2016 Toyota Tacoma

#### PART NUMBER:

37-03880, 37-03885

ITEM	QUANTITY	DESCRIPTION	TOOLS NEEDED
1	1	LIGHT BAR ASSEMBLY	15MM SOCKET
2,3	2	MOUNTING BRACKET, DRIVER(2) AND PASSENGER(3)	16MM SOCKET
4,5	2	SUPPORT STRAP, DRIVER(4) AND PASSENGER(5)	12MM SOCKET
6	2	M10 BOLT PLATE (YELLOW ZINC)	15MM WRENCH
7	4	M10 HEX NUT (YELLOW ZINC)	16MM WRENCH
8	8	M10 FLAT WASHER (YELLOW ZINC)	12MM WRENCH
9	8	M10 SPLIT LOCK WASHER (YELLOW ZINC)	5MM ALLEN WRENCH
10	4	M10 HEX HEAD BOLT (YELLOW ZINC)	RATCHET
11	4	M8 BUTTON HEAD BOLT (BLACK ZINC OR RAW)	TORQUE WRENCH
12	4	M8 FLAT WASHER (BLACK ZINC OR RAW)	
13	4	M8 HEX FLANGE NUT (BLACK ZINC OR RAW)	

**ANTI-SEIZE LUBRICANT MUST BE USED ON ALL STAINLESS STEEL FASTENERS TO PREVENT THREAD DAMAGE AND GALLING**

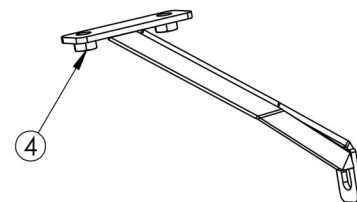
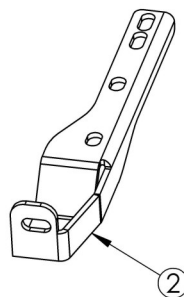
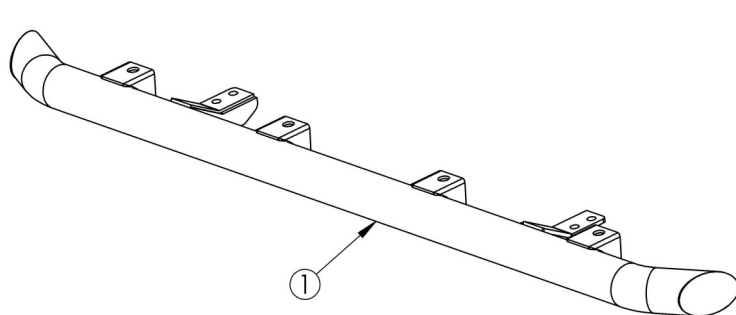

Driver Side Items Shown  
Passenger Side Opposite

### PROCEDURE

1. Remove contents from box, verify if all parts listed are present and free from damage.  
Carefully read and understand all instructions before attempting installation.  
**Failure to identify damage before installation could lead to a rejection of any claim.**
2. Lift the hood and locate and remove 2 bolts and 2 plastic retainers (**Figure 1**). and carefully pull the grille off. .
3. Locate (2) M10 bolt plates and insert through (2) holes located on the radiator support. **See Figure 2.**
4. Locate (1) Mounting Bracket and loosely secure to previously installed M10 bolt plate using (1) M10 hex nut, (1) M10 flat washer and (1) M10 split lock washer. Repeat for other side. **See Figures 3 and 7 Off-Road Light Bar Assembly.**
5. Locate (1) Support Strap and loosely secure onto factory bolt using (1) M10 hex nut, (1) M10 flat washer and (1) M10 split lock washer. Repeat for other side. **See Figures 4 and 7 Off-Road Light Bar Assembly.**



Westin Automotive Products, Inc.  
320 W. Covina Blvd  
San Dimas, Ca. 91773

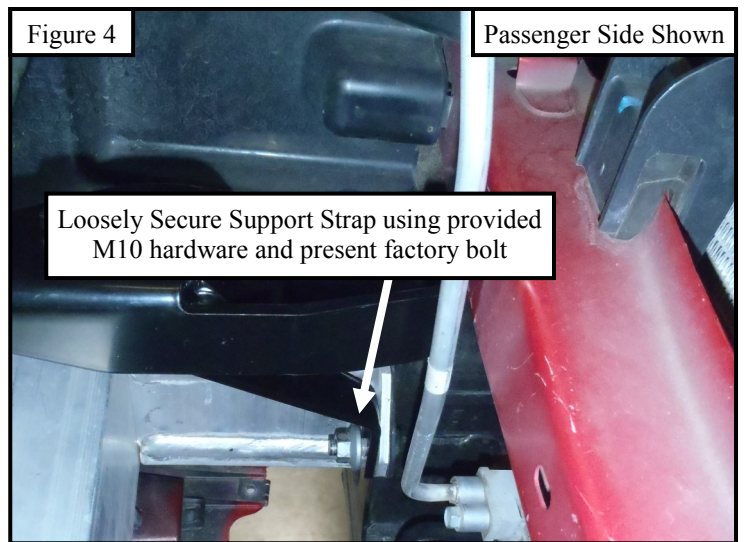
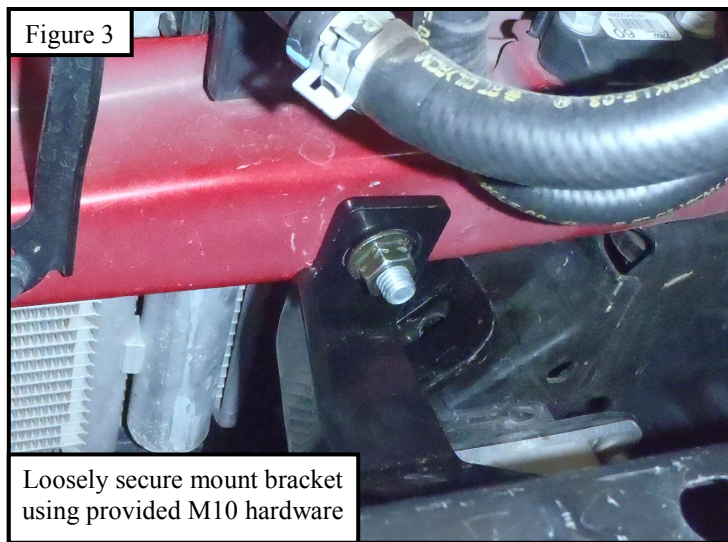
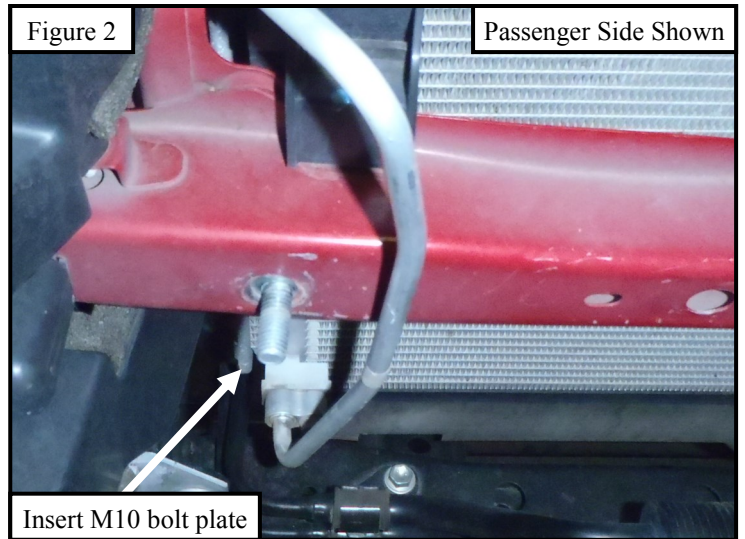
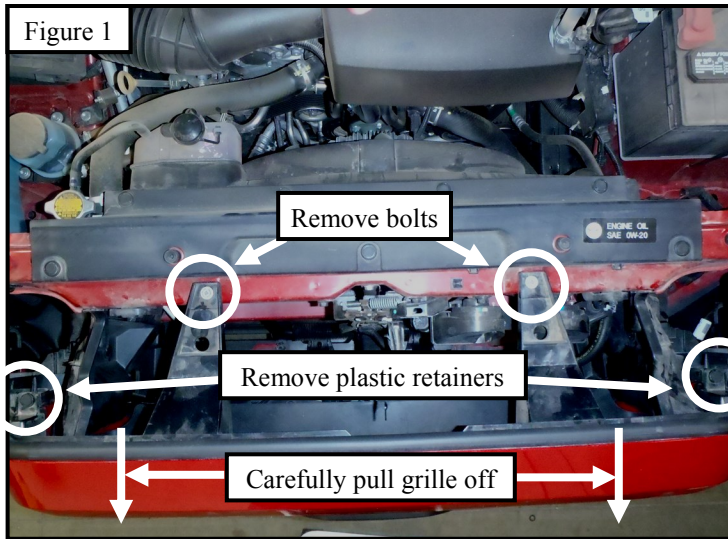

6. Loosely secure both the Mounting Brackets and Support Straps using (4) M10 hex head bolts, (4) M10 flat washers and (4) M10 split lock washers. See **Figures 5 and 7 Off-Road Light Bar Assembly**.
7. Loosely secure the Light Bar Assembly onto the Mounting Brackets using the provided M8 hardware. See **Figures 6 and 7 Off-Road Light Bar Assembly**.
8. Align and adjust the Off-Road Light Bar as necessary then fully tighten all hardware at this time. Torque all M10 hardware to 30-35 ft-lbs and M8 to 15-20 ft-lbs.

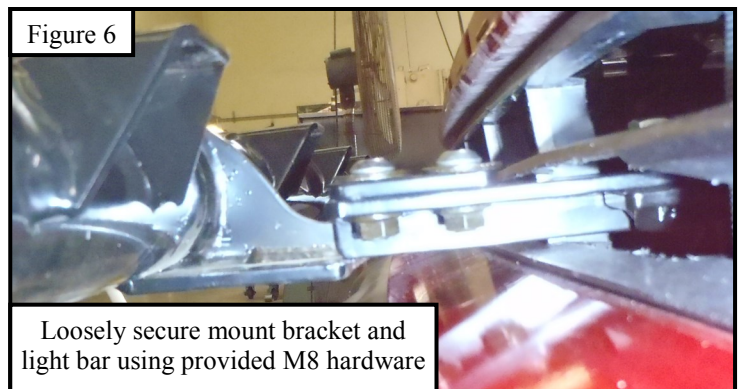

Westin Automotive Products, Inc.  
320 W. Covina Blvd  
San Dimas, Ca. 91773



Figure 7

Off-Road Light Bar Assembly

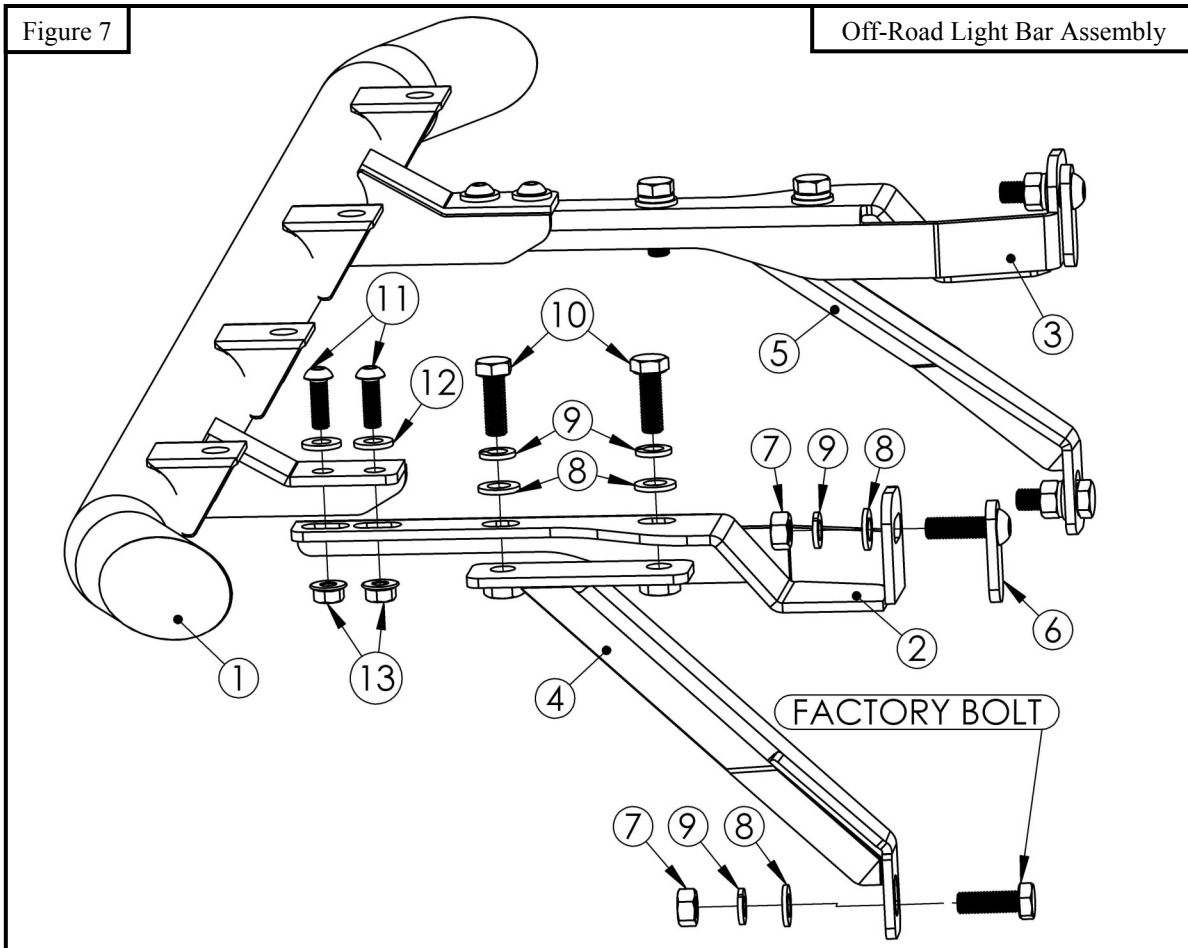

INSTALLATION COMPLETE



#### CARE INSTRUCTIONS

- REGULAR WAXING IS RECOMMENDED. DO NOT USE ANY TYPE OF POLISH OR WAX THAT MAY CONTAIN ABRASIVES.
- STAINLESS STEEL PRODUCTS CAN BE CLEANED WITH MILD SOAP AND WATER. STAINLESS STEEL POLISH SHOULD BE USED TO POLISH SMALL SCRATCHES.
- GLOSS BLACK FINISHES SHOULD BE CLEANED WITH MILD SOAP AND WATER.



Westin Automotive Products, Inc.  
320 W. Covina Blvd  
San Dimas, Ca. 91773

Thank you for choosing Westin products  
for additional installation assistance please call  
Customer Service (800) 793-7846  
[www.westinautomotive.com](http://www.westinautomotive.com)



AUTOMOTIVE PRODUCTS, INC.



## WARNING



Failure to follow these instructions could lead to death, personal injury, and / or property damage.

### FASTENERS:

All Westin supplied fasteners must be utilized and installed in accordance with the installation instructions and apply torque to the specifications as defined. **DOUBLE CHECK ALL FASTENERS BEFORE INITIAL USE, AND PERIODICALLY IN THE FUTURE TO ENSURE PROPER FUNCTION AND SAFETY.**

### DRILLING:

Most Westin products do not require drilling for installation. If drilling is defined as required, use caution when drilling a vehicle. **FAILURE TO REVIEW AN AREA TO BE DRILLED MAY RESULT IN PERSONAL INJURY AND/OR INJURY TO OTHERS AS WELL AS VEHICLE DAMAGE.**

### EYE PROTECTION:

**ALWAYS WEAR SAFETY GLASSES OR GOGGLES DURING THE INSTALLATION PROCESS TO AVOID PERSONAL INJURY.**

### MAXIMUM TOWING/CARRYING CAPACITY:

The Westin Receiver Hitches will have a visible tow rating label affixed directly on the product. User should never exceed the vehicle manufacturers maximum tow and weight rating regardless of the capacity of the hitch. **FAILURE TO FOLLOW THESE GUIDELINES WILL VOID THE WESTIN WARRANTY AND MAY RESULT IN PERSONAL INJURY AND/OR INJURY TO OTHERS AS WELL AS VEHICLE DAMAGE.**



Westin Automotive Products, Inc.  
320 W. Covina Blvd  
San Dimas, Ca. 91773