

# INSTALLATION INSTRUCTIONS

## HARD TRI-FOLD TONNEAU COVER



APPLICATION: UNIVERSAL FOR VEHICLES WITH NO UTILITY TRACKS

PART NUMBER: 19-44785, 19-44745, 19-43985, 19-46365, 19-44795, 19-44735, 19-44705, 19-43995, 19-44025, 19-46355, 19-41000

CONTENT			
ITEM	QUANTITY	DESCRIPTION	TOOLS NEEDED
1	1	COVER	5.0 ALLEN KEY
2	1	DRIVER SIDE RAIL	4.0 ALLEN KEY
3	1	PASSENGER SIDE RAIL	2.5 ALLEN KEY
4	4	BLACK M6 COMBINATION SCREWS	CUTTING TOOL
5	2	SUPPORT RODS	
6	2	SUPPORT ROD BRACKET	
7	6	CLAMP "A"	
8	6	CLAMP "B"	
9	6	PLASTIC KNOBS	
10	6	M8 SCREWS	
11	2	DRAIN PIPES	
12	1	FOAM SEAL	
ANTI-SEIZE LUBRICANT MUST BE USED ON ALL STAINLESS STEEL FASTENERS TO PREVENT THREAD DAMAGE AND GALLING			
Item 1			
	Item 2		

Item 3



Item 5



Item 6



Item 8

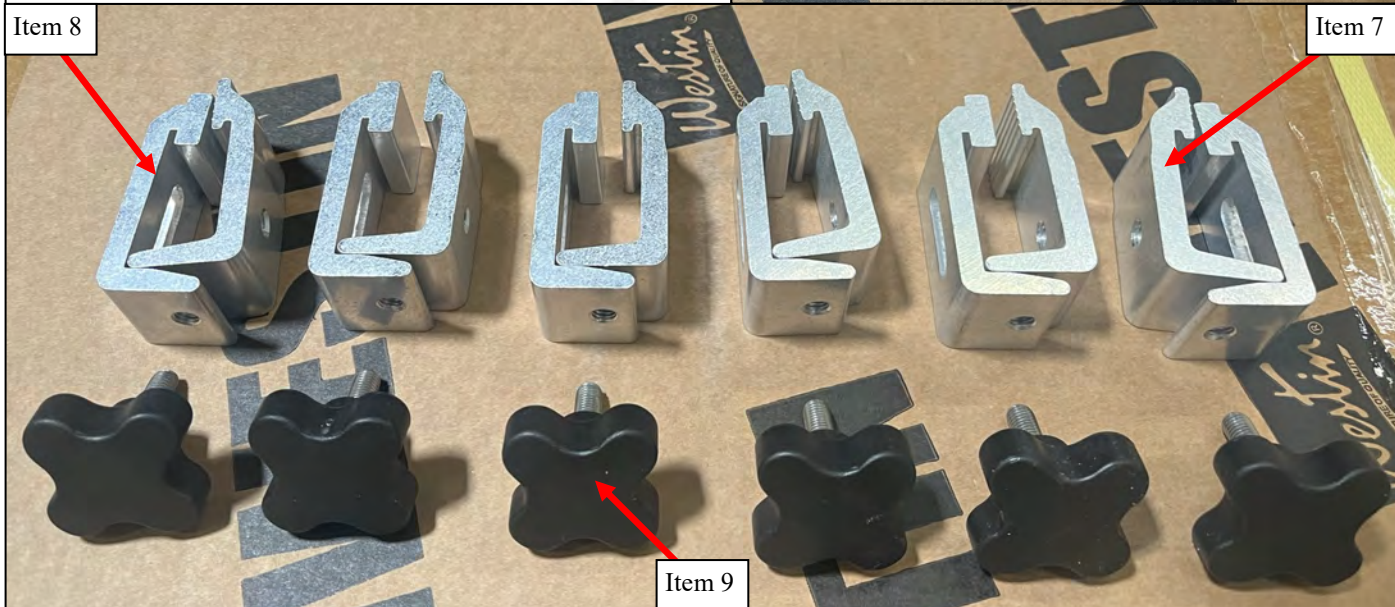

Item 7

Item 9

Item 11



Item 12



**WESTIN**

Westin Automotive Products, Inc.  
320 W. Covina Blvd  
San Dimas, Ca. 91773

## PROCEDURE

1. Remove contents from box, verify if all parts listed are present and free from damage.  
Carefully read and understand all instructions before attempting installation.  
**Failure to identify damage before installation could lead to a rejection of any claim.**

**NOTE:** Some vehicles may require assembly of the driver and passenger side rails. If applicable, use **figure 1** as reference, if not then continue to step 2.

2. Start by aligning the foam seal (Item 12) onto the top surface of the front bed wall. With a cutting tool, cut off any excess foam so it lines up with the edges. Then peel off the back so the adhesive can attach to the bed wall. **See figure 2** as reference.

Figure 1

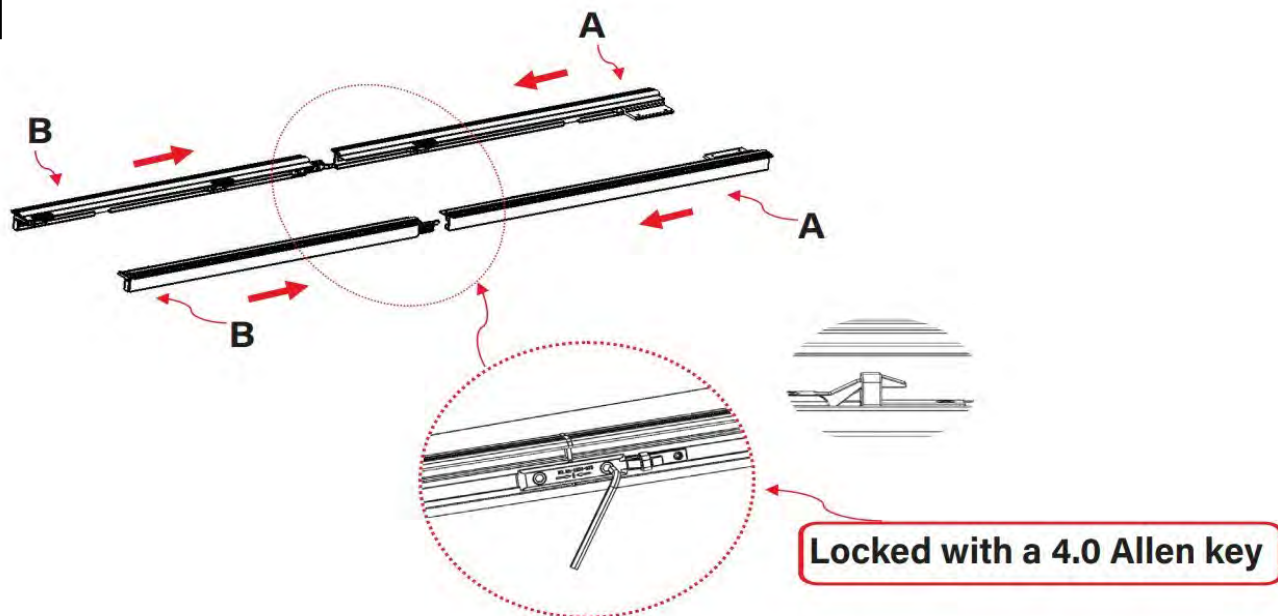
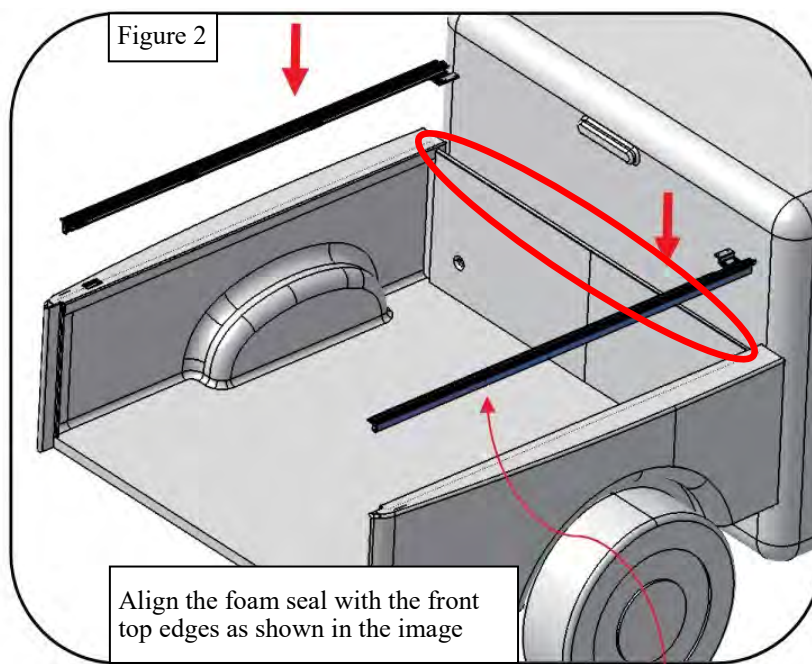

Figure 2



**WESTIN**

Westin Automotive Products, Inc.  
320 W. Covina Blvd  
San Dimas, Ca. 91773



3. Starting with the driver's side rail (Item 2), place the railing against the upper and inner sides of the bed rails. Flush with the interior so that the bar is vertical (Fig 3 & 4).

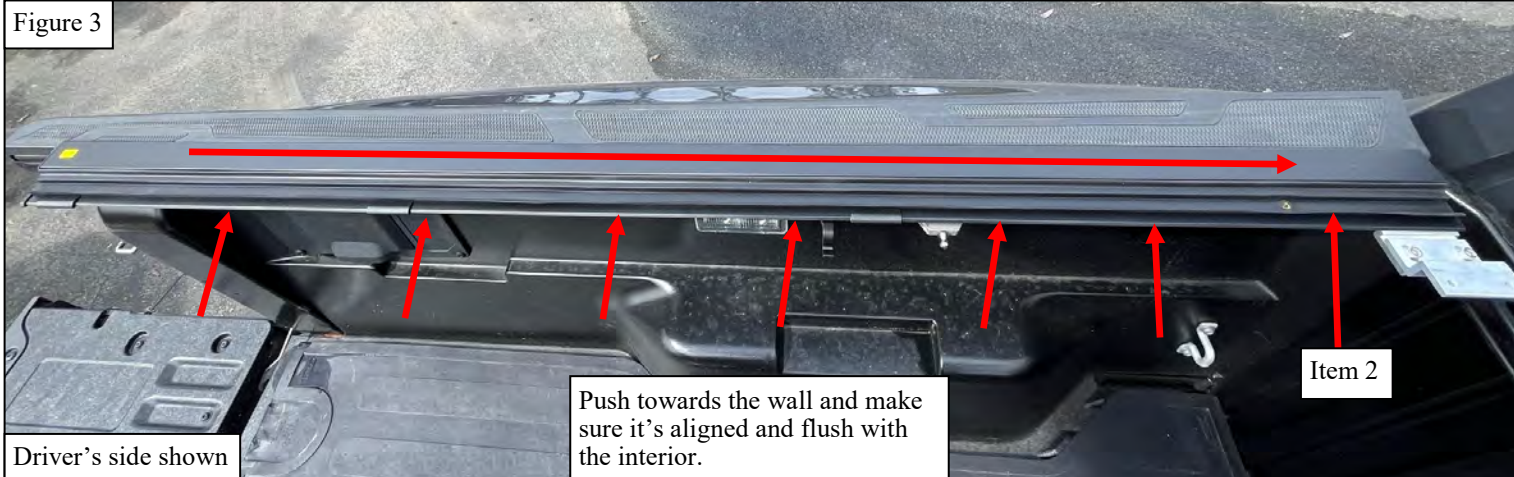

**WESTIN**

Westin Automotive Products, Inc.  
320 W. Covina Blvd  
San Dimas, Ca. 91773

4. Spread out three clamps “A” (Item 7) through the back of the rail, and three clamps “B” (Item 8) through the holes in the railing. Tighten three plastic knobs (Item 9) onto the bottom of clamps “B” , and after doing so pre-tighten three M8 screws (Item 10) with a 5.0 allen key, so the rail doesn’t move. After the three are pre-tighten, fasten each bolt so the rail fits snug against the bed wall. See **figures 5, 6, 7** as reference for this step.

Figure 5

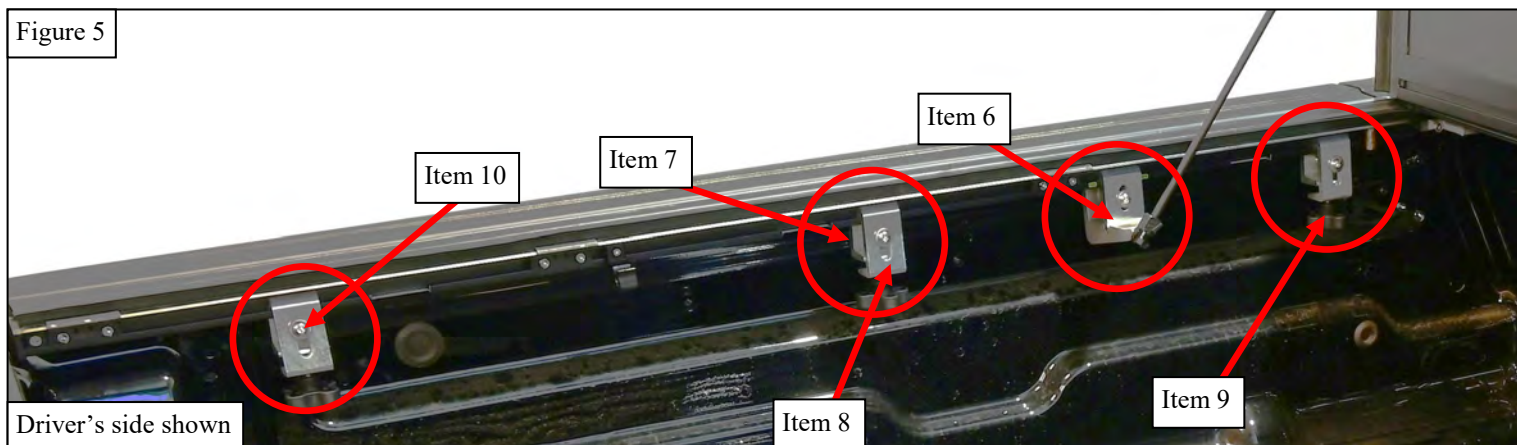
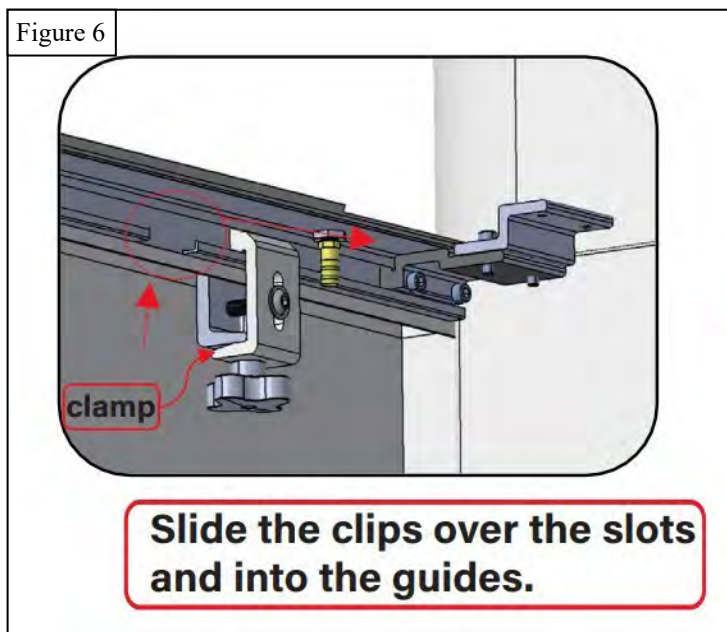
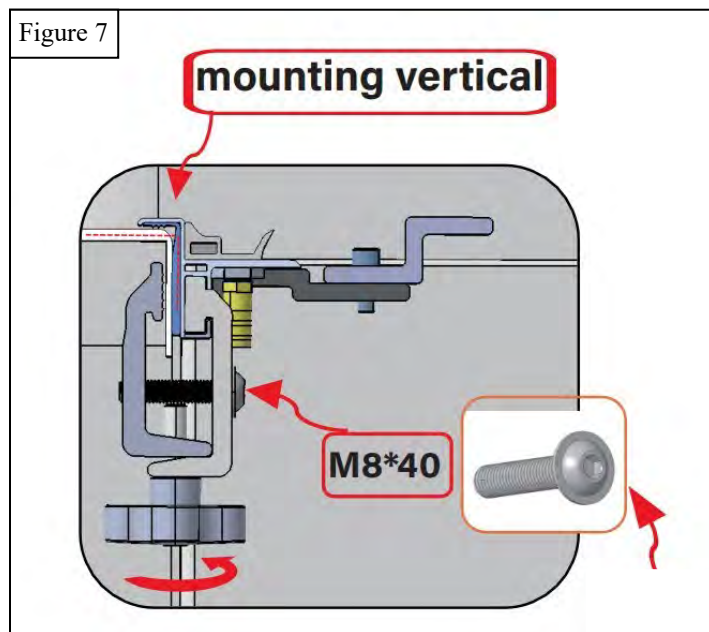

Figure 6



Driver's side shown

Figure 7





5. Slide in the support rod bracket (Item 6) and move it to where it's lined up in between the arrows on the rail. Once aligned, fasten a M8 screw onto the bracket so it doesn't move, do so with a 5.0 allen key. (**Fig 8**).
6. Attach the support rod (Item 5) to the bracket and recovery assemblies as shown in the images below (**Fig 9 & 10**).
7. Repeat steps two through six for the passenger's side rail (Item 3).

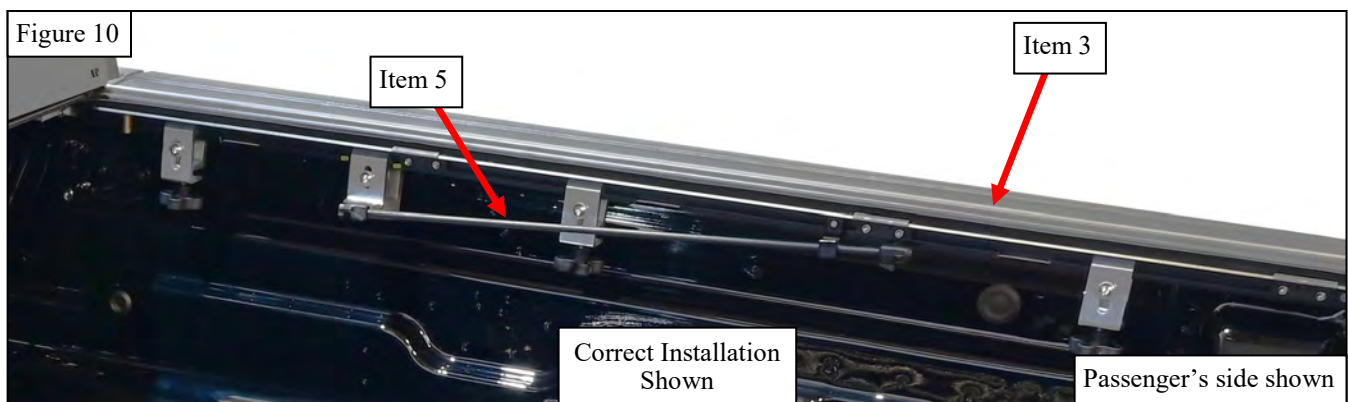
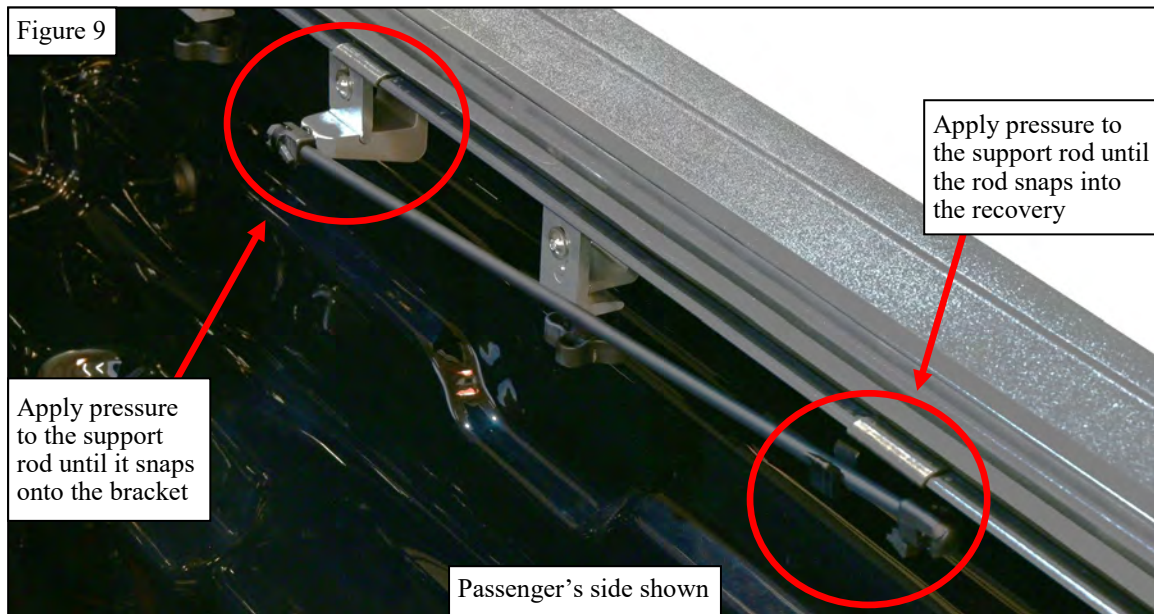
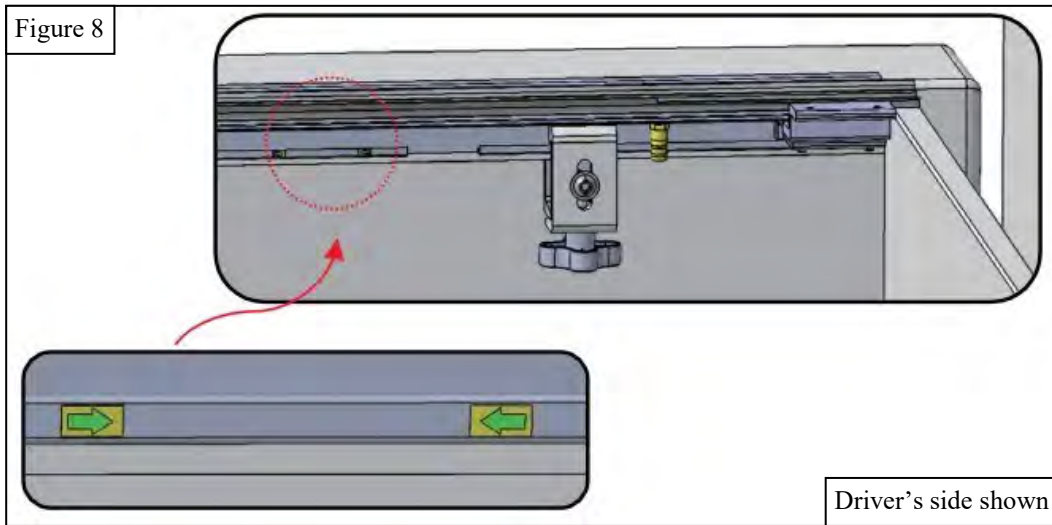

8. Align the cover (Item 1) onto the truck bed horizontally, so that it's even with the sides of the truck bed (**Fig 11**).
9. Turn out the rubber strip so it wraps around the top of the front truck bed wall (**Fig 12**).
10. Position the cover so the holes align with the holes on the top of the railing. Install the M6 bolts (Item 4) see (**Fig 13**).

Figure 11

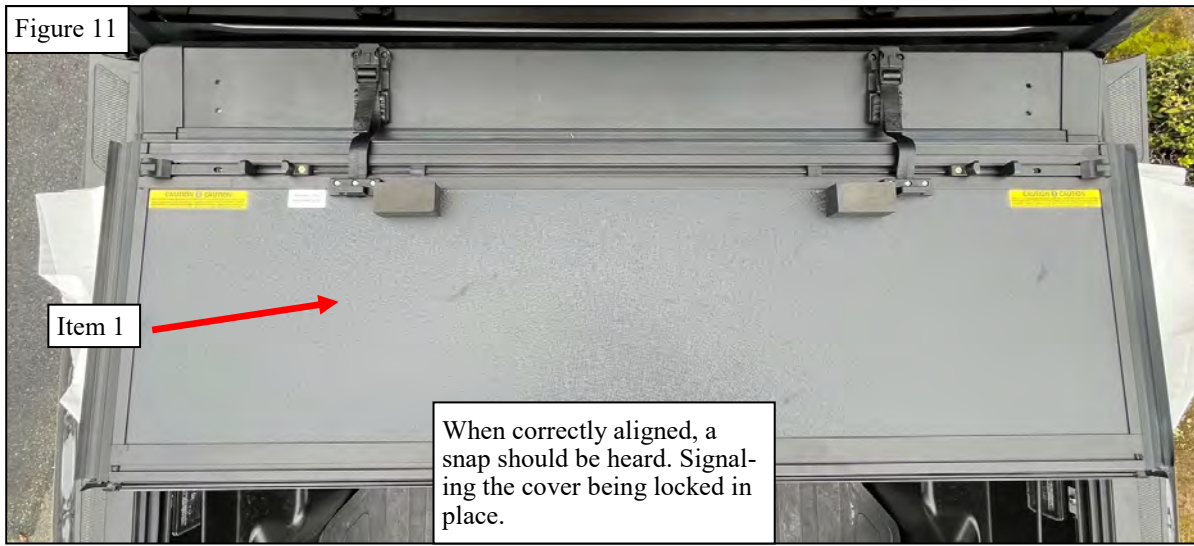
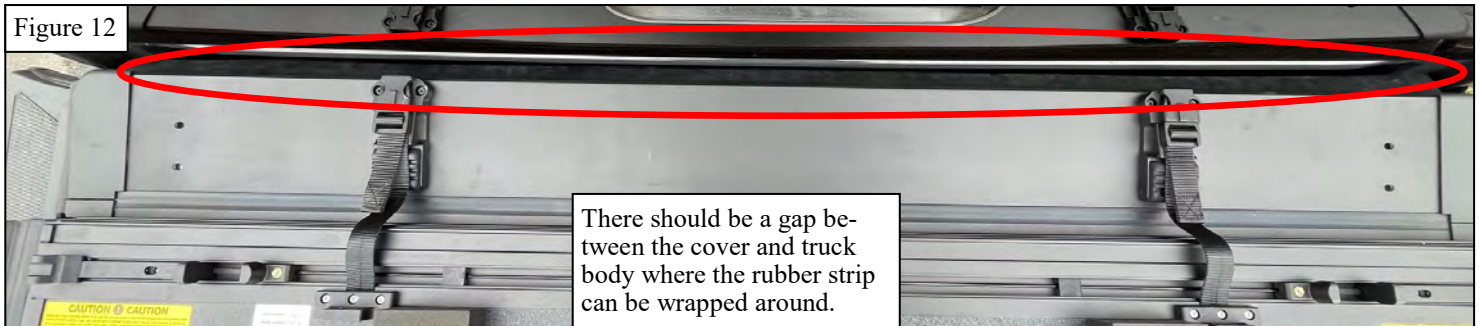

Figure 12



Driver's side shown

Figure 13





11. After aligning the holes, pre-tighten the M6 bolts with a 5.0 allen Key (Fig 14, 15, 16).

**NOTE:** Before pre-tightening the bolts, make sure the space between the end of the cover and the top of the tailgate is correct. The cover needs to be flush with the foam seal making it fully sealed. If not, adjust the cover accordingly then continue with the rest of the procedure. See **figure 17** as reference.

Figure 14



Figure 15

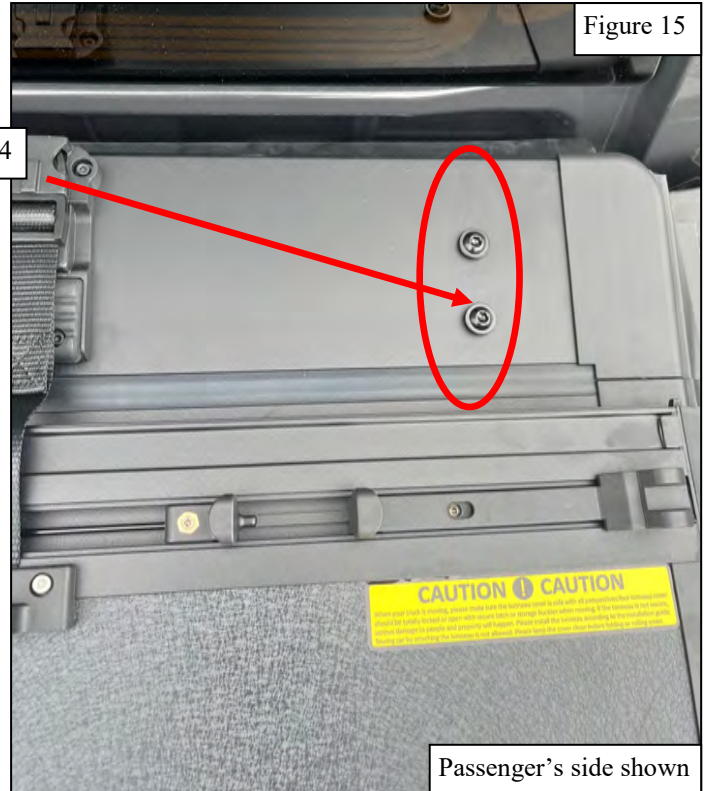

Figure 16

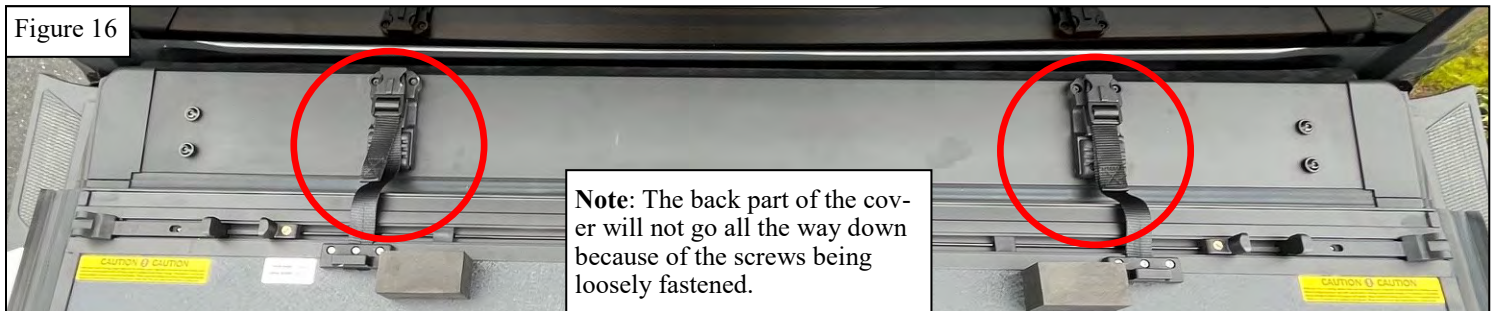

Figure 17



**WESTIN**

Westin Automotive Products, Inc.  
320 W. Covina Blvd  
San Dimas, Ca. 91773



12. After loosely threading the bolts, unfold the cover by unclipping the locks circled in **figure 16** and snap it into the lock slots to ensure each lock works properly. See **figures 18 and 19** as reference.
13. If locks are properly working and aligned, tighten the bolts and continue onto the next step. If not, adjust accordingly so the cover is aligned then tighten.

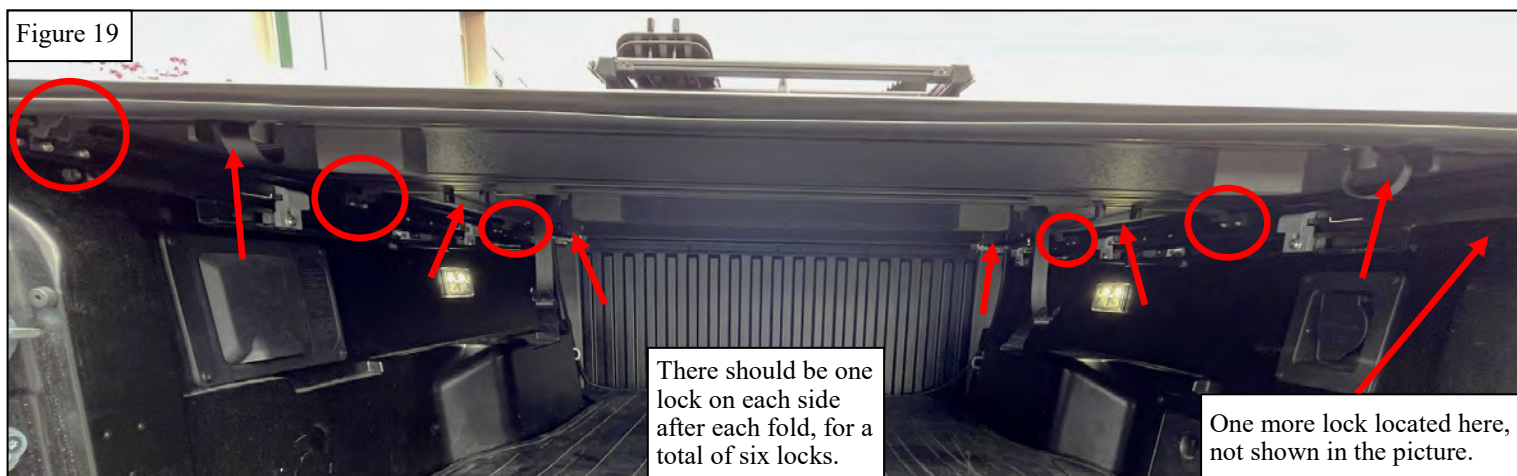
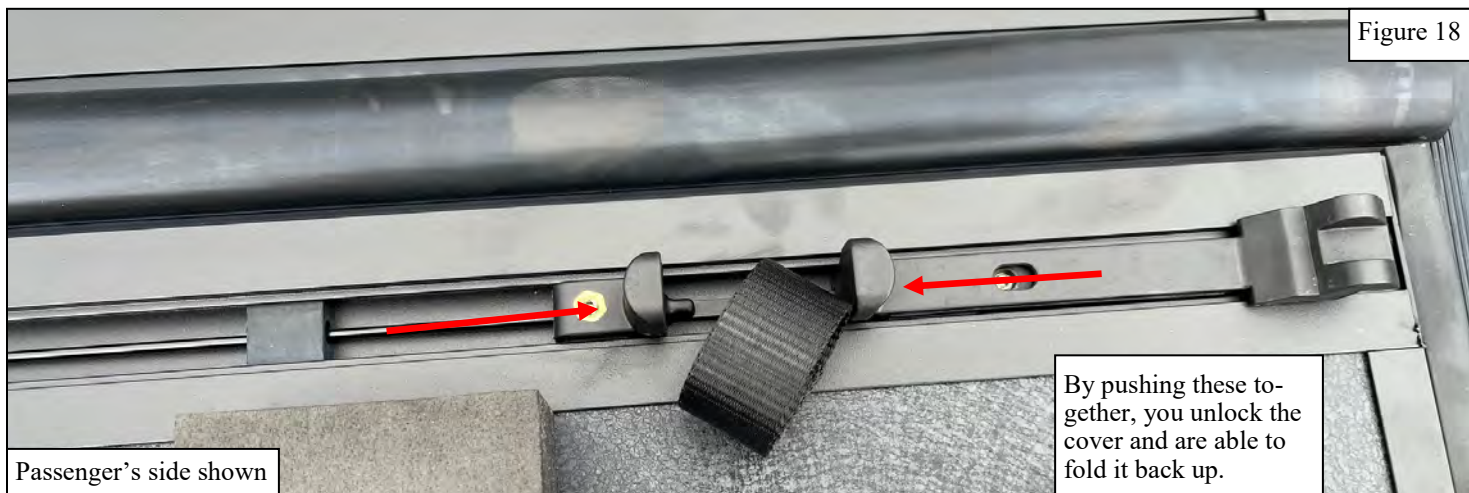

14. Starting on the driver's side, to install the drain hose (Item 11), push the drain hose up the opening until completely sealed tight. Run the hose on the side of the front bed wall of the truck until reaches the bottom then point it to the holes on the truck bed. Repeat this process for the passenger's side (**Fig 20, 21, 22**).

15. Once both are installed, close the cover and then the tailgate.

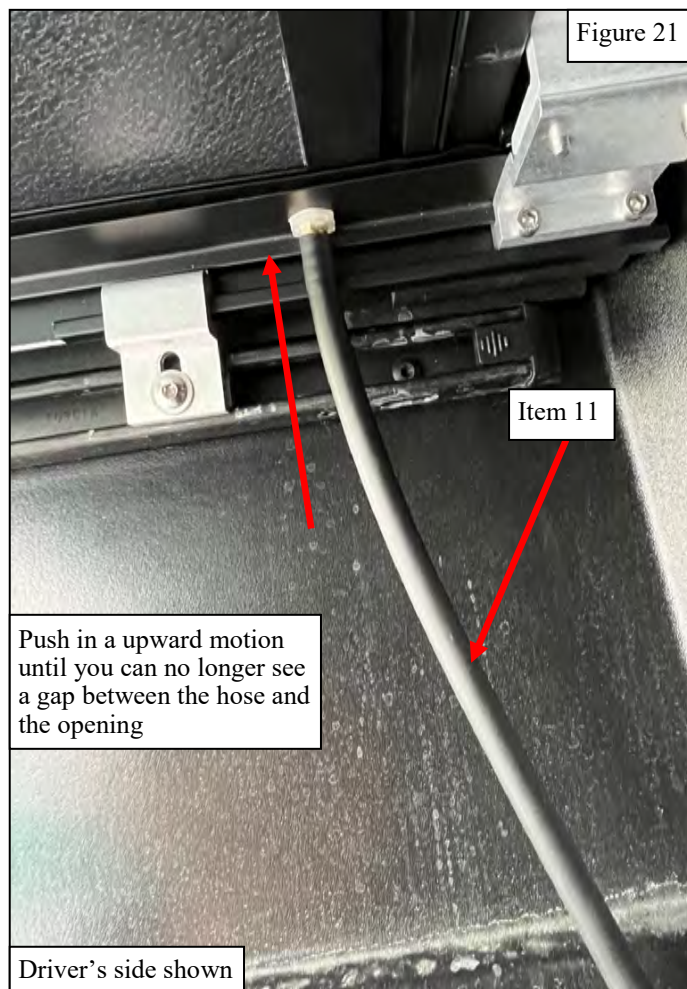

**WESTIN**

Westin Automotive Products, Inc.  
320 W. Covina Blvd  
San Dimas, Ca. 91773



## INSTALLATION COMPLETE



### CARE INSTRUCTIONS

- REGULAR WAXING IS RECOMMENDED. DO NOT USE ANY TYPE OF POLISH OR WAX THAT MAY CONTAIN ABRASIVES.
- STAINLESS STEEL PRODUCTS CAN BE CLEANED WITH MILD SOAP AND WATER. STAINLESS STEEL POLISH SHOULD BE USED TO POLISH SMALL SCRATCHES.
- GLOSS BLACK FINISHES SHOULD BE CLEANED WITH MILD SOAP AND WATER.

**WESTIN** Westin Automotive Products, Inc.  
320 W. Covina Blvd  
San Dimas, Ca. 91773

P.N.: 75-1943985-RevA

ECO #:W25-0111

Thank you for choosing Westin products  
for additional installation assistance please call  
Customer Service (800) 793-7846  
[www.westinautomotive.com](http://www.westinautomotive.com)

DATE: 03/13/2025



## WARNING



Failure to follow these instructions could lead to death, personal injury, and / or property damage.

Failure to follow these instructions could lead to death, personal injury, and / or property damage.

### FASTENERS:

All Westin supplied fasteners must be utilized and installed in accordance with the installation instructions and apply torque to the specifications as defined. **DOUBLE CHECK ALL FASTENERS BEFORE INITIAL USE, AND PERIODICALLY IN THE FUTURE TO ENSURE PROPER FUNCTION AND SAFETY.**

### DRILLING:

Most Westin products do not require drilling for installation. If drilling is defined as required, use caution when drilling a vehicle. **FAILURE TO REVIEW AN AREA TO BE DRILLED MAY RESULT IN PERSONAL INJURY AND/OR INJURY TO OTHERS AS WELL AS VEHICLE DAMAGE.**

### EYE PROTECTION:

**ALWAYS WEAR SAFETY GLASSES OR GOGGLES DURING THE INSTALLATION PROCESS TO AVOID PERSONAL INJURY.**

### MAXIMUM TOWING/CARRYING CAPACITY: (if applicable)

The Westin Receiver Hitches will have a visible tow rating label affixed directly on the product. User should never exceed the vehicle manufacturers maximum tow and weight rating regardless of the capacity of the hitch. **FAILURE TO FOLLOW THESE GUIDELINES WILL VOID THE WESTIN WARRANTY AND MAY RESULT IN PERSONAL INJURY AND/OR INJURY TO OTHERS AS WELL AS VEHICLE DAMAGE.**

### FOR CALIFORNIA RESIDENTS ONLY-PROP 65 WARNING:

Some products may contain chemicals such as DEHP, which can cause cancer, birth defects or other reproductive harm. For more info go to [www.p65warnings.ca.gov](http://www.p65warnings.ca.gov)



Westin Automotive Products, Inc.  
320 W. Covina Blvd  
San Dimas, Ca. 91773

Thank you for choosing Westin products  
for additional installation assistance please call  
Customer Service (800) 793-7846  
[www.westinautomotive.com](http://www.westinautomotive.com)