

INSTALLATION INSTRUCTIONS

R5 M-SERIES WTW XD STEPS



APPLICATION:

2020 Chevy Silverado 2500/3500 Crew Cab 6.5ft Bed
2020 GMC Sierra 2500/3500 Crew Cab 6.5ft Bed

PART NUMBER:

28-5234760, 28-5234765

CONTENT			
ITEM	QUANTITY	DESCRIPTION	TOOLS NEEDED
1	2	STEP BAR FRONT SECTION (1 DRIVER, 1 PASSENGER)	10MM SOCKET
2	2	STEP BAR REAR SECTION (1 DRIVER, 1 PASSENGER)	10MM WRENCH
3	2	STEP PAD (NOT ASSEMBLED)	13MM WRENCH
4	2	REINFORCEMENT LINK TALL	16MM SOCKET
5	2	REINFORCEMENT LINK SHORT	16MM WRENCH
6	2	LINK PLATE	18MM SOCKET
7,8	2	LINK BRACKET (1 DRIVER, 1 PASSENGER)	18MM WRENCH
9	16	SELF THREADING NUTS	RACHTET
10,11	6	MOUNTING BRACKET (3 DRIVER, 3 PASSENGER)	TORQUE WRENCH
12,13	2	TOP ISOLATOR BRACKET (1 DRIVER, 1 PASSENGER)	
14,15	2	BOTTOM ISOLATOR BRACKET (1 DRIVER, 1 PASSENGER)	
16	4	ISOLATOR KIT	
17	8	PLATE ADAPTER	
18	10	PLASTIC BRACKET COVER	
19	16	M8 HEX NUT (BLACK ZINC)	
20	32	M8 SPLIT LOCK WASHER (BLACK ZINC)	
21	32	M8 FLAT WASHER (BLACK ZINC)	
22	16	M8 HEX HEAD CAP SCREW (BLACK ZINC)	
23	20	M6 HEX HEAD CAP SCREW (YELLOW ZINC)	
24	40	M6 FLAT WASHER (YELLOW ZINC)	
25	20	M6 NYLOCK NUT (YELLOW ZINC)	
26	4	M12 HEX HEAD BOLT (YELLOW ZINC)	
27	4	M12 SPLIT LOCK WASHER (YELLOW ZINC)	
28	4	M10 FLANGED HEX HEAD BOLT (BLACK ZINC)	
29	12	M6 HEX HEAD CAP SCREW (BLACK ZINC)	
30	12	M6 SPLIT LOCK WASHER (BLACK ZINC)	
31	12	M6 FLAT WASHER (BLACK ZINC)	
ANTI-SEIZE LUBRICANT MUST BE USED ON ALL STAINLESS STEEL FASTENERS TO PREVENT THREAD DAMAGE AND GALLING			

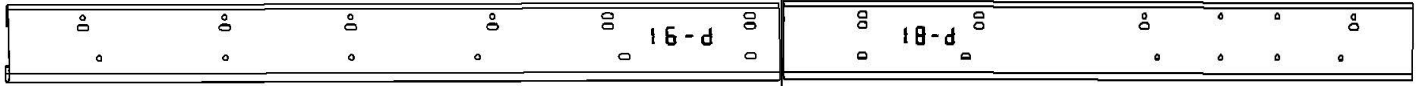

Item 1

Item 2

ITEM 3



ITEM 4

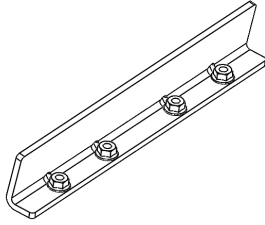

ITEM 5

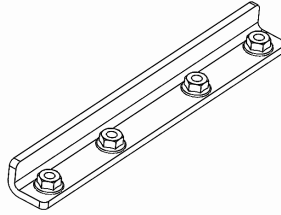

ITEM 6

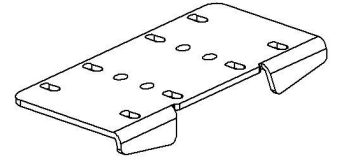

ITEM 7

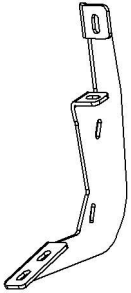

ITEM 8

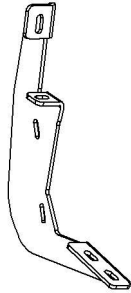

ITEM 10

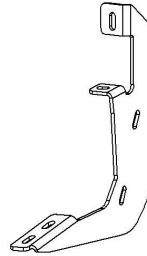

ITEM 11

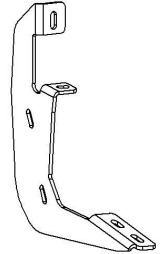

ITEM 12

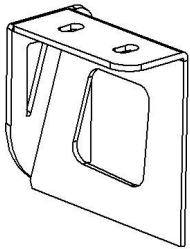

ITEM 13

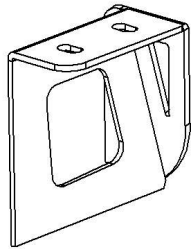

ITEM 14

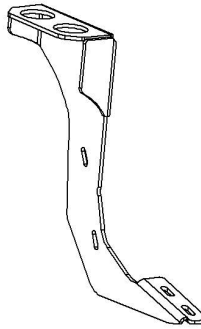

ITEM 15

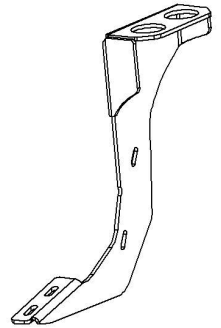

ITEM 16

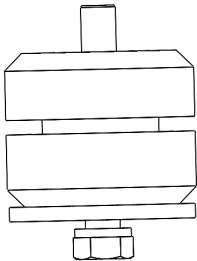

ITEM 17

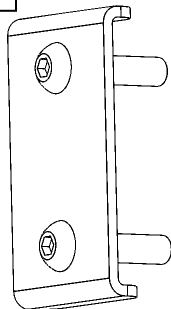

ITEM 18

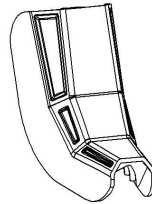

PROCEDURE

1. Remove contents from box, verify if all parts listed are present and free from damage.
Carefully read and understand all instructions before attempting installation.
Failure to identify damage before installation could lead to a rejection of any claim.
2. Starting on the driver side, remove the rubber plugs located on the rocker panel at each mounting location. See **Figure 1**.
3. **For models with threaded holes:** At each bracket mounting location on the rocker panel there should be a welded factory nut.



Figure 1

4. Starting on the driver side locate (1) Mounting Bracket (Item 10) and loosely secure it to the rocker panel using the provided hardware: (2) M8 hex head bolt, (2) M8 flat washer, and (2) M8 lock washer. See **Figure 2**.
5. Repeat **Step 4** for all remaining standard Mounting Bracket (Item 10) locations.
6. Install the Link Bracket (Item 7) using the supplied hardware: (2) M8 hex head bolt long, (2) M8 flat washer, and (2) M8 lock washer. (This is located at the third to the front location) See **Figure 3**.

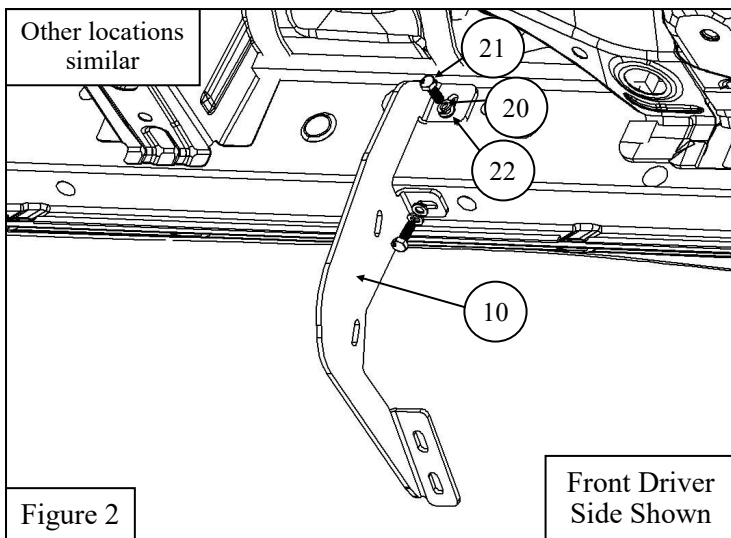
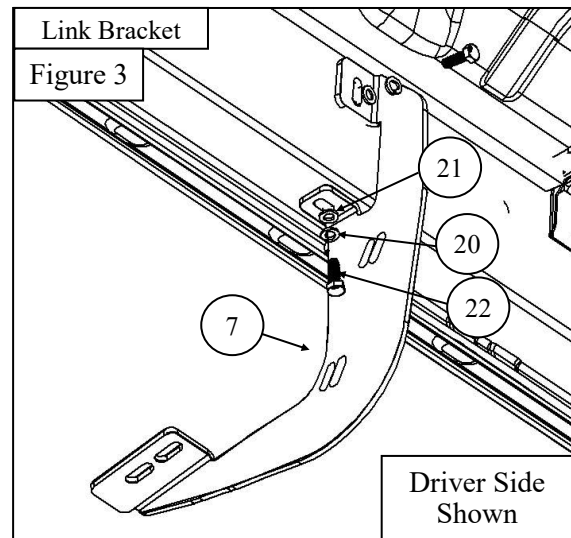
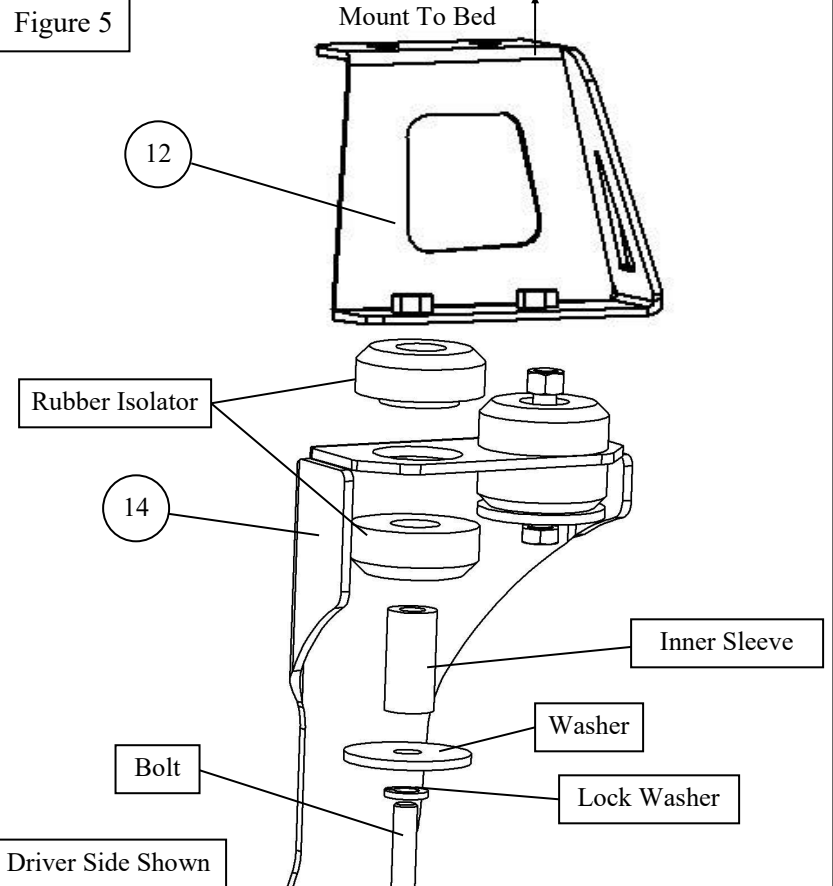
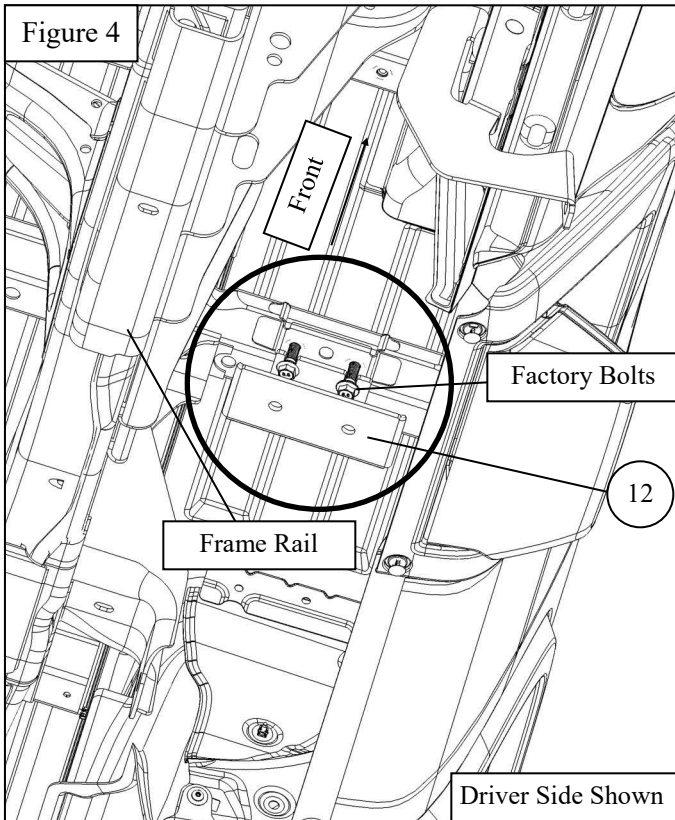

Figure 2



7. Attach the Bottom Isolator Bracket (14,15) to the Top Isolator Bracket (12,13) using the Isolator Kit (16) hardware. See **Figure 4-5**.



8. Under the front of the bed, there is two factory bolts as shown in **Figure 4**. Remove these bolts.
9. Using Preexisting factory bolts, mount the isolator bracket assembly (12) in between the bed and factory bed bracket. See **Figures 5-7**

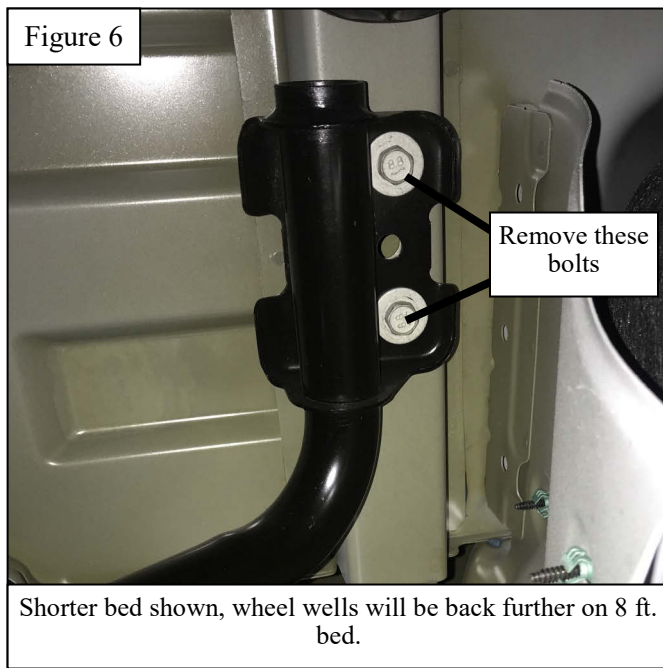

10. Obtain both sections of the Step Bar Assembly (1 or 2). Slide the Reinforcement Links (4 & 5) into both sides of the step bar sections. See **Figure 8**.

11. Line up the holes on the Step Bar sections with the holes on the Reinforcement Links (4 & 5). See **Figure 9**.

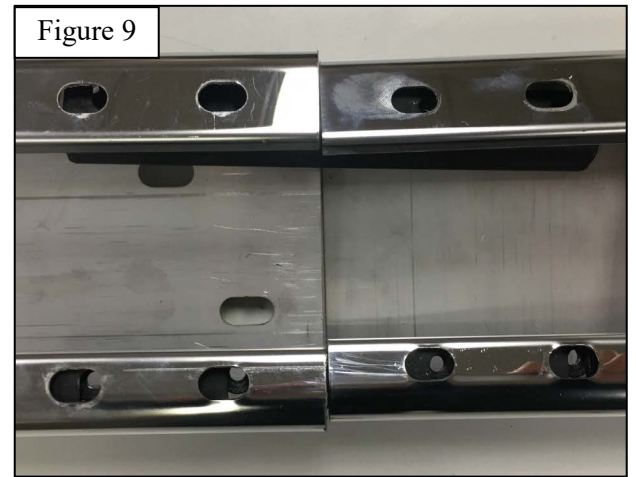

12. Place the supplied step pad into the holes to connect the two Step Bar sections (1 & 2). Place the supplied thread cutting nut on each of the plastic stems. Tighten until nut reaches metal and feels firm in place. See **Figures 10 and 11**.

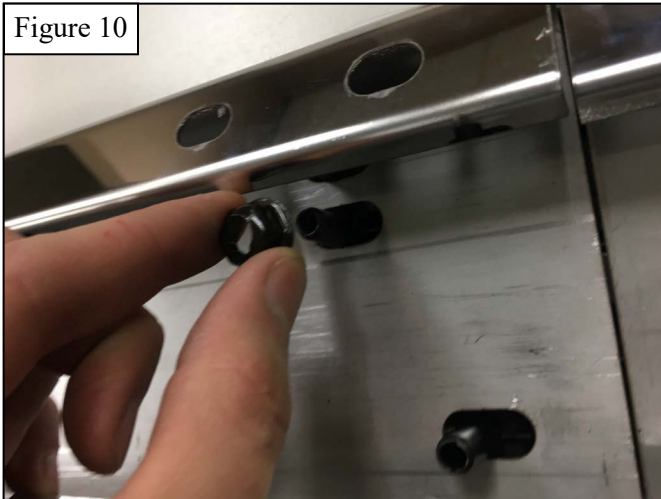

13. Obtain the Link Plate (6) and secure it to the Step Bar Assembly (1 & 2) using the supplied black M6 Hardware. See **Figure 12**.
14. After assembly, attach the loose center step pad by pressing down into the holes on the step

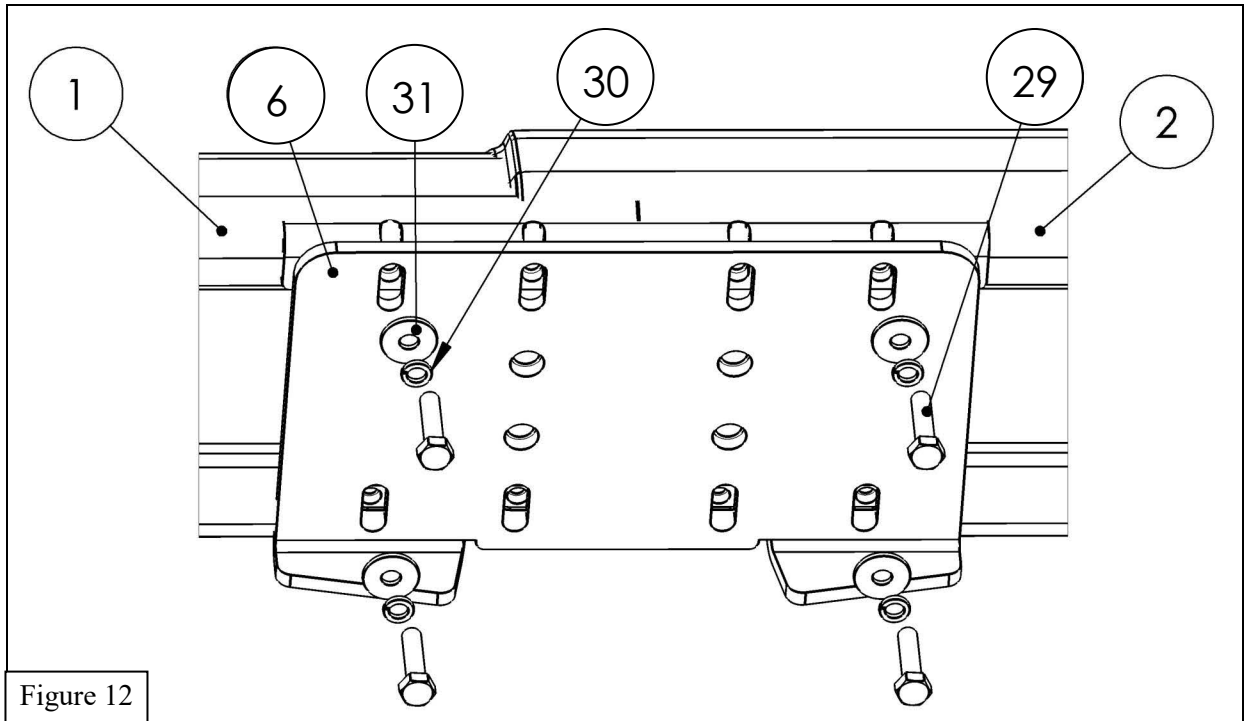

Figure 12

15. Secure the Plastic Bracket Covers (4) to the Mounting Brackets using the supplied M6 Hardware. See **Figure 4**.
16. Fasten step bars respectively to either side using the M8 hardware provided with the step bars. See **Figures 5 & 6**.
17. Align and adjust the step bars as needed and fully tighten all hardware. Torque all M6 fasteners to 7 ft-lbs and all M8 fasteners to 16 ft-lbs, M10 to 30 ft-lbs, and M12 to 55 ft-lbs.

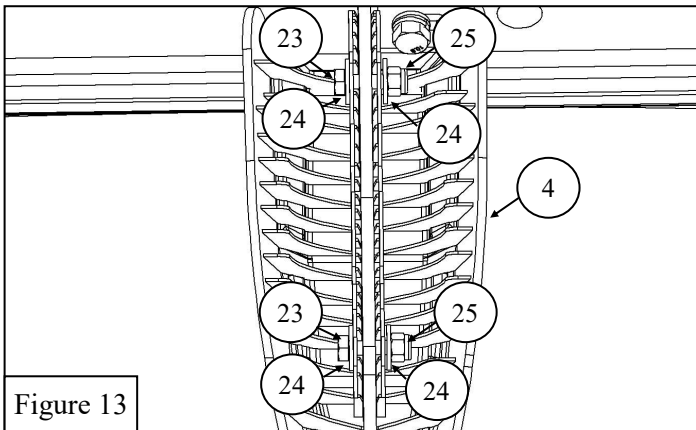
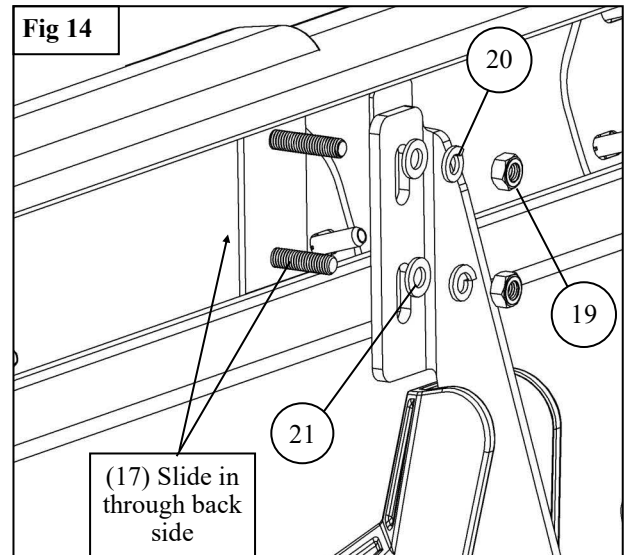
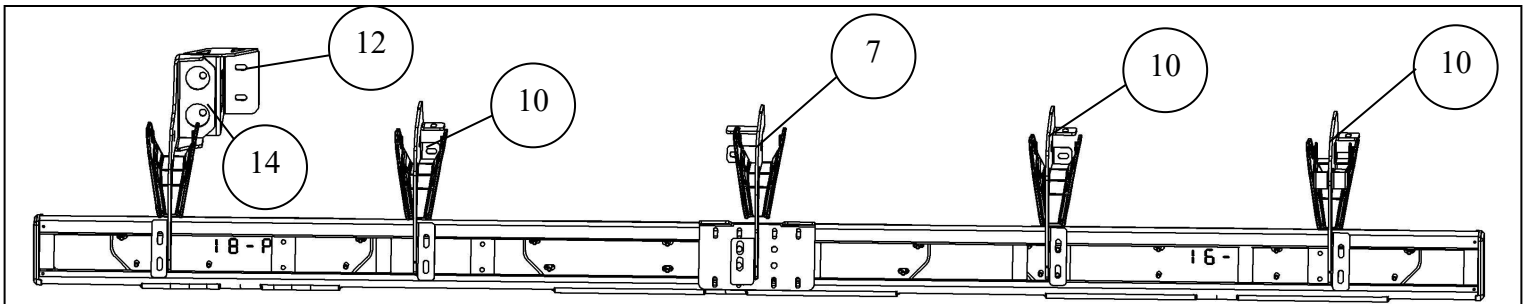
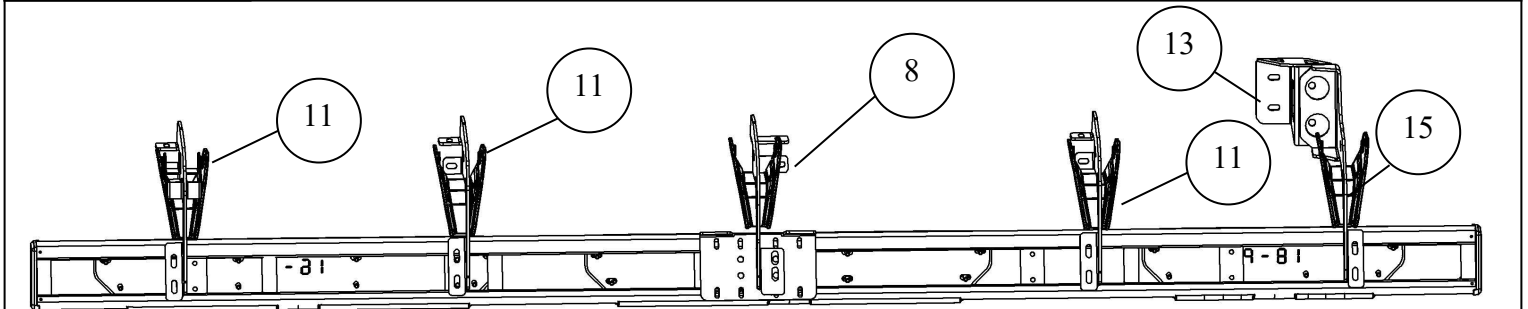

Figure 13





Driver Side Shown



Passenger Side Shown

INSTALLATION COMPLETE



CARE INSTRUCTIONS

- REGULAR WAXING IS RECOMMENDED. DO NOT USE ANY TYPE OF POLISH OR WAX THAT MAY CONTAIN ABRASIVES.
- STAINLESS STEEL PRODUCTS CAN BE CLEANED WITH MILD SOAP AND WATER. STAINLESS STEEL POLISH SHOULD BE USED TO POLISH SMALL SCRATCHES.
- GLOSS BLACK FINISHES SHOULD BE CLEANED WITH MILD SOAP AND WATER.

WESTIN Westin Automotive Products, Inc.
320 W. Covina Blvd
San Dimas, Ca. 91773

Thank you for choosing Westin products
for additional installation assistance please call
Customer Service (800) 793-7846
www.westinautomotive.com



WARNING



Failure to follow these instructions could lead to death, personal injury, and / or property damage.

Failure to follow these instructions could lead to death, personal injury, and / or property damage.

FASTENERS:

All Westin supplied fasteners must be utilized and installed in accordance with the installation instructions and apply torque to the specifications as defined. **DOUBLE CHECK ALL FASTENERS BEFORE INITIAL USE, AND PERIODICALLY IN THE FUTURE TO ENSURE PROPER FUNCTION AND SAFETY.**

DRILLING:

Most Westin products do not require drilling for installation. If drilling is defined as required, use caution when drilling a vehicle. **FAILURE TO REVIEW AN AREA TO BE DRILLED MAY RESULT IN PERSONAL INJURY AND/OR INJURY TO OTHERS AS WELL AS VEHICLE DAMAGE.**

EYE PROTECTION:

ALWAYS WEAR SAFETY GLASSES OR GOGGLES DURING THE INSTALLATION PROCESS TO AVOID PERSONAL INJURY.

MAXIMUM TOWING/CARRYING CAPACITY: (if applicable)

The Westin Receiver Hitches will have a visible tow rating label affixed directly on the product. User should never exceed the vehicle manufacturers maximum tow and weight rating regardless of the capacity of the hitch. **FAILURE TO FOLLOW THESE GUIDELINES WILL VOID THE WESTIN WARRANTY AND MAY RESULT IN PERSONAL INJURY AND/OR INJURY TO OTHERS AS WELL AS VEHICLE DAMAGE.**

FOR CALIFORNIA RESIDENTS ONLY-PROP 65 WARNING:

Some products may contain chemicals such as DEHP, which can cause cancer, birth defects or other reproductive harm. For more info go to www.p65warnings.ca.gov



Westin Automotive Products, Inc.
320 W. Covina Blvd
San Dimas, Ca. 91773