

INSTALLATION INSTRUCTIONS



CONTOUR LED BULL BAR

APPLICATION:

2016-2018 Chevrolet Silverado 1500

PART NUMBER:

32-31090-L, 32-31095T-L

ITEM	QUANTITY	DESCRIPTION	TOOLS NEEDED
1	1	CONTOUR BULL BAR ASSEMBLY	19MM WRENCH
2,3	2	SUPPORT STRAP, DRIVER (2) AND PASSENGER (3)	17MM WRENCH
4,5	2	MOUNTING BRACKET, DRIVER (4) AND PASSENGER (5)	17MM SOCKET
6,7	2	LOWER MOUNTING BRACKET, DRIVER (6) AND PASSENGER (7)	6MM HEX KEY
8	4	M12 BUTTON HEAD BOLT (BLACK ZINC)	8MM HEX KEY
9	8	M12 FLAT WASHER (BLACK ZINC)	UTILITY KNIFE
10	4	M12 SPLIT LOCK WASHER (BLACK ZINC)	RATCHET
11	4	M12 HEX NUT (BLACK ZINC)	TORQUE WRENCH
12	2	M10 BUTTON HEAD BOLT (BLACK ZINC)	
13	2	M10 SPLIT LOCK WASHER (BLACK ZINC)	
14	2	M10 FLAT WASHER (BLACK ZINC)	
15	2	M10 BUTTON HEAD BOLT (YELLOW ZINC)	
16	8	M10 FLAT WASHER (YELLOW ZINC)	
17	6	M10 SPLIT LOCK WASHER (YELLOW ZINC)	
18	2	M10 HEX NUT (YELLOW ZINC)	
19	1	ADHESIVE FOAM TAPE	
20	4	M10 HEX HEAD BOLT (YELLOW ZINC)	

ANTI-SEIZE LUBRICANT MUST BE USED ON ALL STAINLESS STEEL FASTENERS TO PREVENT THREAD DAMAGE AND GALLING

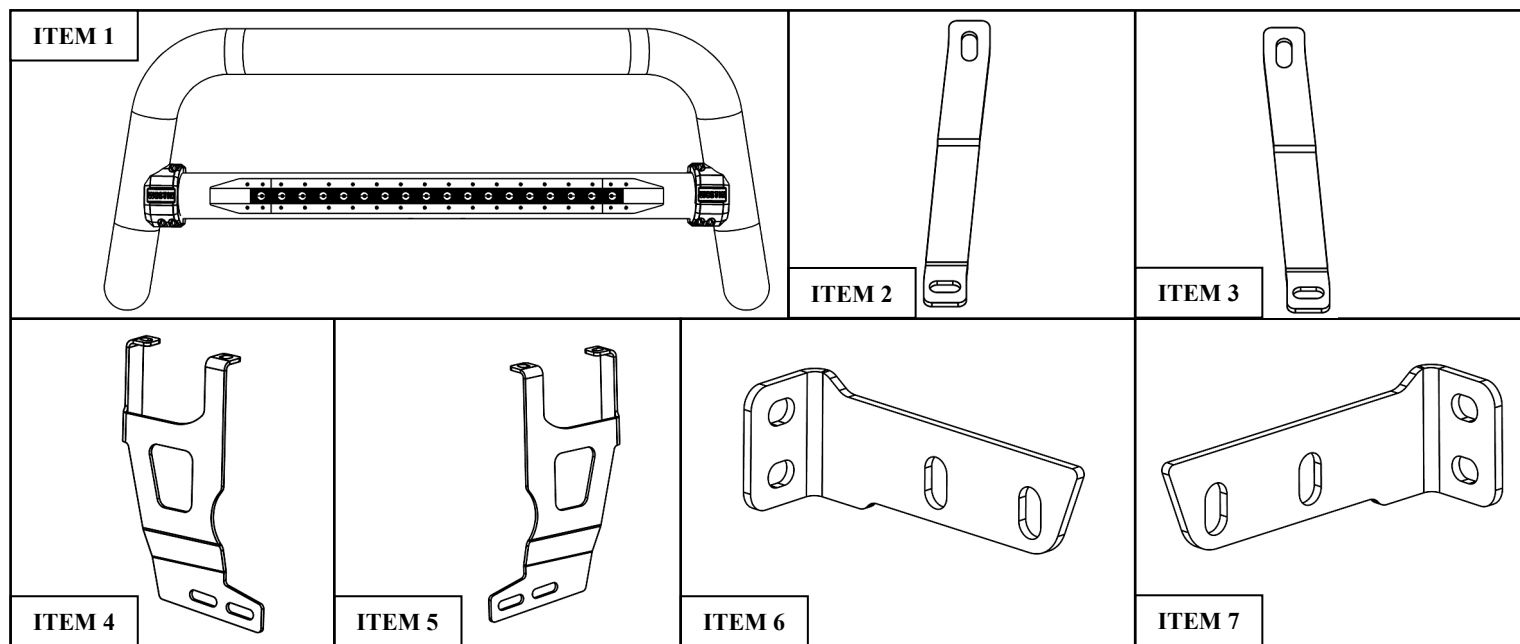

WESTIN Westin Automotive Products, Inc.
320 W. Covina Blvd
San Dimas, Ca. 91773

Thank you for choosing Westin products
for additional installation assistance please call
Customer Service (800) 793-7846
www.westinautomotive.com

PROCEDURE

1. Remove contents from box, verify if all parts listed are present and free from damage.
Carefully read and understand all instructions before attempting installation.
Failure to identify damage before installation could lead to a rejection of any claim.
2. Remove the radiator cover to reveal screws that attach the grille to the front of vehicle. See **Figure 1**.
3. Remove the screws that attach the grille to the front of vehicle. Carefully pull the grille off the vehicle. See **Figure 2**.

Pull up all fasteners and
remove plastic radiator cover.

Figure 1



Remove screws that attach
the grille to the vehicle.

Figure 2

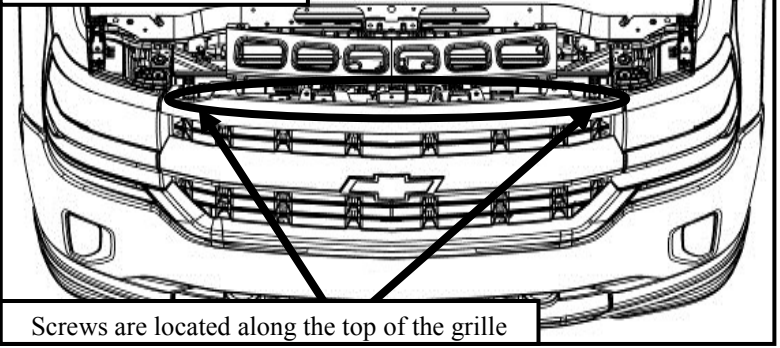

4. Remove the bumper support bar from each side of the vehicle by removing the bolts shown in **Figure 3**. **Note:** Driver's side shown. Bumper support bars will be reused.

Driver's Side Shown

Figure 3

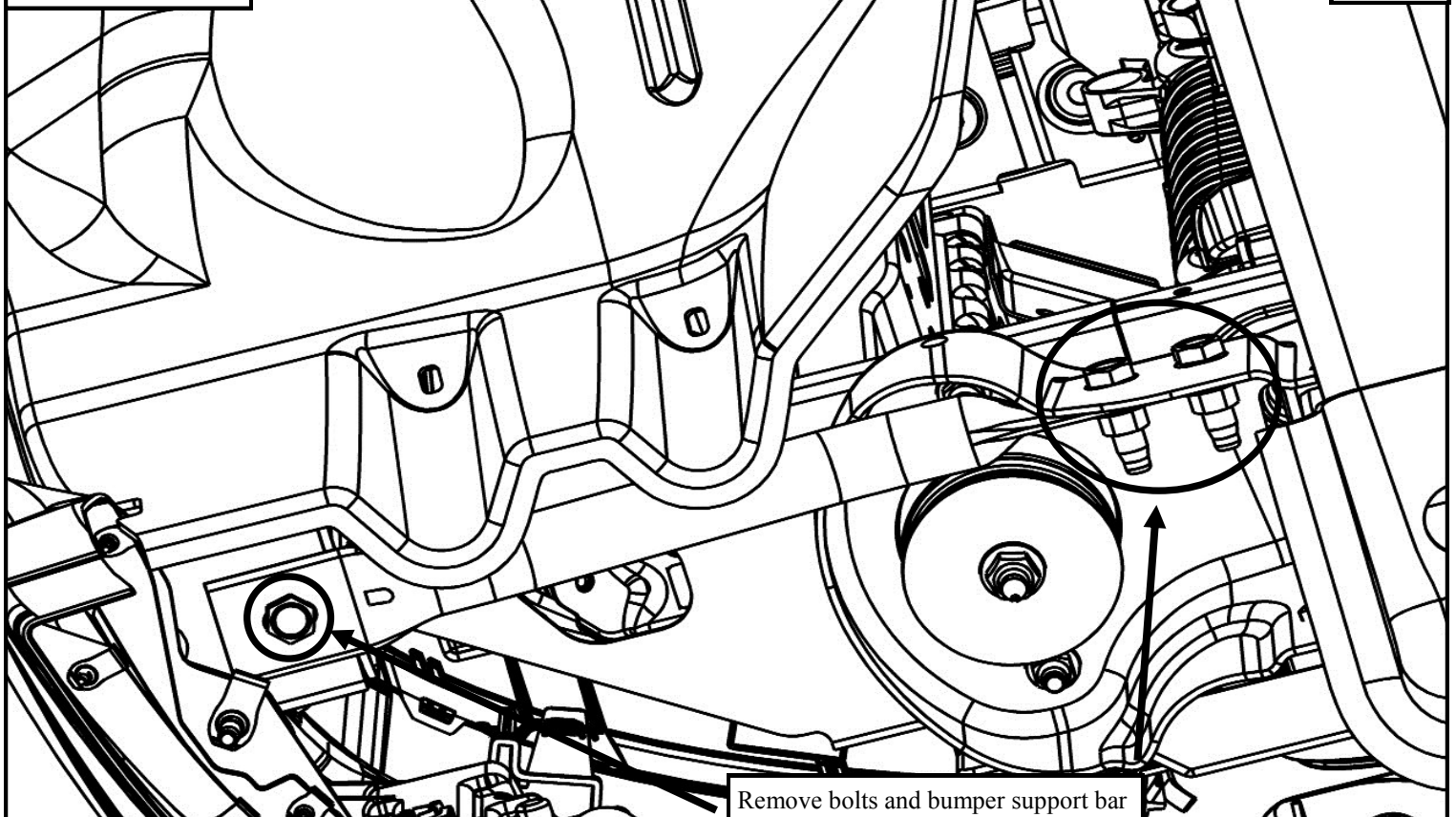

WESTIN

Westin Automotive Products, Inc.
320 W. Covina Blvd
San Dimas, Ca. 91773

Thank you for choosing Westin products
for additional installation assistance please call
Customer Service (800) 793-7846

www.westinautomotive.com

DATE: 1/02/17

5. Remove the factory nuts shown in **Figure 4** on each side of the vehicle. They can be found on front body mount near the location of the bumper support bars removed in **step 4**.
6. Loosely install the mounting brackets (4 & 5) using the factory hardware removed in **step 5** according to **Figure 5**. **Note:** Factory tow hooks can be retained but their use is impaired.

Figure 4

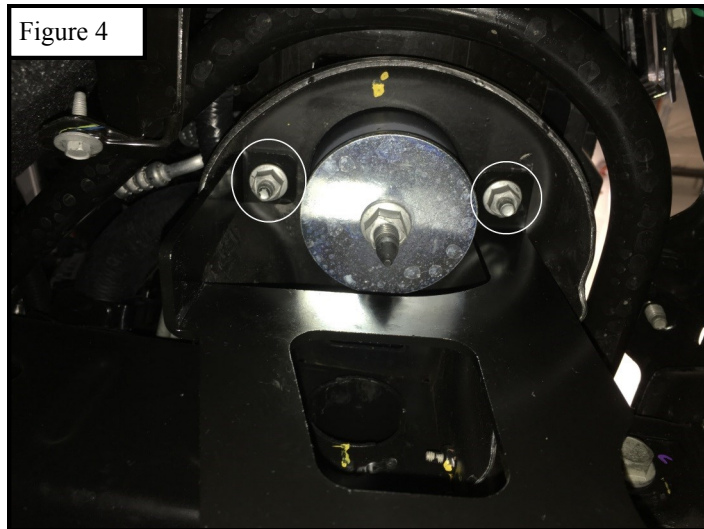

7. Trim the foam tape (19) and apply it to the back of the upper support brackets as shown in **Figure 6**.

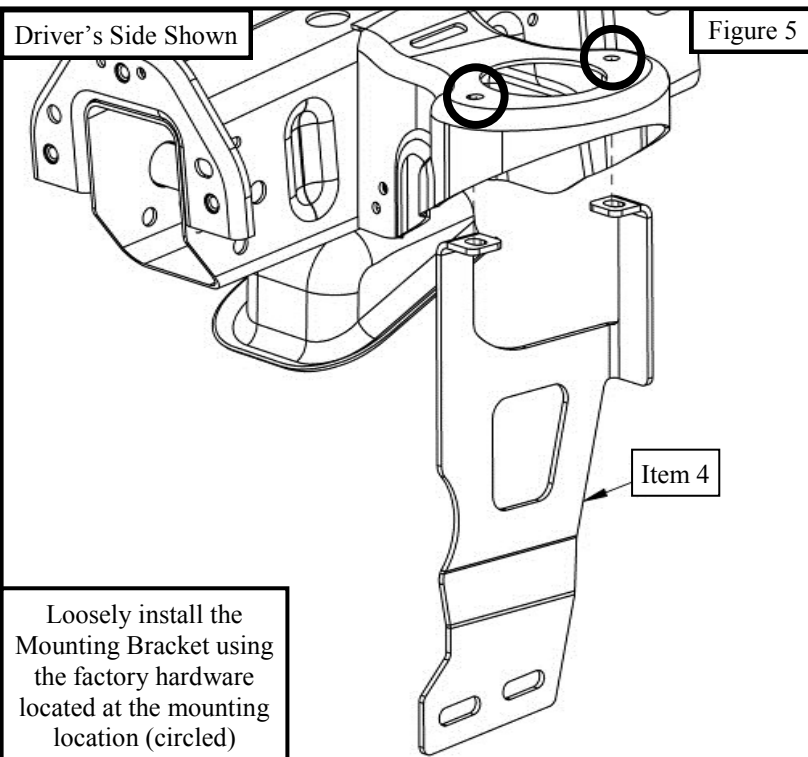
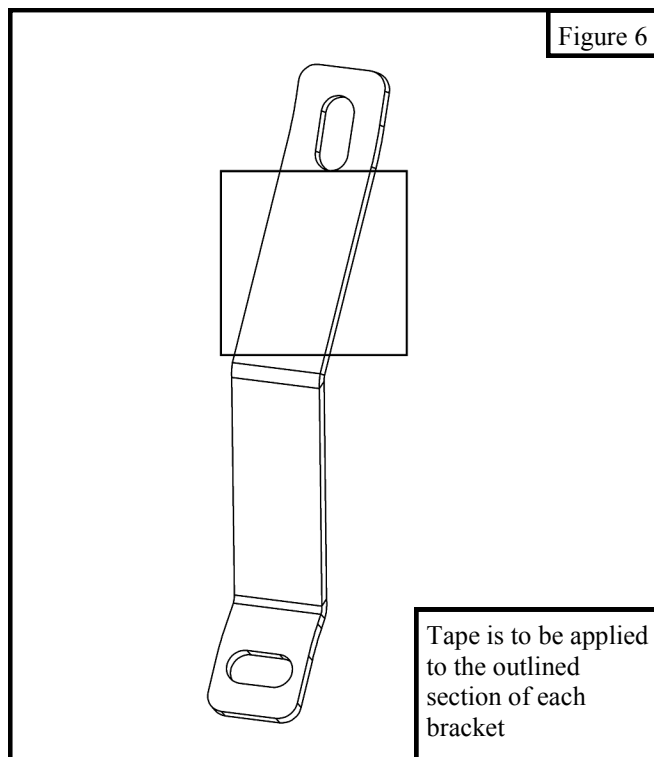
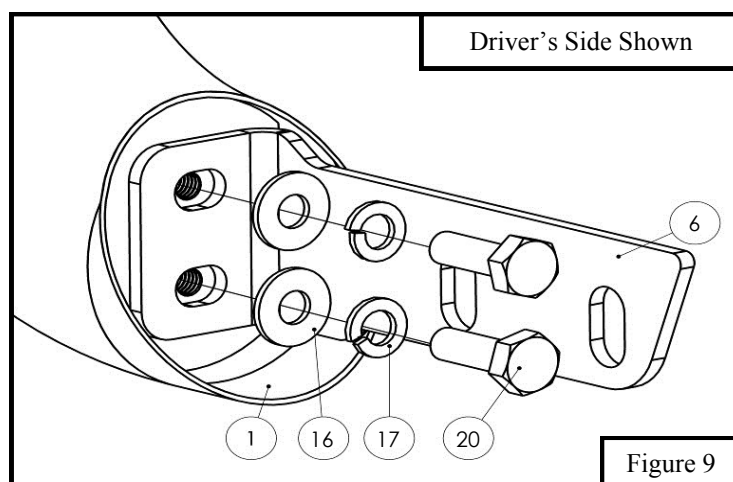
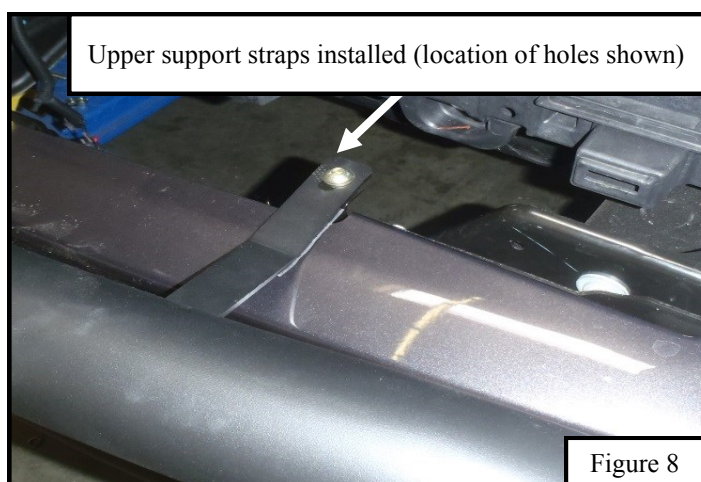
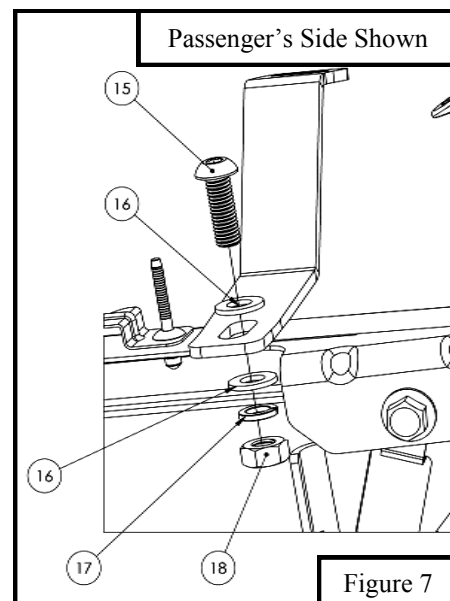

Figure 6



8. Loosely secure the upper support straps (2 & 3) to the existing holes near the top of the bumper. Install using supplied M10 hardware (15-18). See **Figures 7 & 8**.
9. Loosely install the lower mounting brackets (6 & 7) onto the bull bar using the supplied M10 hardware (16, 17, & 20) according to **Figure 9**.



10. Adjust the center tube of the contour bull bar assembly so that the light will point straight ahead by first loosening the bolts on the plastic bushings (3 bolts on each bushing). See **Figure 10**. Next, locate the rectangular openings behind the light and loosen the two bolts on each side. Rotate and align the light as needed and then tighten hardware. See **Figure 11**.

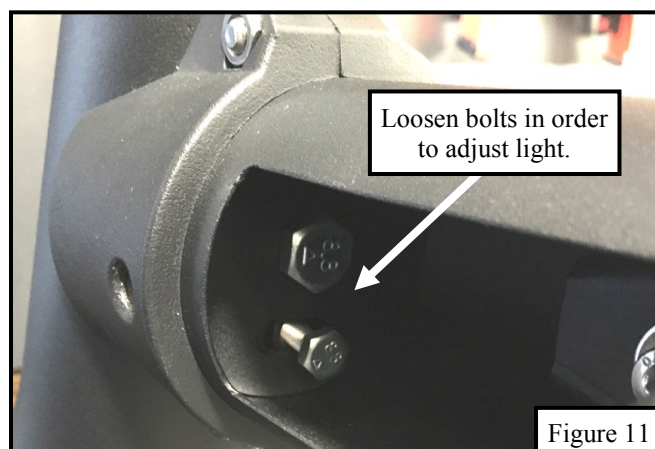
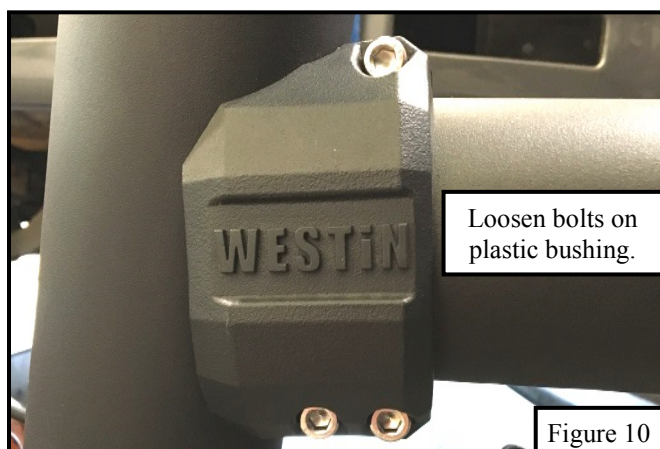

11. With assistance, loosely install the bull bar to the mounting brackets using the supplied M12 hardware (8-11) according to **Figure 12**.

12. Loosely attach the upper support straps to the bull bar using the supplied M10 hardware (12-14) according to **Figure 13**.

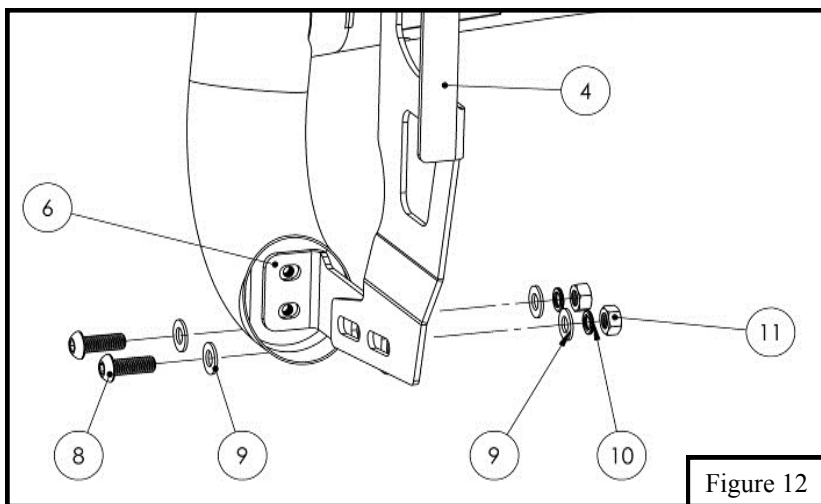

Figure 12

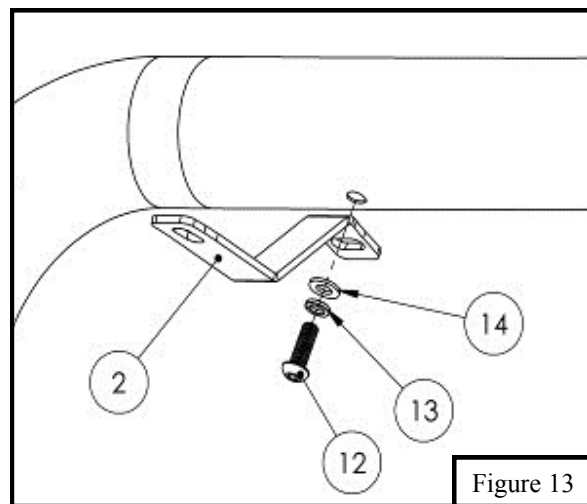

Figure 13

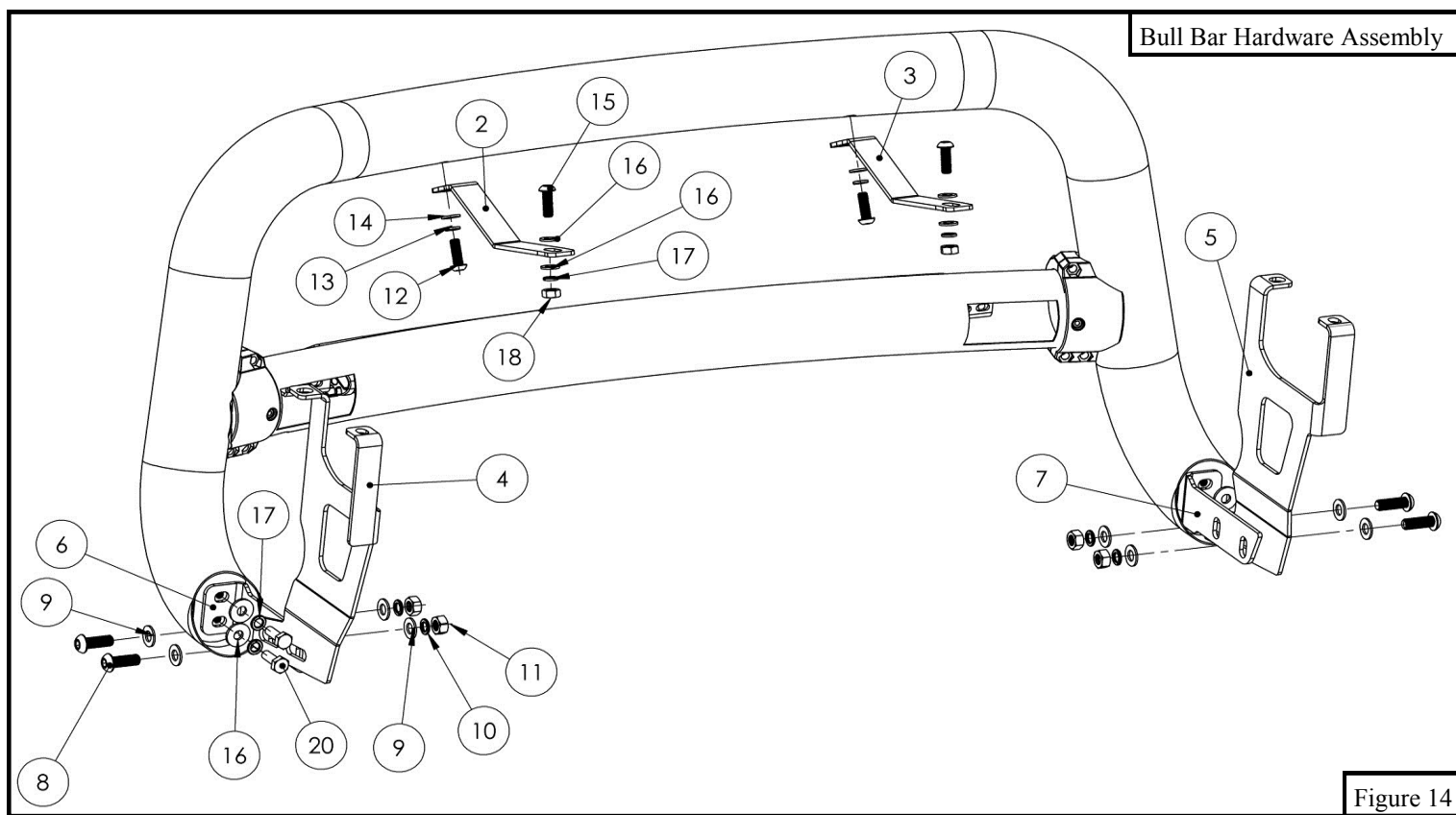

Figure 14

13. Align and adjust the bull bar as necessary then fully tighten all hardware. Torque all M10 hardware to 30-35 ft-lbs and M12 hardware to 50-55 ft-lbs.

14. Reinstall the bumper support bars using the original hardware.

INSTALLATION COMPLETE



CARE INSTRUCTIONS

- REGULAR WAXING IS RECOMMENDED. DO NOT USE ANY TYPE OF POLISH OR WAX THAT MAY CONTAIN ABRASIVES.
- STAINLESS STEEL PRODUCTS CAN BE CLEANED WITH MILD SOAP AND WATER. STAINLESS STEEL POLISH SHOULD BE USED TO POLISH SMALL SCRATCHES.
- GLOSS BLACK FINISHES SHOULD BE CLEANED WITH MILD SOAP AND WATER.

WESTIN Westin Automotive Products, Inc.
320 W. Covina Blvd
San Dimas, Ca. 91773

Thank you for choosing Westin products
for additional installation assistance please call
Customer Service (800) 793-7846
www.westinautomotive.com
DATE: 1/02/17

WIRING INSTRUCTIONS:

CAUTION:

1. Disconnect ground connection from battery (-) to avoid accidental short circuits before attempting to connect electrical wires.
2. When running wires, avoid areas of excessive heat, vibration, pinch or rotation when securing harness to vehicle.
3. Always use a fused (+) positive supply source.
4. This light becomes hot under continuous use. Do not remove or touch the casting for at least 30 minutes after the lamp has been turned off.

WESTIN recommends using a professional for this installation.

Refer to Figure 15 below.

1. Locate the wiring harness and mount the switch in a convenient location where it is easily accessible from the drivers seat. **Note:** *The switch will need to be removed from the wiring harness so that the rest of the harness can be routed from the engine bay to the cabin.*
2. Route the wiring harness wire, specifically the fuse and relay, from the positive battery terminal along the firewalls existing wire routes. **Note:** *Tape as necessary to correct slack.*
3. Secure the relay by either drilling or using a pre-existing bolt along the chassis that is not connected to any other wire.
4. Run the switch harness through the firewall preferably through the pre-existing rubber plug that is used to run the OEM wiring harness from the engine bay to fuse box. **Note:** *Reconnect the switch to the wiring harness.*
5. Place the LED plug wire along the fender chassis where it will not get pinched and away from any moving parts (fan, pulleys etc.).
6. Run the attached wire from the LED Light Bar as previously mentioned away from any moving parts.
7. Connect both ends of wiring connectors from LED light bar and wiring harness.
8. Re-connect battery terminals, attach the red (+) wire to battery positive, and the black (-) wire to ground. **Note:** *Add dielectric grease (not supplied).*
9. Turn on the switch to make sure if the light works. If not, please check carefully if the wiring installation is correct.

Figure 15

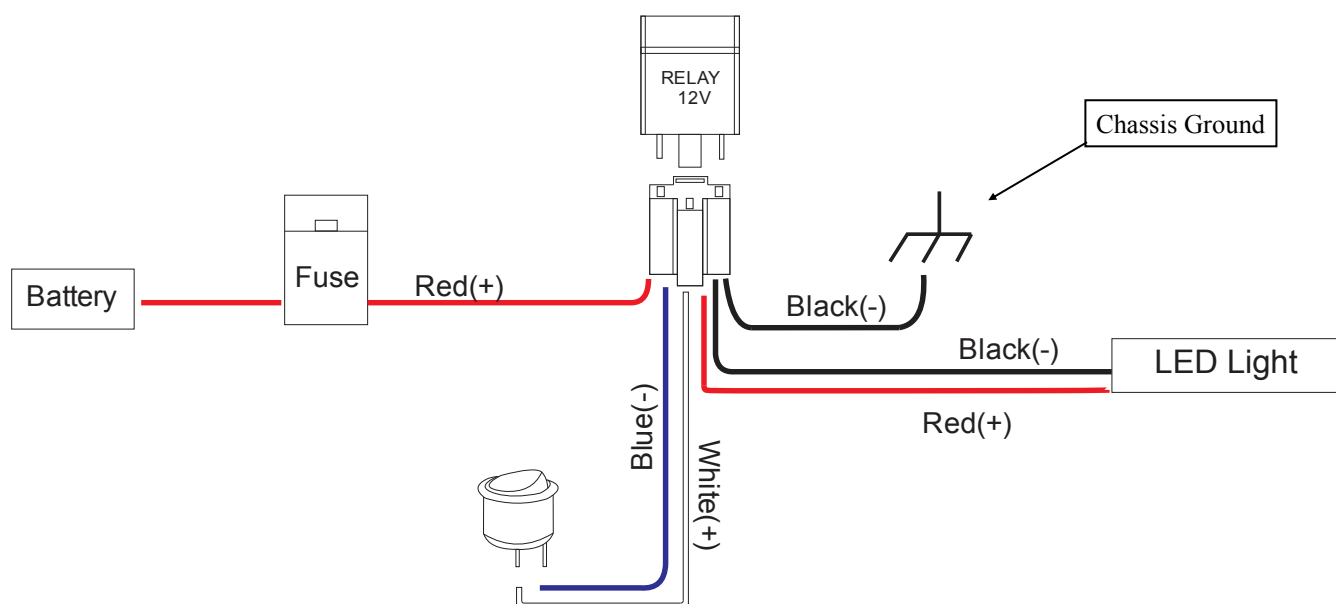

WESTIN

Westin Automotive Products, Inc.
320 W. Covina Blvd
San Dimas, Ca. 91773



WARNING



Failure to follow these instructions could lead to death, personal injury, and / or property damage.

FASTENERS:

All Westin supplied fasteners must be utilized and installed in accordance with the installation instructions and apply torque to the specifications as defined. **DOUBLE CHECK ALL FASTENERS BEFORE INITIAL USE, AND PERIODICALLY IN THE FUTURE TO ENSURE PROPER FUNCTION AND SAFETY.**

DRILLING:

Most Westin products do not require drilling for installation. If drilling is defined as required, use caution when drilling a vehicle. **FAILURE TO REVIEW AN AREA TO BE DRILLED MAY RESULT IN PERSONAL INJURY AND/OR INJURY TO OTHERS AS WELL AS VEHICLE DAMAGE.**

EYE PROTECTION:

ALWAYS WEAR SAFETY GLASSES OR GOGGLES DURING THE INSTALLATION PROCESS TO AVOID PERSONAL INJURY.

MAXIMUM TOWING/CARRYING CAPACITY:

The Westin Receiver Hitches will have a visible tow rating label affixed directly on the product. User should never exceed the vehicle manufacturers maximum tow and weight rating regardless of the capacity of the hitch. **FAILURE TO FOLLOW THESE GUIDELINES WILL VOID THE WESTIN WARRANTY AND MAY RESULT IN PERSONAL INJURY AND/OR INJURY TO OTHERS AS WELL AS VEHICLE DAMAGE.**