



INSTALLATION INSTRUCTIONS

MAX WINCH TRAY, WINCH MOUNT GRILLE GUARD

APPLICATION:
2019-2020 Ford Ranger
PART NUMBER:
46-23985, 57-93985

ITEM	QUANTITY	DESCRIPTION	TOOLS NEEDED
1	1	MAX WINCH TRAY	13MM SOCKET
2	1	LOWER DRIVER MOUNTING BRACKET	15MM SOCKET
3	1	LOWER PASSENGER MOUNTING BRACKET	18MM SOCKET
4	1	LOWER SUPPORT BRACKET	19MM SOCKET
5	1	LOWER SUPPORT BRACKET	21MM SOCKET
6	4	M12 HEX HEAD CAP SCREW (YELLOW ZINC)	13MM WRENCH
7	8	M12 SPLIT LOCK WASHER (YELLOW ZINC)	15MM WRENCH
8	8	M12 FLAT WASHER (YELLOW ZINC)	18MM WRENCH
9	4	M12 HEX NUT (YELLOW ZINC)	19MM WRENCH
10	6	M12 HEX HEAD CAP SCREW (BLACK ZINC)	21MM WRENCH
11	6	M12 SPLIT LOCK WASHER (BLACK ZINC)	TORQUE WRENCH
12	12	M12 FLAT WASHER (BLACK ZINC)	PRY TOOL
13	6	M12 HEX NUT (BLACK ZINC)	ALLEN KEY SET
14	4	M12 RETAINER	RATCHET
15	4	M12 FISH WIRE	
16	4	M12 BOLT PLATE	
17	2	M12 NUT PLATE	
18	1	WINCH MOUNT HDX GRILL GUARD	
19	2	UPPER SUPPORT STRAP GRILLE GUARD DRIVER AND PASSENGER	
20	2	M10 BUTTON HEAD BOLT (BLACK ZINC)	
21	2	M10 CUP WASHER (BLACK ZINC)	
22	2	M10 SERRATED FLANGE NUT (BLACK ZINC)	
23	6	M12 BUTTON HEAD BOLT (BLACK ZINC)	
24	6	M12 CUP WASHER (BLACK ZINC)	
25	6	M12 SERRATED FLANGE NUT (BLACK ZINC)	

ANTI-SEIZE LUBRICANT MUST BE USED ON ALL STAINLESS STEEL FASTENERS TO PREVENT THREAD DAMAGE AND GALLING

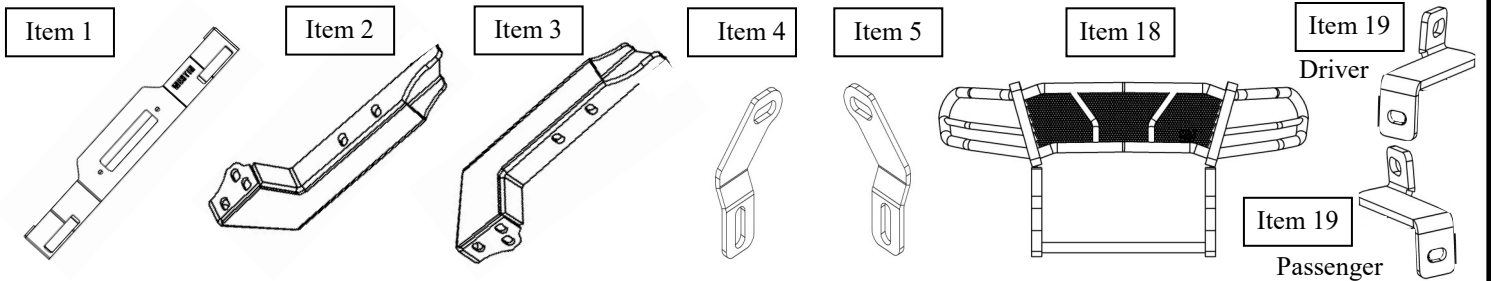

WESTIN Westin Automotive Products, Inc.
320 W. Covina Blvd
San Dimas, Ca. 91773

Thank you for choosing Westin products
for additional installation assistance please call
Customer Service (800) 793-7846

PROCEDURE

1. Remove contents from box, verify if all parts listed are present and free from damage.
Carefully read and understand all instructions before attempting installation.
Failure to identify damage before installation could lead to a rejection of any claim.

IF INSTALLING WINCH TRAY ONLY SKIP TO PAGE 5

IF INSTALLING WINCH MOUNT GRILLE GUARD WITH THE WINCH TRAY CONTINUE HERE ON PAGE 2

2. Remove the five lower clips found under the front end of the bumper. See Fig. 1
3. Carefully remove the front bumper cover by pulling from the bottom up. See Fig. 2

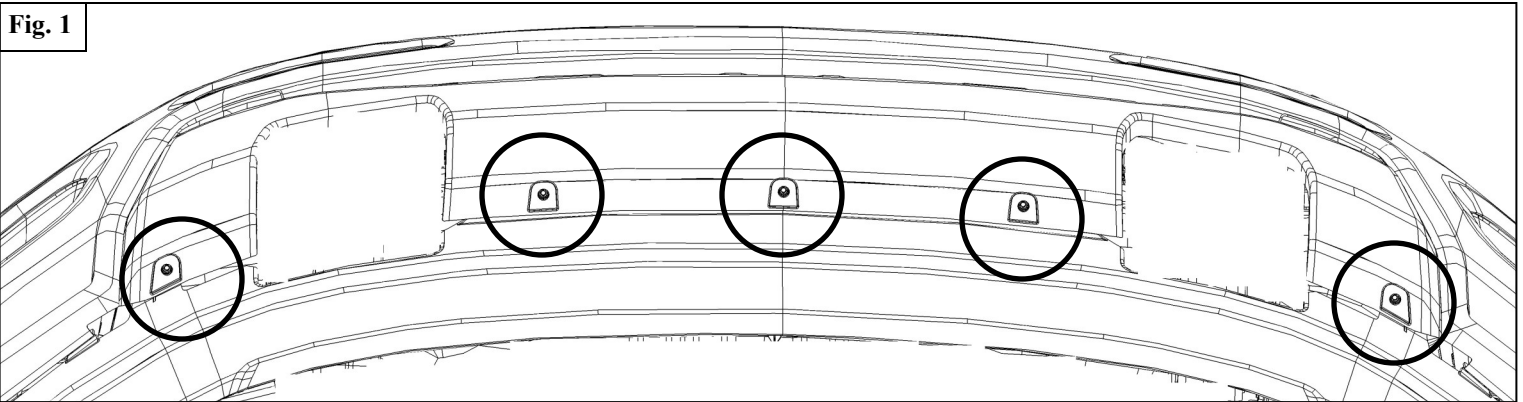

WESTIN

Westin Automotive Products, Inc.
320 W. Covina Blvd
San Dimas, Ca. 91773

4. With the now exposed bumper plate, unbolt the bumper. See Fig. 3
5. Unplug any connections to the bumper. See Fig. 4
6. Remove the bumper.

Fig. 3

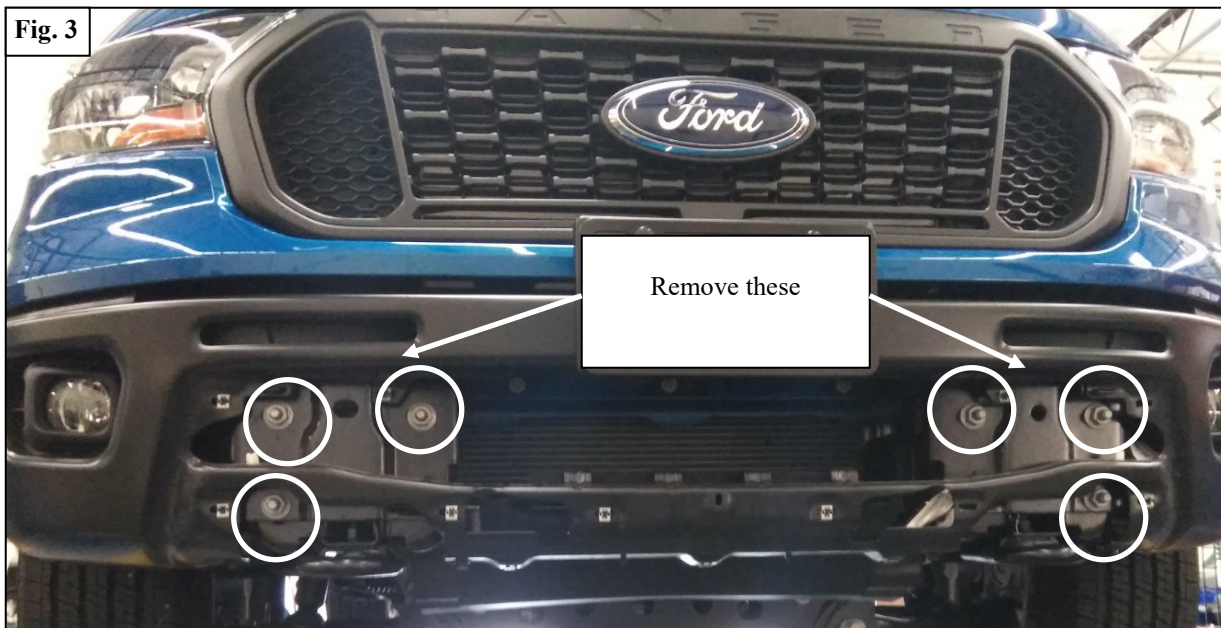
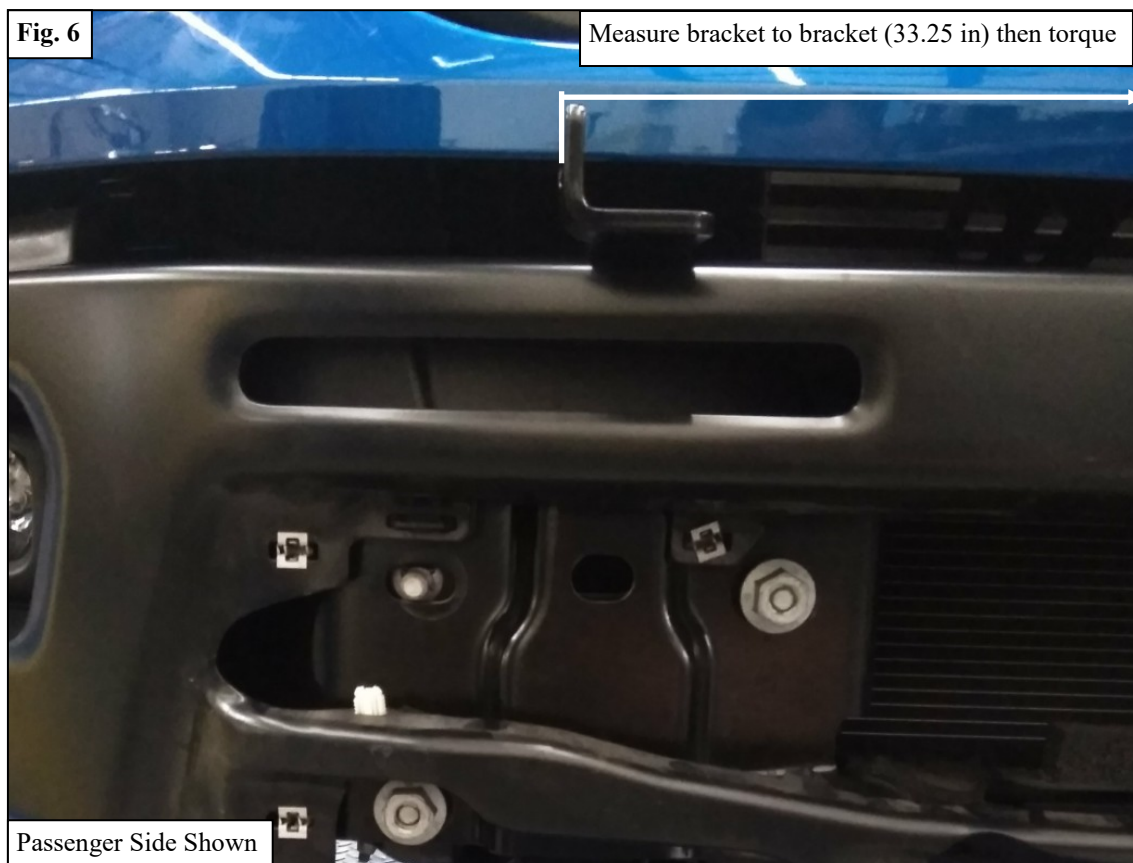
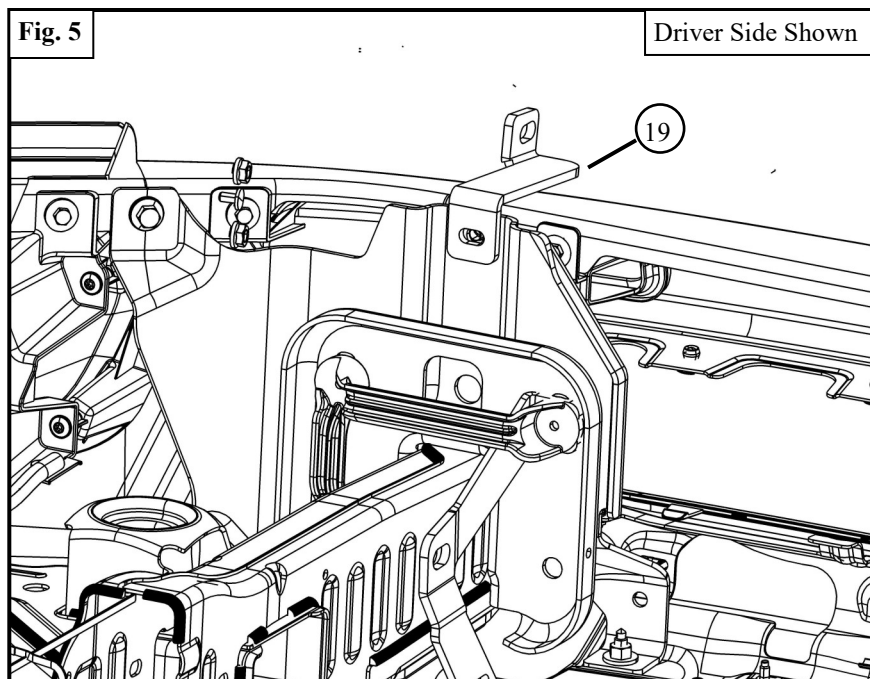

Fig. 4



7. Remove factory bolt and install upper support strap with previously removed factory bolt. See **Fig. 5**
A. Measure the distance between the upper brackets. Make sure it is 33 1/4 inches. See **Fig. 6**
B. Torque the factory bolts to 16 ft lbs.
C. **Re-install the factory bumper and the bumper cover in the reverse order that was previously instructed.**



WESTIN

Westin Automotive Products, Inc.
320 W. Covina Blvd
San Dimas, Ca. 91773

WINCH TRAY INSTALLATION BEGINS HERE ON PAGE 5 AND ENDS ON PAGE 7

8. If tow hooks are equipped, remove the tow hooks. *Note: Factory Tow hooks will not be reused.* See **Fig. 7**. If tow hooks are not equipped use a cutting tool to cut out the plastic where the tow hook opening would be.

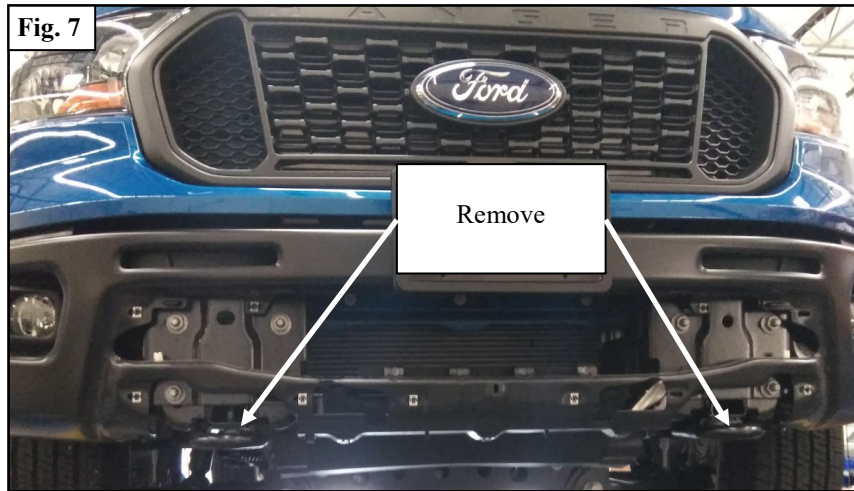

9. Once tow hooks are removed, cut the lower valence so that the lower mount bracket can slide through. *Note: for vehicles without tow hooks, the tow hook pocket area and the valence will have to be cut.* See **Fig. 8**

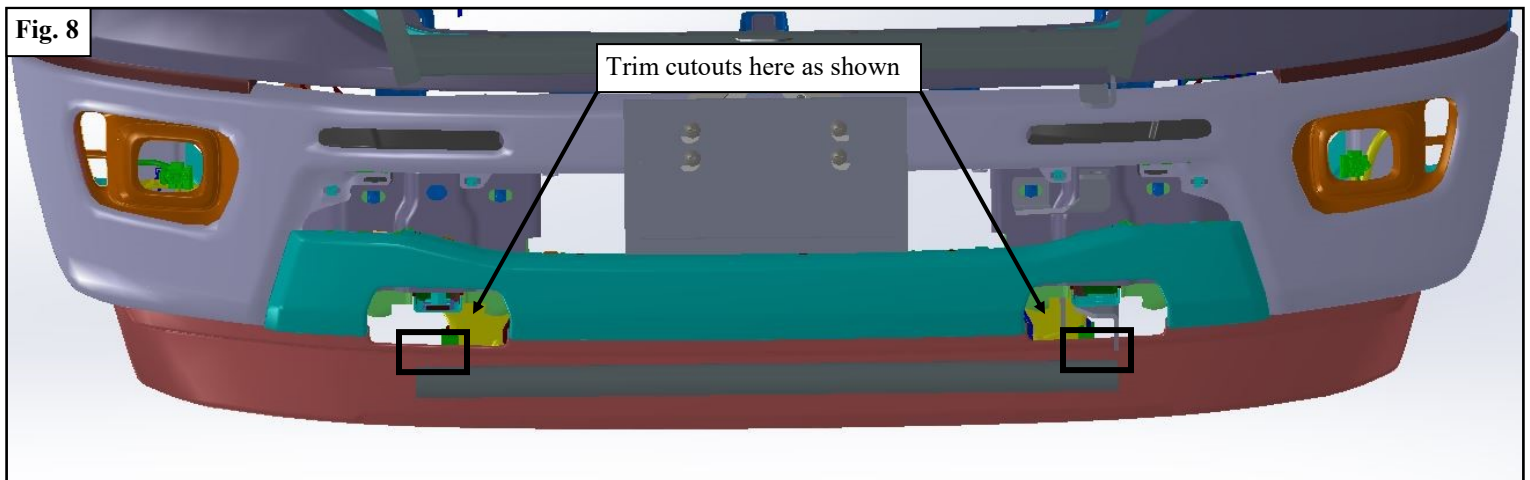

10. Slide double nut plate through frame and align with the two holes on the bottom of the frame. See **Fig. 9**
11. Once the double nut plate is aligned with the holes loosely mount the lower mount bracket with the supplied M12 hardware. See **Fig. 10**

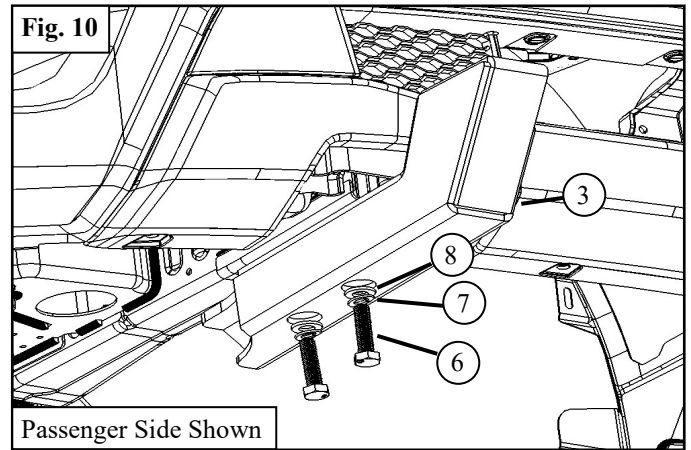
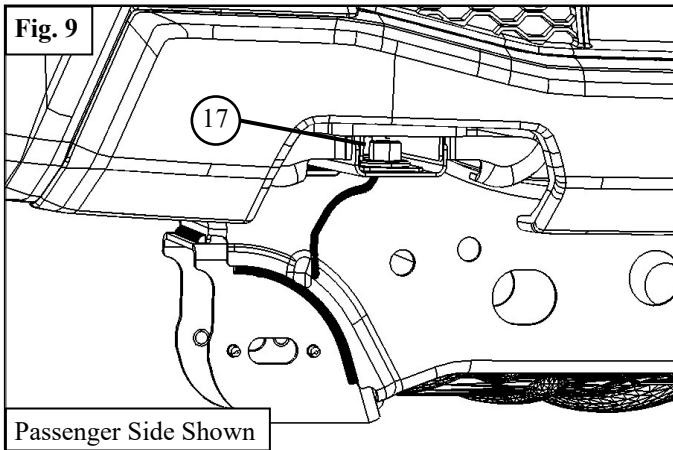

12. Once the lower mount bracket is loosely mounted grab a M12 bolt plate and a M12 fish wire. Feed the fish wire through the hole in the frame with the threaded wire going in first. Once the fish wire is out on the open end of the frame, thread the M12 bolt plate to the M12 fish wire. Once sufficiently threaded pull the bolt plate through the hole in the frame. See **Fig. 11**
13. Once the bolt plate is through the hole, thread a retainer clip on the bolt plate so it doesn't fall into the frame. See **Fig. 12**
14. Repeat steps 12 and 13 similarly for the bolt plate that goes though the lower mount bracket. See **Fig. 12**

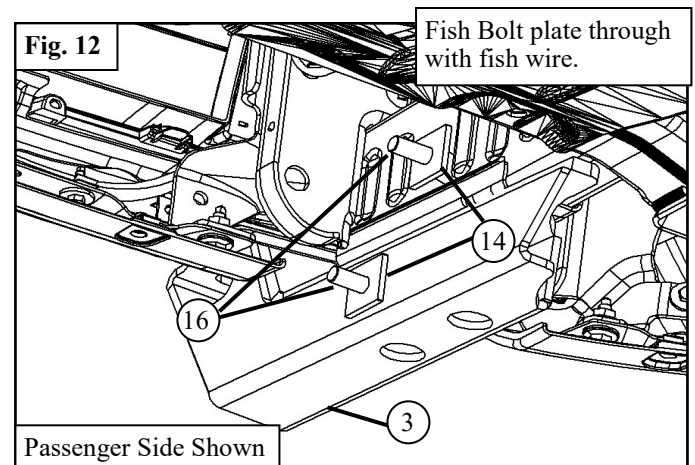
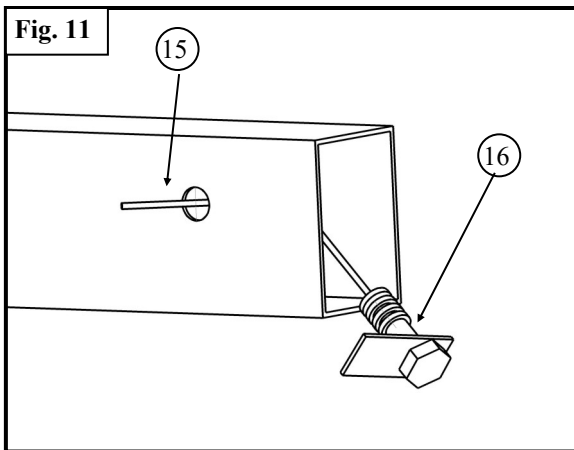

15. Grab the lower support bracket and loosely mount to the lower mount bracket using the supplied M12 hardware. See **Fig. 13**
16. Set the Winch Tray (1) on top of the lower mount brackets.
17. Loosely install the Winch Tray using the supplied black M12 Hardware. See **Fig. 14**.
18. Adjust the Winch Tray and torque down all hardware to specified ft-lbs: M12 to 60 ft-lbs.

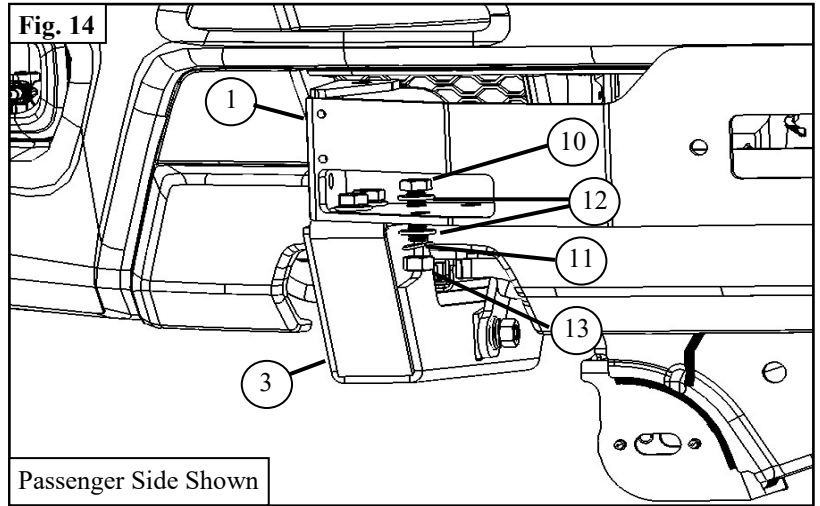
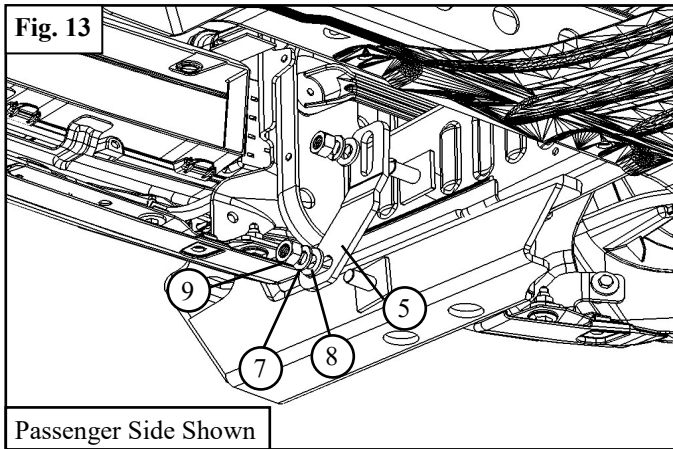

WINCH TRAY INSTALLATION END

WESTIN

Westin Automotive Products, Inc.
320 W. Covina Blvd
San Dimas, Ca. 91773

19. Loosely mount the grille guard to the previously installed winch tray and upper support bracket using supplied M10 and M12 hardware. See Fig. 15 & 16.
20. Adjust grille guard and torque down all bolts as specified: M8 to 16 ft lbs, M10 to 30 ft lbs, M12 to 55 ft lbs.

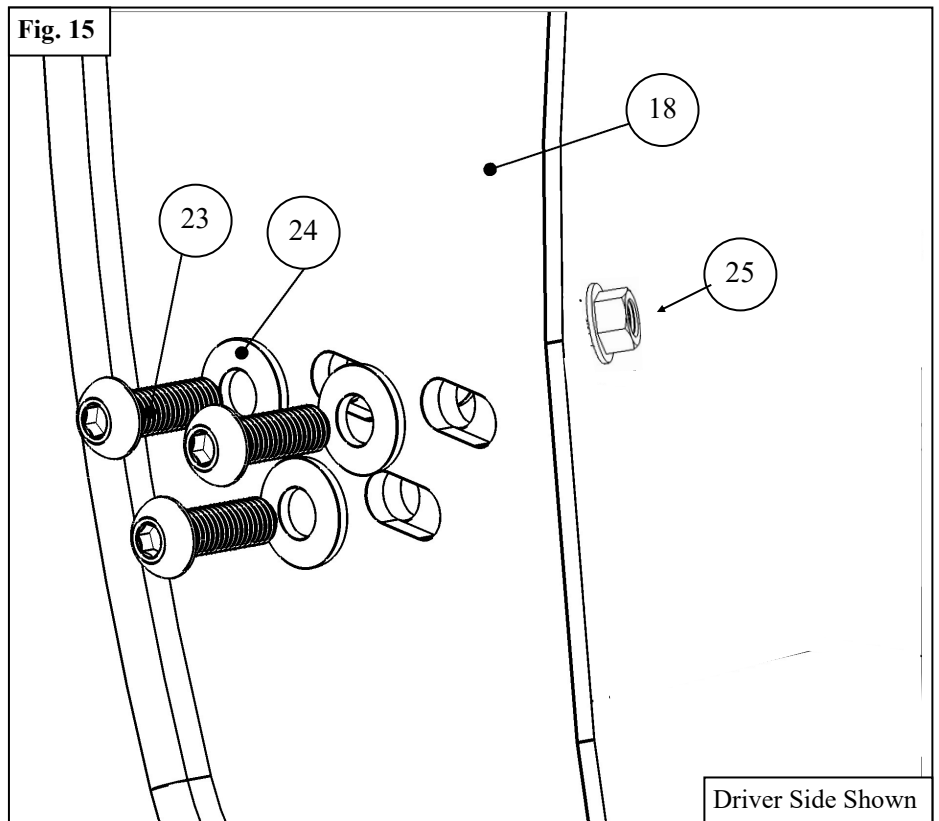
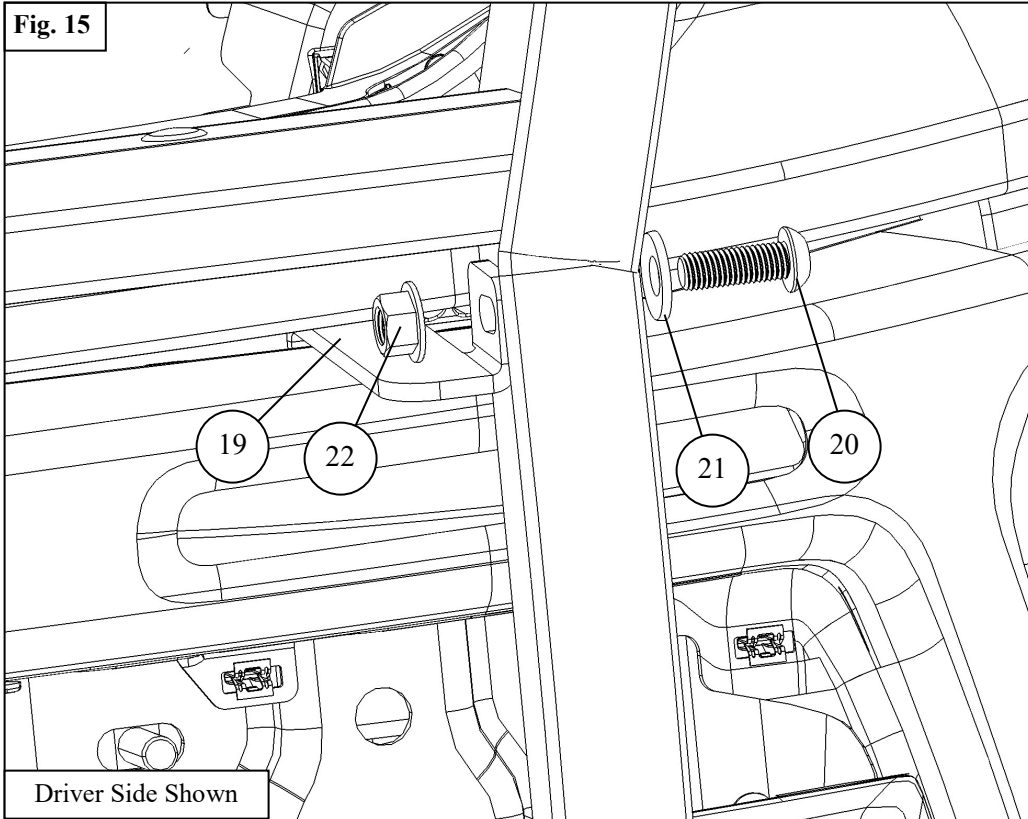

INSTALLATION COMPLETE



Winch and tow hooks sold separately.

CARE INSTRUCTIONS

- REGULAR WAXING IS RECOMMENDED. DO NOT USE ANY TYPE OF POLISH OR WAX THAT MAY CONTAIN ABRASIVES.
- STAINLESS STEEL PRODUCTS CAN BE CLEANED WITH MILD SOAP AND WATER. STAINLESS STEEL POLISH SHOULD BE USED TO POLISH SMALL SCRATCHES.
- GLOSS BLACK FINISHES SHOULD BE CLEANED WITH MILD SOAP AND WATER.

WESTIN

Westin Automotive Products, Inc.
320 W. Covina Blvd
San Dimas, Ca. 91773

Thank you for choosing Westin products
for additional installation assistance please call
Customer Service (800) 793-7846
www.westinautomotive.com



WARNING



Failure to follow these instructions could lead to death, personal injury, and / or property damage.

Failure to follow these instructions could lead to death, personal injury, and / or property damage.

FASTENERS:

All Westin supplied fasteners must be utilized and installed in accordance with the installation instructions and apply torque to the specifications as defined. **DOUBLE CHECK ALL FASTENERS BEFORE INITIAL USE, AND PERIODICALLY IN THE FUTURE TO ENSURE PROPER FUNCTION AND SAFETY.**

DRILLING:

Most Westin products do not require drilling for installation. If drilling is defined as required, use caution when drilling a vehicle. **FAILURE TO REVIEW AN AREA TO BE DRILLED MAY RESULT IN PERSONAL INJURY AND/OR INJURY TO OTHERS AS WELL AS VEHICLE DAMAGE.**

EYE PROTECTION:

ALWAYS WEAR SAFETY GLASSES OR GOGGLES DURING THE INSTALLATION PROCESS TO AVOID PERSONAL INJURY.

MAXIMUM TOWING/CARRYING CAPACITY: (if applicable)

The Westin Receiver Hitches will have a visible tow rating label affixed directly on the product. User should never exceed the vehicle manufacturers maximum tow and weight rating regardless of the capacity of the hitch. **FAILURE TO FOLLOW THESE GUIDELINES WILL VOID THE WESTIN WARRANTY AND MAY RESULT IN PERSONAL INJURY AND/OR INJURY TO OTHERS AS WELL AS VEHICLE DAMAGE.**

FOR CALIFORNIA RESIDENTS ONLY-PROP 65 WARNING:

Some products may contain chemicals such as DEHP, which can cause cancer, birth defects or other reproductive harm. For more info go to www.p65warnings.ca.gov



Westin Automotive Products, Inc.
320 W. Covina Blvd
San Dimas, Ca. 91773