



# INSTALLATION INSTRUCTIONS

## HDX MODULAR GRILLE GUARD

### APPLICATION:

2015-2022 Ford Transit 150/250/350 (W/O Front Sensor)

### PART NUMBER:

57-24055

<b>CONTENT</b>			
<b>ITEM</b>	<b>QUANTITY</b>	<b>DESCRIPTION</b>	<b>TOOLS NEEDED</b>
1	1	GRILLE GUARD BASE	13MM SOCKET
2	1	GRILLE GUARD DRIVER WING	13MM WRENCH
3	1	GRILLE GUARD PASSENGER WING	15MM SOCKET
4	1	DRIVER LOWER MOUNTING BRACKET	15MM WRENCH
5	1	PASSENGER LOWER MOUNTING BRACKET	18MM SOCKET
6	2	SPACER	18MM WRENCH
7	1	DRIVER UPPER SUPPORT BRACKET	RATCHET
8	1	PASSENGER UPPER SUPPORT BRACKET	TORQUE WRENCH
9	1	DRIVER LOWER SUPPORT BRACKET	2" HOLE SAW
10	1	PASSENGER LOWER SUPPORT BRACKET	PRY TOOL
11	2	M10 BUTTON HEAD BOLT	ALLEN WRENCH
12	2	M10 BELLVILLE WASHER	
13	2	M10 SERRATED FLANGE NUT (GLOSS FINISH)	
14	4	M12 BELLVILLE WASHER	
15	4	M12 BUTTON HEAD BOLT	
16	4	M12 SERRATED FLANGE NUT	
17	2	LONG M12 HEX HEAD BOLT	
18	2	SHORT M12 HEX HEAD BOLT	
19	8	M12 FLAT WASHER	
20	4	M12 SPLIT LOCK WASHER	
21	4	M12 HEX NUT	
22	6	M10 SERRATED FLANGE NUT (DULL FINISH)	
23	4	M10 SERRATED FLANGE BOLT	
24	10	M8 HEX SOCKET BUTTON HEAD BOLT	
25	10	M8 SERRATED FLANGE HEX NUT	
26	10	M8 BELLVILLE WASHER	

**ANTI-SEIZE LUBRICANT MUST BE USED ON ALL STAINLESS STEEL FASTENERS TO PREVENT THREAD DAMAGE AND GALLING**



Westin Automotive Products, Inc.  
320 W. Covina Blvd  
San Dimas, Ca. 91773

Thank you for choosing Westin products  
for additional installation assistance please call  
Customer Service (800) 793-7846  
www.westinautomotive.com

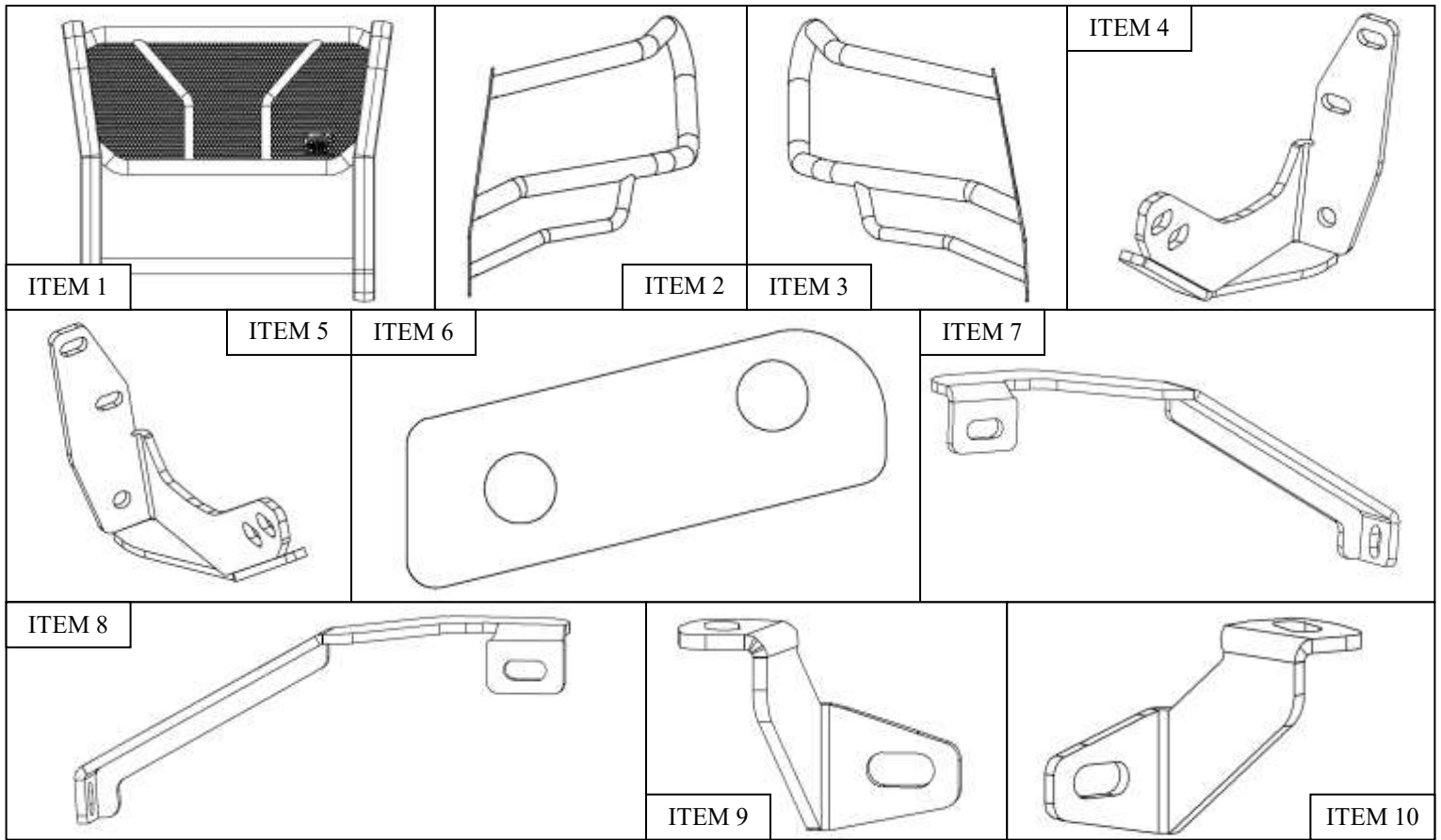

### PROCEDURE

1. Remove contents from box, verify if all parts listed are present and free from damage. Carefully read and understand all instructions before attempting installation. **Failure to identify damage before installation could lead to a rejection of any claim.**
2. Start by removing two factory clips in order to remove the front fender trim pieces shown. Repeat for both sides. See **Figure 1** for reference.
3. Remove the single bolt on each side inside the fender well. See **Figure 2** for reference



- Remove the headlights on both sides by removing the two bolts shown in **Figure 3**. Unplug the headlights and tilt the headlights back and forth gently to release the plastic clip at the bottom of the headlights in order to remove them.
- Unclip the bumper retaining clip at the bottom of the headlight bezel. Repeat on the opposite side. See **Figure 4** for reference.
- Remove the plastic clips and fasteners along the top side of the bumper. Also remove the 10MM fasteners along the bottom of the front bumper. See **Figure 5** for reference.

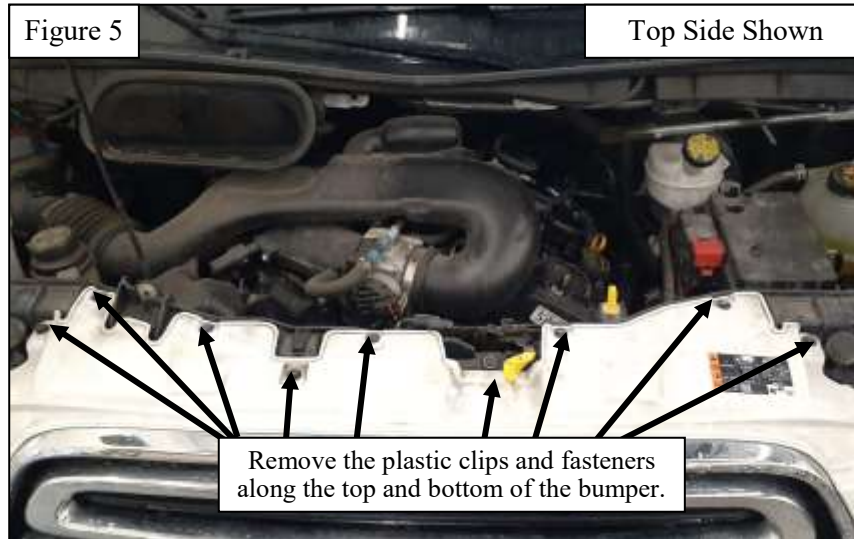
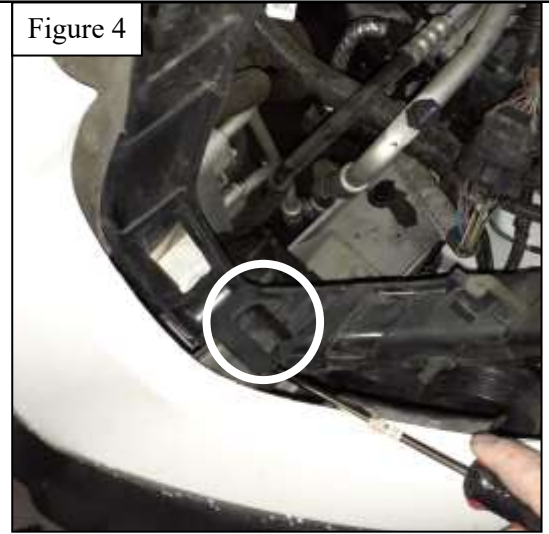
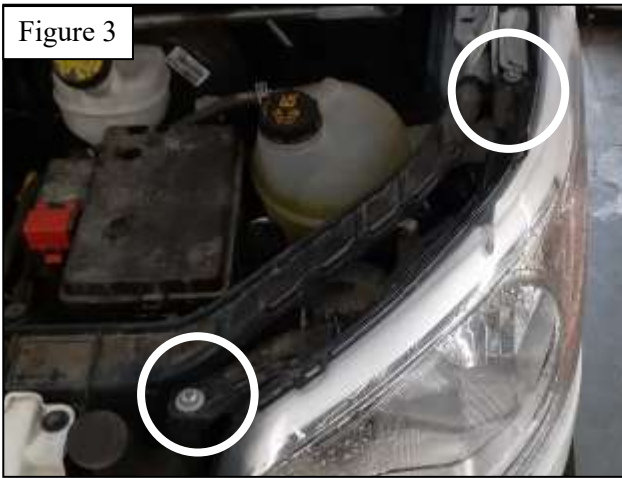

- Remove the license plate and factory license plate holder. Remove the two bolts and carefully pull off the bumper assembly. See **Figures 6 & 7** for reference. **Note:** Make sure any wiring connectors secured to the bumper are unplugged prior to removal.

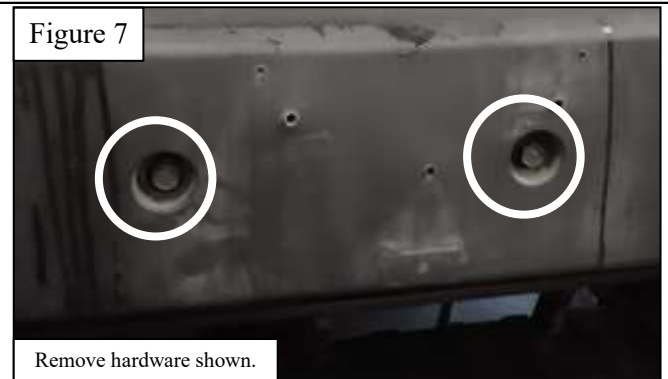
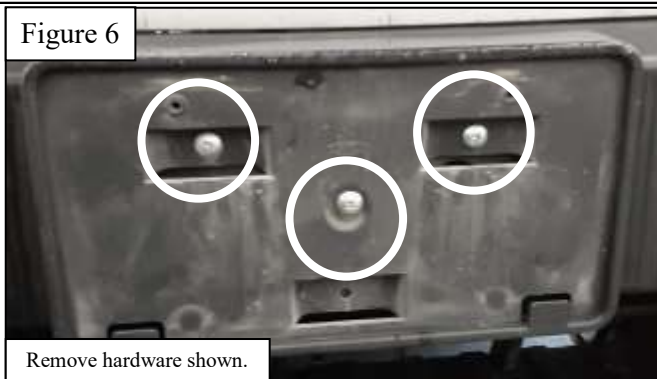

8. Remove the clips indicated and the factory air duct shown in **Figures 8 & 9**. The factory duct will not be reused. Repeat this step for both sides of the vehicle.

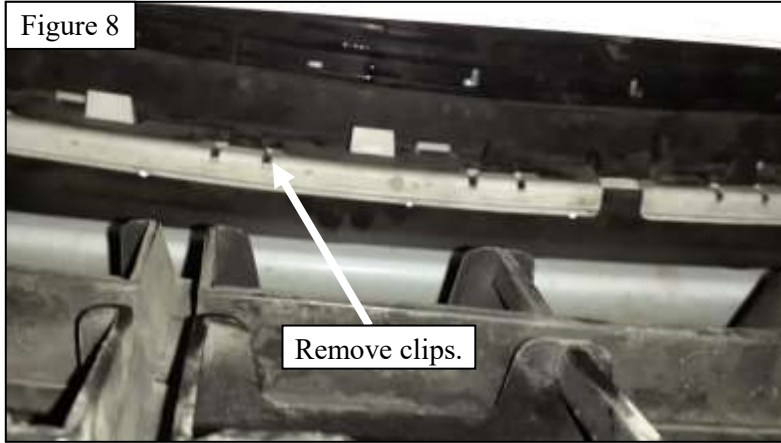

#### TRIMMING INSTRUCTIONS

9. **For model years 2015-2019:** Use the larger provided templates to cut out the bumper. See **Figure 10** for reference.
  10. **For model years 2020-2021:** Use the smaller provided templates to cut out the bumper. See **Figure 11** for reference.
- Align templates as shown below on both driver and passenger sides.
  - Cut out the section shown on the template with a 2" hole saw.

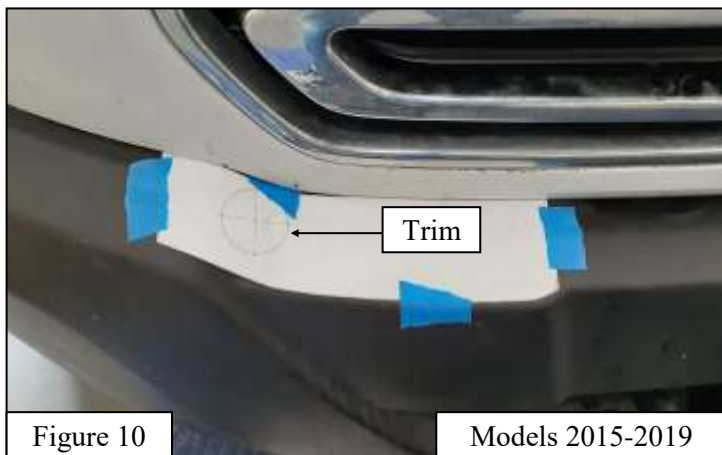

11. After trimming the bumper, reinstall the bumper onto the vehicle.
12. Using the supplied M10 hardware (Items 22-23), install the Upper Support Brackets to the front of the vehicle frame using the upper mounting locations. See **Figures 12 & 13** for reference.

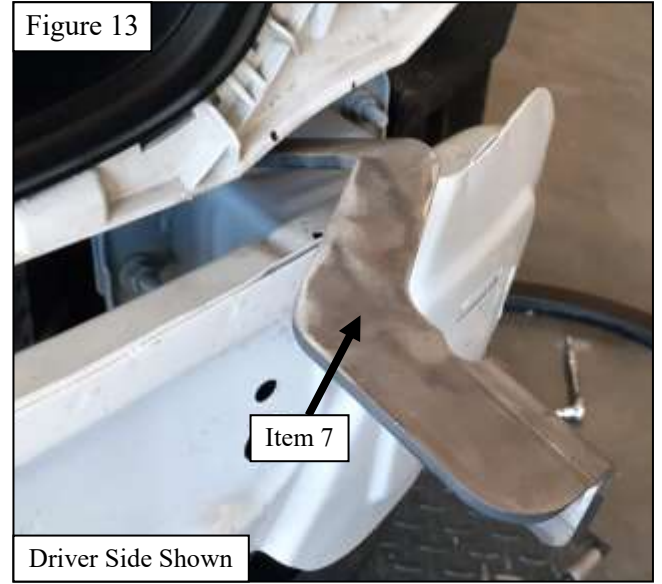
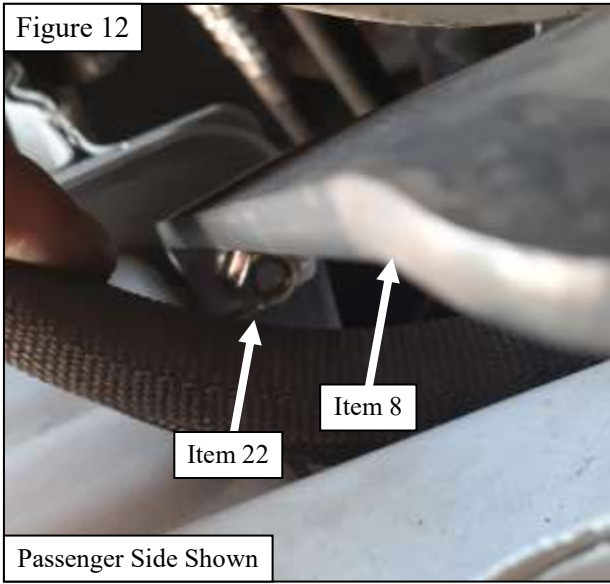

13. Using the supplied M10 and M12 hardware, loosely assemble the Lower Mounting Bracket, Lower Support Bracket, and Spacer to the vehicle's frame on each side. See **Figures 14 & 15** for reference.

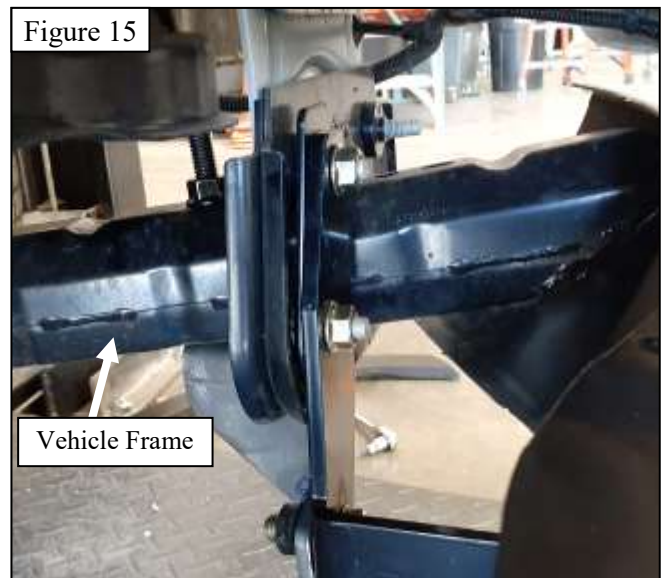
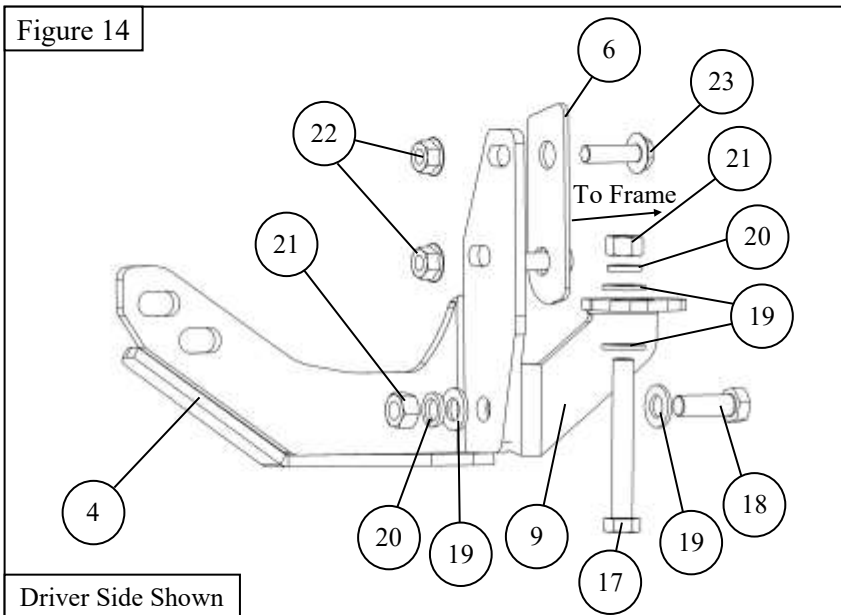

14. Using the supplied M10 and M12 hardware, loosely assemble the Grille Guard Base (Item 1) to the previously installed mounting brackets. See **Figure 16** for reference.
15. Adjust the Grille Guard Base as needed. Tighten and torque all hardware as specified: M10 to 35-40 ft-lbs., M12 to 55-60 ft-lbs.

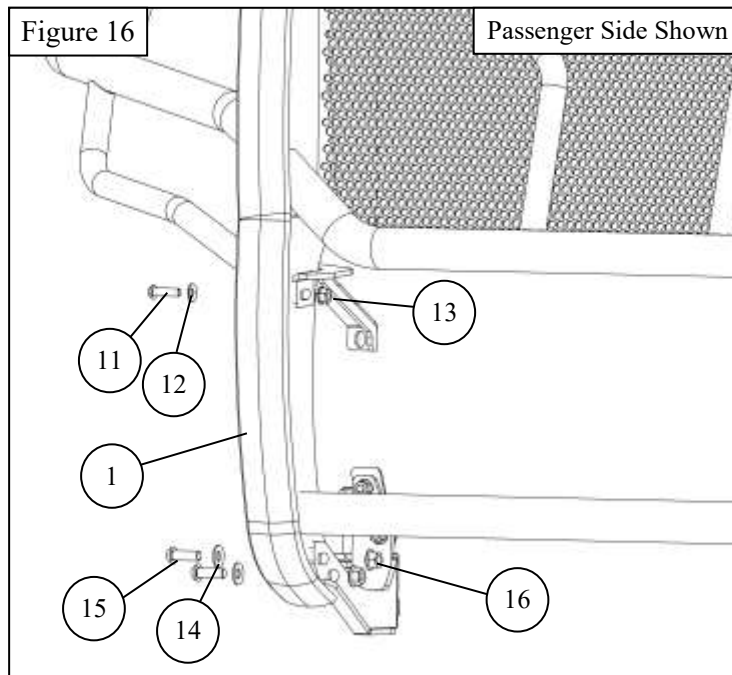

16. Locate and install the Driver and Passenger Wings (Items 2-3) using the M8 hardware. See **Figure 17** for reference.
17. Align and adjust the Wings as necessary. Tighten and torque all M8 hardware to 15-18 ft-lbs.

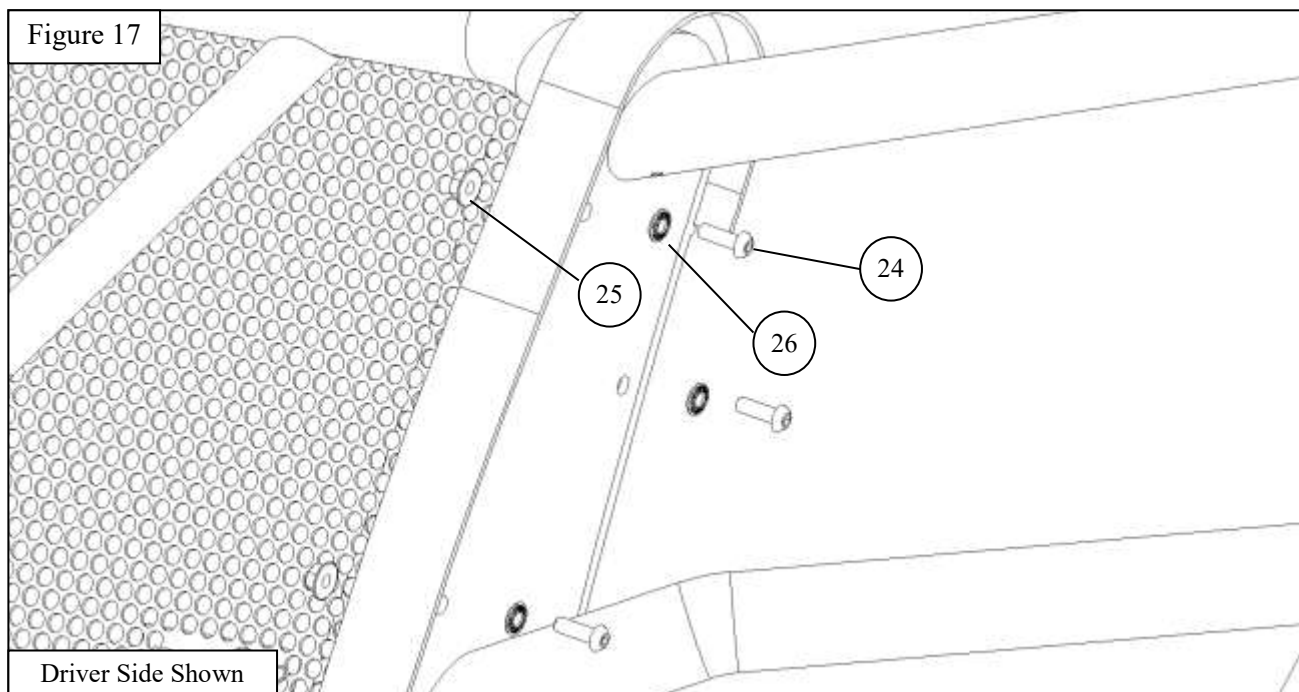

## INSTALLATION COMPLETE



### CARE INSTRUCTIONS

- REGULAR WAXING IS RECOMMENDED. DO NOT USE ANY TYPE OF POLISH OR WAX THAT MAY CONTAIN ABRASIVES.
- STAINLESS STEEL PRODUCTS CAN BE CLEANED WITH MILD SOAP AND WATER. STAINLESS STEEL POLISH SHOULD BE USED TO POLISH SMALL SCRATCHES.
- GLOSS BLACK FINISHES SHOULD BE CLEANED WITH MILD SOAP AND WATER.



Westin Automotive Products, Inc.  
320 W. Covina Blvd  
San Dimas, Ca. 91773

Thank you for choosing Westin products  
for additional installation assistance please call  
Customer Service (800) 793-7846  
[www.westinautomotive.com](http://www.westinautomotive.com)



## WARNING



Failure to follow these instructions could lead to death, personal injury, and / or property damage.

Failure to follow these instructions could lead to death, personal injury, and / or property damage.

### FASTENERS:

All Westin supplied fasteners must be utilized and installed in accordance with the installation instructions and apply torque to the specifications as defined. **DOUBLE CHECK ALL FASTENERS BEFORE INITIAL USE, AND PERIODICALLY IN THE FUTURE TO ENSURE PROPER FUNCTION AND SAFETY.**

### DRILLING:

Most Westin products do not require drilling for installation. If drilling is defined as required, use caution when drilling a vehicle. **FAILURE TO REVIEW AN AREA TO BE DRILLED MAY RESULT IN PERSONAL INJURY AND/OR INJURY TO OTHERS AS WELL AS VEHICLE DAMAGE.**

### EYE PROTECTION:

**ALWAYS WEAR SAFETY GLASSES OR GOGGLES DURING THE INSTALLATION PROCESS TO AVOID PERSONAL INJURY.**

### MAXIMUM TOWING/CARRYING CAPACITY: (if applicable)

The Westin Receiver Hitches will have a visible tow rating label affixed directly on the product. User should never exceed the vehicle manufacturers maximum tow and weight rating regardless of the capacity of the hitch. **FAILURE TO FOLLOW THESE GUIDELINES WILL VOID THE WESTIN WARRANTY AND MAY RESULT IN PERSONAL INJURY AND/OR INJURY TO OTHERS AS WELL AS VEHICLE DAMAGE.**

### FOR CALIFORNIA RESIDENTS ONLY-PROP 65 WARNING:

Some products may contain chemicals such as DEHP, which can cause cancer, birth defects or other reproductive harm. For more info go to [www.p65warnings.ca.gov](http://www.p65warnings.ca.gov)



Westin Automotive Products, Inc.  
320 W. Covina Blvd  
San Dimas, Ca. 91773