

INSTALLATION INSTRUCTIONS

PRO-SERIES FRONT BUMPER



APPLICATION:
CHEVROLET SILVERADO 1500 2023-2024
PART NUMBER:
58-411315

CONTENT			
ITEM	QUANTITY	DESCRIPTION	TOOLS NEEDED
1	1	PRO-SERIES FRONT BUMPER	10MM WRENCH
2	1	WINCH TRAY	19MM WRENCH
3	1	DRIVER MOUNT BRACKET	10MM SOCKET
4	1	PASSENGER MOUNT BRACKET	19MM SOCKET
5	2	WINCH TRAY PLATE	RATCHET
6	1	DRIVER WINCH TRAY BRACKET	TORQUE WRENCH
7	1	PASSENGER WINCH TRAY BRACKET	
8	4	SENSOR L-TAB	
9	1	SENSOR PLATE A	
10	1	SENSOR PLATE B	
11	2	SENSOR PLATE C	
12	1	DRIVER LED BRACKET	
13	1	PASSENGER LED BRACKET	
14	2	RECTANGULAR WASHER	
15	2	SENSOR CABLE EXTENSION	
16	20	SHORT M12 HEX HEAD BOLT (YELLOW ZINC)	
17	8	LONG M12 HEX HEAD BOLT (YELLOW ZINC)	
18	20	M12 SPLIT LOCK WASHER (YELLOW ZINC)	
19	30	M12 FLAT WASHER (YELLOW ZINC)	
20	10	M12 SERRATED FLANGE HEX NUT (YELLOW ZINC)	
21	4	LARGE M10 FLAT WASHER (YELLOW ZINC)	
22	4	M6 HEX HEAD BOLT (YELLOW ZINC)	
23	4	M6 ROUND HEAD SQUARE NECK BOLT (BLACK ZINC)	
24	4	M6 FLAT WASHER (YELLOW ZINC)	
25	8	M6 SERRATED FLANGE HEX NUT (YELLOW ZINC)	
26	4	DOUBLE SIDED FOAM TAPE SQUARE	
ANTI-SEIZE LUBRICANT MUST BE USED ON ALL STAINLESS STEEL FASTENERS TO PREVENT THREAD DAMAGE AND GALLING			



Westin Automotive Products, Inc.
320 W. Covina Blvd
San Dimas, Ca. 91773

Thank you for choosing Westin products
for additional installation assistance please call
Customer Service (800) 793-7846
www.westinautomotive.com

<div data-bbox="94 111 784 304" data-label="Image"> </div> <div data-bbox="74 361 147 388" data-label="Caption"> <p>Item 1</p> </div>	<div data-bbox="850 79 1531 327" data-label="Image"> </div> <div data-bbox="829 361 902 388" data-label="Caption"> <p>Item 2</p> </div>
<div data-bbox="79 407 347 464" data-label="Text"> <p>Driver Side Shown Passenger Side Opposite</p> </div> <div data-bbox="467 426 685 722" data-label="Image"> </div> <div data-bbox="74 711 147 739" data-label="Caption"> <p>Item 3</p> </div>	<div data-bbox="914 455 1458 672" data-label="Image"> </div> <div data-bbox="829 711 902 739" data-label="Caption"> <p>Item 5</p> </div>
<div data-bbox="79 758 347 814" data-label="Text"> <p>Driver Side Shown Passenger Side Opposite</p> </div> <div data-bbox="436 766 753 1073" data-label="Image"> </div> <div data-bbox="74 1060 147 1087" data-label="Caption"> <p>Item 6</p> </div>	<div data-bbox="976 787 1458 1029" data-label="Image"> </div> <div data-bbox="829 1060 902 1087" data-label="Caption"> <p>Item 8</p> </div>
<div data-bbox="71 1106 337 1163" data-label="Text"> <p>Sensor Plate A Shown Sensor Plate B Opposite</p> </div> <div data-bbox="404 1144 753 1415" data-label="Image"> </div> <div data-bbox="74 1411 147 1438" data-label="Caption"> <p>Item 9</p> </div>	<div data-bbox="1076 1121 1338 1415" data-label="Image"> </div> <div data-bbox="823 1411 902 1438" data-label="Caption"> <p>Item 11</p> </div>
<div data-bbox="79 1457 347 1514" data-label="Text"> <p>Driver Side Shown Passenger Side Opposite</p> </div> <div data-bbox="451 1470 709 1780" data-label="Image"> </div> <div data-bbox="66 1759 155 1787" data-label="Caption"> <p>Item 12</p> </div>	<div data-bbox="950 1488 1438 1740" data-label="Image"> </div> <div data-bbox="823 1759 902 1787" data-label="Caption"> <p>Item 14</p> </div>



Westin Automotive Products, Inc.
320 W. Covina Blvd
San Dimas, Ca. 91773

Thank you for choosing Westin products
for additional installation assistance please call
Customer Service (800) 793-7846
www.westinautomotive.com

PROCEDURE

1. Remove contents from box, verify if all parts listed are present and free from damage. Carefully read and understand all instructions before attempting installation.
Failure to identify damage before installation could lead to a rejection of any claim.

2. Remove the three fasteners retaining the panel above the bumper from the inside of the wheel wells. See **Figure 1**.
3. Remove the trim panel from the clips near the headlights. Use a pry tool if necessary. See **Figure 2**.

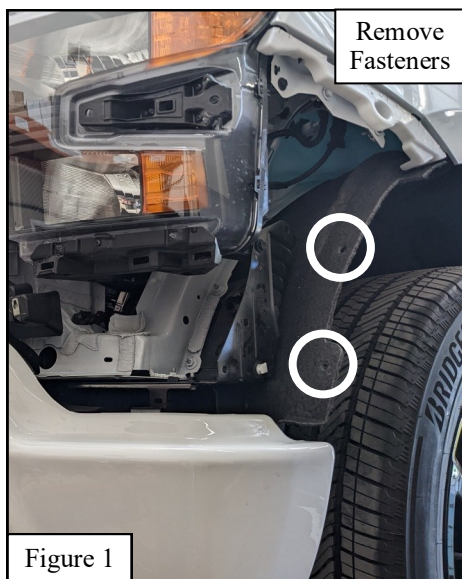

4. On both sides of the vehicle, use a pry tool to remove the fascia panel from the clips shown. See **Figures 3 and 4**.
5. Remove the fascia panel above the bumper. **Note:** The fascia panel contains plastic clips retaining it to the rest of the vehicle. Pull firmly and carefully on the fascia to remove it.



6. Open the hood and remove the lever seen in **Figure 5** using a T10 Torx driver. Remove the (2) screws and slide the lever toward the front of the vehicle.
7. Remove the plastic cover shown in **Figure 6**. Use a pry tool to disengage and remove the clips retaining the plastic cover.

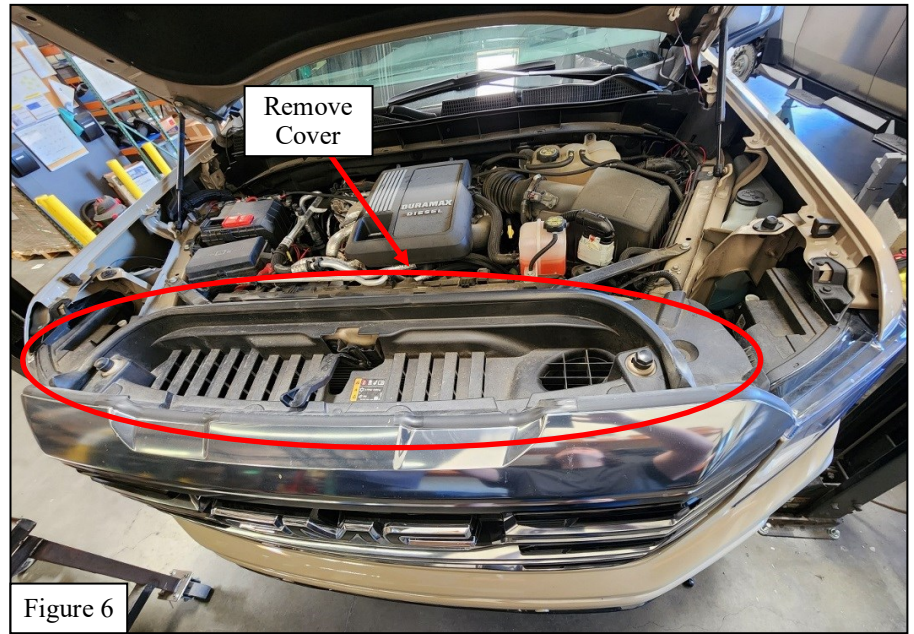
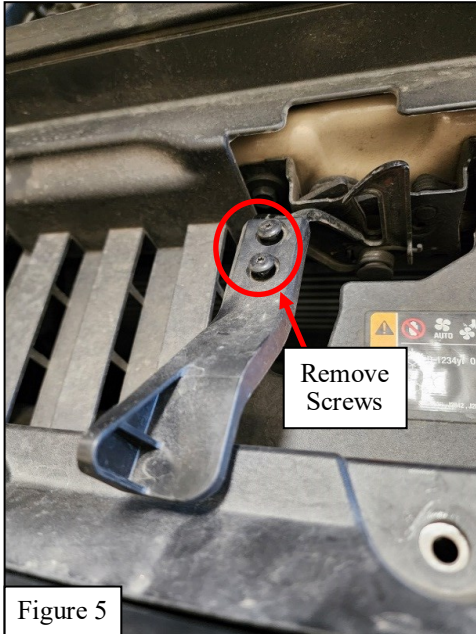

8. Remove the fasteners retaining the grille. There are 4 fasteners along the top and three along the bottom. See **Figures 7 and 8**.
9. Remove the grille from the clips above the headlights. See **Figure 8**.
10. Remove the grille by firmly and carefully pulling it away from the vehicle.

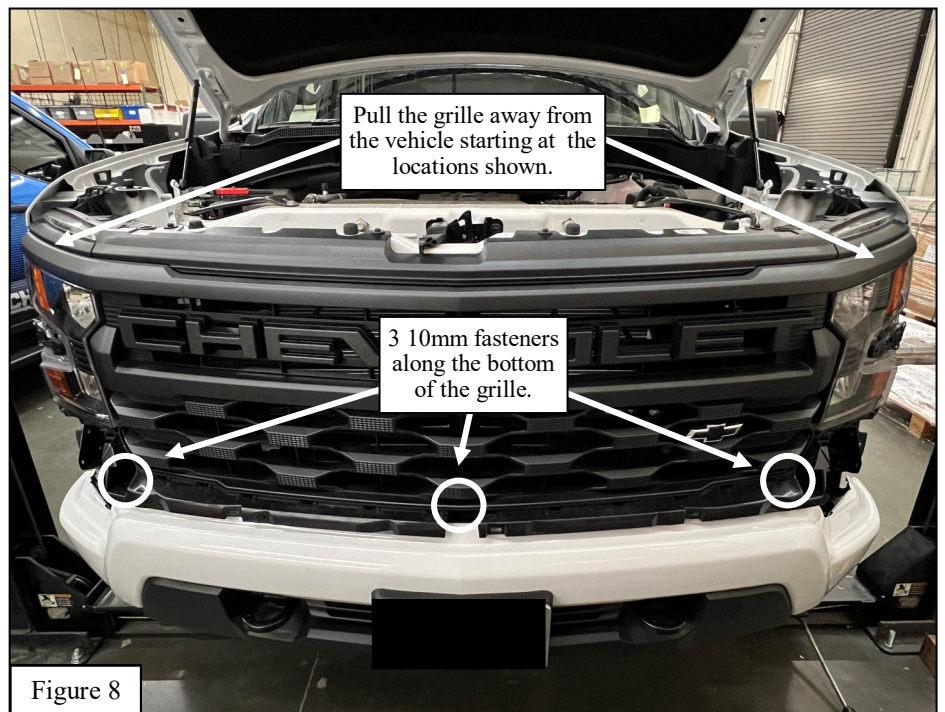
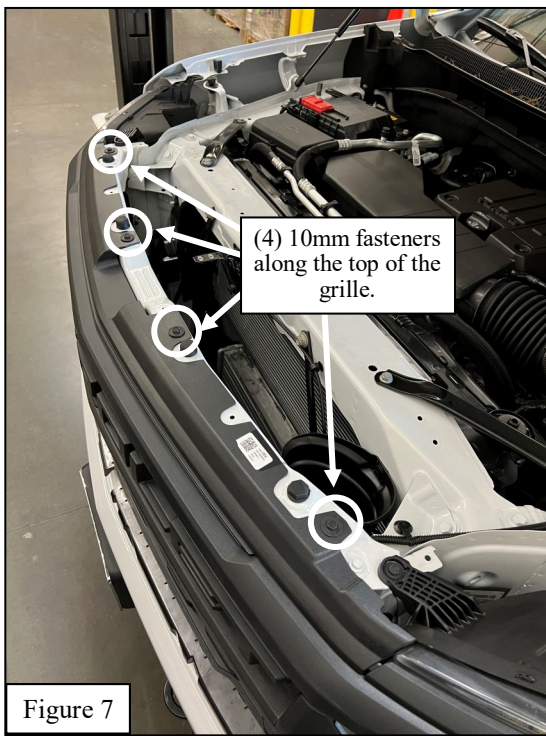

11. Disconnect the electrical harness seen in **Figure 9**. If a block heater is equipped, disconnect the block heater cable.

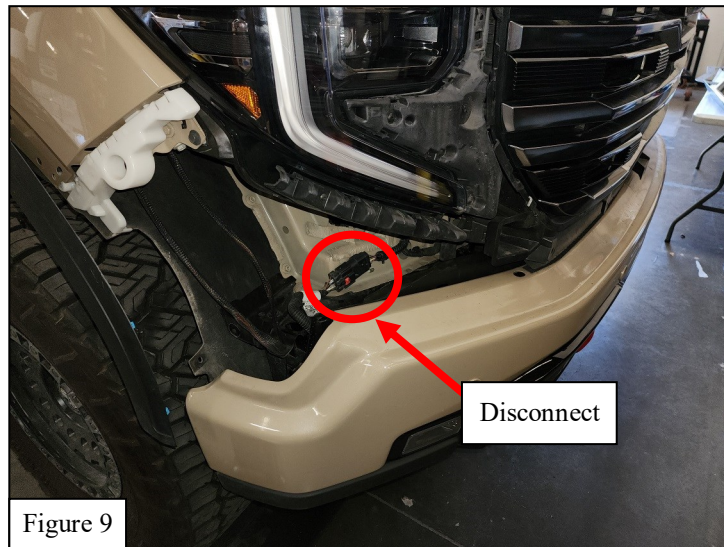

12. Remove the panel shown in **Figure 10**. Lift the panel and remove the clips underneath see **Figures 10 and 11**.

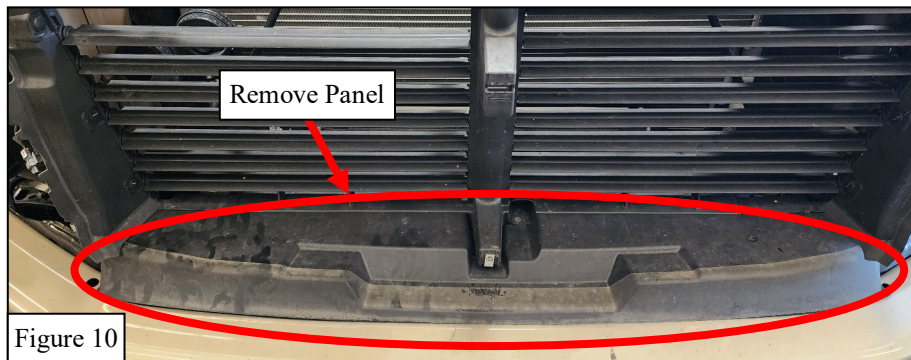

13. Remove the (4) OE bolts located underneath the panel removed in the previous step. See **Figure 12**.
14. Remove the (4) OE bolts attached to the bottom of the plastic skid plate. See **Figure 13**.
15. Remove the (2) OE bolts on the sides of the bumper shown in **Figure 13**.
16. Remove Bumper by carefully pulling it out.

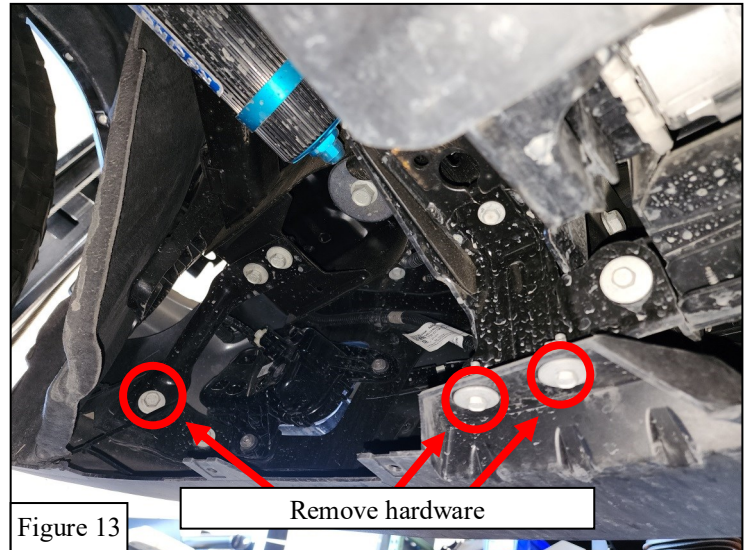
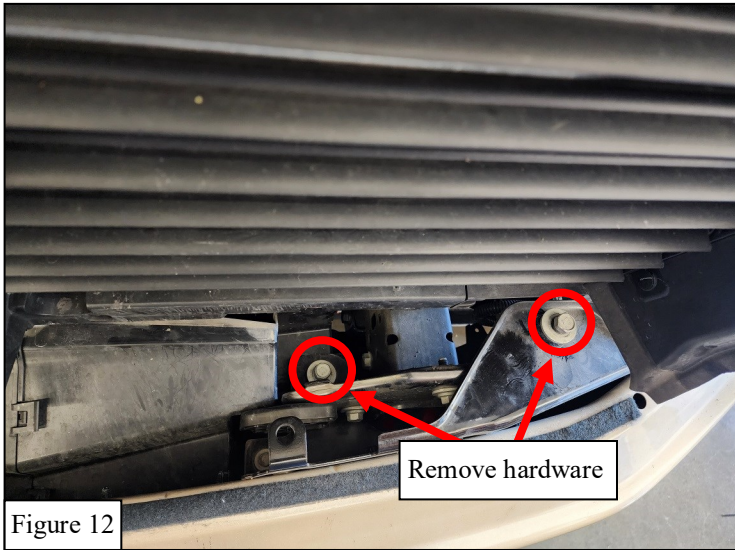

17. If an air baffle is equipped, remove the air baffle.
18. If tow hooks are equipped, remove the tow hooks.
19. Slide the Driver Winch Tray Bracket (**item 3**) into the frame. See **Figure 14**.

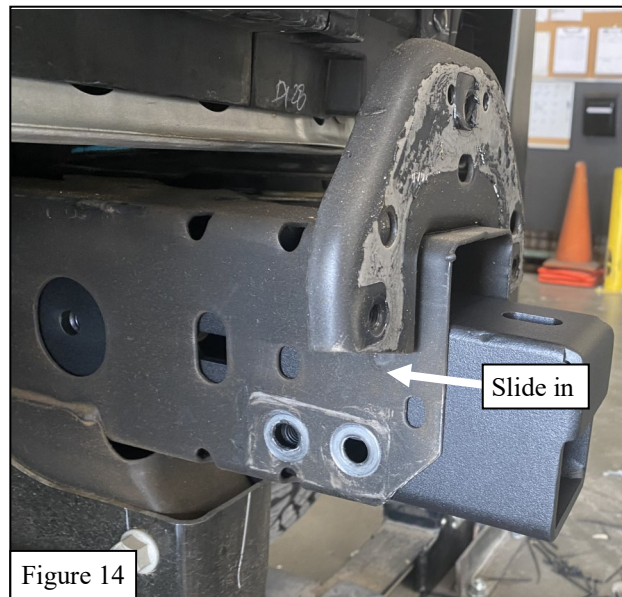

20. Remove the OEM bracket from underneath the Driver Winch Tray Bracket. See **Figure 15**.
21. Loosely install the Driver Winch Tray Bracket and a Winch Tray Plate (**item 5**) using the M12 hardware (**items 14, 16-20**). See Figures **15** and **16**.

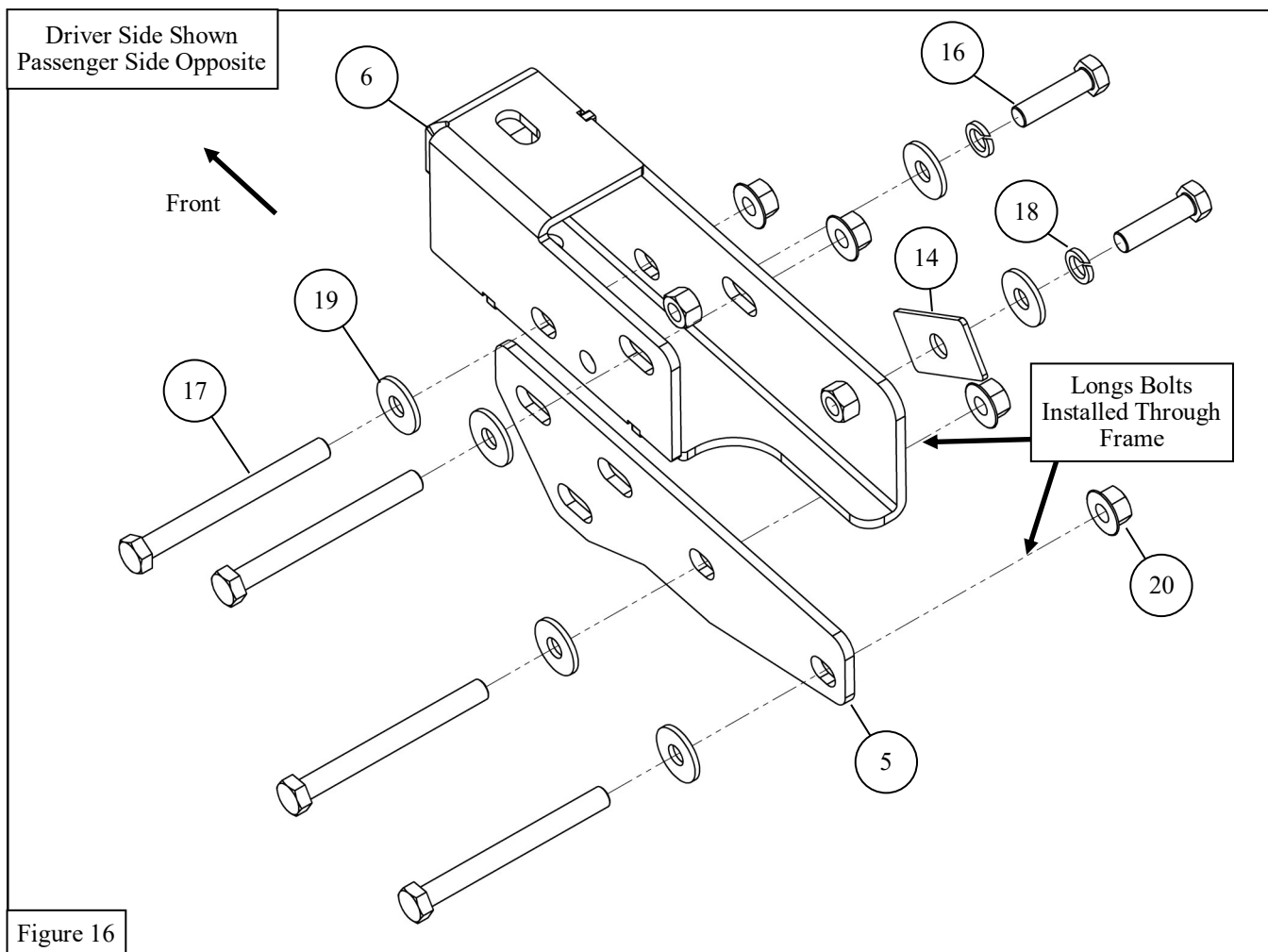
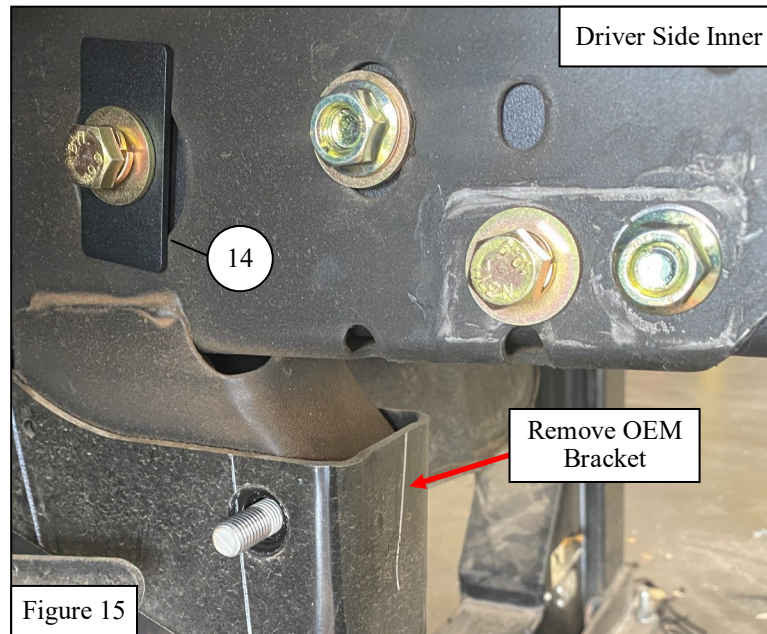

22. Repeat steps 19-21 on the passenger side.
23. Install the winch onto the winch tray. Use the Large M10 washers included with the bumper instead of the M10 washers included with the winch.
24. Loosely install the Winch Tray (**item 2**). Hold the Winch Tray between the Winch Tray Plates and beneath the vehicle frame. Use the M12 hardware (**items 16, 18, and 19**) to attach the Winch Tray to the Winch Tray Plates and Winch Tray Brackets. See **Figure 17**.

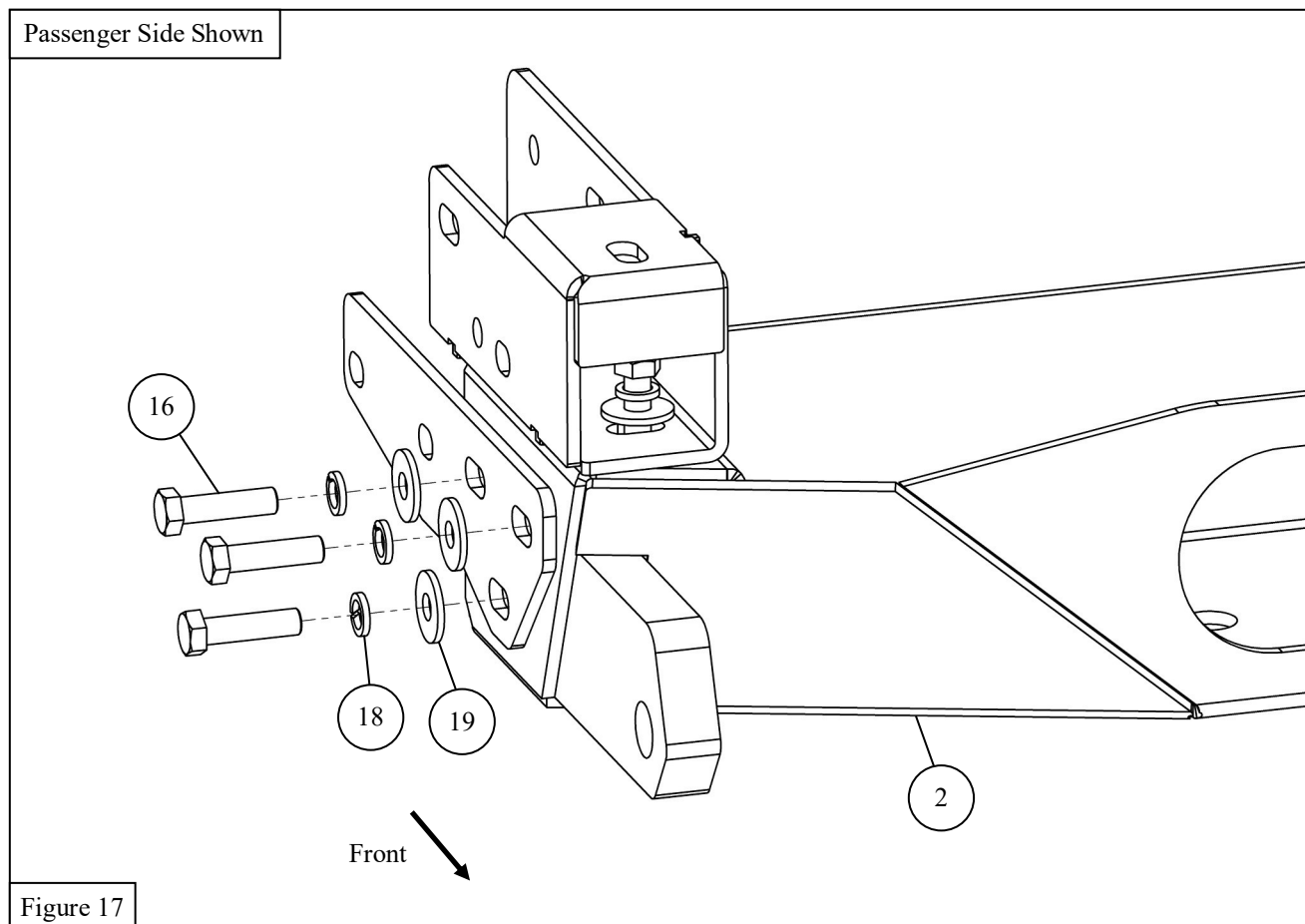

25. On each side, remove the M12 bolt directly above the Winch Tray Bracket.
26. Loosely install the Mount Brackets (**items 3 and 4**) on top of the Winch Tray Brackets using the M12 hardware (**items 16, 18-20**) and the M12 bolts removed in the previous step. See **Figure 18**.
27. Align and adjust the winch tray and brackets. Tighten and torque the M12 hardware to 55-60 ft-lbs.

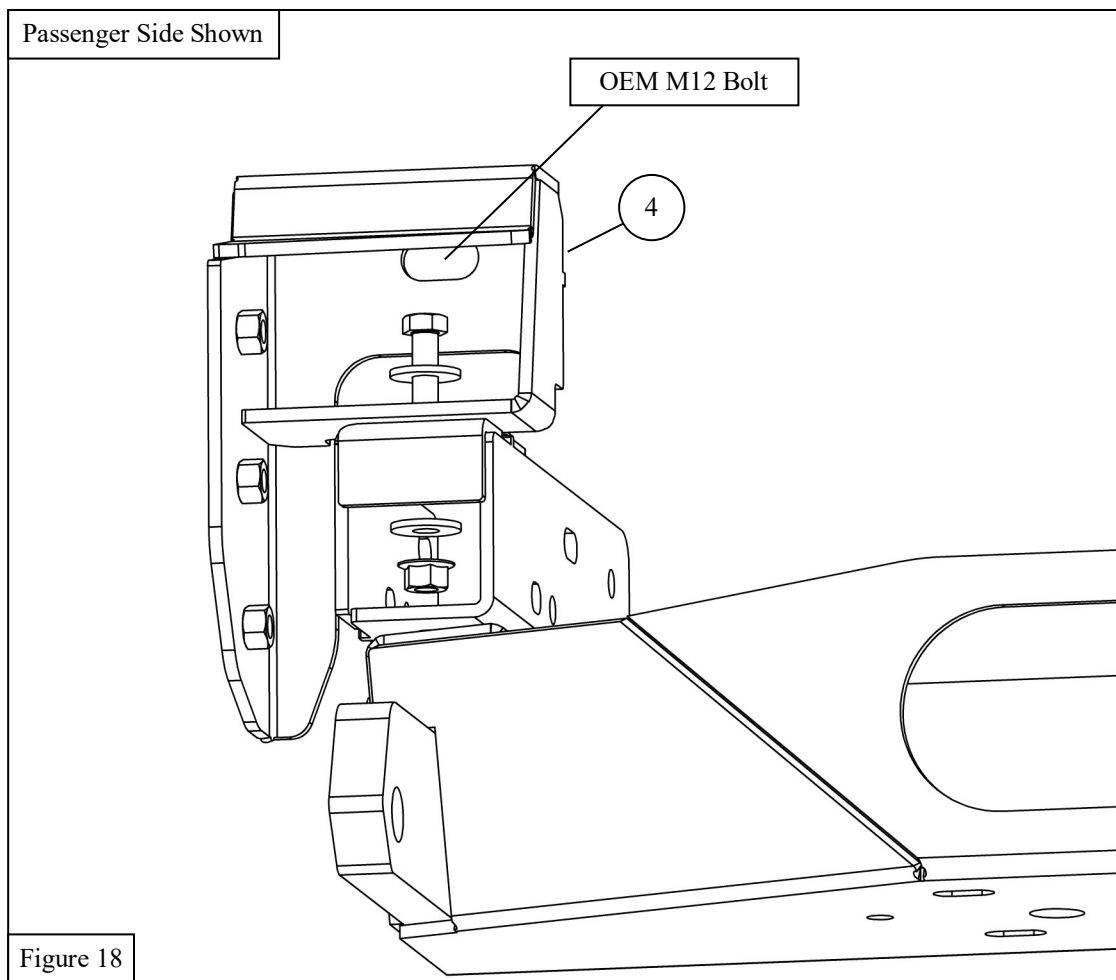

Parking Sensor Relocation Instructions
If parking sensors are not equipped, skip to step 32.

28. Install the parking sensors to onto the Sensor Plates (**items 9-11**) using the Sensor L-Tabs (**item 8**), Double Sided Foam Tape Squares (**items 26**) and M6 hardware (**items 23 and 25**). See **Figure 19**.

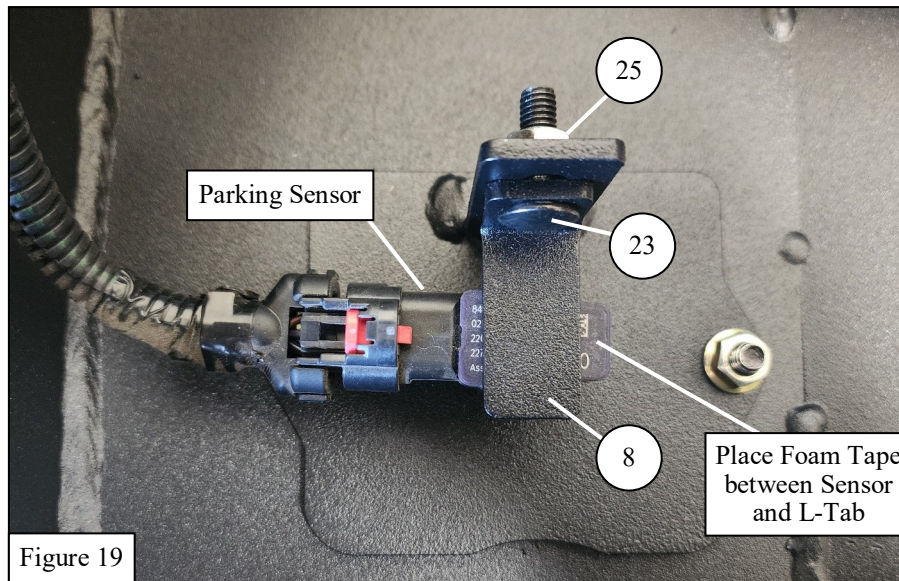

29. Remove the small mesh covers from the Pro-Series Bumper. See **Figure 20**.
30. Install the Sensor Plates onto the Pro-Series Bumper using the hardware removed in the previous step. See **Figure 20**.
31. Tighten the M6 hardware to 5-8 ft-lb.

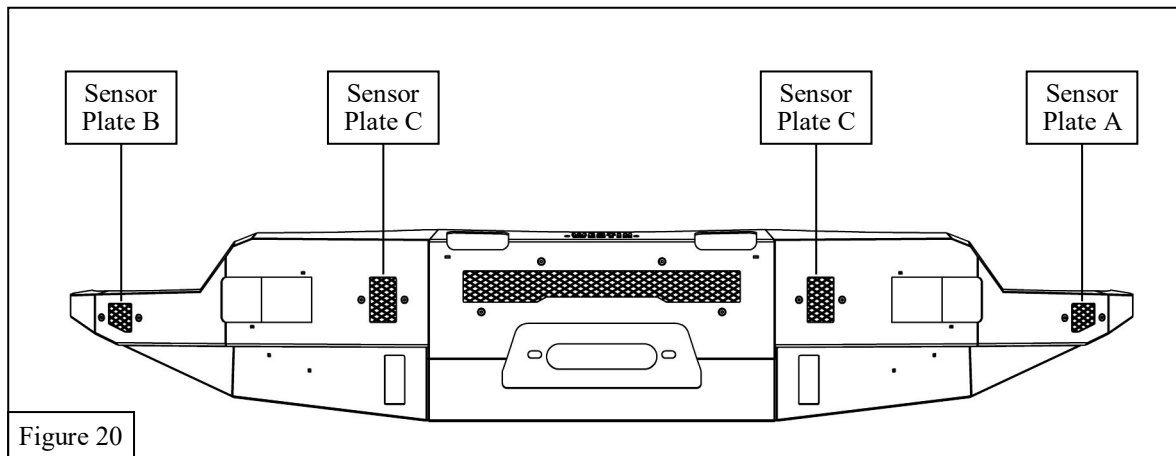

20" LED Light Bar Installation (B-Force Double Row LED Light Bar P.N. 09-12212-40C recommended)

Skip to step 36 if you are not installing a LED light bar.

32. Remove large center mesh cover.
33. Install the LED Brackets (**items 12 and 13**) using the M6 hardware (**items 22, 24, and 25**). See **Figure 21**.
34. Install the LED light bar onto the LED Brackets using the hardware included with the LED light bar.
35. Tighten the M6 hardware to 5-8 ft-lb.

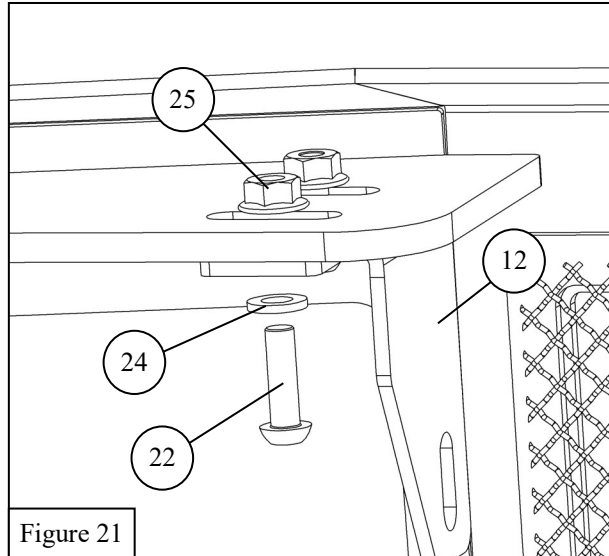

36. If installing LED light cubes (HyperQ LED Auxiliary Lights recommended), install them at this time. See **Figure 22**.
37. With help, install the bumper to the mounting brackets using the M12 hardware (**items 16, 18, and 19**). See **Figure 22**.
38. Align and adjust the bumper. Tighten and torque the M12 hardware to 55-60 ft-lbs.

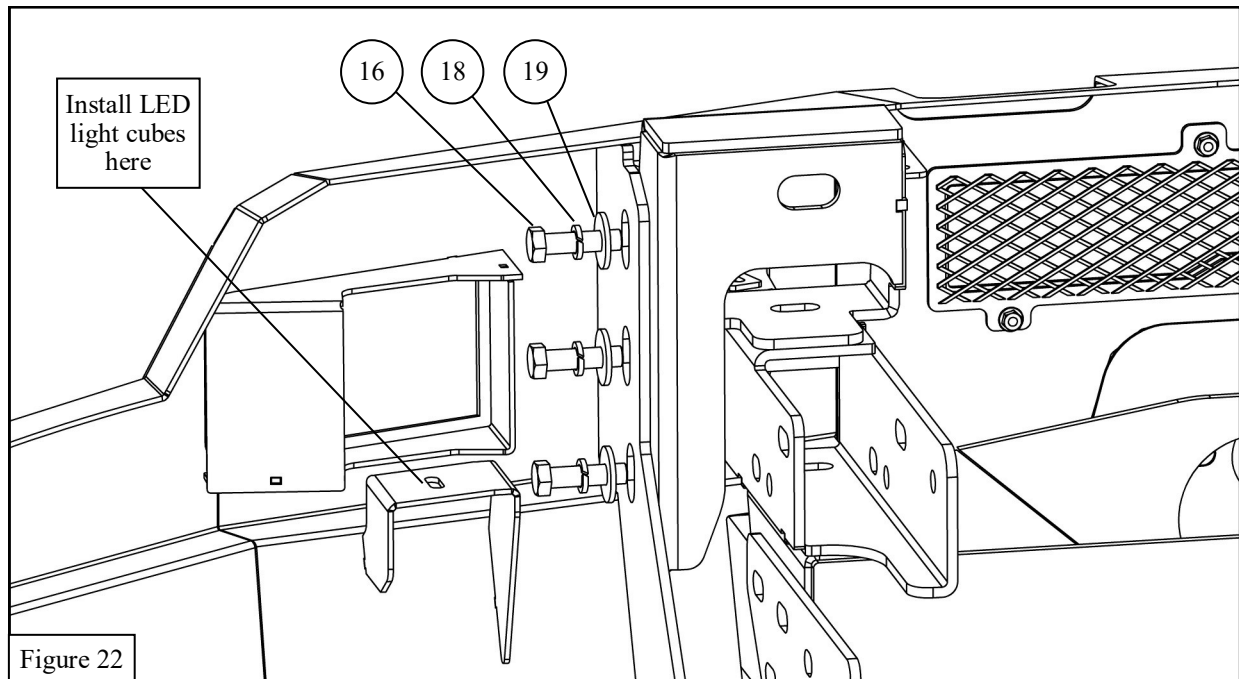

Westin Automotive Products, Inc.
320 W. Covina Blvd
San Dimas, Ca. 91773

Thank you for choosing Westin products
for additional installation assistance please call
Customer Service (800) 793-7846
www.westinautomotive.com

Parking Sensor Relocation Instructions
If parking sensors are not equipped, skip to step 44.

39. Remove the wiring harness from the OEM bumper.
40. Connect the sensor cable extensions to the outer parking sensors.
41. Connect the wiring harness to the parking sensors and sensor cable extensions. Route the wiring harness over the mount brackets.
42. Connect the wiring harness to the vehicle. See **Figure 23** for connection location.
43. Use zip ties to keep the wiring harness in place.



44. Reinstall the grille, fascia panel, cover, and lever. Refer to steps 2-12 for reference.



Westin Automotive Products, Inc.
320 W. Covina Blvd
San Dimas, Ca. 91773

INSTALLATION COMPLETE



CARE INSTRUCTIONS

- REGULAR WAXING IS RECOMMENDED. DO NOT USE ANY TYPE OF POLISH OR WAX THAT MAY CONTAIN ABRASIVES.
- STAINLESS STEEL PRODUCTS CAN BE CLEANED WITH MILD SOAP AND WATER. STAINLESS STEEL POLISH SHOULD BE USED TO POLISH SMALL SCRATCHES.
- GLOSS BLACK FINISHES SHOULD BE CLEANED WITH MILD SOAP AND WATER.



Westin Automotive Products, Inc.
320 W. Covina Blvd
San Dimas, Ca. 91773

Thank you for choosing Westin products
for additional installation assistance please call
Customer Service (800) 793-7846
www.westinautomotive.com



WARNING



Failure to follow these instructions could lead to death, personal injury, and / or property damage.

Failure to follow these instructions could lead to death, personal injury, and / or property damage.

FASTENERS:

All Westin supplied fasteners must be utilized and installed in accordance with the installation instructions and apply torque to the specifications as defined. **DOUBLE CHECK ALL FASTENERS BEFORE INITIAL USE, AND PERIODICALLY IN THE FUTURE TO ENSURE PROPER FUNCTION AND SAFETY.**

DRILLING:

Most Westin products do not require drilling for installation. If drilling is defined as required, use caution when drilling a vehicle. **FAILURE TO REVIEW AN AREA TO BE DRILLED MAY RESULT IN PERSONAL INJURY AND/OR INJURY TO OTHERS AS WELL AS VEHICLE DAMAGE.**

EYE PROTECTION:

ALWAYS WEAR SAFETY GLASSES OR GOGGLES DURING THE INSTALLATION PROCESS TO AVOID PERSONAL INJURY.

MAXIMUM TOWING/CARRYING CAPACITY: (if applicable)

The Westin Receiver Hitches will have a visible tow rating label affixed directly on the product. User should never exceed the vehicle manufacturers maximum tow and weight rating regardless of the capacity of the hitch. **FAILURE TO FOLLOW THESE GUIDELINES WILL VOID THE WESTIN WARRANTY AND MAY RESULT IN PERSONAL INJURY AND/OR INJURY TO OTHERS AS WELL AS VEHICLE DAMAGE.**

FOR CALIFORNIA RESIDENTS ONLY-PROP 65 WARNING:

Some products may contain chemicals such as DEHP, which can cause cancer, birth defects or other reproductive harm. For more info go to www.p65warnings.ca.gov



Westin Automotive Products, Inc.
320 W. Covina Blvd
San Dimas, Ca. 91773